

NOTE: DO NOT COVER OR CONCEAL ANY BUILDING, ELECTRICAL, PLUMBING OR MECHANICAL WORK WITHOUT INSPECTOR'S SIGNATURE IN PROPER PLACE.

B10	FOUNDATION FORMS	INSPECTION	INSPECTOR	DATE
E60/B11	UFER GROUND			6-28-00
B12	CONCRETE SLAB FORMS			6-14-00
P40	PLUMB UNDERFLOOR/SLAB			6-28-00
M30	MECH UNDERFLOOR/SLAB			
E61	ELECT UNDERGROUND			
E62	ELECT CONDUIT-SLAB			
B13	FLOOR JOISTS OR GIRDERS	DO NOT COVER UNTIL INSTALLATION ABOVE HAS BEEN SIGNED		
B14/15	INSULATION/WALL/FLOOR	DO NOT INSTALL SUB FLOOR UNTIL ABOVE HAS BEEN SIGNED		
P41	TOP PLUMBING			
M31	TOP MECHANICAL/WALL/CELL			
E83	ROUGH ELECTRICAL/WALL/CELL			
B19	FRAME			
B17	ROOF PLYWOOD NAIL COMM. & APIS			7-25-00
B18	EXTERIOR PLATH/SIDING			10-16-00
B22	INT. LATH OR WALL BD. NAILING	DO NOT COVER UNTIL INSTALLATION ABOVE HAS BEEN SIGNED		
E66	DO NOT TAPE PLASTER OR TOP UNTIL ABOVE HAS BEEN SIGNED			
P43	SEWER SERVICE			
P42	WATER SERVICE			6-8-00
P46	SPRINKLER SYSTEM			
P47/SS	GAS TEST	DO NOT COVER UNTIL INSTALLATION ABOVE HAS BEEN SIGNED		
P48	TEMP GAS			11-17-00
E68	POWER GAS			
E67	TEMP POWER # 10068C			9-27-00
SWIMMING POOLS ONLY				
P47	GAS TEST			
P41	PLUMBING PRE-GUNITE			
P40	PLUMBING PRE-DECK			
E71	ELECTRICAL PRE-GUNITE			
E71	ELECTRICAL PRE-DECK			
E72	ELECTRICAL UNDERGRD			
DO NOT COVER UNTIL INSTALLATION ABOVE HAS BEEN SIGNED				
FINAL APPROVALS				
BUI DING ELECTRICAL PLUMBING MECHANICAL FIRE S/I				
DO NOT OCCUPY BUILDING UNTIL ALL OF THE ABOVE HAVE BEEN SIGNED AND CERTIFICATE OF OCCUPANCY ISSUED THIS CARD TO BE POSTED ON JOB AT ALL				

BUILDING SITE ADDRESS

2311 Cashew Way

SUITE

INSR AREA
4R

ASSESSOR PARCEL NO.

225 1530 018

COMMUNITY PLAN NO.

NAME OF APPLICANT

Kevin Cott 11/11

ADDRESS

ZIP CODE

PHONE NO.

LICENSED CONTRACTOR

PROPERTY OWNER

ARCH. ENGR.

104 18

Kat cards

License No.

18

NO. OF STORIES

2

NO. OF ROOMS

9

ROOF COVERING

AREA 1ST FLOOR

TOTAL AREA

2156

THIS PERMIT IS FOR:

BUILDING

MECHANICAL

PLUMBING

ELECTRICAL

SITE

FIRE

OCCUP. GROUP

NATURE OF WORK IN DETAIL

NSFR MP2156

FLOOD STATUS

() SPECIAL CONDITIONS ATTACHMENTS:

CITY OF SACRAMENTO BUILDING INSPECTION DIVISION 264-5191

WORKER'S COMPENSATION DECLARATION

I hereby affirm under penalty of perjury one of the following declarations:

I have and will maintain a certificate of consent to self-insure for workers' compensation as provided for by Section 3700 of the Labor Code for the performance of work for which the permit is issued.

I have and will maintain workers' compensation insurance as required by Section 3700 of the Labor Code for the performance of the work for which this permit is issued. My worker's compensation insurance carrier and policy number are:

Carrier: _____
Policy Number: _____

(This section need not be completed if the permit is for one hundred dollars (\$100) or less.) I certify that in the performance of the work for which this permit is issued, I shall not employ any person in any manner so as to become subject to the workers' compensation laws of California and agree that if I should become subject to the workers' compensation provisions of Section 3700 of the Labor Code, I shall forthwith comply with those provisions.

Date: _____ Applicant: _____ (Signature)

VALUATION	\$ 40678.40	FIRE SP.	
ISSUED BY:	KS	FED CODE	
DATE ISSUED	6/17/00	PERMIT NO.	
BUILDING PERMIT FEE	\$		
PLAN CHECK/PROC. FEE	\$		
S.M.T. FEE	\$		
CONST. EXCISE TAX	\$		
CITY BUS LICENSE	\$		
TECH FEE	\$		
WATER DEV. FEE	\$		
CITY SEWER DEV. FEE	\$		
REG. SEWER FEE	\$		
RESIDENTIAL CONST. TAX	\$		
TOTAL FEES	\$		

RESIDENTIAL BUILDING PERMIT APPLICATION

Lot 18

- New Construction
 Addition
 Remodels
 Other

Project Address: 2211 Cashan Place Assessor Parcel # 225-1330-08

OWNER INFORMATION: Natomas Crossing Phase #1

Legal Property Owner: Kimball Hill Homes Phone # 714-1153
 Owner Address: 10535 East Stockton Blvd City ELK GROVE State Ca Zip ~~744-1425~~
95624

CONTRACTOR INFORMATION:

Contractor: Kimball Hill Homes Lic. # 701-803 Phone # 714-1153 Fax# 714-1425

PROJECT INFORMATION:

Land Use Zone R-14 Occupancy Group R-3 Construction Type VN Fed Code 1A

No. of stories: 2 No. of rooms: 9 Street width: _____

1st Floor Area 1086 - 2nd Floor Area 1070 Basement _____ Roof Material _____

AREA IN SQUARE FOOT OF:

EXISTING NEW

Dwelling/Living	_____	<u>2156</u>
Garage/Storage	_____	<u>418</u>
Decks/Balconies	_____	<u>135</u>
Carports	_____	_____

SCOPE OF WORK:

FOR OFFICE USE ONLY:

- | | | |
|---|---|--|
| <input type="checkbox"/> Information above complete | <input type="checkbox"/> AR Flood Waiver required | <input type="checkbox"/> Planning Approval |
| <input type="checkbox"/> Violation files checked | <input type="checkbox"/> Flood Elevation Certificate Required | <input type="checkbox"/> Design Review Approval |
| <input type="checkbox"/> Standard setbacks | <input type="checkbox"/> Water Development Infill Area | <input type="checkbox"/> Special Fee Districts Apply : _____ |
| <input type="checkbox"/> County Sewer | | |

NEW STRUCTURES & ADDITIONS

❖ THE FOLLOWING MUST BE PROVIDED IN ORDER TO SUBMIT FOR PLAN REVIEW

- | | |
|---|---|
| <input type="checkbox"/> 2 COMPLETE PLANS, LEGIBLE & DRAWN TO SCALE | ❖ Plans to include: site plan, floor plan, elevations, roof/ceiling plan, foundation and structural framing details, and structural calculations for non-conforming structures. |
| <input type="checkbox"/> 3 SETS IF PROJECT IS IN A DESIGN REVIEW AREA | |
| <input type="checkbox"/> Title 24 Energy Compliance documentation | <input type="checkbox"/> 11" x 17" copy of floor plan for County Assessor |
| <input type="checkbox"/> Grading and Erosion Control Questionnaire | <input type="checkbox"/> Plan Review Fees |

Date: _____

Received by: (staff) _____

ACTIVITY/PERMIT # _____



INSULATION CONTRACTORS ASSOCIATION OF AMERICA

1321 DUKE STREET, SUITE 303 • ALEXANDRIA, VA 22314 • (703) 739-0356



LOT # 18 TRACT # WAINMAG
STREET 2311 Cashaw CITY SN

EXTERIOR WALLS:
MANUFACTURER _____ THICKNESS/TYPE _____ R-VALUE 13

CEILINGS:
BATTS:
MANUFACTURER _____ THICKNESS/TYPE _____ R-VALUE 30

BLOWN IN:
MANUFACTURER C.T. MINIMUM THICKNESS 12" R-VALUE 30

SQUARE FOOTAGE COVERED 1375 NUMBER OF BAGS USED 25

FLOORS:
MANUFACTURER _____ THICKNESS/TYPE _____ R-VALUE _____

SLAB ON GRADE:
MANUFACTURER _____ THICKNESS/TYPE _____ R-VALUE _____

WIDTH OF INSULATION _____ INCHES

FOUNDATION WALLS:
MANUFACTURER _____ THICKNESS/TYPE _____ R-VALUE _____

GENERAL CONTRACTOR _____
CALIFORNIA CONTRACTORS LICENSE # _____ DATE _____

SIGNATURE TITLE

INSULATION CONTRACTOR **ARCADE INSULATION**
CALIFORNIA CONTRACTORS LICENSE #263784

SIGNATURE DATE 11-9-00

SIGNATURE TITLE

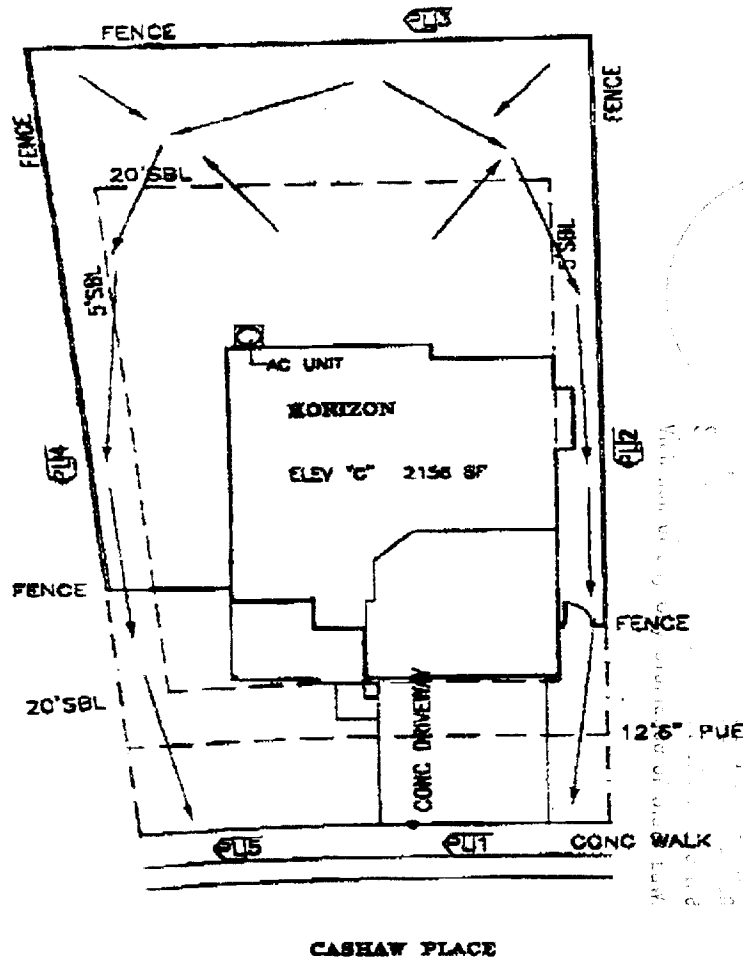

This plan is a general representation of the lot and does not constitute a warranty of any kind. The actual placement and measurements demonstrated on this diagram are subject to change without notice.



BLOOM
Architectural
Developments
Incorporated
 1427 Kenneth Avenue
 Fair Oaks, CA 95628
 (916)981-1553
 (916)987-3011 Fax



LOT#	BEARING	LENGTH	R
PL1	N89°34'10"E	21.08'	
PL2	N00°25'50"W	110.00'	
PL3	N89°34'10"E	50.07'	
PL4	N05°36'44"W(R)	111.76'	
PL5	N66°58'43"E	28.93'	320.00'

Plot Plan Disclosure This plot plan approximates a general representation of lot dimensions, easements, fences and home placement, etc. This illustration is not a condition of Kimball Hill Homes sales agreement. The actual placement and measurements demonstrated on this diagram are subject to change without notice.

Signature _____

KHH California, Inc. (916)714-1153
 10535 E. Stockton Blvd, Ste. K, Elk Grove, CA 95768

Job# 1648 18 **Plan#** 2156
Date Apr 03 00 **Draft #**
Plan HORIZON **Elev** C
Project Natomas Crossing
Lot 18 **Unit** 18
Address 2211 Cashaw Place
City Sacramento **State** CA
APN -----0000

PLOT PLAN
 Scale 1"=20'