

CITY OF SACRAMENTO
1231 I Street, Sacramento, CA 95814

Permit No: 0007263
Insp Area: 4

Site Address: 5130 SEAGLENN WY SAC
Parcel No: 201-0350-019

Sub-Type: NSFR
LOT 19 NORTHBOROU VILL 5-1 Housing (Y/N): N

CONTRACTOR
CENTEX HOMES
3300 DOUGLAS BLVD
STE. 210 95661

OWNER

ARCHITECT

Nature of Work: NSFR MP2512B/OPT 10 RMS 2 STORY

CONSTRUCTION LENDING AGENCY : I hereby affirm under penalty of perjury that there is a construction lending agency for the performance of the work for which this permit is issued (Sec. 3097, Civ. C).

Lender's Name N/A Lender's Address _____

LICENSED CONTRACTORS DECLARATION: I hereby affirm under penalty of perjury that I am licensed under provisions of Chapter 9 (commencing with section 7000) of Division 3 of the Business and Professions Code and my license is in full force and effect.

License Class B License Number 734094 Date 6-30-00 Contractor Signature Debi Stewer

OWNER-BUILDER DECLARATION: I hereby affirm under penalty of perjury that I am exempt from the contractors License Law for the following reason (Sec. 7031.5, Business and Professions Code; any city or county which requires a permit to construct, alter, improve, demolish, or repair any structure, prior to its issuance, also requires the applicant for such permit to file a signed statement that he or she is licensed pursuant to the provisions of the Contractors License Law (Chapter 9 (commencing with Section 7000) of Division 8 of the Business and Professions Code) or that he or she is exempt therefrom and the basis for the alleged exemption. Any violation of Section 7031.5 by any applicant for a permit subjects the applicant to a civil penalty of not more than five hundred dollars (\$500.00);

____ I, as a owner of the property, or my employees with wages as their sole compensation, will do the work, and the structure is not intended or offered for sale (Sec. 7044, Business and Professional Code: The Contractors License Law does not apply to an owner of property who builds or improves thereon, and who does such work himself or herself or through his/her own employees, provided that such improvements are not intended or offered for sale. If, however, the building or improvement is sold within one year of completion, the owner-builder will have the burden of proving that he/she did not build or improve for the purpose of sale.)

____ I, as owner of the property, am exclusively contracting with licensed contractors to construct the project (Sec. 7044, Business and Professions Code) The Contractors License Law does not apply to an owner of property who builds or improves thereon, and who contracts for such projects with a contractor(s) licensed pursuant to the Contractors License Law).

____ I am exempt under Sec. _____ B & PC for this reason: _____

Date _____ Owner Signature _____

IN ISSUING THIS BUILDING PERMIT, the applicant represents, and the city relies on the representation of the applicant, that the applicant verified all measurements and locations shown on the application or accompanying drawings and that the improvement to be constructed does not violate any law or private agreement relating to permissible or prohibited locations for such improvements. This building permit does not authorize any illegal location of any improvement or the violation of any private agreement relating to location of improvements.

I certify that I have read this application and state that all information is correct. I agree to comply with all city and county ordinances and state laws relating to building construction and herby authorize representative(s) of this city to enter upon the abovementioned property for inspection purposes.

Date 6-30-00 Applicant/Agent Signature Debi Stewer

WORKER'S COMPENSATION DECLARATION: I hereby affirm under penalty of perjury one of the following declarations:

____ I have and will maintain a certificate of consent to self-insure for workers' compensation as provided for by Section 3700 of the Labor Code, for the performance of work for which the permit is issued.

I have and will maintain workers' compensation insurance, as required by Section 3700 of the Labor Code, for the performance of the work for which this permit is issued. My workers' compensation insurance carrier and policy number are:

Carrier AMER. GUAR. & LIAB. INS. Policy Number WC8322096-02 Exp Date 10/01/2000

____ (This section need not be completed if the permit is for \$100 or less) I certify that in the performance of the work for which this permit is issued, I shall not employ any person in any manner so as to become subject to the workers' compensation laws of California and agree that if I should become subject to the workers' compensation provisions of Section 3700 of the Labor Code, I shall forthwith comply with those provisions.

Date 6-30-00 Signature Debi Stewer

WARNING: FAILURE TO SECURE WORKERS' COMPENSATION COVERAGE IS UNLAWFUL AND SHALL SUBJECT AN EMPLOYER TO CRIMINAL PENALTIES AND CIVIL FINES UP TO ONE HUNDRED THOUSAND DOLLARS (\$100,000) IN ADDITION TO THE COST OF COMPENSATION, DAMAGES AS PROVIDED FOR IN SECTION 3706 OF THE LABOR CODE, INTEREST AND ATTORNEY'S FEE.

THIS PERMIT SHALL EXPIRE BY LIMITATION IF WORK IS NOT COMMENCED WITHIN 180 DAYS.

RESIDENTIAL BUILDING PERMIT APPLICATION 0007263

New Construction Addition Remodels Other

Project Address: 5130 Scripps Way Assessor Parcel # 201-0350-019
Lot 19

OWNER INFORMATION:

Legal Property Owner: Center Homes Phone # 786-8693
 Owner Address: 5100 Douglas Blvd #150 City Roseville State CA Zip 95661

CONTRACTOR INFORMATION:

Contractor: Center Homes Lic. # 734094 Phone # 786-8693 Fax# 786-6802

PROJECT INFORMATION:

Land Use Zone RIA Occupancy Group R3 Construction Type VN Fed Code 1A
 No. of stories: 2 No. of rooms: _____ Street width: _____
 1st Floor Area 1209 2nd Floor Area 1365 Basement _____ Roof Material _____

AREA IN SQUARE FOOT OF:

	<u>EXISTING</u>	<u>NEW</u>
Dwelling/Living	_____	<u>2672</u>
Garage/Storage	_____	<u>614</u>
Decks/Balconies	_____	_____
Carports	_____	_____

SCOPE OF WORK: MP 2512 New Home Construction

FOR OFFICE USE ONLY

- | | | |
|---|---|---|
| <input type="checkbox"/> Information above complete | <input type="checkbox"/> AR Flood Waiver required | <input type="checkbox"/> Planning Approval |
| <input type="checkbox"/> Violation files checked | <input type="checkbox"/> Flood Elevation Certificate Required | <input type="checkbox"/> Design Review Approval |
| <input type="checkbox"/> Standard setbacks | <input type="checkbox"/> Water Development Infill Area | <input type="checkbox"/> Special Fee Districts Apply: _____ |
| <input type="checkbox"/> County Sewer | | |

NEW STRUCTURES & ADDITIONS

❖ THE FOLLOWING MUST BE PROVIDED IN ORDER TO SUBMIT FOR PLAN REVIEW

- | | |
|---|---|
| <input type="checkbox"/> 2 COMPLETE PLANS, LEGIBLE & DRAWN TO SCALE | ❖ Plans to include: site plan, floor plan, elevations, roof/ceiling plan, foundation and structural framing details, and structural calculations for non-conforming structures. |
| <input type="checkbox"/> 3 SETS IF PROJECT IS IN A DESIGN REVIEW AREA | |
| <input type="checkbox"/> Title 24 Energy Compliance documentation | <input type="checkbox"/> 11" x 17" copy of floor plan for County Assessor |
| <input type="checkbox"/> Grading and Erosion Control Questionnaire | <input type="checkbox"/> Plan Review Fees |

Date: _____ Received by: (staff) _____

ACTIVITY/PERMIT #

INSULATION CERTIFICATE

THIS IS TO CERTIFY THAT INSULATION HAS BEEN INSTALLED IN CONFORMANCE WITH THE CURRENT ENERGY REGULATIONS, CALIFORNIA ADMINISTRATION CODE, TITLE 24, STATE OF CALIFORNIA, IN THE BUILDING LOCATED AT:

SITE ADDRESS: Lot 19 Northborough Sacramento, CA
NUMBER STREET CITY STATE

CEILING:

BLOW: Manufacturer Greenstone Thickness 10.3" R/Value 38
Square Feet 1389 # Bags/Lbs. per bags 56

BATTS: Manufacturer Johns Manville Thickness 13" R/Value 38

EXTERIOR WALLS:

Thickness 3.5" R/Value 13
Manufacturer Johns Manville Thickness 6.25" R/Value 19

FLOOR INSULATION:

Manufacturer _____ Thickness _____ R/Value _____

AIR INFILTRATION: (TITLE 24)

Yes XX No _____

OTHER: _____

GENERAL CONTRACTOR: Centex Homes LIC. # _____

BY: _____ TITLE _____ DATE _____

INSULATION CONTRACTOR: Western Insulation, Inc. LIC. # 481278

BY: James Blair TITLE Auth. Agent DATE 10/26/00

Lot Area = 6,715 sf
 Building Footprint = 1,966 sf
 Gross Coverage = 29.3%
 Porch Allowance = 43 sf
 Net Coverage = 28.6%

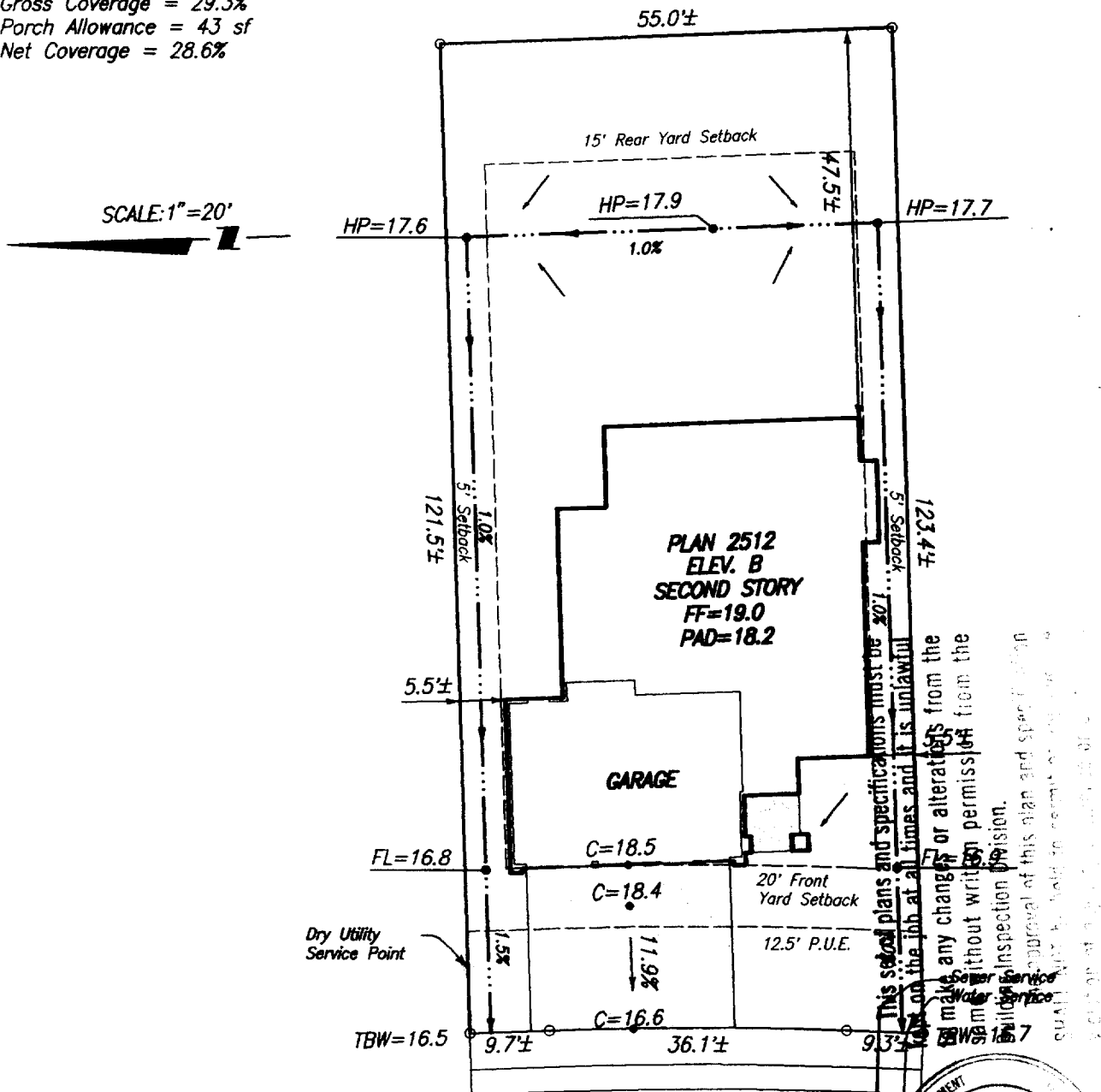

S130

SEAGLENN WAY

All proposed plans and specifications must be submitted to the City of Sacramento for review and approval. Any changes or alterations must be approved by the City Engineer. This plan is subject to the provisions of the City Code and the State Building Code.

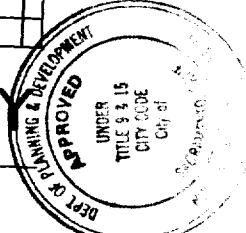

Plot Plan for Lot 19
 Northborough Village 5-1
 City of Sacramento

Centex Homes
 3700 Douglas Blvd., Suite 150
 Roseville, CA 95661
 Ph.: (916) 786-8693

Plan 2512 Elev. B
 Centex Review & Approval:
 By: SA Date: 6/16

Note:
 This plot plan has been prepared for the purpose of showing the building foundation relationship to the property line, proposed drainage elevations and direction of flow to conform to local ordinances and for the purpose of building permit issuance. Information shown is approximate except for those setbacks which are minimums required by ordinance. This plot does not reflect as-built conditions which will likely vary from this plan.

**Murray Smith & Associates
 Engineering, Inc.**
 3110 Gold Canal Drive
 Rancho Cordova, CA 95670
 Ph.: (916) 635-1511

May 31, 2000

PN: 99008

Norman

Scheel

Structural

Engineer

Sacramento

6939 Sunrise Blvd. #123
Citrus Heights, CA 95610
(916) 726-0612
(916) 726-3189 (fax)

NORMAN SCHEEL
Structural Engineer
Email: norm@nss.com

ROBERT COON
Project Manager
Email: rob@nss.com

PAULO IBANEZ
Project Manager
Email: paulo@nss.com

TIM SLOAN
Project Manager
Email: tim@nss.com

CASANDRA COURTILLET
Design Engineer
Email: cassandra@nss.com

MARY PHUNG
Design Engineer
Email: mary@nss.com

STEVE COOKSEY
CAD Supervisor
Email: steve@nss.com

STACY MARLIN
Office Manager
Email: stacy@nss.com

Davis
213 E Street Suite B
Davis, CA 95616
(530)753-5300
(530)753-5380(fax)

TRACY HARRIS P.E.
Project Engineer
Email: tracy@nss.com

DARRELL PEREIRA
Design Engineer
Email: darrell@nss.com

September 27, 2000

Centex Homes
3700 Douglas Blvd., Suite 150
Roseville, CA 95661

Re: Northborough – Plan 2512 Inspection Responses (Job #99028)

To whom it may concern:

This letter is to verify that this office has addressed the following items:

1. Please see the attached detail for the connection from the double drag joist to the rim board.
2. Please see the attached detail for the repair of the TJI joist with a notched bottom chord.
3. Beam #7 may have a 4x4 post installed at each end.

If there are further questions, please contact Tim Sloan at (916) 726-0612.

NORMAN SCHEEL
STRUCTURAL ENGINEER

Enclosures: 2 details

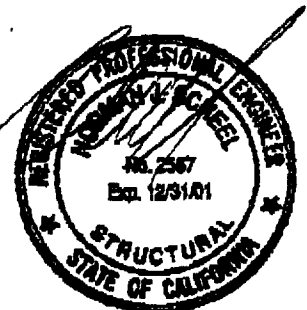

**NORMAN SCHEEL
STRUCTURAL ENGINEER**

6939 Sunrise Blvd. Suite 123
Citrus Heights, CA 95610

JOB PLAN 2512

CLIENT _____ DATE _____

JOB NO. 99028 BY _____ SHEET NO. _____

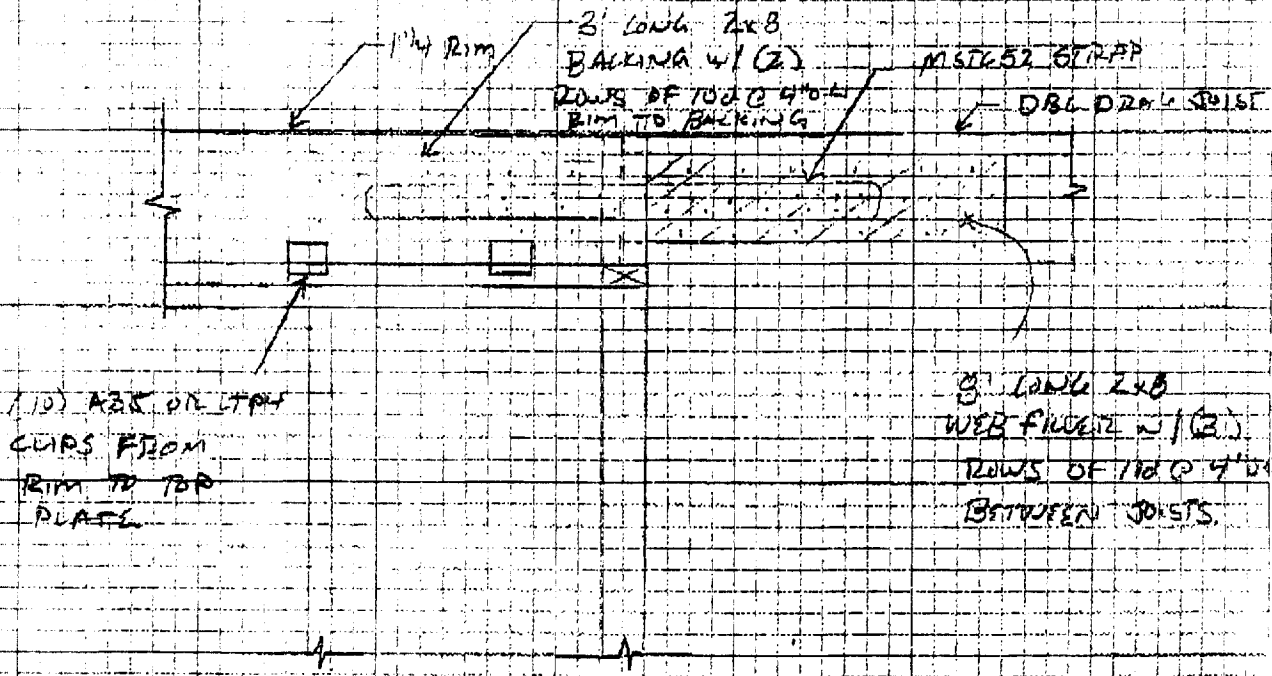

SCHHEEL
STRUCTURAL ENGINEER
839 Sunrise Blvd. Suite 123
Citrus Heights, CA 95610

JOB PLAN 2512

CLIENT _____ DATE _____

JOB NO. 99023 BY _____

SHEET NO. _____

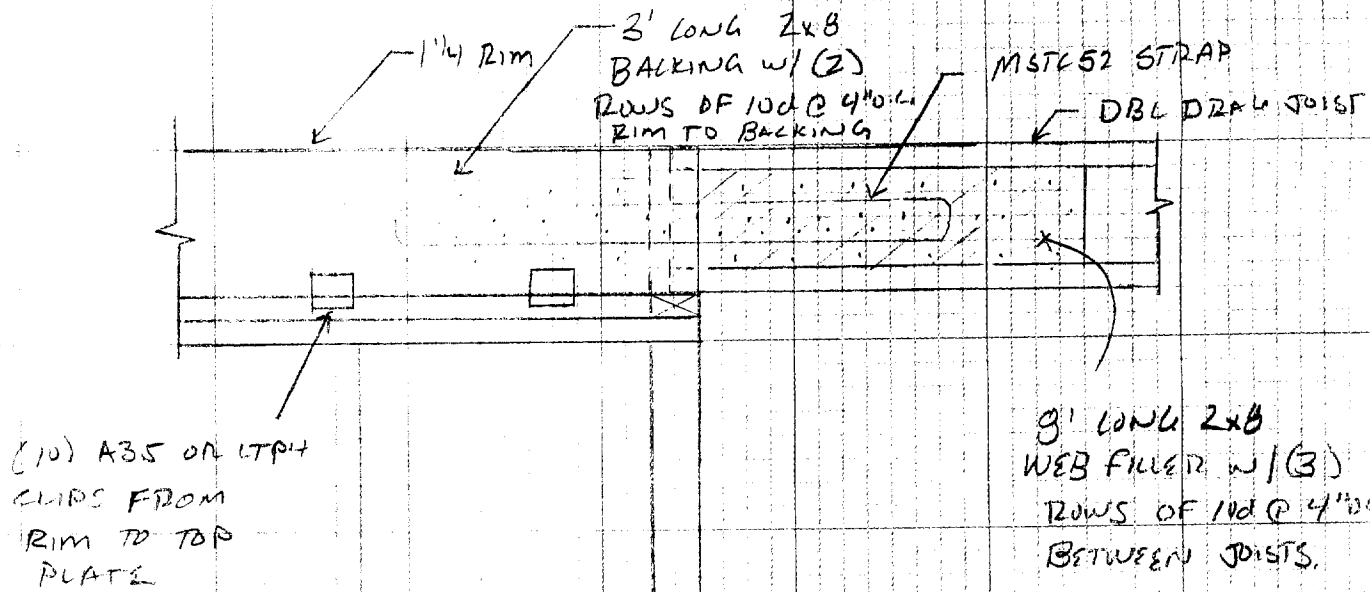

○ DRAG STRAP CONNECTION