

**CITY OF SACRAMENTO**

1231 I Street, Sacramento, CA 95814

**Permit No: 0007601**

**Insp Area: 4**

**Site Address: 1111 FEE DR SAC**

Parcel No: 277-0241-027

Sub-Type: COM

Housing (Y/N): N

**CONTRACTOR**

WAGNER ENGINEERING CORP  
3309 WHITE OAK CT  
SACRAMENTO, CA 95864

**OWNER**

LABRIE THOMAS R  
1908  
SACRAMENTO CA 95815

**ARCHITECT**

**Nature of Work: INSTALL NEW ELECT. SERVICE TO BILLBOARD SIGN**

**CONSTRUCTION LENDING AGENCY:** I hereby affirm under penalty of perjury that there is a construction lending agency for the performance of the work for which this permit is issued (Sec. 3097, Civ. C).

Lender's Name \_\_\_\_\_ Lender's Address \_\_\_\_\_

**LICENSED CONTRACTORS DECLARATION:** I hereby affirm under penalty of perjury that I am licensed under provisions of Chapter 9 (commencing with section 7000) of Division 3 of the Business and Professions Code and my license is in full force and effect.

License Class A License Number 282049 Date 7-24-2000 Contractor Signature [Signature]

**OWNER-BUILDER DECLARATION:** I hereby affirm under penalty of perjury that I am exempt from the contractors License Law for the following reason (Sec. 7031.5, Business and Professions Code; any city or county which requires a permit to construct, alter, improve, demolish, or repair any structure, prior to its issuance, also requires the applicant for such permit to file a signed statement that he or she is licensed pursuant to the provisions of the Contractors License Law (Chapter 9 (commencing with Section 7000) of Division 8 of the Business and Professions Code) or that he or she is exempt therefrom and the basis for the alleged exemption. Any violation of Section 7031.5 by any applicant for a permit subjects the applicant to a civil penalty of not more than five hundred dollars (\$500.00):

\_\_\_\_ I, as a owner of the property, or my employees with wages as their sole compensation, will do the work, and the structure is not intended or offered for sale (Sec. 7044, Business and Professional Code: The Contractors License Law does not apply to an owner of property who builds or improves thereon, and who does such work himself or herself or through his/her own employees, provided that such improvements are not intended or offered for sale. If, however, the building or improvement is sold within one year of completion, the owner-builder will have the burden of proving that he/she did not build or improve for the purpose of sale.)

\_\_\_\_ I, as owner of the property, am exclusively contracting with licensed contractors to construct the project (Sec. 7044, Business and Professions Code: The Contractors License Law does not apply to an owner of property who builds or improves thereon, and who contracts for such projects with a contractor(s) licensed pursuant to the Contractors License Law).

\_\_\_\_ I am exempt under Sec. \_\_\_\_\_ B & PC for this reason: \_\_\_\_\_

Date \_\_\_\_\_ Owner Signature \_\_\_\_\_

**IN ISSUING THIS BUILDING PERMIT,** the applicant represents, and the city relies on the representation of the applicant, that the applicant verified all measurements and locations shown on the application or accompanying drawings and that the improvement to be constructed does not violate any law or private agreement relating to permissible or prohibited locations for such improvements. This building permit does not authorize any illegal location of any improvement or the violation of any private agreement relating to location of improvements.

I certify that I have read this application and state that all information is correct. I agree to comply with all city and county ordinances and state laws relating to building construction and hereby authorize representative(s) of this city to enter upon the above-mentioned property for inspection purposes.

Date 7-24-2000 Applicant/Agent Signature [Signature]

**WORKER'S COMPENSATION DECLARATION:** I hereby affirm under penalty of perjury one of the following declarations:

\_\_\_\_ I have and will maintain a certificate of consent to self-insure for workers' compensation as provided for by Section 3700 of the Labor Code, for the performance of work for which the permit is issued.

[Signature] have and will maintain workers' compensation insurance, as required by Section 3700 of the Labor Code, for the performance of the work for which this permit is issued. My workers' compensation insurance carrier and policy number are:

Carrier STATE COMPENSATION INS FUND Policy Number 1205378-00 Exp Date 07/01/2001

\_\_\_\_ (This section need not be completed if the permit is for \$100 or less) I certify that in the performance of the work for which this permit is issued, I shall not employ any person in any manner so as to become subject to the workers' compensation laws of California and agree that if I should become subject to the workers' compensation provisions of Section 3700 of the Labor Code, I shall forthwith comply with those provisions.

Date 7-24-2000 Applicant Signature [Signature]

**WARNING** FAILURE TO SECURE WORKER'S COMPENSATION COVERAGE IS UNLAWFUL AND SHALL SUBJECT AN EMPLOYER TO CRIMINAL PENALTIES AND CIVIL FINES UP TO ONE HUNDRED THOUSAND DOLLARS (\$100,000) IN ADDITION TO THE COST OF COMPENSATION, DAMAGES AS PROVIDED FOR IN SECTION 3706 OF THE LABOR CODE, INTEREST AND ATTORNEY'S FEE.

**THIS PERMIT SHALL EXPIRE BY LIMITATION IF WORK IS NOT COMMENCED WITHIN 180 DAYS.**

**APPROVED PER 1996**  
**NATIONAL ELECTRICAL CODE**  
**AND CITY OF SACRAMENTO**  
**AMENDMENTS:**  
**T.L.M. 01-03-01**  
**ELECTRICAL DIVISION**

1111 Fee Drive  
 Sacramento, Ca

The approval of all  
 Electrical work is subject to field  
 inspections

Revision to  
 Permit 0007601

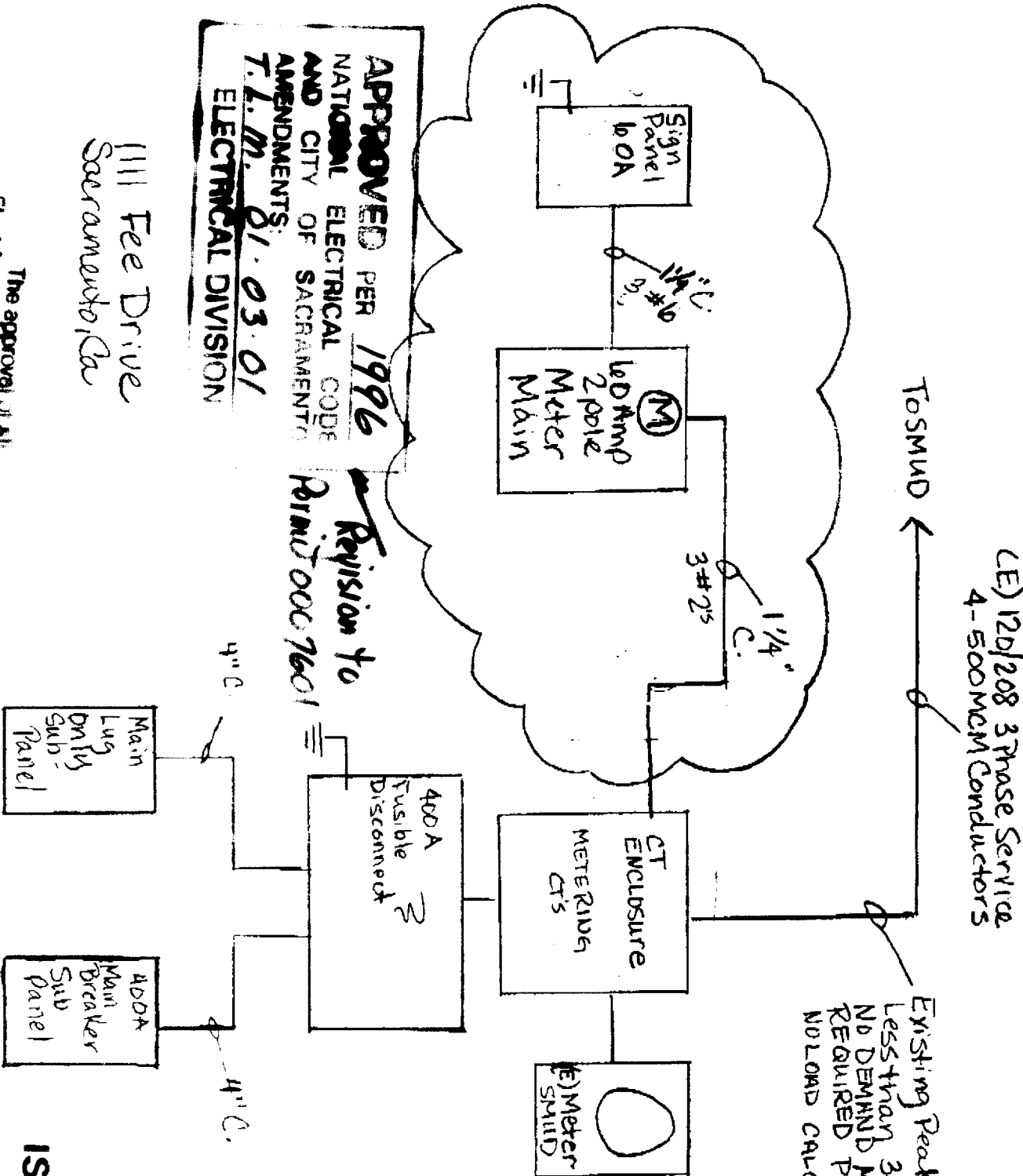

CE) 1201208 3 Phase Service  
 4-500MCM Conductors

Existing Peak Load  
 Less than 30 KW  
 NO DEMAND METER  
 REQUIRED PER SMUD  
 NO LOAD CALCS AVAIL.

This set of plans and specifications must be kept on the job at all times and it is unlawful to make any changes or alterations from the same without written permission from the Building Inspection Division.  
 The approval of this plan and specification SHALL NOT be held to permit or approve the violation of any City Ordinance or State Law.

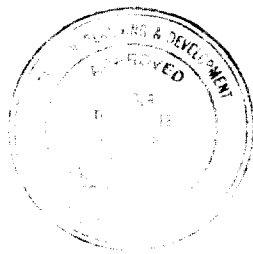

**ISSUED**

JAN 03 2001

Sacramento Building Division

Revised 12/18  
Sheet E2

THESE CHANGES WERE MADE  
BY THE ELECTRICAL ENGINEER  
ON 12/18/00

1111 Fee Drive

JAN 03 2001

ISSUED

Sacramento Building Division

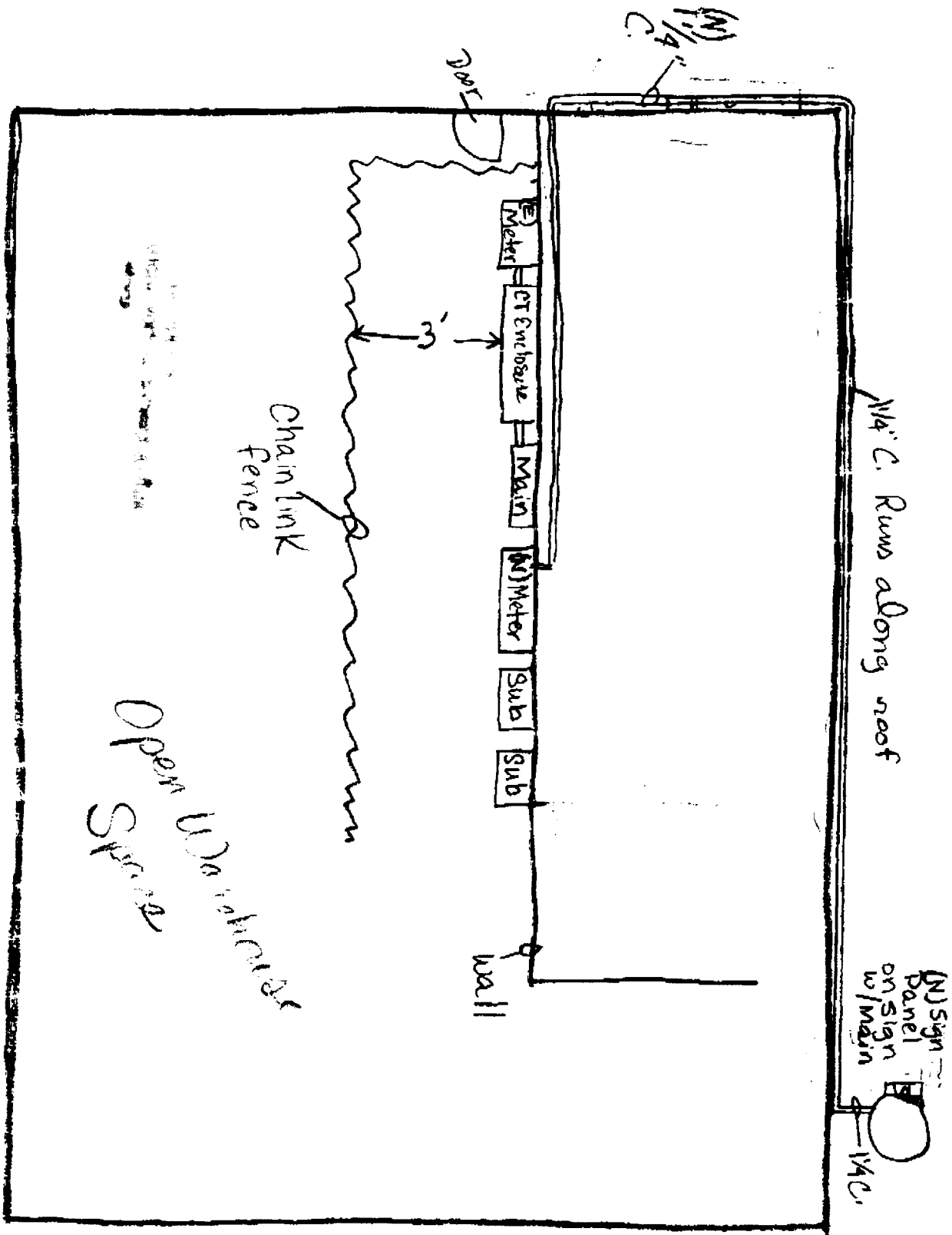

120/240 NEMA 3R PANEL		80 AMP MAIN BREAKERS						ITEM
ITEM	AMP	POLE	CKT 1	CKT 2	POLE	AMP	ITEM	
SWITCHED SIGN LIGHTS	20	2	1	2	3	20	SWITCHED SIGN LIGHTS	
UNSWITCHED OUTLETS	20	1	3	4	8	1	UNSWITCHED OUTLET	
TIME CLOCK POWER			5	6	20			
			7	8				
			9	10				

Provide W.P. Outlet covers that protect from weather while in use

PLACER WILL BE INSTALLING ELECTRICAL SERVICE TO A NEW BILLIARD SIGN AT THIS LOCATION.

THE MAIN PANEL IS A NEMA 3R UL LISTED ENCLOSURE, AND WE HAVE INCLUDED CUT SHEETS FOR THE LIGHTS THAT WILL BE INSTALLED.

The approval of all Electrical work is subject to field inspections

1996  
 T.L.M. 7-5-00  
 ELECTRICAL DIVISION

0007601

Sacramento Building Division

JAN 03 2001

ISSUED

Page 1 of 6

ELLER MEDIA FREEWAY SIGN  
 111 Fee Drive  
 SACRAMENTO, CA

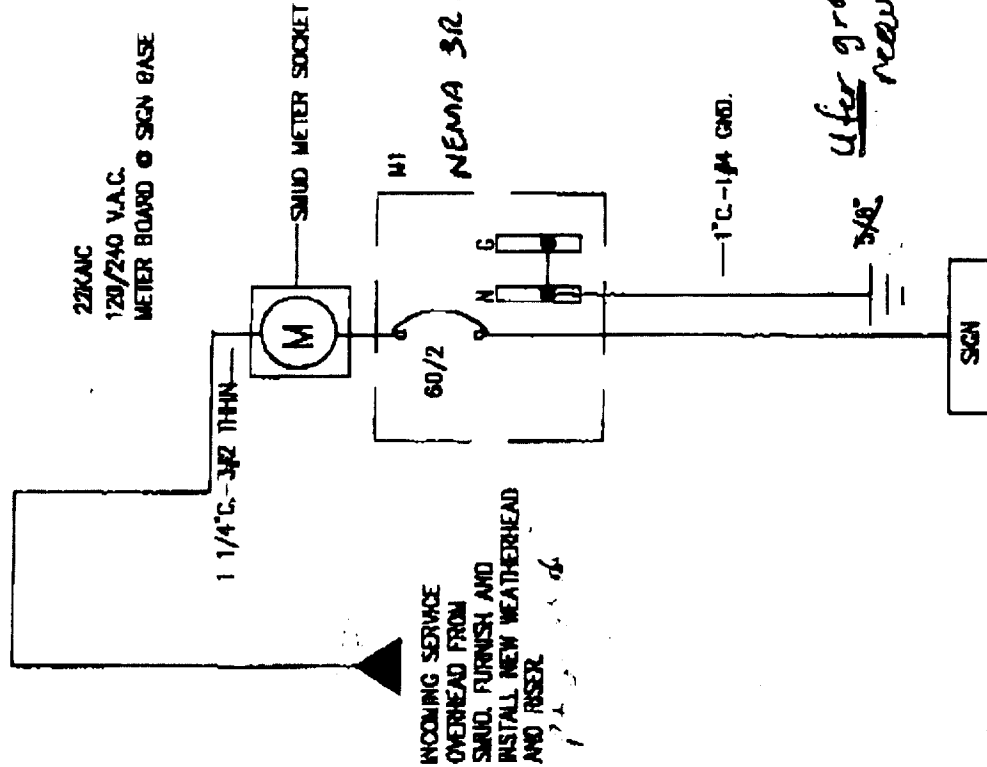

INCOMING SERVICE  
 OVERHEAD FROM  
 SMUD. FURNISH AND  
 INSTALL NEW WEATHERHEAD  
 AND RISER.

NEMA 3R ENCLOSURE

1" C-1/4" GND.

*After ground required*

ELECTRICAL LOAD CALC. - M1	
LOAD	KVA
LIGHTING: TOTAL	8.0
25% LIGHTING CONTINUOUS LOAD:	2.48
MISCELLANEOUS:	2.00
TOTAL KVA:	12.48
14.4 KVA @ 240V, 1Ph. = 52 A.	

*8 Light @*

The approval of all  
 Electrical work is subject to field  
 inspections

W.P. Covers to be the type that protects the outlet when in use.

W.P. COVERS TYP FOR ALL

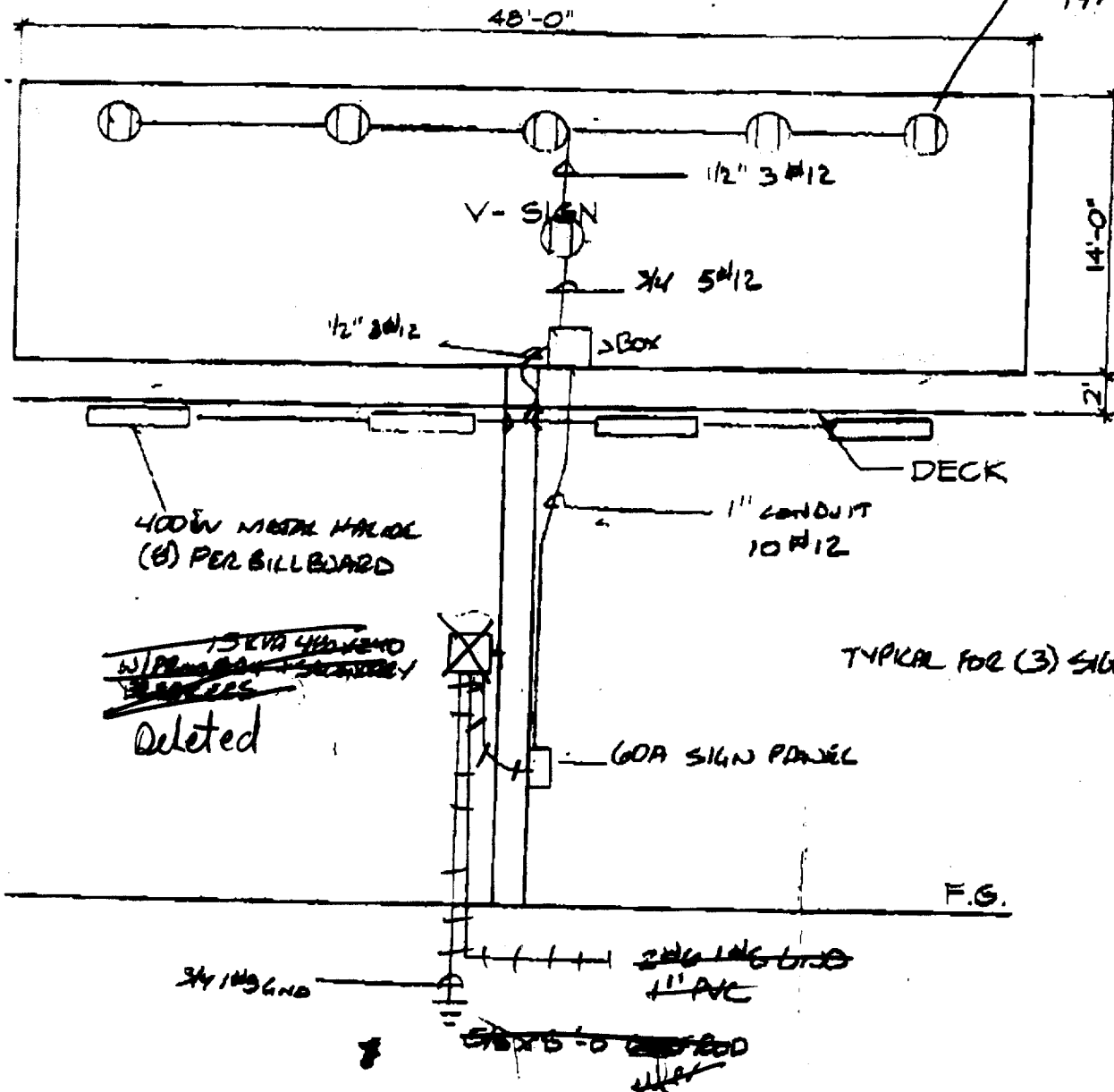

The approval of all Electrical work is subject to field inspections

1  
S-1

# V-SIGN (DOUBLE SIDED SIGN)

NTB

SIGN PANEL AT BASE OF EACH SIGN

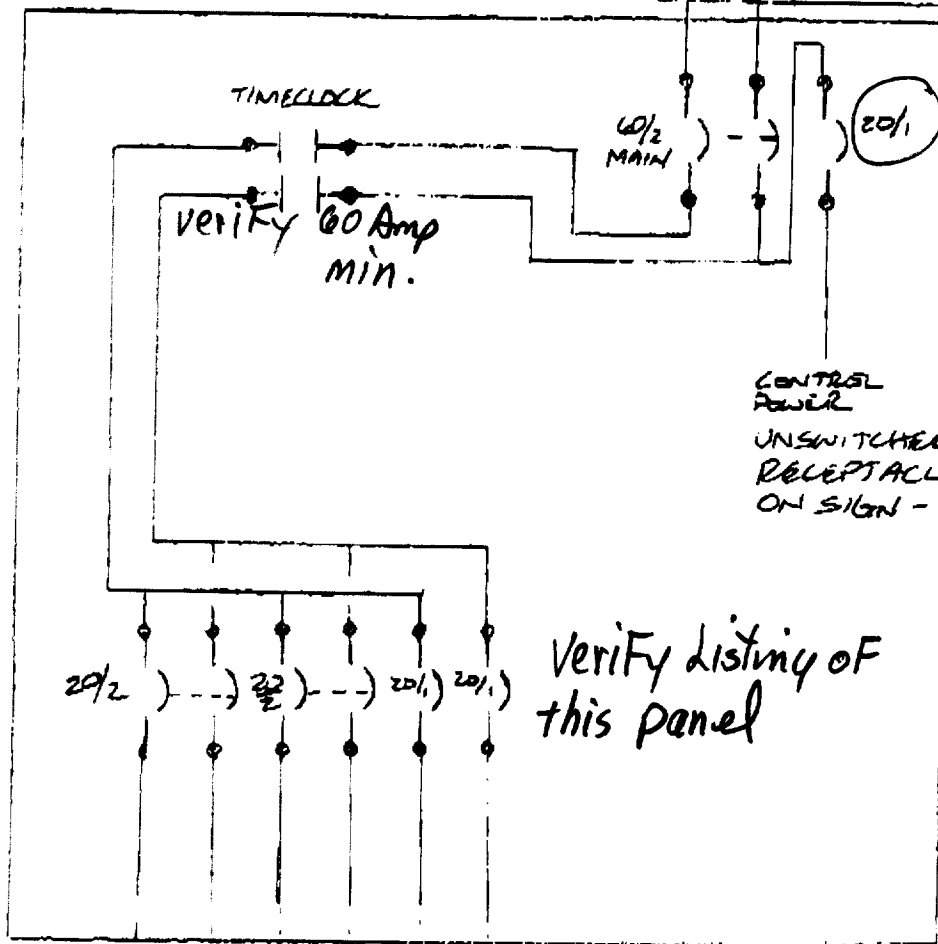

3#6 TO TRANSFORMER

CONTROL POWER  
UNSWITCHED RECEPTACLES ON SIGN -

NEMA 3R ENCLOSURE

Verify listing of this panel

SWITCHED LIGHTS  
 SWITCHED LIGHTS  
 SWITCHED LIGHTS  
 SWITCHED RECEPTACLES

The approval of all Electrical work is subject to field inspections

Page 4 of 6





# *Expresslite*<sup>®</sup>

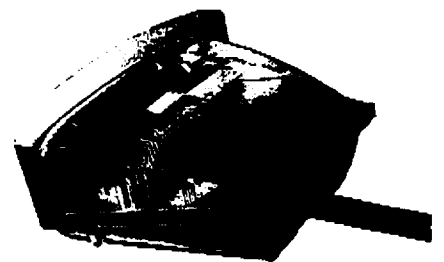
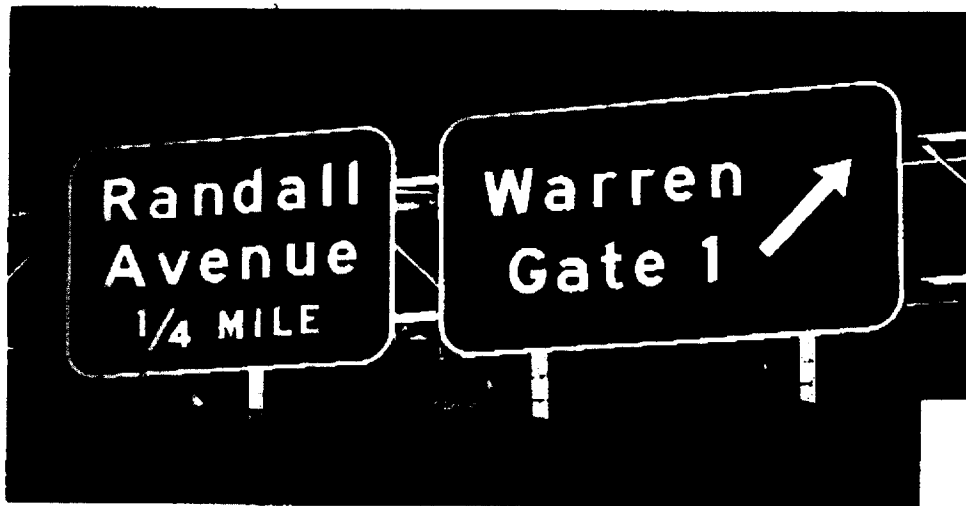

**Low profile**

— Shallow profile design provides a clean, clutter-free look that will not obstruct message visibility.

**Better uniformity**

— Precise optical design and efficient HID lamps provide more uniform illumination over the entire sign than fluorescent or halogen.

**Economical**

— Widespread distribution with spacings up to 14' means fewer fixtures and less installation and maintenance costs.

**Minimizes glare**

— Integral shielding minimizes back light from the fixture and an optional side shield reduces side light if required.

**Copper free die cast housing**

— Assures long life in coastal areas or where salt is a problem.

**Seven-stage pretreatment/poly-ester powder paint**

— Long term corrosion protection.

**UL Listed**

— UL listed 1572, wet location.

**Holophane Mission Statement.**

*[Faded text in a dark box, likely the Holophane Mission Statement]*

The approval of all  
Electrical work is subject to field  
inspections

**HOLOPHANE**