

CITY OF SACRAMENTO
1231 I Street, Sacramento, CA 95814

Permit No: 0013241
Insp Area: 1

Site Address: 1321 KONDOS AV SAC
Parcel No: 006-0284-036

CAPITOL PARK HOMES LOT 26
Sub-Type: NSFR
Housing (Y/N): N

CONTRACTOR
CAPITOL PARK HOMES
518 19TH ST STE 200
SACRAMENTO CA 95814

OWNER

ARCHITECT

Nature of Work: MP 1448 3 STORY 7 ROOM SFR

CONSTRUCTION LENDING AGENCY: I hereby affirm under penalty of perjury that there is a construction lending agency for the performance of the work for which this permit is issued (Sec. 3097, C.C.P.C.)

Lender's Name _____ Lender's Address _____

LICENSED CONTRACTORS DECLARATION: I hereby affirm under penalty of perjury that I am licensed under provisions of Chapter 9 (commencing with section 7000) of Division 8 of the Business and Professions Code and my license is in full force and effect.

License Class B License Number 767067 Date 4-19-01 Contractor Signature [Signature]

OWNER-BUILDER DECLARATION: I hereby affirm under penalty of perjury that I am exempt from the contractors License Law for the following reason (Sec. 7031.5, Business and Professions Code): any city or county which requires a permit to construct, alter, improve, demolish, or repair any structure, prior to its issuance, also requires the applicant for such permit to file a signed statement that he or she is licensed pursuant to the provisions of the Contractors License Law (Chapter 9 (commencing with Section 7000) of Division 8 of the Business and Professions Code) or that he or she is exempt therefrom and the basis for the alleged exemption. Any violation of Section 7031.5 by any applicant for a permit subjects the applicant to a civil penalty of not more than five hundred dollars (\$500.00):

____ I, as a owner of the property, or my employees with wages as their sole compensation, will do the work, and the structure is not intended or offered for sale (Sec. 7044, Business and Professions Code). The Contractors License Law does not apply to an owner of property who builds or improves thereon, and who does such work himself or herself or through his/her own employees, provided that such improvements are not intended or offered for sale. If, however, the building or improvement is sold within one year of completion, the owner-builder will have the burden of proving that he/she did not build or improve for the purpose of sale.

____ I, as owner of the property, am exclusively contracting with licensed contractors to construct the project (Sec. 7044, Business and Professions Code). The Contractors License Law does not apply to an owner of property who builds or improves thereon, and who contracts for such projects with a contractor(s) licensed pursuant to the Contractors License Law.

I am exempt under Sec. _____ B & PC for this reason: _____

Date _____ Owner Signature _____

IN ISSUING THIS BUILDING PERMIT, the applicant represents, and the city relies on the representation of the applicant, that the applicant verified all measurements and locations shown on the application or accompanying drawings and that the improvement to be constructed does not violate any law or private agreement relating to permissible or prohibited locations for such improvements. This building permit does not authorize any illegal location of any improvement or the violation of any private agreement relating to location of improvements.

I certify that I have read this application and state that all information is correct. I agree to comply with all city and county ordinances and state laws relating to building construction and hereby authorize representative(s) of this city to enter upon the abovementioned property for inspection purposes.

Date 4-19-01 Applicant/Agent Signature [Signature]

WORKER'S COMPENSATION DECLARATION: I hereby affirm under penalty of perjury one of the following declarations:

____ I have and will maintain a certificate of consent to self-insure for workers' compensation as provided for by Section 3700 of the Labor Code, for the performance of work for which the permit is issued.

____ I have and will maintain workers' compensation insurance, as required by Section 3700 of the Labor Code, for the performance of the work for which this permit is issued. My workers' compensation insurance carrier and policy number are:

Carrier Binder Policy Number NEIGHBORHOODS AND ENVIRONMENT SERVICES Exp Date _____

____ (This section need not be completed if the permit is for \$100 or less) I certify that in the performance of the work for which this permit is issued, I shall not employ any person in any manner so as to become subject to the workers' compensation laws of California and agree that if I should become subject to the workers' compensation provisions of Section 3700 of the Labor Code, I shall forthwith comply with those provisions.

Date 4-19-01 Applicant Signature [Signature]

WARNING: FAILURE TO SECURE WORKER'S COMPENSATION COVERAGE IS UNLAWFUL AND SHALL SUBJECT AN EMPLOYER TO CRIMINAL PENALTIES AND CIVIL FINES UP TO ONE HUNDRED THOUSAND DOLLARS (\$100,000) IN ADDITION TO THE COST OF COMPENSATION, DAMAGES AS PROVIDED FOR IN SECTION 3706 OF THE LABOR CODE, INTEREST AND ATTORNEY'S FEE.

THIS PERMIT SHALL EXPIRE BY LIMITATION IF WORK IS NOT COMMENCED WITHIN 180 DAYS.

CERTIFICATION OF INSULATION

CNM CONST

LOT # 260

- P.O. BOX 854, WEST SACRAMENTO, CA 95601 LIC. #200000
- 1309 MELODY ROAD, MARYSVILLE, CA 95901 LIC. #200000
- P.O. BOX 9651, FRESNO, CA 93793-9651 LIC. #202026
- P.O. BOX 1831, RENO, NV 89505 LIC. #10675
- 3326 A PONDEROSA WAY, LAS VEGAS, NV 89118 LIC. #10675

CURTAIN WALL HOMES

DATE INSULATION COMPLETED 12-28-01

WALLS (SQUARE FEET)	CEILING (SQUARE FEET)	FLOORS (SQUARE FEET)
MATERIAL FIBERGLASS	MATERIAL FIBERGLASS	MATERIAL FIBERGLASS
FORM BATTS	FORM BATTS & BLOW	FORM BATTS
MANUFACTURER'S PRODUCT I.D.	MANUFACTURER'S PRODUCT I.D.	MANUFACTURER'S PRODUCT I.D.
OCF	OCF BAGS	OCF
INSTALLED	THICKNESS	APPROXIMATE SQUARE FOOT
13	3 3/4"	30
		9'

MATERIAL FIBERGLASS	FORM BATTS	R VALUE	MANUFACTURER OCF
MATERIAL FOAM		MANUFACTURER W R GRACE	

THIS IS TO CERTIFY THAT THE ABOVE AND/OR SEALS ARE INSULATED ACCORDING TO THE REQUIREMENTS WITH THE FOLLOWING MATERIALS:		
SIGNATURE - INSULATION CONTRACTOR <i>Jeff Cobb</i>	TITLE MANAGER	DATE 12-31-01
SIGNATURE - GENERAL CONTRACTOR	TITLE	DATE

REMARKS

Certification of Compliance School District Development

Part I - To be completed by the APPLICANT

Owner's Name/Address SHASTA DUN TUN SINGLE FAMILY DEV LLC
 Project Address 1321 KENLIS AVE
 Parcel Number 0060-0284-006 Lot No. 26
 Subdivision Name CAPITOL PARK HOMES No. of Units _____
 Applicant's Signature [Signature] Title PM
 Phone No. 762-4801 Date 4-5-01

Notice to Applicant: Pursuant to Government Code Section 66020(d), this will serve to notify you that the 90-day approval period in which you may protest the fees or other payment identified above will begin to run on the date in which the building or installation permit for this project is issued or on which they are paid to the district(s) or to another public entity authorized to collect them on behalf of the district(s), whichever is earlier.

Part II - To be completed by the BUILDING DEPARTMENT

Plan Identification Number 1609
 Building Type (check one) Residential Apartment/Condominium Commercial/Industrial
 Square Feet of Chargeable Building Area 1609
 Signature/Title [Signature] Date 4-5-01

Part III - To be completed by the SCHOOL DISTRICT

School District 76050 Certificate No. 7039
 Exempt Comments \$452.22 per unit - SCC attachment A
 Residential/Apartment/etc. _____ Square ft. x \$ 1.72 = \$ 452.22
 Commercial/Industrial _____ Square ft. x \$ _____ = \$ _____
 Total fees collected 11 # 49724 = \$ 452.22

This certification covers only the amount of square footage indicated above. Any additions or corrections to the square footage for this project will require an amendment to the Certificate of Compliance.

As the authorized school official, I hereby certify that the requirements of Government Code Section 65995 and any other authorized requirements have been complied with by the above signed applicant.

Signature [Signature] Date 4/12/01

0013241

PLAN 2

RESIDENTIAL SUBDIVISION BUILDING PERMIT APPLICATION

Project Address: 1321 Kondos Ave. Assessor Parcel # 006-0284-036
 Lot Number: 26 Subdivision CAPITOL PARK HOMES

OWNER INFORMATION:

Legal Property Owner: SHASTA/DOWNTOWN SINGLE FAMI Phone# 449-8989
 Owner Address: 818 19th ST City SACRAMENTO State CA Zip 95814

CONTRACTOR INFORMATION:

Contractor: CNM CONST. Lic. # 767087 Phone # 449-8989 Fax 449-8865

PROJECT INFORMATION:

Land Use Zone R1A Occupancy Group R3 Construction Type VN Fed Code 1A
 No. of Stories: 3 No. of Rooms: 9 Street Width: 20
 1st Floor Area 998 2nd Floor Area 432 Basement - Roof Material COMP

AREA IN SQUARE FOOT OF:

Dwelling/Living 1430
 Garage/Storage 626/355
 Decks/Balconies 91
 Carports -

SCOPE OF WORK: NEW SINGLE FAMILY RESIDENCE

FOR OFFICE USE ONLY

- | | | |
|---|---|---|
| <input type="checkbox"/> Information Above Complete | <input type="checkbox"/> AR Flood Waiver Required | <input type="checkbox"/> Planning Approval |
| <input type="checkbox"/> Violation Files Checked | <input type="checkbox"/> Flood Elevation Certificate Required | <input type="checkbox"/> Design Review Approval |
| <input type="checkbox"/> Standard Setbacks | <input type="checkbox"/> Water Development Infill Area | <input type="checkbox"/> Special Fee Districts Apply: |
| <input type="checkbox"/> County Sewer | | |

THE FOLLOWING MUST BE PROVIDED IN ORDER TO SUBMIT FOR PERMIT

- 2 COMPLETE PLOT PLANS, LEGIBLE & DRAWN TO SCALE
- 11 X 17 COPY OF FLOOR PLAN WITH FOLLOWING INFORMATION

a) Assessor's Parcel Number	c) Owners Name
b) New Floor Area	d) Project Address

Date: _____ Received by: (staff) _____ Permit # _____

MOTOR COURT B

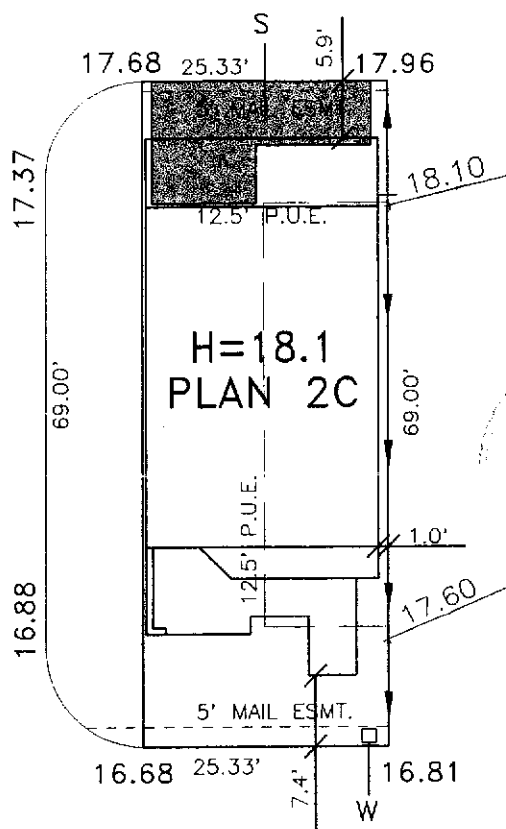

KONDOS AVENUE



NOTE:

This plan is only intended to reference the building plan designated for this lot. All setbacks other than minimum code requirements are approximate. The "as-built" field condition may vary from this plan.

DATE: 10-10-00
 A.P.N.: 006-2840-036
 ADDRESS: 1321 KONDOS

LOT AREA: 1,747 SF
 LOT COVERAGE: 61%

The Spink Corporation
 2590 VENTURE OAKS WAY
 SACRAMENTO, CA. 95833
 PH (916)925-5550 FAX (916)921-9274

CAPITOL PARK
 LOT 26
 PLAN 2C

CAPITOL PARK
 CITY OF SACRAMENTO, CA
 CLIENT: CNM CONSTRUCTION
 JOB NO.: 1222-002