



# REPORT TO COUNCIL

## City of Sacramento

915 I Street, Sacramento, CA 95814-2604  
www.CityofSacramento.org

**CONSENT**  
**May 6, 2008**

**Honorable Mayor and  
Members of the City Council**

**Title: Burberry Park Phase 2 (LT19, L19111001)**

**Location/Council District:** 2400 Burberry Drive/Council District 1

**Recommendation:** Adopt a **Resolution** appropriating \$875,000 of Park Development Impact Fee (PIF), Fund 791 (3204), to the project.

**Contact:** J.P. Tindell, Park Planning and Development Manager, 808-1955

**Presenters:** Not applicable

**Department:** Parks and Recreation

**Division:** Park Planning & Development Services

**Organization No:** 4727

### **Description/Analysis**

**Issue:** Burberry Park is 11.8 acre park located at Northborough Drive and Club Center Drive in North Natomas. It is requested that funds be appropriated from PIF, Fund 791 (3204), in the amount of \$875,000 to LT19, L19111001. The scope of the park improvements scheduled to begin in 2009 has increased and additional funding is needed.

A summary of the Burberry Park project history is included as Attachment 1 (page 4) and an area map as Attachment 2 (page 5).

**Policy Considerations:** Utilizing Park Development Impact Fees to augment this budget is consistent with Sacramento City Code Section 16.64.060 as these funds will be used for the "...improvement, and expansion of the public parks, playgrounds and recreational facilities."

Providing parks and recreation facilities is consistent with the City's strategic plan to enhance livability in Sacramento's neighborhoods by expanding park, recreation, and trail facilities throughout the City.

This is part of the Park Development Process for park planning as stated in the *2005-2010 Parks and Recreation Master Plan*.

**Committee/Commission Action:** The Burberry Park name and master plan (Attachment 3, page 6) were reviewed and supported by the Parks and Recreation Commission (PRC) on December 20, 2000. The name change was approved on September 5, 2002.

**Environmental Considerations:** This report concerns administrative activities that will not have a significant effect on the environment, and does not constitute a "project" as defined by the California Environmental Quality Act (CEQA) [CEQA Guidelines Sections 15061(b)(3); 15378(b)(2)].

**Rationale for Recommendation:** Burberry Park is a project which will address the needs of North Natomas as stated in the 2006 Parks and Recreation Programming Guide (PRPG). The scope of improvements scheduled to begin in 2009 has increased and additional funding is needed. The current scope for Phase 2 includes a remodel of the natural area (including infrastructure), a restroom, and tennis courts. The original Phase 2 budget did not take into account the extent of the changes (a complete revision) to the natural area or the costs associated with it.

**Financial Considerations:** Staff recommends that the City Council appropriate \$875,000 from PIF, Fund 791 (3204), to LT19, L19111001. There are adequate funds in PIF, Community Planning Area 10, to appropriate funds for the Burberry Park Phase 2 project. Other funding for this park (\$400,000) comes from the Quimby Act Fees, Fund 710 (2508).

**Emerging Small Business Development (ESBD):** The selection of landscape architect consultants and contractors for this project will follow City established guidelines for inclusion of ESBD firms.

Respectfully Submitted by:

  
JAMES L. COMBS  
Director, Parks and Recreation

Recommendation Approved:

  
for RAY KERRIDGE  
City Manager

**Table of Contents:**

Report	pg. 1
<b>Attachments</b>	
1 Background Information	pg. 4
2 Burberry Park Location Map	pg. 5
3 Burberry Park Master Plan	pg. 6
4 Resolution	pg. 7

**Attachment 1**

**Background Information**

The name assignment of Burberry Park, the master plan, and the environmental documents were approved by City Council on July 22, 2004. Burberry Park Phase 1 construction was awarded through Resolution Number 2004-745. Phase 1 development included basic landscaping, irrigation, pathways, picnic and play areas, native area landscape improvements, a basketball court, and group picnic area improvements including a shade structure.

Due to community requests, Burberry Park Phase 2 will include a remodel of the natural area. In addition, a restroom and tennis courts will be constructed. When funding becomes available, future development will include a lighted soccer field, parking lot, and amphitheater. The project is tentatively scheduled to be bid in the summer of 2009 and construction completed in the fall of 2009.

# City of Sacramento

## Department of Parks and Recreation

### Burberry Community Park

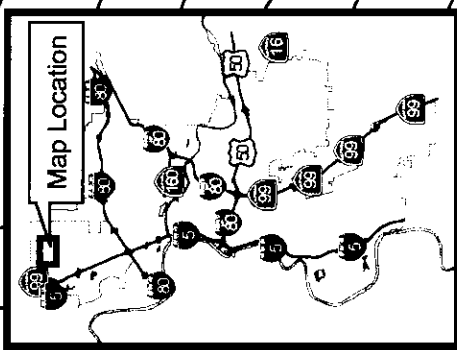
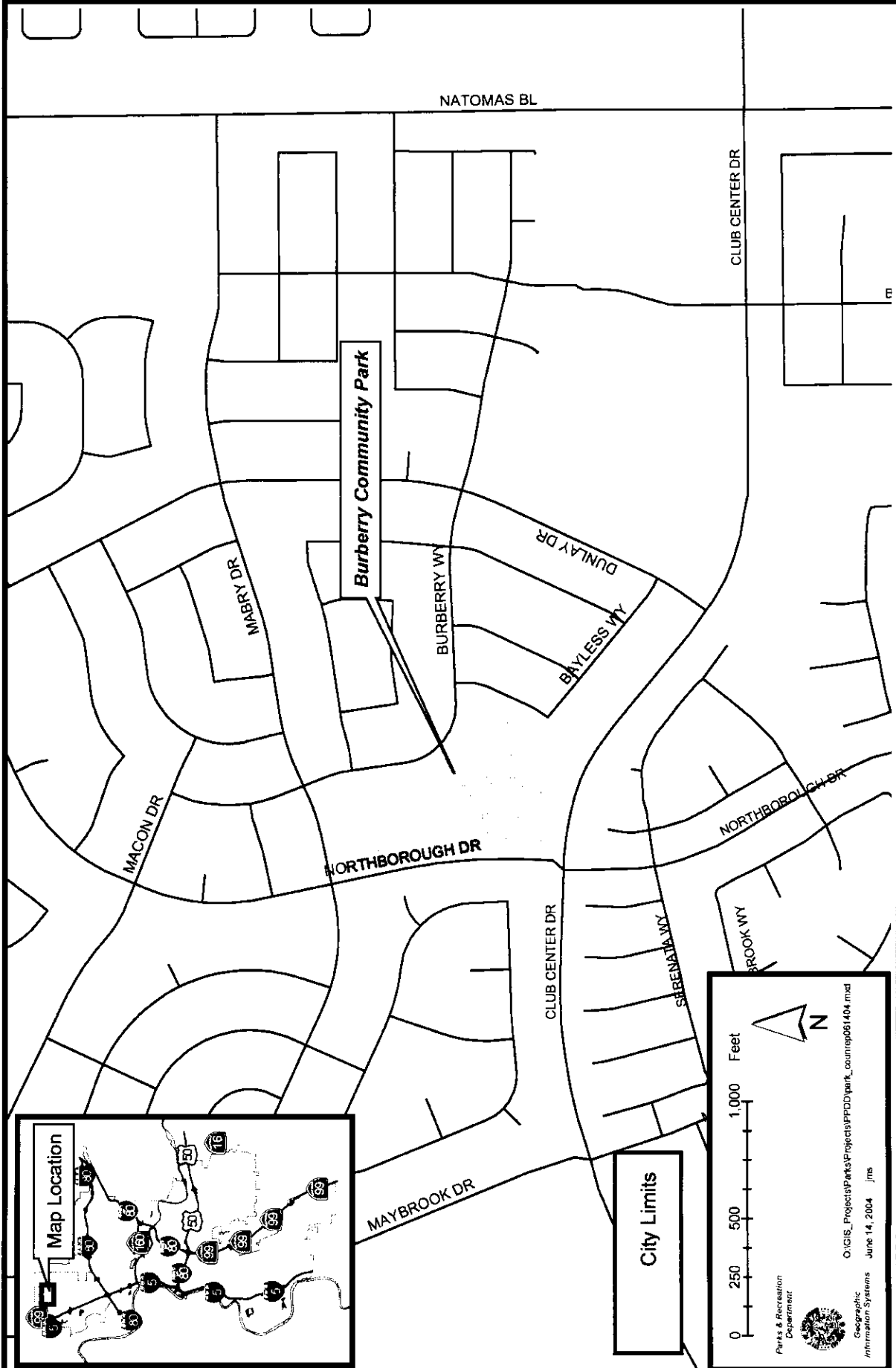

City Limits

0 250 500 1,000 Feet

Parks & Recreation Department

O:\GIS\_Projects\Parks\Projects\PPDD\park\_count\pp061404.mxd  
Geographic Information Systems June 14, 2004 .jms

**Attachment 3  
Burberry Park Master Plan**

**LEGEND**

- A. SOCCER FIELDS
- B. BERMING
- C. PATHWAYS
- D. TENNIS COURTS
- E. BASKETBALL COURT
- F. RESTROOM
- G. PARKING LOT
- H. AMPHITHEATER
- I. CENTRAL PLAZA
- J. ADVENTURE PLAY
- K. SITTING AREAS
- L. DRY STREAM BED
- M. PICNIC AREAS
- N. TOT LOT
- O. NATURAL AREA —

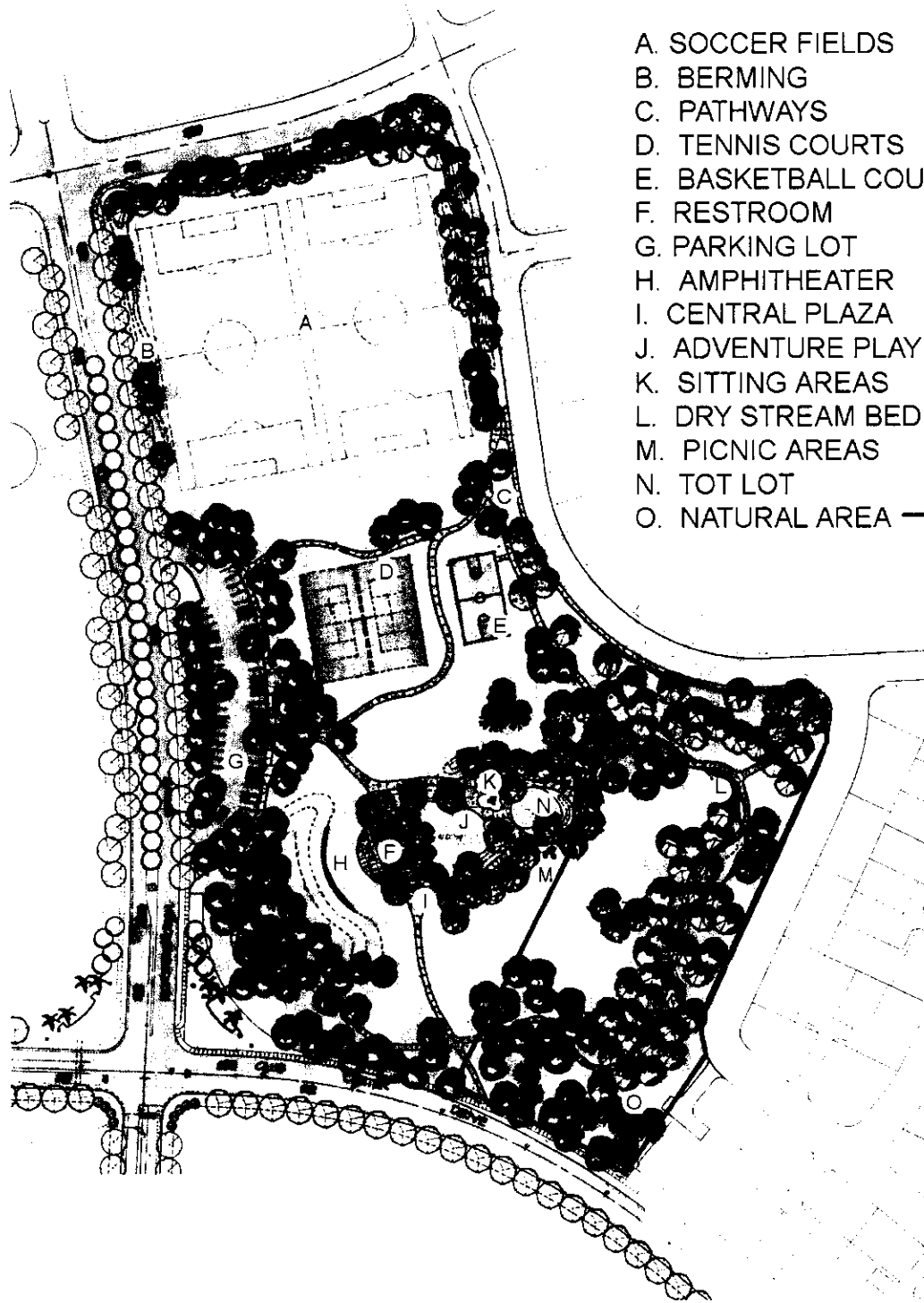

**BURBERRY PARK**



**RESOLUTION NO. 2008-**

Adopted by the Sacramento City Council

**May 6, 2008**

**APPROVING BURBERRY PARK CAPITAL IMPROVEMENT PROGRAM**

**BACKGROUND:**

- A. Burberry Park is an 11.8-acre community park located at Northborough Drive and Club Center Drive /Council District 1.
- B. The Burberry Park name, master plan, and associated environmental documents were approved by City Council on July 22, 2004, in Resolution #2004-581.
- C. Burberry Park Phase 1 construction contract was awarded in Resolution #2004-745.
- D. The Environmental Services Manager has reviewed the Burberry Park Phase 2 project for compliance with the requirements of the California Environmental Quality Act (CEQA).
- E. Utilizing Park Impact Fees, Fund 791 (3204), to augment this budget is consistent with Sacramento City Code Section 16.64.060 as these funds will be used for the "...improvement, and expansion of the public parks, playgrounds and recreational facilities."

**BASED ON THE FACTS SET FORTH IN THE BACKGROUND, THE CITY COUNCIL RESOLVES AS FOLLOWS:**

- Section 1. That \$875,000 from the Park Development Impact Fee (PIF), Fund 791 (3204), is appropriated to Burberry Park Phase 2, LT19 (L19111001).