

**CITY OF SACRAMENTO**  
1231 I Street, Sacramento, CA 95814

**Permit No: 0514734**  
**Insp Area: 4**  
**Thos Bros: 276H1**

**Site Address: 4368 GIBRALTAR ST SAC**  
Parcel No: 225-2010-017 CAMBAY WEST UNIT 7 LOT # 17  
N

Sub-Type: NSFR  
Housing (Y/N):

**CONTRACTOR**  
GRIFFIN INDUSTRIES  
24005 VENTURA BL.  
CALABASAS CA. 91302

**OWNER**  
NATOMAS HERITAGE-3 LLC  
24005 VENTURA BLVD  
CALABASAS, CA 91302

**ARCHITECT**

**Nature of Work: MP 1823 2 STORY 7 ROOM SFR**

**CONSTRUCTION LENDING AGENCY :** I hereby affirm under penalty of perjury that there is a construction lending agency for the performance of the work for which this permit is issued (Sec. 3097, Civ. C).

Lender's Name \_\_\_\_\_ Lender's Address \_\_\_\_\_

**LICENSED CONTRACTORS DECLARATION:** I hereby affirm under penalty of perjury that I am licensed under provisions of Chapter 9 (commencing with section 7000) of Division 3 of the Business and Professions Code and my license is in full force and effect.

License Class \_\_\_\_\_ License Number 684448 Date 10/18/05 Contractor Signature *Jerry Peterson*

**OWNER-BUILDER DECLARATION:** I hereby affirm under penalty of perjury that I am exempt from the contractor's License Law for the following reason (Sec. 7031.5, Business and Professions Code; any city or county which requires a permit to construct, alter, improve, demolish, or repair any structure, prior to its issuance, also requires the applicant for such permit to file a signed statement that he or she is licensed pursuant to the provisions of the Contractors License Law (Chapter 9 (commencing with Section 7000) of Division 8 of the Business and Professions Code) or that he or she is exempt therefrom and the basis for the alleged exemption. Any violation of Section 7031.5 by any applicant for a permit subjects the applicant to a civil penalty of not more than five hundred dollars (\$500.00);

\_\_\_\_\_, I, as a owner of the property, or my employees with wages as their sole compensation, will do the work, and the structure is not intended or offered for sale (Sec. 7044, Business and Professional Code: The Contractors License Law does not apply to an owner of property who builds or improves thereon, and who does such work himself or herself or through his/her own employees, provided that such improvements are not intended or offered for sale. If, however, the building or improvement is sold within one year of completion, the owner-builder will have the burden of proving that he/she did not build or improve for the purpose of sale.)

\_\_\_\_\_, I, as owner of the property, am exclusively contracting with licensed contractors to construct the project (Sec. 7044, Business and Professions Code: The Contractors License Law does not apply to an owner of property who builds or improves thereon, and who contracts for such projects with a contractor(s) licensed pursuant to the Contractors License Law).

\_\_\_\_\_, I am exempt under Sec. \_\_\_\_\_ B & PC for this reason: \_\_\_\_\_

Date \_\_\_\_\_ Owner Signature \_\_\_\_\_

**IN ISSUING THIS BUILDING PERMIT,** the applicant represents, and the city relies on the representation of the applicant, that the applicant verified all measurements and locations shown on the application or accompanying drawings and that the improvement to be constructed does not violate any law or private agreement relating to permissible or prohibited locations for such improvements. This building permit does not authorize any illegal location of a any improvement or the violation of any private agreement relating to location of improvements.

I certify that I have read this application and state that all information is correct. I agree to comply with all city and county ordinances and state laws relating to building construction and hereby authorize representative(s) of this city to enter upon the abovementioned property for inspection purposes.

Date 10/18/05 Applicant/Agent Signature *Jerry Peterson*

**WORKER'S COMPENSATION DECLARATION:** I hereby affirm under penalty of perjury one of the following declarations:

\_\_\_\_\_, I have and will maintain a certificate of consent to self-insure for workers' compensation as provided for by Section 3700 of the Labor Code, for the performance of work for which the permit is issued.

\_\_\_\_\_, I have and will maintain workers' compensation insurance, as required by Section 3700 of the Labor Code, for the performance of the work for which this permit is issued. My workers' compensation insurance carrier and policy number are:

Carrier STATE COMP. INS. FUND Policy Number WC 1673452-2003 Exp Date 01/01/2006

\_\_\_\_\_, (This section need not be completed if the permit is for \$100 or less) I certify that in the performance of the work for which this permit is issued, I shall not employ any person in any manner so as to become subject to the workers' compensation laws of California and agree that if I should become subject to the workers' compensation provisions of Section 3700 of the Labor Code, I shall forthwith comply with those provisions.

Date 10/18/05 Applicant Signature *Jerry Peterson*

**WARNING: FAILURE TO SECURE WORKER'S COMPENSATION COVERAGE IS UNLAWFUL AND SHALL SUBJECT AN EMPLOYER TO CRIMINAL PENALTIES AND CIVIL FINES UP TO ONE HUNDRED THOUSAND DOLLARS (\$100,000) IN ADDITION TO THE COST OF COMPENSATION, DAMAGES AS PROVIDED FOR IN SECTION 3706 OF THE LABOR CODE, INTEREST AND ATTORNEY'S FEE.**

**THIS PERMIT SHALL EXPIRE BY LIMITATION IF WORK IS NOT COMMENCED WITHIN 180 DAYS.**

THIS PLOT PLAN IS PROVIDED AS A GENERAL LAYOUT OF THE PROPERTY. ALL INFORMATION ON THIS PLAN INCLUDING: SETBACK DIMENSIONS, FENCE LOCATIONS, DRIVEWAY GRADES, SLOPE AND WALL HEIGHTS AND LOCATIONS, ARE APPROXIMATE AND MAY VARY OR CHANGE WITHOUT PRIOR NOTICE.

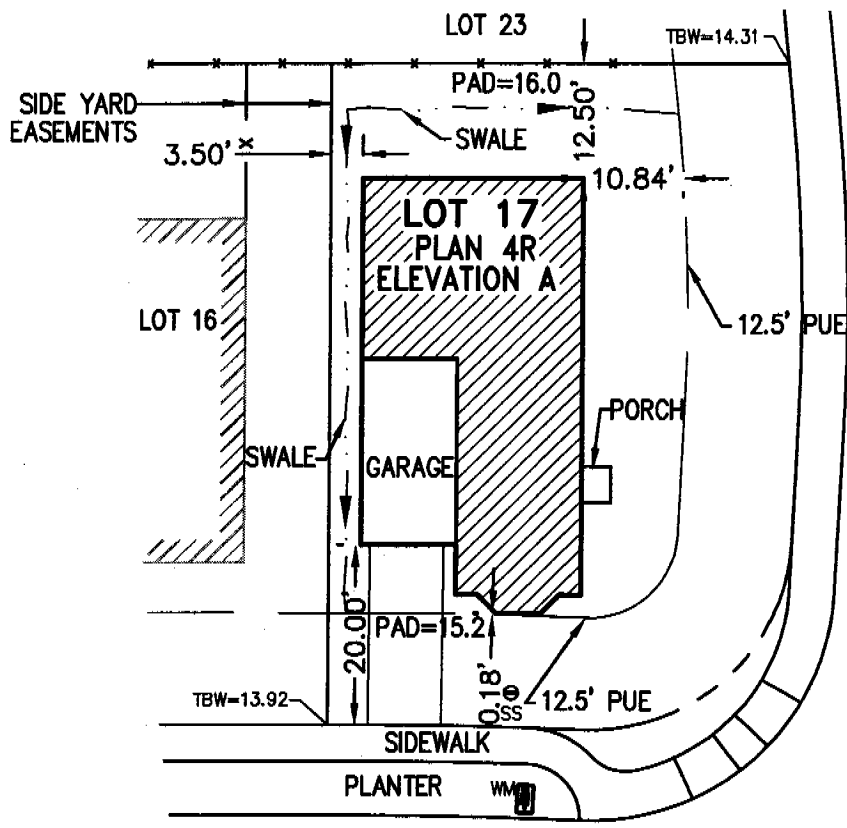

COLCHESTER AVENUE

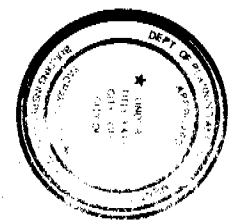

This set of plans and specifications must be kept on the job at all times and it is unlawful to make any changes or alterations from the same without written permission from the Building Inspection Division. The approval of this plan and specification SHALL NOT be held to permit or approve the violation of any City Ordinance or State Law.

**GIBRALTAR STREET**

- LEGEND**
- SBL - SET BACK LINE
  - PUE - PUBLIC UTILITY ESMT.
  - TBC - TOP BACK OF CURB
  - WM - WATER METER
  - SS - SANITARY SEWER
  - TBW - TOP BACK OF WALK
  - x - - FENCE

<p><b>GRIFFIN INDUSTRIES</b> 4200 DUCKHORN DR. SACRAMENTO, CA 95834 (916) 515-0171</p>	<p>LOT SIZE = 3620 SF BLDG. FOOTPRINT = 1061 SF FRONT SETBACK = 12.5' LEFT SETBACK = 3.5' RIGHT SETBACK = 12.5' REAR SETBACK = 0</p>	<p><b>CAMBAY WEST UNIT 4</b> <b>LOT 17</b> <b>4368 GIBRALTAR STREET</b> SACRAMENTO CALIFORNIA</p>
		<p><b>Carter=Burgess</b> Carter &amp; Burgess Inc.</p>
<p>DRAWN BY: PJB</p>	<p>CHECKED BY: RJT</p>	<p>W.O. NO.: 333251</p>
<p>DWG.: FALLOW</p>	<p>SCALE: 1"=20'</p>	<p>DATE: 07-10-05</p>

P:\Projects\333251.3\Drawings\C\Plot Plans\Plot Plans\Phase 4 (1,2, & 17-21).dwg 7-10-05 12:08:14 PM toporr

**INSULATION CERTIFICATE**

THIS IS TO CERTIFY THAT INSULATION HAS BEEN INSTALLED IN CONFORMANCE WITH THE CURRENT ENERGY REGULATIONS, CALIFORNIA ADMINISTRATION CODE, TITLE 24, STATE OF CALIFORNIA, IN THE BUILDING LOCATED AT:

SITE ADDRESS LOT 17 MAPLEWOOD SACRAMENTO CA  
NUMBER CITY STATE  
4368 Gibraltar 0514734

**CEILINGS:**

BLOW: MANUFACTURER OWENS CORNING THICKNESS 14.75" R/VALUE 30  
MANUFACTURER GREEN FIBER THICKNESS \_\_\_\_\_ R/VALUE \_\_\_\_\_  
BATTS: MANUFACTURER KNAUF THICKNESS 10" \_\_\_\_\_  
KNAUF \_\_\_\_\_

**EXTERIOR WALLS:**

MANUFACTURER KNAUF THICKNESS 3.5" R/VALUE 13  
KNAUF \_\_\_\_\_

**FLOOR INSULATION**

MANUFACTURER KNAUF THICKNESS 6.25" R/VALUE 19  
KNAUF \_\_\_\_\_

**AIR INFILTRATION:** (TITLE 24)  
YES XXX NO \_\_\_\_\_

OTHER: \_\_\_\_\_

GENERAL CONTRACTOR: GRIFFIN INDUSTRIES LICENSE # \_\_\_\_\_

BY: \_\_\_\_\_ TITLE \_\_\_\_\_ DATE \_\_\_\_\_

INSULATION CONTRACTOR: WESTERN INSULATION LP LICENSE # 794484

BY: Becky Gutherz TITLE AUTH. AGENT DATE 7/19/2007  
BECKY GUTHERZ

# INSTALLATION CERTIFICATE

(Page 3 of 12) **CF-6R**

4368 GIBR. QJAR CA.

0514734

Site Address: **MAPLEWOOD PLAN 4**

Permit Number

An installation certificate is required to be posted at the building site or made available for all appropriate inspections. (The information provided on this form is required) After completion of final inspection, a copy must be provided to the building department (upon request) and the building owner at occupancy, per Section 10-103(a).

## HVAC SYSTEMS:

### Heating Equipment

Equip Type (pkg. heat pump)	CEC Certified Mfr. Name and Model Number	# of Identical Systems	Efficiency (AFUE, etc.) (CF-1R value)	Duct Location (attic, etc.)	Duct or Piping R-value	Heating Load (Btu/hr)	Heating Capacity (Btu/hr)
<b>FURNACE</b>	<b>GOODMAN</b>						
	<b>GMS80905CX</b>	<b>1</b>	<b>80%</b>	<b>ATTIC</b>	<b>R6</b>	<b>90,000</b>	

### Cooling Equipment

Equip Type (pkg. heat pump)	CEC Certified Mfr. Name and Model Number	# of Identical Systems	Efficiency (SEER or EER) (CF-1R value)	Duct Location (attic, etc.)	Duct R-value	Cooling Load (Btu/hr)	Cooling Capacity (Btu/hr)
<b>CONDENSOR</b>	<b>GOODMAN</b>						
	<b>GSC130601A</b>	<b>1</b>	<b>13 SEER 11.5 EER</b>	<b>ATTIC</b>	<b>R6</b>	<b>60,000</b>	
<b>COIL</b>	<b>ASPEN</b>						<b>ARI #</b>
	<b>CP48A3B175T</b>						<b>1261856</b>

1. > symbol reads *greater than or equal to* what is indicated on the CF-1R value. Include both SEER and EER if compliance credit for high EER air conditioner is claimed.

I, the undersigned, verify that equipment listed above is: 1) is the actual equipment installed, 2) equivalent to or more efficient than that specified in the certificate of compliance (Form CF-1R) submitted for compliance with the *Energy Efficiency Standards* for residential buildings, and 3) equipment that meets or exceeds the appropriate requirements for manufactured devices (from the *Appliance Efficiency Regulations* or Part 6), where applicable.

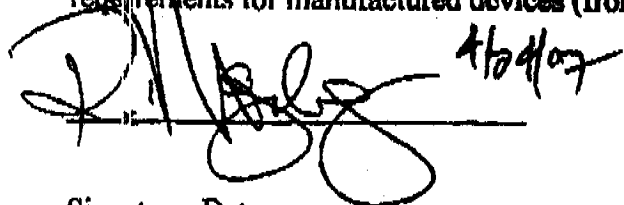

Signature, Date

Blue Mountain Air, Inc

Installing Contactor

**INSTALLATION CERTIFICATE**

**CF-6R**

4364 GIBBONS ST.

0504734

Site Address

Permit Number

An installation certificate is required to be posted at the building site or made available for all appropriate inspections. (The information provided on this form is required; however, use of this form to provide the information is optional.) After completion of final inspection, a copy must be provided to the building department (upon request) and the building owner at occupancy, per Section 10-103(b).

**HVAC SYSTEMS:**

**Heating Equipment**

Equip. Type (pkg. heat pump)	CEC Certified Mfr Name and Model Number	# of Identical Systems	Efficiency (AFUE, etc.) <sup>1</sup> [ $\geq$ CF-1R value]	Duct Location (attic, etc.)	Duct or Piping R-value	Heating Load (Btu/hr)	Heating Capacity (Btu/hr)

**Cooling Equipment**

Equip. Type (pkg. heat pump)	CEC Certified Compressor Unit Mfr Name and Model Number	# of Identical Systems	Efficiency (SEER, etc.) <sup>1</sup> [ $\geq$ CF-1R value]	Duct Location (attic, etc.)	Duct R-value	Cooling Load (Btu/hr)	Cooling Capacity (Btu/hr)

<sup>1</sup>  $\geq$  reads greater than or equal to.

I, the undersigned, verify that equipment listed above is: 1) the actual equipment installed, 2) equivalent to or more efficient than that specified in the certificate of compliance (Form CF-1R) submitted for compliance with the *Energy Efficiency Standards* for residential buildings, and 3) equipment that meets or exceeds the appropriate requirements for manufactured devices (from the *Appliance Efficiency Regulations* or Part 6), where applicable.

Signature, Date

Installing Subcontractor (Co. Name)  
OR General Contractor (Co. Name) OR Owner

**WATER HEATING SYSTEMS:**

Heater Type	CEC Certified Mfr Name & Model Number	Distribution Type (Std. Point-of-Use)	If Recirculation, Control Type	# of Identical Systems	Rated <sup>2</sup> Input (kW or Btu/hr)	Tank Volume (gallons)	Efficiency <sup>3</sup> (EF, RE)	Standby <sup>3</sup> Loss (%)	External Insulation R-value <sup>1</sup>
GAS	M44076FBW-5				40,000	40	.62		16
GAS	M45030FBW-5				40,000	50	.63		16
GAS	M2XR7506W				16,000	75	.80%		12

- 2 For small gas storage (rated input of less than or equal to 75,000 Btu/hr), electric resistance and heat pump water heaters, list Energy Factor. For large gas storage water heaters (rated input of greater than 75,000 Btu/hr), list Recovery Efficiency, Standby Loss and Rated Input. For instantaneous gas water heaters, list Recovery Efficiency and Rated Input.
- 3 R-12 external insulation is mandatory for storage water heaters with an energy factor of less than 0.58.

**Faucets & Shower Heads:**

All faucets and showerheads installed are certified to the Commission, pursuant to Title 24, Part 6, Section 111.

I, the undersigned, verify that equipment listed above my signature is: 1) the actual equipment installed; 2) equivalent to or more efficient than that specified in the certificate of compliance (Form CF-1R) submitted for compliance with the *Energy Efficiency Standards* for residential buildings; and 3) equipment that meets or exceeds the appropriate requirements for manufactured devices (from the *Appliance Efficiency Regulations* or Part 6), where applicable.

*[Signature]* 4-6-05  
Signature, Date

**WILMOR & SONS PLUMBING**  
Installing Subcontractor (Co. Name) OR  
General Contractor (Co. Name) OR Owner

COPY TO: Building Department  
HERS Provider (if applicable)  
Building Owner at Occupancy

INSTALLATION CERTIFICATE

(page 2 of 4)

CF-6R

Maplewood Plan 4

Site Address

4358 Gibraltar

Permit Number

0514734

FENESTRATION/GLAZING:

Manufacturer/Brand Name (GROUP LIKE PRODUCTS)	Operator Type (e.g., fixed, slider)	Manufactured Products Labeled U-value (≤ CF-1R value) <sup>2</sup>	Ship-Built Products		Quantity (Optional)	Total Square Feet	Comments/Special Features
			# of Panels	Default U-Value <sup>2</sup>			
1. HHO	SL	.62				192	
2. IBIG	SA	.60				18	
3. TIC PIC	PW	.44				95	
4. 450	SAD	.52				48	
5.							
6.							
7.							
8.							
9.							
10.							
11.							
12.							
13.							
14.							
15.							

<sup>2</sup> installed U-value must be less than or equal to value from CF-1R. Alternatively, installed weighted average U-value for the total fenestration area is less than or equal to value from CF-1R.

I, the undersigned, verify that the fenestration/glazing listed above my signature (1) is the actual fenestration product installed; (2) is equivalent to or more efficient than that specified in the certificate of compliance (Form CF-1R) submitted for compliance with the Energy Efficiency Standards for residential buildings; and (3) the product meets or exceeds the appropriate requirements for manufactured devices (from Part 6), where applicable.

4  
 Item #s (if applicable)      Signature, Date      3/1/05 Milgard Mfg.  
 Installing Subcontractor (Co. Name) OR  
 General Contractor (Co. Name) OR Owner

\_\_\_\_\_  
 Item #s (if applicable)      Signature, Date      \_\_\_\_\_  
 Installing Subcontractor (Co. Name) OR  
 General Contractor (Co. Name) OR Owner

\_\_\_\_\_  
 Item #s (if applicable)      Signature, Date      \_\_\_\_\_  
 Installing Subcontractor (Co. Name) OR  
 General Contractor (Co. Name) OR Owner

COPY TO: Building Department  
 Building Owner at Occupancy

Compliance Forms

July 1, 1995