

CITY OF SACRAMENTO
1231 I Street, Sacramento, CA 95814

Permit No: 0011047
Insp Area: 1

Site Address: 1306 P ST SAC
Parcel No: 006-0284-031

Sub-Type: NSFR
Housing (Y/N): N
CAPITOL PARK HOMES LOT 21

CONTRACTOR
CAPITOL PARK HOMES
818 19TH ST STE 200
SACRAMENTO CA. 95814

OWNER

ARCHITECT

Nature of Work: MP 1306 3 STORY 7 ROOM SFR

CONSTRUCTION LENDING AGENCY : I hereby affirm under penalty of perjury that there is a construction lending agency for the performance of the work for which this permit is issued (Sec. 3097, Civ. C).

Lender's Name _____ Lender's Address _____

LICENSED CONTRACTORS DECLARATION: I hereby affirm under penalty of perjury that I am licensed under provisions of Chapter 9 (commencing with section 7000) of Division 3 of the Business and Professions Code and my license is in full force and effect.

License Class AB License Number 767087 Date 9-28-00 Contractor Signature [Signature]

OWNER-BUILDER DECLARATION: I hereby affirm under penalty of perjury that I am exempt from the contractors License Law for the following reason (Sec. 7031.5, Business and Professions Code; any city or county which requires a permit to construct, alter, improve, demolish, or repair any structure, prior to its issuance, also requires the applicant for such permit to file a signed statement that he or she is licensed pursuant to the provisions of the Contractors License Law (Chapter 9 (commencing with Section 7000) of Division 8 of the Business and Professions Code) or that he or she is exempt therefrom and the basis for the alleged exemption. Any violation of Section 7031.5 by any applicant for a permit subjects the applicant to a civil penalty of not more than five hundred dollars (\$500.00):

_____, I, as a owner of the property, or my employees with wages as their sole compensation, will do the work, and the structure is not intended or offered for sale (Sec. 7044, Business and Professional Code: The Contractors License Law does not apply to an owner of property who builds or improves thereon, and who does such work himself or herself or through his/her own employees, provided that such improvements are not intended or offered for sale. If, however, the building or improvement is sold within one year of completion, the owner-builder will have the burden of proving that he/she did not build or improve for the purpose of sale.)

_____, I, as owner of the property, am exclusively contracting with licensed contractors to construct the project (Sec. 7044, Business and Professions Code: The Contractors License Law does not apply to an owner of property who builds or improves thereon, and who contracts for such projects with a contractor(s) licensed pursuant to the Contractors License Law).

_____, I am exempt under Sec. _____ B & PC for this reason: _____

Date _____ Owner Signature _____

IN ISSUING THIS BUILDING PERMIT, the applicant represents, and the city relies on the representation of the applicant, that the applicant verified all measurements and locations shown on the application or accompanying drawings and that the improvement to be constructed does not violate any law or private agreement relating to permissible or prohibited locations for such improvements. This building permit does not authorize any illegal location of any improvement or the violation of any private agreement relating to location of improvements.

I certify that I have read this application and state that all information is correct. I agree to comply with all city and county ordinances and state laws relating to building construction and hereby authorize representative(s) of this city to enter upon the abovementioned property for inspection purposes.

Date 9-28-00 Applicant/Agent Signature [Signature]

WORKER'S COMPENSATION DECLARATION: I hereby affirm under penalty of perjury one of the following declarations:

_____, I have and will maintain a certificate of consent to self-insure for workers' compensation as provided for by Section 3700 of the Labor Code, for the performance of work for which the permit is issued.

_____, I have and will maintain workers' compensation insurance, as required by Section 3700 of the Labor Code, for the performance of the work for which this permit is issued. My workers' compensation insurance carrier and policy number are:

Carrier State Comp Policy Number 241723

_____, (This section need not be completed if the permit is for \$100 or less) I certify that in the performance of the work for which the permit is issued, I shall not employ any person in any manner so as to become subject to the workers' compensation laws of California, and that if I should become subject to the workers' compensation provisions of Section 3700 of the Labor Code, I shall forthwith comply with those provisions.

Date 9-28-00 Applicant Signature [Signature]

CITY OF SACRAMENTO
EST. DATE 28 2000
NEIGHBORHOODS PLANNING AND DEVELOPMENT SERVICES

WARNING: FAILURE TO SECURE WORKER'S COMPENSATION COVERAGE IS UNLAWFUL AND SHALL SUBJECT AN EMPLOYER TO CRIMINAL PENALTIES AND CIVIL FINES UP TO ONE HUNDRED THOUSAND DOLLARS (\$100,000) IN ADDITION TO THE COST OF COMPENSATION, DAMAGES AS PROVIDED FOR IN SECTION 3706 OF THE LABOR CODE, INTEREST AND ATTORNEY'S FEE.

THIS PERMIT SHALL EXPIRE BY LIMITATION IF WORK IS NOT COMMENCED WITHIN 180 DAYS.

RESIDENTIAL SUBDIVISION BUILDING PERMIT APPLICATION

PLAN 1

Project Address: 1306 P ST
Lot Number: 21

Assessor Parcel # _____
Subdivision CAPITOL PARK HOMES

OWNER INFORMATION:

Legal Property Owner: SHASTA/DOWNTOWN SINGLE FAM Phone# 449-8989
Owner Address: 818 19th ST City SACRAMENTO State CA Zip 95814

CONTRACTOR INFORMATION:

Contractor: C.N.M CONST. Lic. # 767087 Phone # 449-8989 Fax 449-8865

PROJECT INFORMATION:

Land Use Zone R1A Occupancy Group R3 Construction Type VN Fed Code 1A
No. of Stories: 2 No. of Rooms: 5 Street Width: 20
1st Floor Area 900 2nd Floor Area 406 Basement - Roof Material COMP
AREA IN SQUARE FOOT OF:
Dwelling/Living 1306
Garage/Storage 561 / -
Decks/Balconies 60
Carports -
SCOPE OF WORK: NEW SINGLE FAMILY RESIDENCE

- Information Above Complete
- Violation Files Checked
- Standard Setbacks
- County Sewer
- AR Flood Waiver Required
- Flood Elevation Certificate Required
- Water Development Infill Area
- Planning Approval
- Design Review Approval
- Special Fee Districts Apply:

→THE FOLLOWING MUST BE PROVIDED IN ORDER TO SUBMIT FOR PERMIT←

- 2 COMPLETE PLOT PLANS, LEGIBLE & DRAWN TO SCALE
- 11 X 17 COPY OF FLOOR PLAN WITH FOLLOWING INFORMATION
 - a) Assessor's Parcel Number
 - b) New Floor Area
 - c) Owners Name
 - d) Project Address

Date: _____ Received by: (staff) _____ Permit # _____

FOR OFFICE USE ONLY

CERTIFICATION OF INSULATION

PART I GENERAL	ADDRESS OR TRACT		SACRAMENTO INSULATION CONTRACTORS				
	CNM	LOT # 21	<input checked="" type="checkbox"/> P.O. BOX 854, WEST SACRAMENTO, CA 95691 LIC. #202026 <input type="checkbox"/> 1309 MELODY ROAD, MARYSVILLE, CA 95901 LIC. #202026 <input type="checkbox"/> P.O. BOX 9651, FRESNO, CA 93793-9651 LIC. #202026 <input type="checkbox"/> P.O. BOX 1631, RENO, NV 89505 LIC. #10675 <input type="checkbox"/> 3326 A PONDEROSA WAY, LAS VEGAS, NV 89118 LIC. #10675				
CAPITOL PARK HOMES		DATE INSULATION COMPLETED 4-3-00					
PART II AREAS INSULATED	WALLS		CEILINGS			FLOORS	
	(SQUARE FEET)		(SQUARE FEET)			(SQUARE FEET)	
	TYPE OF INSULATION		TYPE OF INSULATION			TYPE OF INSULATION	
	MATERIAL FIBERGLASS		MATERIAL FIBERGLASS			MATERIAL FIBERGLASS	
	FORM BATTS		FORM BATTS & BLOW			FORM BATTS	
	MANUFACTURER'S PRODUCT I.D.		MANUFACTURER'S PRODUCT I.D.			MANUFACTURER'S PRODUCT I.D.	
	MANUFACTURER		MANUFACTURER			MANUFACTURER	
	OCF		OCF			OCF	
	BAGS						
	R - VALUE INSTALLED	APPLIED THICKNESS	R - VALUE INSTALLED	APPLIED THICKNESS	MIN. INSTALLED WEIGHT PER SQUARE FOOT	R - VALUE INSTALLED	APPLIED THICKNESS
13	3 5/8"	30	9"		19	6 1/4"	
KNEE WALLS IF R-VALUE IS OTHER THAN WALLS ABOVE							
MATERIAL FIBERGLASS		FORM BATTS		R VALUE		MANUFACTURER OCF	
AIR INFILTRATION SEALANT							
MATERIAL FOAM				MANUFACTURER W R GRACE			
THIS IS TO CERTIFY THAT INSULATION AND/OR SEALANT HAS BEEN INSTALLED IN CONFORMANCE WITH APPLICABLE CODES, MATERIAL STANDARDS AND REGULATIONS.							
SIGNATURE - INSULATION CONTRACTOR 				TITLE MANAGER		DATE 9-20-01	
SIGNATURE - GENERAL CONTRACTOR				TITLE		DATE	
REMARKS							

P STREET

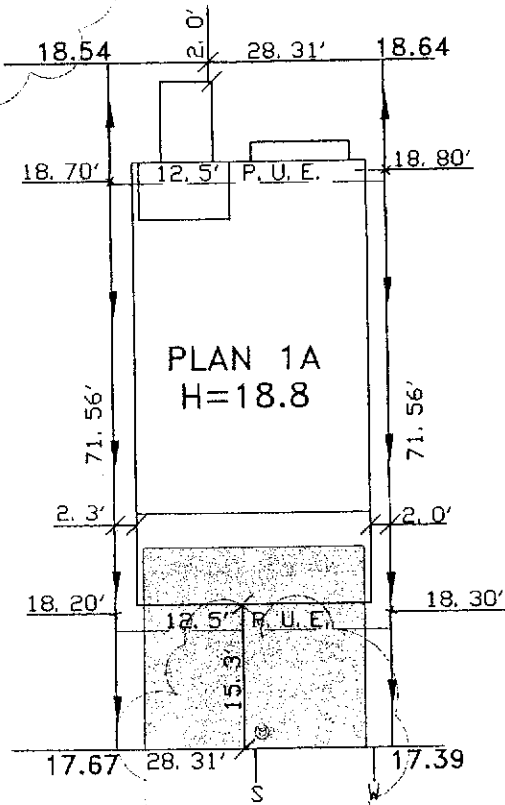
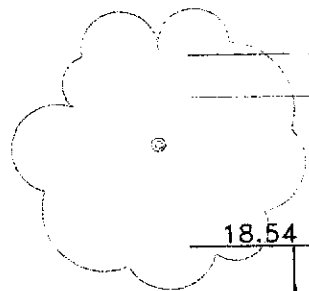

MOTOR COURT B

This set of plans and specifications must be kept on the job at all times and it is unlawful to make any changes or alterations from the same without written permission from the Building Inspection Division.
 The approval of this plan and specification SHALL NOT be held to permit or approve the violation of any City Ordinance or State Law.

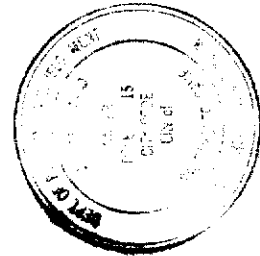

NOTE:

This plan is only intended to reference the building plan designated for this lot. All setbacks other than minimum code requirements are approximate. The "as-built" field condition may vary from this plan.

DATE: 08-22-00
 A.P.N.:
 ADDRESS: 1306 P ST

LOT AREA: 2,026 SF
 LOT COVERAGE: 47%

The Spink Corporation

2590 VENTURE OAKS WAY
 SACRAMENTO, CA. 95833

PH:(916)925-5550 FAX:(916)921-9274

CAPITOL PARK

LOT 21
 PLAN 1A

CAPITOL PARK

CITY OF SACRAMENTO, CA.
 CLIENT: CNM CONSTRUCTION
 JOB NO.: 1222-002