

**CITY OF SACRAMENTO**

**1231 I Street, Sacramento, CA 95814**

**Permit No: 9811982**

**Insp Area: 4**

**Site Address: 3327 MARINA GLEN WY SAC**

**Parcel No: 2740480011**

**LOT 11/RIVERSGATE**

**Sub-Type: NSFR**

**Housing (Y/N): N**

**CONTRACTOR**

WARMINGTON HOMES  
8265 SIERRA COLLEGE BL #312  
ROSEVILLE CA 95661

**OWNER**

WARMINGTON HOMES

**ARCHITECT**

HEZMALHLACH WILLIAM ARCH INC  
17875 VON KARMAN AV #404  
IRVINE CA 92614

**Nature of Work: NEW HOME MP2901, 9 ROOMS**

**CONSTRUCTION LENDING AGENCY :** I hereby affirm under penalty of perjury that there is a construction lending agency for the performance of the work for which this permit is issued (Sec. 3097, Civ. C).

Lender's Name \_\_\_\_\_

Lender's Address \_\_\_\_\_

**LICENSED CONTRACTORS DECLARATION:** I hereby affirm under penalty of perjury that I am licensed under provisions of Chapter 9 (commencing with section 7000) of Division 3 of the Business and Professions Code and my license is in full force and effect.

License Class B License Number 746231 Date 12-17-98 Contractor Signature \_\_\_\_\_

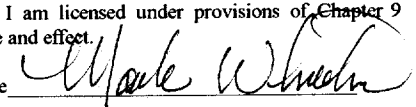

**OWNER-BUILDER DECLARATION:** I hereby affirm under penalty of perjury that I am exempt from the contractors License Law for the following reason (Sec. 7031.5, Business and Professions Code; any city or county which requires a permit to construct, alter, improve, demolish, or repair any structure, prior to its issuance, also requires the applicant for such permit to file a signed statement that he or she is licensed pursuant to the provisions of the Contractors License Law (Chapter 9 (commencing with Section 7000) of Division 8 of the Business and Professions Code) or that he or she is exempt therefrom and the basis for the alleged exemption. Any violation of Section 7031.5 by any applicant for a permit subjects the applicant to a civil penalty of not more than five hundred dollars (\$500.00):

I, as a owner of the property, or my employees with wages as their sole compensation, will do the work, and the structure is not intended or offered for sale (Sec. 7044, Business and Professional Code: The Contractors License Law does not apply to an owner of property who builds or improves thereon, and who does such work himself or herself or through his/her own employees, provided that such improvements are not intended or offered for sale. If, however, the building or improvement is sold within one year of completion, the owner-builder will have the burden of proving that he/she did not build or improve for the purpose of sale.)

I, as owner of the property, am exclusively contracting with licensed contractors to construct the project (Sec. 7044, Business and Professions Code: The Contractors License Law does not apply to an owner of property who builds or improves thereon, and who contracts for such projects with a contractor(s) licensed pursuant to the Contractors License Law).

I am exempt under Sec. \_\_\_\_\_ B & PC for this reason: \_\_\_\_\_

Date \_\_\_\_\_

Owner Signature \_\_\_\_\_

**IN ISSUING THIS BUILDING PERMIT,** the applicant represents, and the city relies on the representation of the applicant, that the applicant verified all measurements and locations shown on the application or accompanying drawings and that the improvement to be constructed does not violate any law or private agreement relating to permissible or prohibited locations for such improvements. This building permit does not authorize any illegal location of any improvement or the violation of any private agreement relating to location of improvements.

I certify that I have read this application and state that all information is correct. I agree to comply with all city and county ordinances and state laws relating to building construction and hereby authorize representative(s) of this city to enter upon the abovementioned property for inspection purposes.

Date 12-17-98 Applicant/Agent Signature \_\_\_\_\_

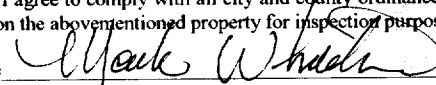

**WORKER'S COMPENSATION DECLARATION:** I hereby affirm under penalty of perjury one of the following declarations:

I have and will maintain a certificate of consent to self-insure for workers' compensation as provided for by Section 3700 of the Labor Code, for the performance of work for which the permit is issued.

I have and will maintain workers' compensation insurance, as required by Section 3700 of the Labor Code, for the performance of the work for which this permit is issued. My workers' compensation insurance carrier and policy number are:

Carrier REPUBLIC INDEM CO OF AMERICA

Policy Number 00779320

Exp Date 07/01/1999

(This section need not be completed if the permit is for \$100 or less) I certify that in the performance of the work for which this permit is issued, I shall not employ any person in any manner so as to become subject to the workers' compensation laws of California and agree that if I should become subject to the workers' compensation provisions of Section 3700 of the Labor Code, I shall forthwith comply with those provisions.

Date 12-17-98 Applicant Signature \_\_\_\_\_

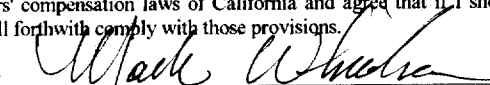

**WARNING: FAILURE TO SECURE WORKER'S COMPENSATION COVERAGE IS UNLAWFUL AND SHALL SUBJECT AN EMPLOYER TO CRIMINAL PENALTIES AND CIVIL FINES UP TO ONE HUNDRED THOUSAND DOLLARS (\$100,000) IN ADDITION TO THE COST OF COMPENSATION. DAMAGES AS PROVIDED FOR IN SECTION 3706 OF THE LABOR CODE, INTEREST AND ATTORNEY'S FEE.**

**THIS PERMIT SHALL EXPIRE BY LIMITATION IF WORK IS NOT COMMENCED WITHIN 180 DAYS.**

# NATOMAS UNIFIED SCHOOL DISTRICT

1515 Sports Drive, #1 • Sacramento, CA 95834  
Phone 916/641-3300 • Fax 916/928-1629

## CERTIFICATION OF COMPLIANCE

### SCHOOL DISTRICT DEVELOPMENT FEES

<b>PART I: TO BE COMPLETED BY APPLICANT</b>			
PROPERTY OWNER'S NAME	WARMINGTON HOMES.		
OWNER'S ADDRESS	5500 DOUGLAS BLVD.		
PROJECT ADDRESS	3327 - MARINA GLOWWY		
PARCEL NUMBER	274-0480-011		
SUBDIVISION NAME	RIVERBEND.		
NUMBER OF UNITS			
PRINT APPLICANT'S NAME	MARK WHITEHEAD	APPLICANT'S SIGNATURE:	<i>Mark Whitehead</i>
TITLE OF APPLICANT	SUPERINTENDENT		
DATE	2-16-98	TELEPHONE NUMBER	416-5350
<b>PART II: TO BE COMPLETED BY BUILDING DEPARTMENT</b>			
PLAN IDENTIFICATION NUMBER	9811982		
BUILDING TYPE (CHECK ONE)	<input checked="" type="checkbox"/> RESIDENTIAL <input type="checkbox"/> APARTMENT/CONDOMINIUM <input type="checkbox"/> COMMERCIAL/INDUSTRIAL		
SQUARE FEET OF CHARGEABLE BUILDING AREA	2901		
SIGNATURE	<i>Maureen McAllen</i>		
TITLE	Bldg. Insp.	DATE	12-12-98
<b>PART III: TO BE COMPLETED BY NATOMAS UNIFIED SCHOOL DISTRICT</b>			
DISTRICT CERTIFICATION NUMBER	99-60		
FEES COLLECTED			
RESIDENTIAL	2901 Sq. Ft. X \$ 1.93	= \$	5598.93
APARTMENT/CONDOMINIUM	Sq. Ft. X \$	= \$	
COMMERCIAL/INDUSTRIAL	Sq. Ft. X \$	= \$	

This certification covers only the amount of square footage indicated above. Any additions or corrections to the square footage for this project will require an amendment to the Certificate of Compliance.

As the authorized school district official, I hereby certify that the requirements of Government Code Section 65995 have been complied with by the above signed applicant.

**AUTHORIZED SCHOOL DISTRICT OFFICIAL:**

SIGNATURE: *Maureen McAllen*  
TITLE: *Building Inspector*      DATE: *12/17/98*

# CERTIFICATION OF INSULATION

PART I GENERAL

PART II AREAS INSULATED

PART III SIGNATURES

<b>ADDRESS OR TRACT</b>	<b>SACRAMENTO INSULATION CONTRACTORS</b>
WARMINGTON  RIVERBEND	LOT # 11  <input checked="" type="checkbox"/> P.O. BOX 854, WEST SACRAMENTO, CA 95691 LIC. #202026 <input type="checkbox"/> 3243 INDUSTRIAL DRIVE, YUBA CITY, CA 95993 LIC. #202026 <input type="checkbox"/> P.O. BOX 9651, FRESNO, CA 93793-9651 LIC. #202026 <input type="checkbox"/> P.O. BOX 1631, RENO, NV 89505 LIC. #10675 <input type="checkbox"/> 3326 A PONDEROSA WAY, LAS VEGAS, NV 89118 LIC. #10675  DATE INSULATION COMPLETED 5-25-99

WALLS		CEILINGS			FLOORS	
( SQUARE FEET)		( SQUARE FEET)			( SQUARE FEET)	
<b>TYPE OF INSULATION</b>		<b>TYPE OF INSULATION</b>			<b>TYPE OF INSULATION</b>	
MATERIAL <b>FIBERGLASS</b>		MATERIAL <b>FIBERGLASS</b>			MATERIAL <b>FIBERGLASS</b>	
FORM <b>BATTS</b>		FORM <b>BATTS &amp; BLOW</b>			FORM <b>BATTS</b>	
MANUFACTURER'S PRODUCT I D		MANUFACTURER'S PRODUCT I D			MANUFACTURER'S PRODUCT I D	
<b>MANUFACTURER</b>		<b>MANUFACTURER</b>			<b>MANUFACTURER</b>	
<b>OCF</b>		<b>OCF</b>			<b>OCF</b>	
		BAGS				
<b>R - VALUE INSTALLED</b>	<b>APPLIED THICKNESS</b>	<b>R - VALUE INSTALLED</b>	<b>APPLIED THICKNESS</b>	<b>MIN. INSTALLED WEIGHT PER SQUARE FOOT</b>	<b>R - VALUE INSTALLED</b>	<b>APPLIED THICKNESS</b>
13	3 5/8"	30 BATT 30 BLOW	9" 12"			

**KNEE WALLS IF R-VALUE IS OTHER THAN WALLS ABOVE**

MATERIAL	FORM	R VALUE	MANUFACTURER
<b>FIBERGLASS</b>	<b>BATTS</b>		<b>OCF</b>

**AIR INFILTRATION SEALANT**

MATERIAL	MANUFACTURER
<b>FOAM</b>	<b>W R GRACE</b>

**THIS IS TO CERTIFY THAT INSULATION AND/OR SEALANT HAS BEEN INSTALLED IN CONFORMANCE WITH APPLICABLE CODES MATERIAL STANDARDS AND REGULATIONS.**

SIGNATURE - INSULATION CONTRACTOR	TITLE	DATE
<i>Mark Smith</i>	MANAGER	4-23-99
SIGNATURE - GENERAL CONTRACTOR	TITLE	DATE
<i>[Signature]</i>	<i>[Signature]</i>	6-29

REMARKS

*[Handwritten Signature]*

№ 18093



INSTALLATION CARD

Job Address:

*Williamson Kuehler*  
*9011 83rd Marine Parkway*  
*Sanramento*

Stucco System Trade Name: KWIK KOTE

Name Stucco Manufacturer: KWIK KOTE CORP.

ICBO Evaluation Service, Inc.

Report No. 3607

Date of Job Completion

Stucco Contractor: Kenyon Construction

Name: John W. Kenyon, III

Address: P.O. Box 2077

North Highlands, CA 95660

Telephone Number: (916) 349-8191

Approved Contractor Number as issued by the Stucco Manufacturer: 1

This is to certify that the stucco system on the building exterior at the above address had been installed in accordance with the evaluation report specified above and the manufacturer's instructions.

Signature of authorized representative of stucco contractor

Date

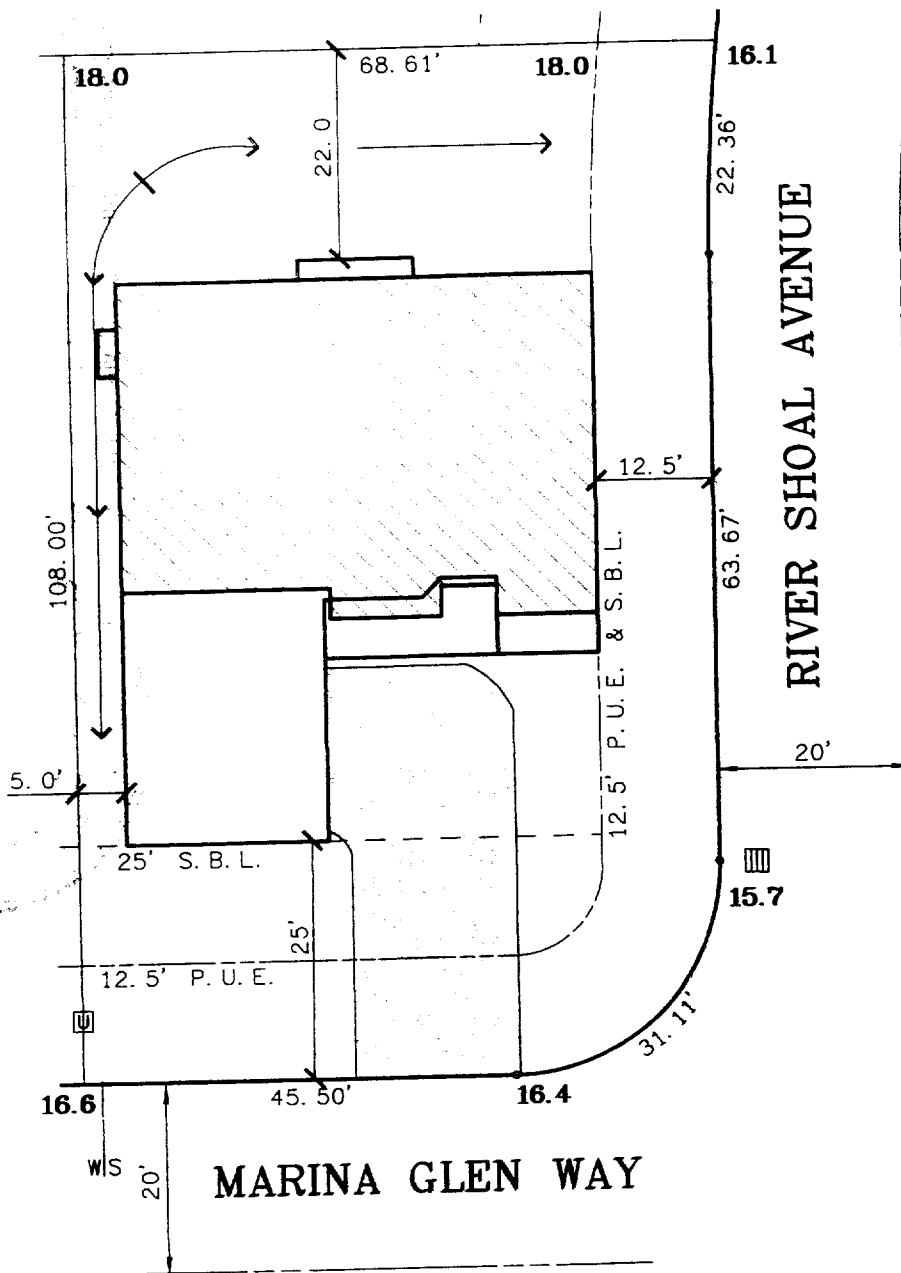

A. P. N. :  
 ADDRESS : 3327 MARINA GLEN WAY

**The Spink Corporation**  
 2590 VENTURE OAKS WAY  
 SACRAMENTO, CA. 95833  
 PH:(916)925-5550 FAX:(916)921-9274

**RIVERGATE**

**LOT 11  
 PLAN 4**

**RIVERBEND CLASSICS**

CITY OF SACRAMENTO, CA.  
 CLIENT: WARMINGTON HOMES  
 JOB NO.: 9342-001