

CITY OF SACRAMENTO
1231 I Street, Sacramento, CA 95814

Permit No: 0106594
Insp Area: 4

Site Address: 4245 BURGESS DR SAC
Parcel No: 237-0630-016 CHARDONNAY UNIT 2 LOT 16

Sub-Type: NSFR
Housing (Y/N): N

CONTRACTOR
BEAZER HOMES
3009 DOUGLAS BL #150
ROSEVILLE CA 95661

OWNER

ARCHITECT

Nature of Work: MP 1491 1 STORY 8 ROOM SFR

CONSTRUCTION LENDING AGENCY: I hereby affirm under penalty of perjury that there is a construction lending agency for the performance of the work for which this permit is issued (Sec. 3097, Civ. C.).

Lender's Name _____ Lender's Address _____

LICENSED CONTRACTORS DECLARATION: I hereby affirm under penalty of perjury that I am licensed under provisions of Chapter 9 (commencing with section 7000) of Division 3 of the Business and Professions Code and my license is in full force and effect.

License Class B License Number 724191 Date 5/23/01 Contractor Signature Sheryl Van Maer

OWNER-BUILDER DECLARATION: I hereby affirm under penalty of perjury that I am exempt from the contractors License Law for the following reason (Sec. 7031.5, Business and Professions Code; any city or county which requires a permit to construct, alter, improve, demolish, or repair any structure, prior to its issuance, also requires the applicant for such permit to file a signed statement that he or she is licensed pursuant to the provisions of the Contractors License Law (Chapter 9 (commencing with Section 7000) of Division 8 of the Business and Professions Code) or that he or she is exempt therefrom and the basis for the alleged exemption. Any violation of Section 7031.5 by any applicant for a permit subjects the applicant to a civil penalty of not more than five hundred dollars (\$500.00).

_____, I, as a owner of the property, or my employees with wages as their sole compensation, will do the work, and the structure is not intended or offered for sale (Sec. 7044, Business and Professional Code: The Contractors License Law does not apply to an owner of property who builds or improves thereon, and who does such work himself or herself or through his/her own employees, provided that such improvements are not intended or offered for sale. If, however, the building or improvement is sold within one year of completion, the owner-builder will have the burden of proving that he/she did not build or improve for the purpose of sale.)

_____, I, as owner of the property, am exclusively contracting with licensed contractors to construct the project (Sec. 7044, Business and Professions Code: The Contractors License Law does not apply to an owner of property who builds or improves thereon, and who contracts for such projects with a contractor(s) licensed pursuant to the Contractors License Law).

_____, I am exempt under Sec. _____ B & PC for this reason: _____

Date _____ Owner Signature _____

IN ISSUING THIS BUILDING PERMIT, the applicant represents, and the city relies on the representation of the applicant, that the applicant verified all measurements and locations shown on the application or accompanying drawings and that the improvement to be constructed does not violate any law or private agreement relating to permissible or prohibited locations for such improvements. This building permit does not authorize any illegal location of any improvement or the violation of any private agreement relating to location of improvements.

I certify that I have read this application and state that all information is correct. I agree to comply with all city and county ordinances and state laws relating to building construction and hereby authorize representative(s) of this city to enter upon the above mentioned property for inspection purposes.

Date 5/23/01 Applicant/Agent Signature Sheryl Van Maer

WORKER'S COMPENSATION DECLARATION: I hereby affirm under penalty of perjury one of the following declarations:

_____, I have and will maintain a certificate of consent to self-insure for workers' compensation as provided for by Section 3700 of the Labor Code, for the performance of work for which the permit is issued

I have and will maintain workers' compensation insurance, as required by Section 3700 of the Labor Code, for the performance of the work for which this permit is issued. My workers' compensation insurance carrier and policy number are:

Carrier LIBERTY MUTUAL INS CO. Policy Number WA2-651-004147-080 Exp Date 04/01/2002

(This section need not be completed if the permit is for \$100 or less) I certify that in the performance of the work for which this permit is issued, I shall not employ any person in any manner so as to become subject to the workers' compensation laws of California and agree that if I should become subject to the workers' compensation provisions of Section 3700 of the Labor Code, I shall forthwith comply with those provisions.

Date 5/23/01 Applicant Signature Sheryl Van Maer

WARNING: FAILURE TO SECURE WORKER'S COMPENSATION COVERAGE IS UNLAWFUL AND SHALL SUBJECT AN EMPLOYER TO CRIMINAL PENALTIES AND CIVIL FINES UP TO ONE HUNDRED THOUSAND DOLLARS (\$100,000) IN ADDITION TO THE COST OF COMPENSATION, DAMAGES AS PROVIDED FOR IN SECTION 3706 OF THE LABOR CODE, INTEREST AND ATTORNEY'S FEE.

THIS PERMIT SHALL EXPIRE BY LIMITATION IF WORK IS NOT COMMENCED WITHIN 180 DAYS.

RESIDENTIAL BUILDING PERMIT APPLICATION

New Construction
 Addition
 Remodels
 Other

Project Address: LOT 16 4245 Burgess Drive Assessor Parcel # 237-0630-016

OWNER INFORMATION: 0606594

Legal Property Owner: <u>Beazer Homes Holdings Corp.</u>	Phone # <u>916-773-3888</u>
Owner Address: <u>3009 Douglas Blvd. 150</u> City <u>Roseville</u> State <u>CA</u> Zip <u>95661</u>	

CONTRACTOR INFORMATION:

Contractor: <u>Same as above</u>	Lic. # <u>B724191</u>	Phone # <u>773-3888</u>	Fax # <u>773-0425</u>
----------------------------------	-----------------------	-------------------------	-----------------------

PROJECT INFORMATION:

Land Use Zone _____	Occupancy Group _____	Construction Type _____	Fed Code _____
No. of stories: <u>1</u>	No. of rooms: _____	Street width: _____	
1 st Floor Area <u>1491</u>	2 nd Floor Area _____	Basement _____	Roof Material _____

AREA IN SQUARE FOOT OF:	EXISTING	NEW
Dwelling/Living	_____	<u>1491</u>
Garage/Storage	_____	<u>390</u>
Decks/Balconies	_____	_____
Carports	_____	_____

SCOPE OF WORK: Single Family Homes

FOR OFFICE USE ONLY

<input type="checkbox"/> Information above complete	<input type="checkbox"/> AR Flood Waiver required	<input type="checkbox"/> Planning Approval
<input type="checkbox"/> Violation files checked	<input type="checkbox"/> Flood Elevation Certificate Required	<input type="checkbox"/> Design Review Approval
<input type="checkbox"/> Standard setbacks	<input type="checkbox"/> Water Development Infill Area	<input type="checkbox"/> Special Fee Districts Apply : _____
<input type="checkbox"/> County Sewer		

NEW STRUCTURES & ADDITIONS

*THE FOLLOWING MUST BE PROVIDED IN ORDER TO SUBMIT FOR PLAN REVIEW

<input type="checkbox"/> 2 COMPLETE PLANS, LEGIBLE & DRAWN TO SCALE <input type="checkbox"/> 3 SETS IF PROJECT IS IN A DESIGN REVIEW AREA <input type="checkbox"/> Title 24 Energy Compliance documentation <input type="checkbox"/> Grading and Erosion Control Questionnaire	<input type="checkbox"/> Plans to include: site plan, floor plan, elevations, roof/ceiling plan, foundation and structural framing details, and structural calculations for non-conforming structures. <input type="checkbox"/> 11" x 17" copy of floor plan for County Assessor <input type="checkbox"/> Plan Review Fees
---	--

Date: _____ Received by: (staff) _____

ACTIVITY/PERMIT #



**F. RODGERS INSULATION
RESIDENTIAL, INC.**

® THERMAL INSULATION CONTRACTORS
Residential

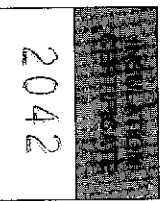

2042

7775 LAS POSITAS ROAD, SUITE A • LIVERMORE, CA 94550-0216

(925) 294-9400 • FAX (925) 294-9475

8541 YOUNGER CREEK DRIVE, SUITE 400 • SACRAMENTO, CA 98828

(916) 386-9400 • FAX (916) 386-9446

THIS IS TO CERTIFY THAT INSULATION HAS BEEN INSTALLED IN CONFORMANCE WITH CURRENT ENERGY REGULATIONS, CALIFORNIA BUILDING DEPARTMENT, TITLE 24, PART 14.05, AND THE STATE OF CALIFORNIA, IN THE BUILDING LOCATED AT _____

BEATZER LOT # 16 TRACT # CHARDONWAY
STREET _____ CITY SAC

EXTERIOR WALLS:

MANUFACTURER O/C THICKNESS/TYPE _____ R- VALUE 13R19

CEILINGS:

BATTS: O/C THICKNESS/TYPE _____ R- VALUE 30

MANUFACTURER BLOWN IN: O/C MINIMUM THICKNESS 1 1/2" R- VALUE 30

MANUFACTURER SQUARE FOOTAGE COVERED 1425 NUMBER OF BAGS USED 28

FLOORS & OVERHANGS: MANUFACTURER _____ THICKNESS/TYPE _____ R- VALUE _____

OTHER: MANUFACTURER _____ THICKNESS/TYPE _____ R- VALUE _____

GENERAL CONTRACTOR _____ DATE _____
CALIFORNIA CONTRACTORS LICENSE # _____

SIGNATURE TITLE
INSULATION CONTRACTOR F. RODGERS INSULATION RESIDENTIAL
CALIFORNIA CONTRACTORS LICENSE #771285
DATE 7-26-01
SIGNATURE B. J. [Signature] TITLE _____

#16

OMEGA PRODUCTS CORP.

DIAMOND WALL INSULATING STUCCO SYSTEM

JOB ADDRESS:

Beacon
Chan Felaine

ICBO Report #4004

Date of Job Completion

7/24/01

PLASTERING CONTRACTOR:

Name: STUCCO WORKS INC.

Address: 5900 WAREHOUSE WAY, SACRAMENTO, CALIFORNIA 95826

Telephone No: (916) 383-6699

Contractor Number of Diamond Wall System 2175

This is to certify that the exterior coating system on the building exterior at the above address has been installed in accordance with the evaluation report specified above and the manufacturer's instructions.

8/14/01
Date

[Signature]
Signature of authorized representative of
Plastering Contractor

This installation card must be presented to the building inspector after completion of work and before final inspection.

X:\PROJ\900054\DWG\PLOTPLANS\LOT16.DWG 05-09-01 10:55 am - Blouie

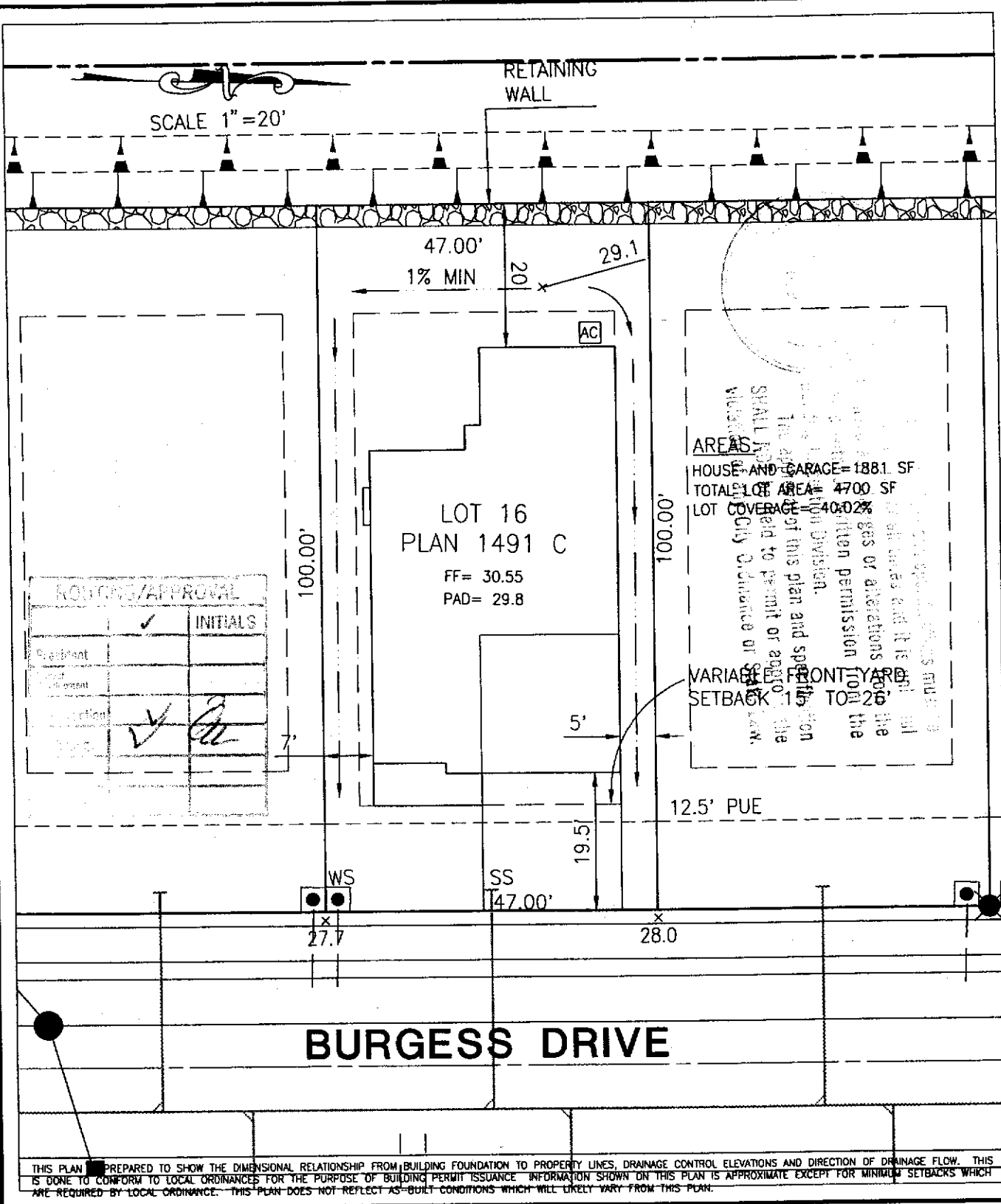

THIS PLAN IS PREPARED TO SHOW THE DIMENSIONAL RELATIONSHIP FROM BUILDING FOUNDATION TO PROPERTY LINES, DRAINAGE CONTROL ELEVATIONS AND DIRECTION OF DRAINAGE FLOW. THIS IS DONE TO CONFORM TO LOCAL ORDINANCES FOR THE PURPOSE OF BUILDING PERMIT ISSUANCE. INFORMATION SHOWN ON THIS PLAN IS APPROXIMATE EXCEPT FOR MINIMUM SETBACKS WHICH ARE REQUIRED BY LOCAL ORDINANCE. THIS PLAN DOES NOT REFLECT AS-BUILT CONDITIONS WHICH WILL LIKELY VARY FROM THIS PLAN.



MORTON & PITALO, INC.

CIVIL ENGINEERING * PLANNING * SURVEYING
1788 TRIBUTE ROAD • SUITE 200 • SACRAMENTO, CA 95815
PHONE: 916/927-2400 • FAX: 916/567-0120

DRAWN:	B.L.	JOB NO:	900054
CHECKED:	MJD	DATE:	MAY 2001
SCALE:	1/20	SHEET:	1 of 1

PLOT PLAN

CHARDONNAY UNIT 2

MODEL 1491 C

LOT 16

CITY OF SACRAMENTO, CALIFORNIA