

DEPARTMENT
OF UTILITIES

ENGINEERING
SERVICES DIVISION

CITY OF SACRAMENTO
CALIFORNIA

1395 35th AVENUE
SACRAMENTO, CA
95822-2911

PH 916-264-1400
FAX 916-264-1497/1498

November 20, 2001

City Council
Sacramento, California

Honorable Members in Session:

SUBJECT: BASIN 55 I&I REDUCTION - PHASE 2 - AWARD CONTRACT TO GELCO SERVICES, INC. FOR AN AMOUNT NOT TO EXCEED \$403,452.

LOCATION AND COUNCIL DISTRICT:

The Basin 55 I&I Reduction - Phase 2 project is located in Council District 4. See attached location map.

RECOMMENDATION:

Staff recommends that the City Council accept the low bid from GELCO Services, Inc., and award the contract for an amount not to exceed \$403,452.

CONTACT PERSON: Gary Reents, Engineering Services Manager, 264-1433
Rick Batha, Supervising Engineer, 264-1448

FOR COUNCIL MEETING OF: December 11, 2001

SUMMARY:

Bids were received from three (3) contractors and opened by the City Clerk on November 14, 2001. The low bidder was GELCO Services, Inc. with a bid of \$403,452. GELCO Services, Inc. met the Emerging and Small Business Enterprise (ESBE) goals. It is therefore proposed to award the contract to GELCO Services, Inc. for \$403,452.



CITY OF SACRAMENTO
DEPARTMENT
OF UTILITIES

Making a Difference in Your Neighborhood

City Council
December 11, 2001
Basin 55 I&I Reduction - Phase 2 (PN:XH11)

COMMITTEE/COMMISSION ACTION:

None.

BACKGROUND INFORMATION:

Sanitary sewer basin 55 is located in the Pocket Area of the City of Sacramento, south of 35th Avenue and west of Interstate 5. This sanitary sewer basin has significant infiltration and inflow (I&I) present throughout the entire year. Infiltration and Inflow is clean storm and/or groundwater that enters the sewer system through defects in the pipes, leaky manholes, or improperly connected storm drains, down spouts and sump pumps. Most inflow comes from stormwater and most infiltration comes from groundwater. Excessive I&I can result in sanitary sewer overflows and excessive sewer flows that need to be pumped and treated.

Utility Department staff conducted an investigation in Basin 55 that provided information on flow volumes in each sewer main segment. Based on this investigation the basin was divided into sub-basins. These sub-basins were then prioritized based on the observed flow volumes in each sub-basin. This project targets the highest prioritized sub-basin for rehabilitation.

This project includes the lining of approximately 1,970 lf of 12-inch sewer main, 360 lf of 8-inch sewer main, 10,430 lf of 6-inch sewer main, reinstatement of 246 sewer service laterals, and rehabilitation of 43 maintenance holes.

This project was advertised and bids were received on November 14, 2001, and are summarized below:

Contractor	Bid Amount
GELCO Services, Inc.	\$403,452
Insituform Technologies, Inc.	\$430,965
Ford Construction Company, Inc.	\$670,430

- The engineer's estimated construction cost was \$470,000.
- The estimated completion date is April 15, 2002.

City Council
December 11, 2001
Basin 55 I&I Reduction - Phase 2 (PN:XH11)

FINANCIAL CONSIDERATIONS:

The total project cost including design, construction, inspection, and contingency is \$470,000. There are sufficient funds in the project to award the contract.

ENVIRONMENTAL DETERMINATION:

The Planning Services Division, Environmental Section, has reviewed the proposed project and has determined that this project is categorically exempt from the California Environmental Quality Act (CEQA) under Section 15302 (c) of the CEQA Guidelines.

POLICY CONSIDERATIONS:

This action is consistent with Title 3, Section 3.60 of the City Code concerning award of contracts.

ESBD CONSIDERATIONS:

This project included participation goals of 20% for emerging and small business enterprises as required by Ordinance 99-007 and Resolution 99-055, relating to ESBD participation goals and policies, adopted by the City Council on February 9, 1999. The responsive low bidder, GELCO Services, Inc., exceeded the ESBE goals with a participation level of 20.57%.

Respectfully submitted,



for Gary A. Reents
Engineering Services Manager

RECOMMENDATION APPROVED:

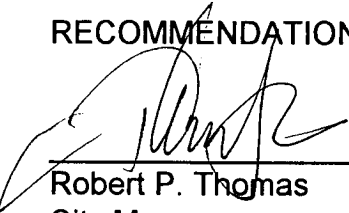

Robert P. Thomas
City Manager

APPROVED:

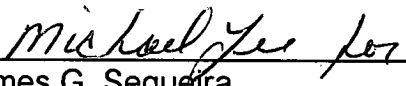

James G. Sequeira
Director of Utilities

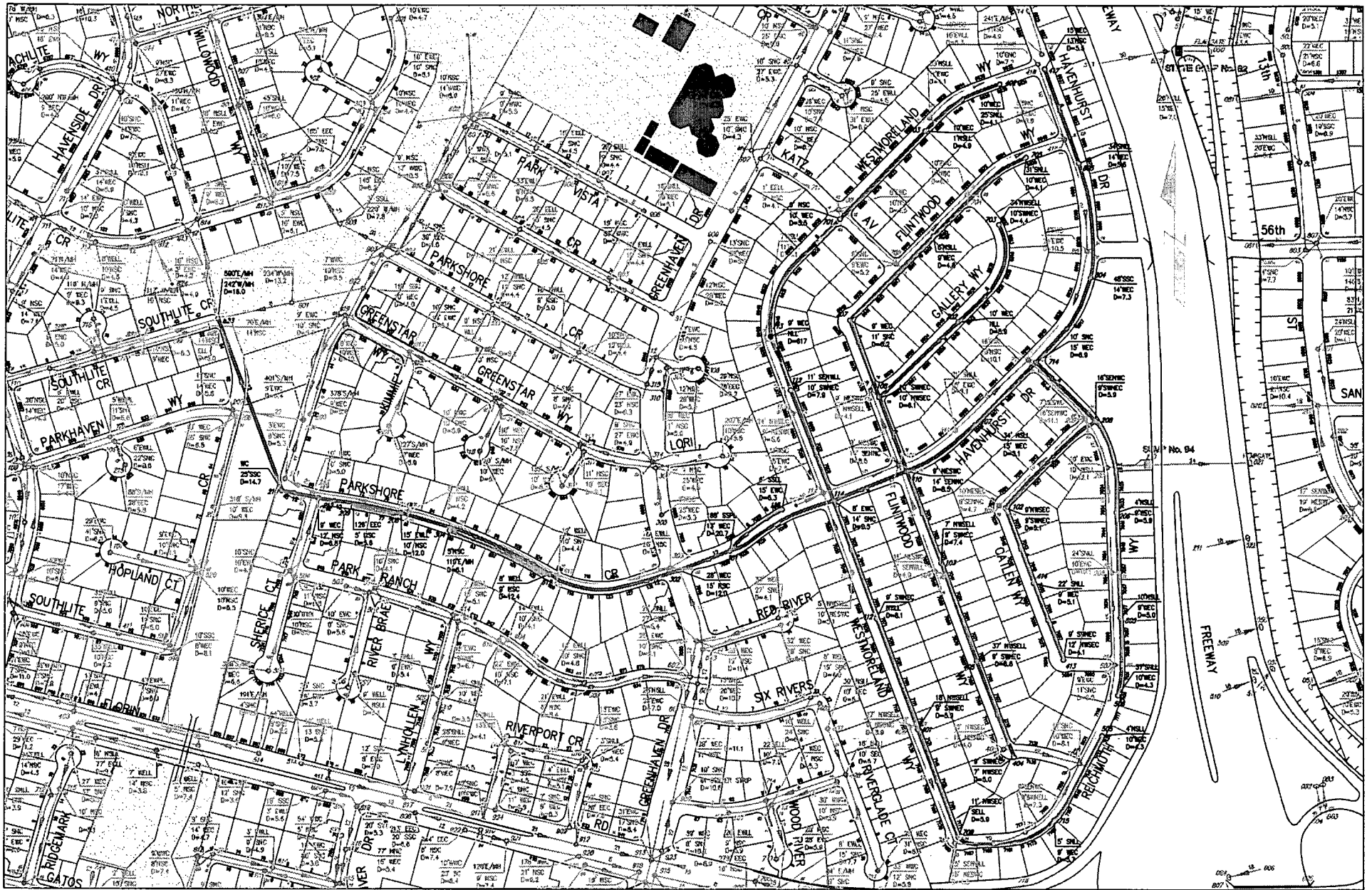

BASIN 55 1&1 REDUCTION - PHASE 2
 LOCATION MAP
 NTS



CITY OF SACRAMENTO
 DEPARTMENT
 OF UTILITIES

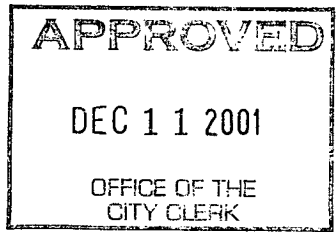

RESOLUTION NO. 2001-815

ADOPTED BY THE SACRAMENTO CITY COUNCIL

ON DATE OF _____

RESOLUTION AUTHORIZING THE CITY MANAGER AND CITY CLERK TO SIGN AND EXECUTE A CONTRACT WITH GELCO SERVICES, INC. FOR BASIN 55 I&I REDUCTION - PHASE 2 (PN: XH11), FOR AN AMOUNT NOT TO EXCEED \$403,452

BE IT RESOLVED BY THE SACRAMENTO CITY COUNCIL THAT:

The City Manager and City Clerk are authorized to sign and execute a contract with GELCO Services, Inc. for the Basin 55 I&I Reduction - Phase 2 (PN: XH11), for an amount not to exceed \$403,452.

MAYOR

ATTEST:

CITY CLERK

FOR CITY CLERK USE ONLY

RESOLUTION NO.: _____

DATE ADOPTED: _____