



REPORT TO COUNCIL City of Sacramento

5

915 I Street, Sacramento, CA 95814-2671
www.CityofSacramento.org

CONSENT
April 18, 2006

Honorable Mayor and
Members of the City Council

Continued from 4-18-06

Subject: Agreement: Use Agreement with Sacramento County for Real Property Interests Necessary for Phase I of Ueda Parkway

Location/Council District:

Main Avenue to West El Camino Avenue Bridge, Council District 1

Recommendation: Adopt a Resolution: 1) Approving the Use Agreement between the City of Sacramento and the County of Sacramento for Ueda Parkway Phase I, CIP HB16.

Contact: Janet Baker, Park Development Manager, 808-8234
Blandon Granger, Real Property Agent II, 808-5629

Presenters: Not Applicable

Department: Parks and Recreation

Division: Park Planning, Design and Development

Organization No: 4727

Summary:

The County of Sacramento (the County) owns recreation easements along the Ueda Parkway. On the Phase I portion of the Ueda Parkway from Main Avenue to West El Camino Avenue, the County holds a recreation easement interest. The County has agreed to let the City of Sacramento use the real estate interests free-of-charge through a use agreement.

Committee/Commission Action:

Not applicable. The Parks and Recreation Commission is periodically updated as to the status of the projects.

Background Information:

The Department of Parks and Recreation is responsible for the development of off-street recreation trails. The Ueda Parkway is an important part of a regional trail system that offers both recreation and commuter opportunities.

Ueda Parkway consists of approximately 12.5 miles of paved recreation trails that are mostly on the crown of levees, Phase I will be approximately four miles of paved trail from Main Avenue to West El Camino Avenue (Attachment 1, page 4). The Ueda Parkway's purpose is to integrate a recreation trail within creek corridors in the northern area of Sacramento. This trail also provides a significant leg to a 60 mile regional trail loop that extends to the American River Parkway and to Placer County through Folsom. The County holds a recreation easement along the entire levee-top alignment of Phase I of the parkway (Attachment 2, page 5).

The County has agreed to let the City of Sacramento use their real estate interests through a use agreement. The agreement with the County will allow the parkway to continue development. Construction of Phase I of the Ueda Parkway is expected to be completed by November, 2006.

Financial Considerations:

No new funds are requested for this report. The County is not charging the City for use of their real estate interests

Environmental Considerations:

The action of approving a use agreement between two regulatory agencies to protect natural resources is exempt under California Environmental Quality Act (CEQA) Guidelines Section 15307 which states that actions taken by regulatory agencies as authorized by state law or local ordinance to assure the maintenance, restoration, or enhancement of a natural resource where the regulatory process involves procedures for protection of the environment is exempt. No construction activities are involved in this exemption.

Any further actions requiring construction under the agreements have been adequately analyzed within the Negative Declaration for the Ueda Parkway project which was approved on October 13, 1999, by City Council. Mandatory mitigation measures, as specified in the Mitigation Monitoring Plan, have been incorporated into the project plans to avoid identified impacts or to mitigate such impacts to a point where clearly no significant impacts will occur

The Ueda Parkway is partially funded with federal funds; therefore, National Environmental Policy Act (NEPA) requirements must be met. In this case, a biological opinion is needed before a Categorical Exclusion can be issued by Federal Highway Administration (FHWA). It is expected the biological opinion will be issued and staff will return to City Council at that time for final CEQA/NEPA approval.

Policy Considerations:

Providing Parks and Recreation facilities is consistent with the City's strategic plan to enhance liveability in Sacramento's neighborhoods by expanding park facilities throughout the City.

Emerging Small Business Development (ESBD):

Not applicable.

Respectfully Submitted by: 

ROBERT G. OVERSTREET II
Director of Parks and Recreation

Recommendation Approved:

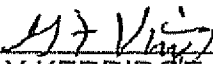

for RAY KERRIDGE
City Manager

Table of Contents:

Pgs	1-3	Report
Pg	4	Attachment 1 – Ueda Parkway Aerial
Pg	5	Attachment 2 – County Easements on the Ueda Parkway
Pg	6	Resolution

Attachment 1 – Ueda Parkway Aerial

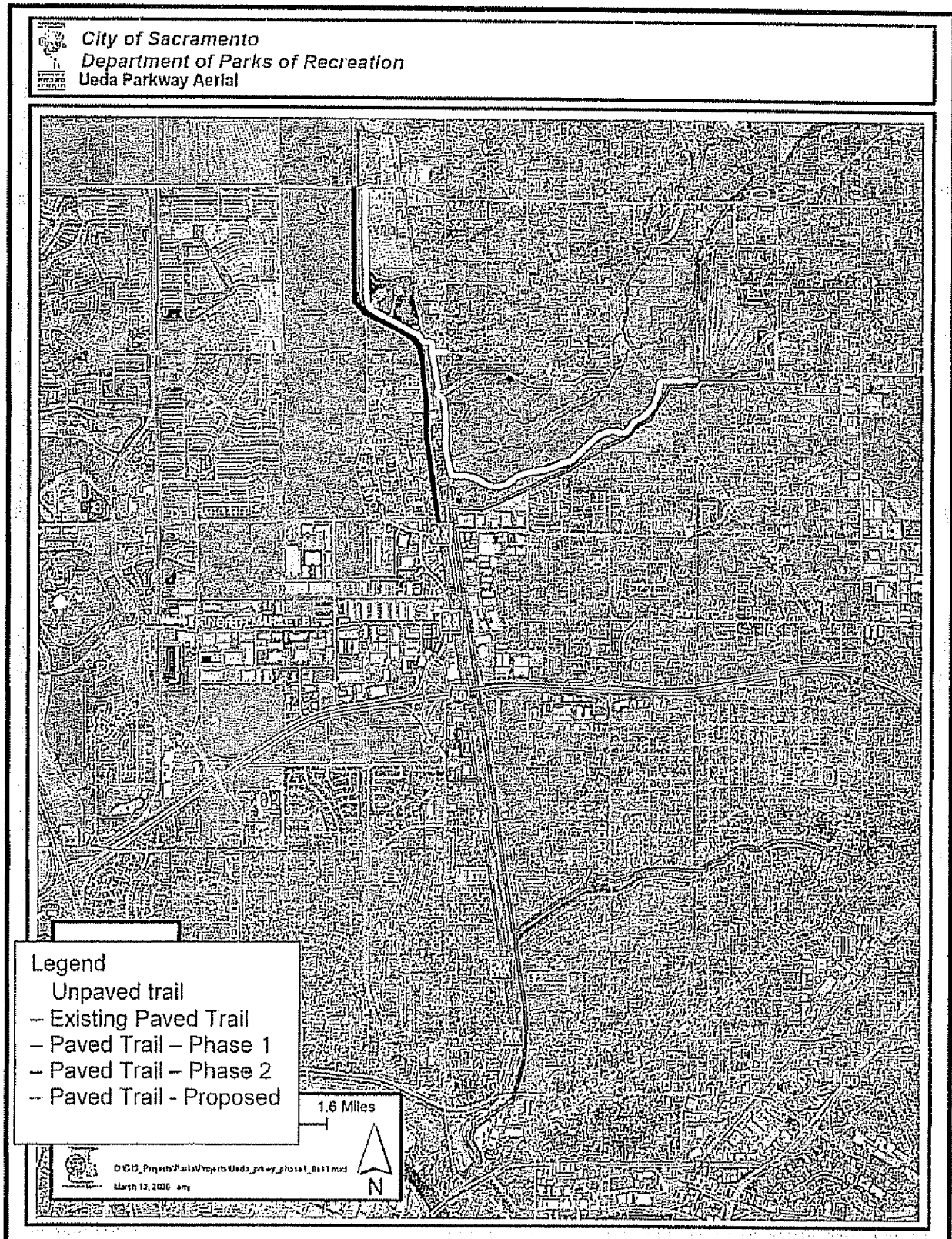

Attachment 2 – County Easements on the Ueda Parkway

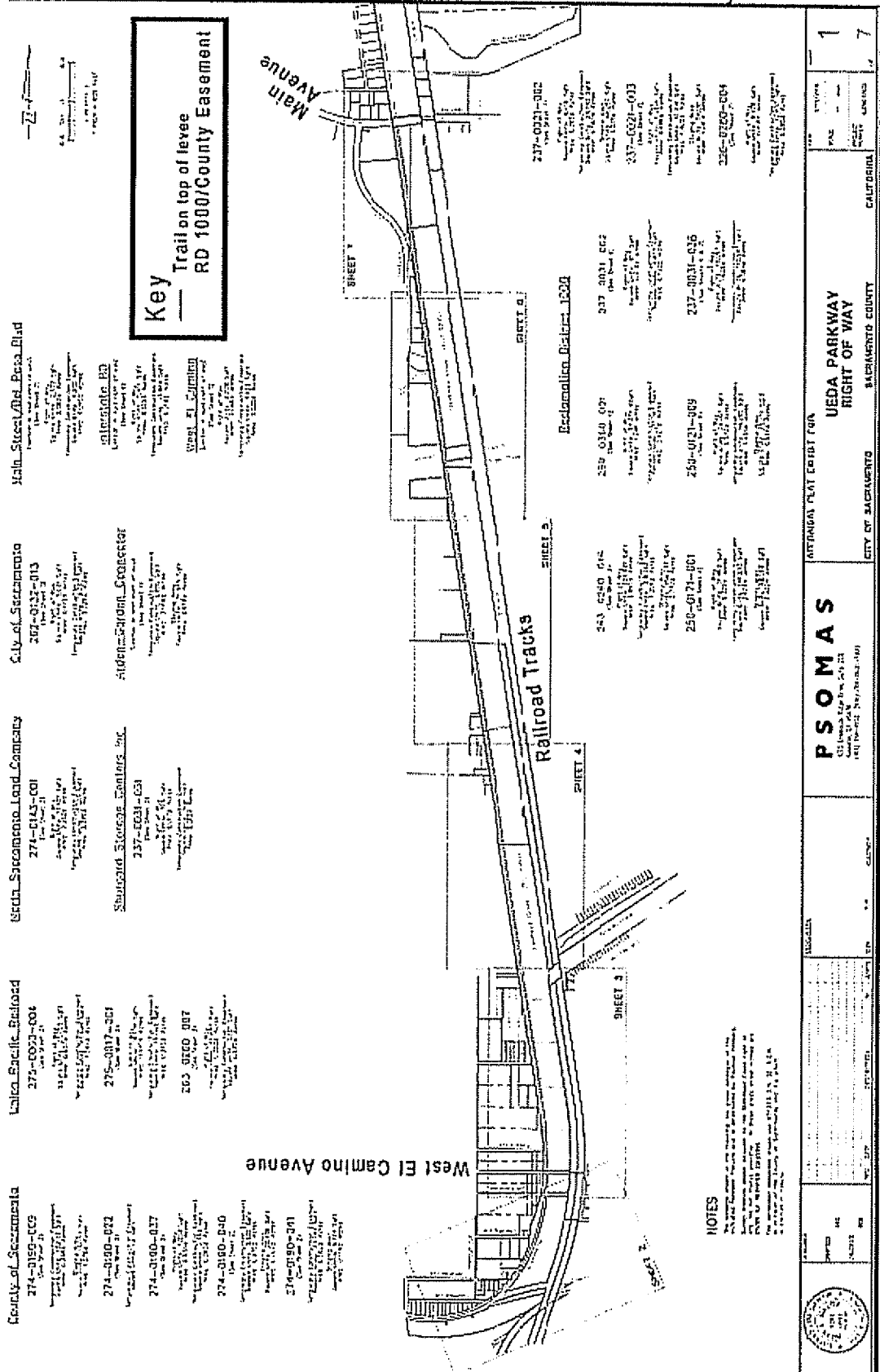

NOTES
 1. All easements shown on this plan are subject to the terms and conditions of the respective easement documents.
 2. The easement shown on this plan is for the purpose of the Ueda Parkway project.
 3. The easement shown on this plan is for the purpose of the Ueda Parkway project.
 4. The easement shown on this plan is for the purpose of the Ueda Parkway project.

	PREPARED BY DATE DRAWN BY	PROJECT NO. SHEET NO.	CITY OF SACRAMENTO SACRAMENTO COUNTY CALIFORNIA	1 7
	ATTORNEY AT LAW FOR P S O M A S 1515 J Street, Suite 400 Sacramento, CA 95811			UEDA PARKWAY RIGHT OF WAY

RESOLUTION NO. 2006-XXXX

Adopted by the Sacramento City Council

April 18, 2006

**APPROVING THE USE AGREEMENT BETWEEN THE CITY OF SACRAMENTO
AND THE COUNTY OF SACRAMENTO FOR UEDA PARKWAY PHASE I, CIP HB16**

BACKGROUND:

- A. The Ueda Parkway is an important part of a regional trail system that offers both recreation and commuter opportunities. The Ueda Parkway consists of approximately 12.5 miles of paved recreation trails that are mostly on the crown of levees; Phase I will be from Main Avenue to West El Camino Avenue.
- B. The County of Sacramento currently owns recreation parcel easements where Phase I of the Ueda Parkway will be located. The County has agreed to let the City of Sacramento use their real estate interests through a use agreement.

**BASED ON THE FACTS SET FORTH IN THE BACKGROUND, THE CITY COUNCIL
RESOLVES AS FOLLOWS:**

- Section 1. Approves the Use Agreement between the City of Sacramento and the County of Sacramento for Ueda Parkway Phase I, CIP HB16.

