

CITY OF SACRAMENTO
1231 I Street, Sacramento, CA 95814

Permit No: 0312565
Insp Area: 2
Thos Bros: 338 A4

Site Address: 6051 MACK RD SAC St: CHOWKING
Parcel No: 118-0103-009

Sub-Type: REM
Housing (Y/N): N

CONTRACTOR
FOCUS CONSTRUCTION CO
1852 S MANHATTAN PL
LOS ANGELES, CA 90019

OWNER
OTR DAYTON HUDSON CORP)
777 NICOLLET MALL
MINNEAPOLIS MN 55402

ARCHITECT
LEO CHO
550 S. WITTON PL
LOS ANGELES CA 90020

Nature of Work: REMODEL-2220SF TENNANT SPACE "CHOWKING" RESTAURANT

CONSTRUCTION LENDING AGENCY : I hereby affirm under penalty of perjury that there is a construction lending agency for the performance of the work for which this permit is issued (Sec. 3097, Civ. C).

Lender's Name _____ Lender's Address _____

LICENSED CONTRACTORS DECLARATION: I hereby affirm under penalty of perjury that I am licensed under provisions of Chapter 9 (commencing with section 7000) of Division 3 of the Business and Professions Code and my license is in full force and effect.

License Class Ch License Number 664521 Date 1/17/04 Contractor Signature [Signature]

OWNER-BUILDER DECLARATION: I hereby affirm under penalty of perjury that I am exempt from the contractors License Law for the following reason (Sec. 7031.5, Business and Professions Code; any city or county which requires a permit to construct, alter, improve, demolish, or repair any structure, prior to its issuance, also requires the applicant for such permit to file a signed statement that he or she is licensed pursuant to the provisions of the Contractors License Law (Chapter 9 (commencing with Section 7000) of Division 8 of the Business and Professions Code) or that he or she is exempt therefrom and the basis for the alleged exemption. Any violation of Section 7031.5 by any applicant for a permit subjects the applicant to a civil penalty of not more than five hundred dollars (\$500.00);

I, as a owner of the property, or my employees with wages as their sole compensation, will do the work, and the structure is not intended or offered for sale (Sec. 7044, Business and Professional Code: The Contractors License Law does not apply to an owner of property who builds or improves thereon, and who does such work himself or herself or through his/her own employees, provided that such improvements are not intended or offered for sale. If, however, the building or improvement is sold within one year of completion, the owner-builder will have the burden of proving that he/she did not build or improve for the purpose of sale.)

I, as owner of the property, am exclusively contracting with licensed contractors to construct the project (Sec. 7044, Business and Professions Code: The Contractors License Law does not apply to an owner of property who builds or improves thereon, and who contracts for such projects with a contractor(s) licensed pursuant to the Contractors License Law).

I am exempt under Sec. _____ B & PC for this reason: _____

Date _____ Owner Signature _____

IN ISSUING THIS BUILDING PERMIT, the applicant represents, and the city relies on the representation of the applicant, that the applicant verified all measurements and locations shown on the application or accompanying drawings and that the improvement to be constructed does not violate any law or private agreement relating to permissible or prohibited locations for such improvements. This building permit does not authorize any illegal location of any improvement or the violation of any private agreement relating to location of improvements.

I certify that I have read this application and state that all information is correct. I agree to comply with all city and county ordinances and state laws relating to building construction and hereby authorize representative(s) of this city to enter upon the abovementioned property for inspection purposes.

Date 1/17/04 Applicant/Agent Signature [Signature]

WORKER'S COMPENSATION DECLARATION: I hereby affirm under penalty of perjury one of the following declarations:

I have and will maintain a certificate of consent to self-insure for workers' compensation as provided for by Section 3700 of the Labor Code, for the performance of work for which the permit is issued.

I have and will maintain workers' compensation insurance, as required by Section 3700 of the Labor Code, for the performance of the work for which this permit is issued. My workers' compensation insurance carrier and policy number are:

Carrier STATE COMPENSATION INS FUND Policy Number 1510673 Exp Date 06/01/2004

(This section need not be completed if the permit is for \$100 or less) I certify that in the performance of the work for which this permit is issued, I shall not employ any person in any manner so as to become subject to the workers' compensation laws of California and agree that if I should become subject to the workers' compensation provisions of Section 3700 of the Labor Code, I shall forthwith comply with those provisions.

Date 1/17/04 Applicant Signature [Signature]

WARNING: FAILURE TO SECURE WORKER'S COMPENSATION COVERAGE IS UNLAWFUL AND SHALL SUBJECT AN EMPLOYER TO CRIMINAL PENALTIES AND CIVIL FINES UP TO ONE HUNDRED THOUSAND DOLLARS (\$100,000) IN ADDITION TO THE COST OF COMPENSATION, DAMAGES AS PROVIDED FOR IN SECTION 3706 OF THE LABOR CODE, INTEREST AND ATTORNEY'S FEE.

THIS PERMIT SHALL EXPIRE BY LIMITATION IF WORK IS NOT COMMENCED WITHIN 180 DAYS.

CITY OF SACRAMENTO

30 DAY TEMPORARY
Certificate of Occupancy
For Information Contact (916) 264-5716

Building Address: 6051 MACK RD Permit No.: 0312565
Building Use: RESTAURANT DBA CHOW KING Occupancy: A-3
Building Owner: OTR DAYTON HUDSON CORP Construction Type: V-1H
Owner Address: MINNEAPOLIS, MN Sprinkled? Yes No
Portion of Building Occupied: TI CHOW KING Area: 2,220 Sq. Ft.

Specific purpose for temporary occupancy and/or conditions/limitations of temporary occupancy:

05/04/2004 LESLIE LUNDHOLM  DENNIS RICHARDSON
Date By: (Print) Sign CHIEF BUILDING OFFICIAL

[TCO approvals::KR,MS,MW,CP]

CBC 109.4 TEMPORARY CERTIFICATE

If the Chief Building Official finds that no substantial hazard will result from occupancy of any building or portion thereof before the same is completed, a temporary Certificate of Occupancy may be issued for the use of a portion or portions of a building or structure prior to the completion for the entire building or structure.

POST IN A CONSPICUOUS PLACE

CIRCO System Balance, Inc.

EB JOB# _____
 SECTION _____ PAGE _____
 DATE 9/26/6

FAN & OUTLET TEST SHEET WITH POWER EXHAUST

AREA SERVED KITCHEN MAKE-UP CHOW KING UNIT EC-2

MOTOR NAMEPLATE DATA

MFG ADSMITH FR 564
 HP 1 1/2 V 115 FLA 16.4
 PH 1 SF 1.20 RPM 1725

SHEAVE DATA:

DIA 1 1/2 SHAFT 5/8
 ADJ % V MAX FIXED

FAN NAMEPLATE DATA

MFG ADCOB AIR
 MODEL # ES 830
 TYPE EVAP COOLER
 SIZE _____

SHEAVE DATA:

DIA 1 1/4 SHAFT 1
 BELTS (1) A-77

DATA	TEST 1	TEST 2	ECON. MODE
VOLTS	120	120	
AMPS	10.8	10.8	
B.H.P.	.98	.98	
ROOM PRES.			
R.P.M.	431	431	
S.P. -	.07	.07	
S.P. +	.31	.32	
T.S.P.	.38	.39	
FILTER S.P.	.07	.07	
CFM TOTAL	5132	5176	
CFM R.A.			
CFM O.A.	100%	100%	100%
CFM P.E.			

FAN DESIGN DATA

CFM 5200 MIN. OA _____ SP 15 IN. WC _____ RPM _____ BHP _____

ROOM	OPENING			FACTOR	DESIGN		TEST 1		TEST 2		TEST	
	NO.	TYPE	SIZE		FPM	CFM	FPM	CFM	FPM	CFM	FPM	CFM
	1	CS	20" Ø	2.13	1192	2600	1064	2319	182	2576		
	2				1192	2600	1265	2825	93	2600		
						5200		5132		5176		

POWER EXHAUST FAN DATA

MFG _____ MODEL _____ HP _____ F.L.A. _____
 CFM @ MIN. _____ ROOM PRESS. @ MIN. _____ IN. WC _____ Hz _____
 CFM @ MAX _____ ROOM PRESS. @ MAX _____ IN. WC _____ Hz _____

REMARKS: OUTLET # 3 OMITTED



CIRCO System Balance, Inc.

SB JOB# _____
 SECTION _____ PAGE _____
 DATE 4-26-0

FAN & OUTLET TEST SHEET WITH POWER EXHAUST

AREA SERVED Kitchen MAKE-UP CHOW KING UNIT EC-1

MOTOR NAMEPLATE DATA

MFG A.O. SMITH FR 56
 HP 2 V 115 FLA 29.6
 PH 1 SF 115 RPM 1725

SHEAVE DATA:

DIA 1 1/2 SHAFT 3/8
 ADJ % MID FIXED _____

FAN NAMEPLATE DATA

MFG ADCO AIR
 MODEL # ED 930
 TYPE EVAP COOL
 SIZE _____

SHEAVE DATA:

DIA 1 1/2 SHAFT 1
 BELTS 11A-77

DATA	TEST 1	TEST 2	ECON. M	ODE
VOLTS	120	120		
AMPS	13	16.2		
B.H.P.	.52	.65		
ROOM PRES.				
R.P.M.	461	510		
S.P. -	.18	.12		
S.P. +	.35	.40		
T.S.P.	.45	.52		
FILTER S.P.	.10	.12		
CFM TOTAL	6085	7252		
CFM R.A.				
CFM O.A.	100%	100%		100
CFM P.E.				

FAN DESIGN DATA

CFM 7200 MIN. OA _____ SP .5 IN. WC _____ RPM _____ BHP _____

ROOM	OPENING			FACTOR	DESIGN		TEST 1		TEST 2		TEST 3
	NO.	TYPE	SIZE		FPM	CFM	FPM	CFM	FPM	CFM	
	1	CS	20" D	2.18	1651	3600	1382	3012	142	3579	
	2	1	1	1	1651	3600	1410	3073	685	3673	
						7200		6085		7252	

POWER EXHAUST FAN DATA

MFG _____ MODEL _____ HP _____ F.L.A. _____
 CFM @ MIN. _____ ROOM PRESS. @ MIN. _____ IN. WC _____ Hz _____
 CFM @ MAX _____ ROOM PRESS. @ MAX _____ IN. WC _____ Hz _____

REMARKS: _____



CIRCO System Balance, Inc.

SB JOB# _____
 SECTION _____ PAGE _____
 DATE 4/26/00

FAN & OUTLET TEST SHEET WITH POWER EXHAUST

AREA SERVED DINING AREA JNIT AC-1

MOTOR NAMEPLATE DATA

MFG N/A FR N/A
 HP 1.0 V 230 FLA 7.0
 PH 1 SF N/A RPM N/A

SHAFT DATA:

DIA * SHAFT *
 ADJ % _____ FIXED _____

FAN NAMEPLATE DATA

MFG _____
 MODEL # DBYA-7060N
 TYPE _____
 SIZE _____

SHAFT DATA:

DIA * SHAFT *
 BELTS 0

DATA	TEST 1	TEST 2	ECON. MODE
VOLTS	<u>275</u>	<u>220</u>	
AMPS	<u>5.8</u>	<u>5.8</u>	
B.H.P.	<u>.82</u>	<u>.82</u>	
ROOM PRES.	<u>HIGH SPEED</u>		
R.P.M.	<u>DIRECT DRIVE</u>		
S.P. -	<u>29</u>	<u>22</u>	
S.P. +	<u>30</u>	<u>22</u>	
T.S.P.	<u>59</u>	<u>59</u>	
FILTER S.P.	<u>06</u>	<u>106</u>	
CFM TOTAL	<u>2400</u>	<u>2405</u>	
CFM R.A.	<u>100%</u>	<u>100%</u>	
CFM O.A.			100%
CFM P.E.			

FAN DESIGN DATA

CFM 2400 MIN. OA _____ SP _____ IN. WC _____ RPM _____ BHP _____

ROOM	OPENING			FACTOR	DESIGN		TEST 1		TEST 2		TEST	
	NO.	TYPE	SIZE		FPM	CFM	FPM	CFM	FPM	CFM	FPM	CFM
	5	ES	6x6	1.0								
	6		10"		300	300	320	320	300	300	300	300
	7				300	300	300	300	300	300	300	300
	8				300	300	300	300	300	300	300	300
	9				300	300	350	350	300	300	300	300
	10		12"		400	400	320	320	370	370	370	370
	11				350	350	310	310	350	350	350	350
	12				400	400	360	360	400	400	400	400
					<u>2400</u>	<u>2400</u>			<u>2405</u>			
	R-1	CR	16" D	1.0	1200	1200	1150	1150	1150	1150	1150	1150
	R-2	1		1	1200	1200	1220	1220	1220	1220	1220	1220
							2350	2350	2350	2350	2350	2350

POWER EXHAUST FAN DATA

MFG _____ MODEL _____ HP _____ F.L.A. _____
 CFM @ MIN. _____ ROOM PRESS. @ MIN. _____ IN. WC _____ Hz _____
 CFM @ MAX. _____ ROOM PRESS. @ MAX. _____ IN. WC _____ Hz _____

REMARKS: _____



CIRCO System Balance, Inc.

S3 JOB# _____
 SECTION _____ PAGE _____
 DATE 9/26/08

FAN & OUTLET TEST SHEET WITH POWER EXHAUST

AREA SERVED Kitchen Hood - CHOOKING UNIT EF-1

MOTOR NAMEPLATE DATA

MFG Acorn FR 56H
 HP 2 V 220 FLA 12.3
 PH 1 SF 120 RPM 1725

SHEAVE DATA:

DIA 1.750 SHAFT 5/8
 ADJ % ✓ FIXED _____

FAN NAMEPLATE DATA

MFG DAVTON
 MODEL # BLFCP-22
 TYPE UTILITY
 SIZE _____

SHEAVE DATA:

DIA MA 1.52 SHAFT 3/16
 BELTS U24L830

DATA	TEST 1	TEST 2	ECON. MODE
VOLTS	<u>225</u>	<u>225</u>	
AMPS	<u>4.0</u>	<u>8.9</u>	
B.H.P.	<u>-</u>	<u>1.36</u>	
ROOM PRES.			
R.P.M.		<u>1696</u>	
S.P. -		<u>.52</u>	
S.P. +		<u>-</u>	
T.S.P.		<u>.52</u>	
FILTER S.P.		<u>-</u>	
CFM TOTAL	<u>3452</u>	<u>7279</u>	
CFM R.A.	<u>-</u>	<u>-</u>	
CFM O.A.	<u>-</u>	<u>-</u>	100
CFM P.E.	<u>-</u>	<u>-</u>	

FAN DESIGN DATA

CFM 7200 MIN. OA _____ SP _____ IN. WC _____ RPM _____ BHP _____

ROOM	OPENING			FACTOR	DESIGN		TEST 1		TEST 2		TEST 3	
	NO.	TYPE	SIZE		FPM	CFM	FPM	CFM	FPM	CFM	FPM	CFM

POWER EXHAUST FAN DATA

MFG _____ MODEL _____ HP _____ F.L.A. _____
 CFM @ MIN. _____ ROOM PRESS. @ MIN. _____ IN. WC _____ Hz _____
 CFM @ MAX. _____ ROOM PRESS. @ MAX. _____ IN. WC _____ Hz _____

REMARKS: 16x20
Belt Loose on test #1



CIRCO System Balance, Inc.

SB JOB# _____
 SECTION _____ PAGE _____
 DATE 7/26/09

FAN & OUTLET TEST SHEET WITH POWER EXHAUST

AREA SERVED KITCHEN HOOP CHOW LINE UNIT EF2

MOTOR NAMEPLATE DATA

MFG A.O. SMITH FR 514
 HP 1.5 V 220 FLA 8.2
 PH 1 SF 120 RPM 1725

SHEAVE DATA:

DIA 14L4.6 SHAFT 5/8
 ADJ % MAX FIXED _____

FAN NAMEPLATE DATA

MFG DAVTON
 MODEL # BLFLP 22
 TYPE UTILITY
 SIZE _____

SHEAVE DATA:

DIA MA 15.2 SHAFT 1 3/16 L
 BELTS (1) 4LB30

DATA	TEST 1	TEST 2	ECON. I	ODE
VOLTS	<u>225</u>	<u>225</u>		
AMPS	<u>5.1</u>	<u>7.9</u>		
B.H.P.	<u>1.93</u>	<u>1.44</u>		
ROOM PRES.				
R.P.M.	<u>915</u>	<u>510</u>		
S.P. -	<u>.20</u>	<u>.42</u>		
S.P. +	<u>-</u>	<u>-</u>		
T.S.P.	<u>.20</u>	<u>.42</u>		
FILTER S.P.	<u>-</u>	<u>-</u>		
CFM TOTAL	<u>3465</u>	<u>5276</u>		
CFM R.A.	<u>-</u>	<u>-</u>		
CFM O.A.	<u>-</u>	<u>-</u>		<u>100</u>
CFM P.E.	<u>-</u>	<u>-</u>		

FAN DESIGN DATA

CFM 5200 MIN. OA _____ SP _____ IN. WC _____ RPM _____ BHP _____

ROOM	OPENING			FACTOR	DESIGN		TEST 1		TEST 2		TEST 3
	NO.	TYPE	SIZE		FPM	CFM	FPM	CFM	FPM	CFM	
<u>KITCH</u>	<u>1</u>	<u>FLY</u>	<u>14X230</u>	<u>22.36</u>	<u>232</u>	<u>5200</u>	<u>155</u>	<u>3465</u>	<u>36</u>	<u>5276</u>	

POWER EXHAUST FAN DATA

MFG _____ MODEL _____ HP _____ F.L.A. _____
 CFM @ MIN. _____ ROOM PRESS. @ MIN. _____ IN. WC _____ Hz _____
 CFM @ MAX _____ ROOM PRESS. @ MAX _____ IN. WC _____ Hz _____

REMARKS: 16X26



APPLICATION FOR COMMERCIAL BUILDING PERMIT

CITY OF SACRAMENTO
 DEVELOPMENT SERVICES DIVISION
 PERMIT SERVICES SECTION

1231 I Street, Rm. 200
 Sacramento, CA 95814 (916) 264-7619 FAX 264-7046

ACTIVITY # <u>0312565</u>	Insp. Area
---------------------------	------------

Applicant **MUST** complete ALL Unshaded areas

ADDRESS 6051 MACK ROAD Suite _____
 PARCEL # _____

<p style="text-align: center;">CONTACT</p> <p>Name <u>LEO FLOR</u></p> <p>Street Address <u>550 S. WILTON PL</u></p> <p>City/State/Zip <u>LOS ANGELES, CA 90020</u></p> <p>Phone <u>(213) 387-7788</u> FAX <u>213-387-4567</u></p> <p>E-mail: <u>9pla@9plinc.us</u></p>	<p style="text-align: center;">LICENSED CONTRACTOR Lic No. # _____</p> <p>Name _____</p> <p>Address _____</p> <p>City/State/Zip _____</p> <p>Phone _____ FAX _____</p> <p>E-mail: _____</p>
<p style="text-align: center;">ARCHITECT/ENG/NEER</p> <p>Name <u>LEO CHO</u></p> <p>Address <u>550 S. WILTON PLACE</u></p> <p>City/State/Zip <u>LOS ANGELES</u></p> <p>Phone <u>(213) 387-7788</u> FAX <u>213-387-4567</u></p> <p>E-mail: <u>9pla@9plinc.us</u></p>	<p style="text-align: center;">OWNER</p> <p>Name <u>RAMON SARPOSANTOS</u></p> <p>Address <u>914 S. AJAX ST.</u></p> <p>City/State/Zip <u>INDUSTRY, CA 91748</u></p> <p>Phone <u>(626) 940-0188</u> FAX _____</p> <p>E-mail: _____</p>

→ Will permittee have any employees or the jobsite? No Yes → INSURANCE CO: _____
 → WORKER'S COMPENSATION POLICY # _____ EXPIRATION DATE: _____

NATURE OF WORK IN DETAIL: 2220 SF Commercial Tenant Unit
REMODEL - RESTAURANT "SHOW KING"

OCCUPANT/TENANT: _____ VALUATION: \$ _____

FLOOD STATUS:			S.C.A.T.							
JOB DESCRIPTION		BLDG	SHELL	APT	TI()	REM()	SW	FIRE	ADD	OTH
INSPECTION DISCIPLINES			BLDG	MECH	PLUMB	ELEC	SITE	FIRE		
# Stories	1st flr Area	Total Area	Use Zone	Occp Group	Const type	Fire Req. Y/N		Fed Code	Vio. File	
						SPR	ALARM		[H]	[Quad]
<u>B</u>	<u>L</u>	<u>P</u>	<u>M</u>	<u>E</u>	<u>F</u>	<u>S</u>	<u>D</u>	<u>2</u>	PW	UTIL

COMMENTS: HEALTH DPT PLANS NOT DRAWN UP AT THIS TIME - APPLICANT NOTIFIED TO RETURN W/ APPROVED HD PLANS.

REGIONAL SANITATION FEES? Yes No HEALTH DEPARTMENT? Yes No

WATER FLOW TEST FOR NEW BUILDINGS OR ADDITIONS? Provided Faxed

6051 Mack Rd.

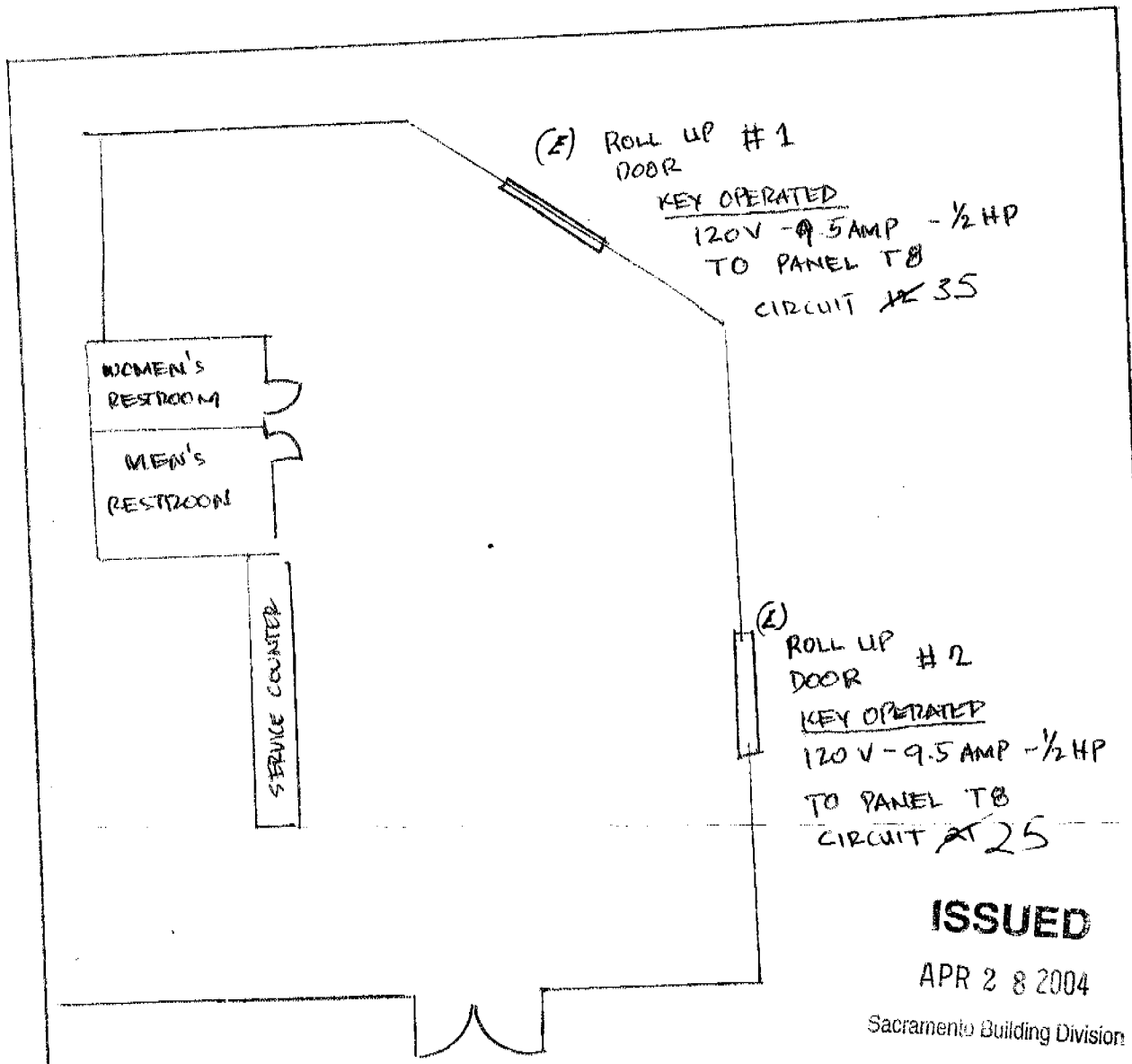

ISSUED

APR 28 2004

Sacramento Building Division

The approval of all electrical work is subject to field instructions.

Revision as per ch. Add door operant.

APPROVED FOR 1999
 T.L.M. 4-28-4

CITY COPY

MAY 28, 2004	CHOWKING RESTAURANT	REVISION
PERMIT # 0312565	6051 MACK ROAD SACRAMENTO, CA	ROLL UP GATE

0312565

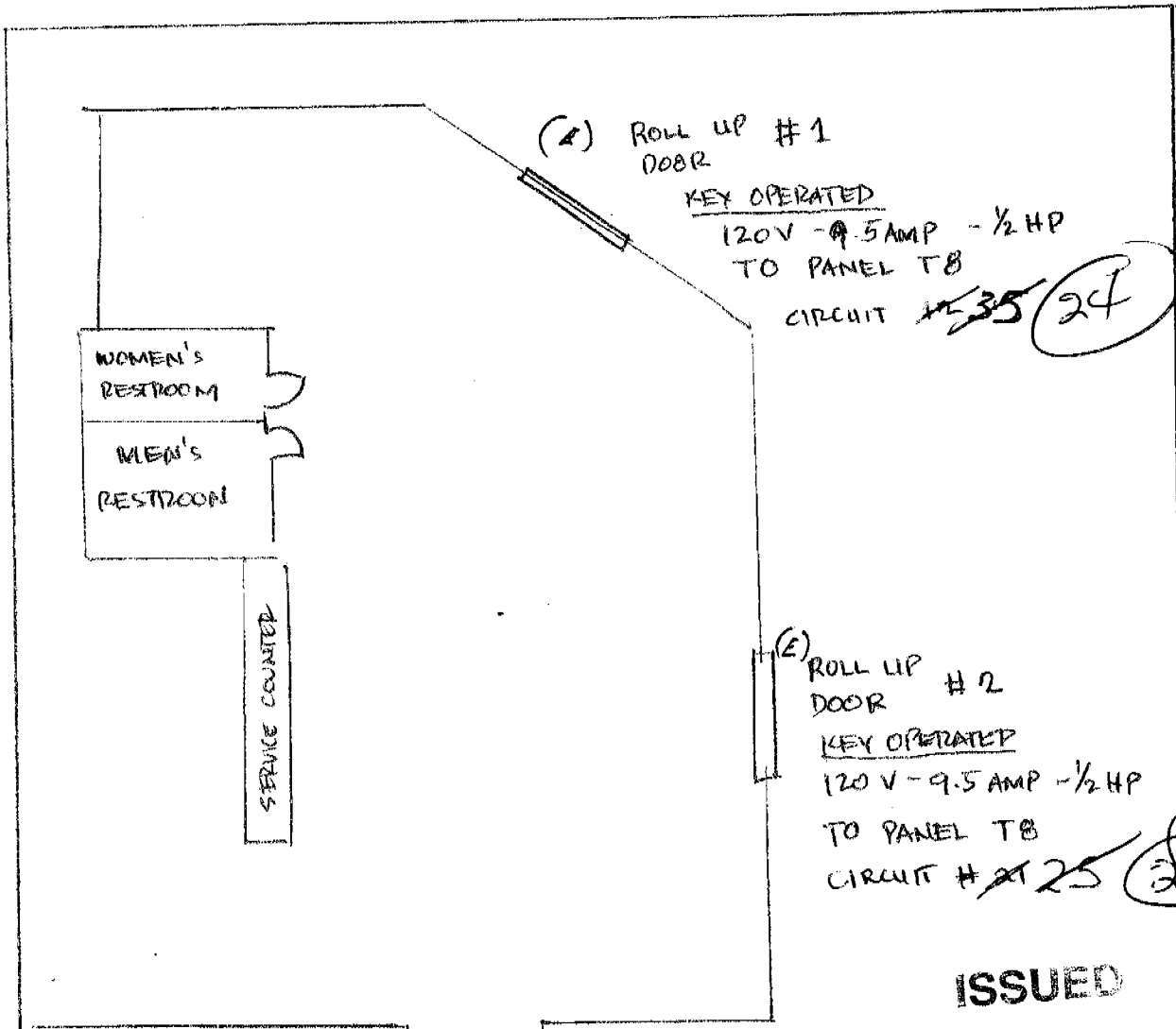

ISSUED

APR 28 2004

Sacramento Building Division

The approval of all
Electrical work is subject to field
inspections

Revision as per C.N. add Elect door operny.

APPROVED FOR 1999
NATIONAL ELECTRICAL CODE
AND ALL CITY ORDINANCES
APPLICABLE
T.L.M. 4-28-4
ELECTRICAL DIVISION

JOB COPY

MAY 28, 2004	CHOWKING RESTAURANT	REVISION
PERMIT # 0312565	6051 MACK ROAD SACRAMENTO, CA	ROLL UP GATE

0312565