

CITY OF SACRAMENTO

Permit No: 0115007

1231 I Street, Sacramento, CA 95814

Insp Area: 2

Site Address: 1236 KONDOS AV SAC

Thos Bros:

Parcel No: 006-0281-070

CAPITOL PARK HOMES LOT 63

Sub-Type: NSFR

Housing (Y/N): N

CONTRACTOR

CNM CONSTRUCTION CO
818 19TH ST
SACRAMENTO CA. 95814

OWNER

ARCHITECT

Nature of Work: MP 1448 3 STORY 7 ROOM SFR

CONSTRUCTION LENDING AGENCY : I hereby affirm under penalty of perjury that there is a construction lending agency for the performance of the work for which this permit is issued (Sec. 3097, Civ. C).

Lender's Name

Lender's Address

LICENSED CONTRACTORS DECLARATION: I hereby affirm under penalty of perjury that I am licensed under provisions of Chapter 9 (commencing with section 7000) of Division 3 of the Business and Professions Code and my license is in full force and effect.

License Class

License Number 767087

Date 11-26-01

Contractor Signature

OWNER-BUILDER DECLARATION: I hereby affirm under penalty of perjury that I am exempt from the contractors License Law for the following reason (Sec. 7031.5, Business and Professions Code; any city or county which requires a permit to construct, alter, improve, demolish, or repair any structure, prior to its issuance, also requires the applicant for such permit to file a signed statement that he or she is licensed pursuant to the provisions of the Contractors License Law (Chapter 9 (commencing with Section 7000) of Division 8 of the Business and Professions Code) or that he or she is exempt therefrom and the basis for the alleged exemption. Any violation of Section 7031.5 by any applicant for a permit subjects the applicant to a civil penalty of not more than five hundred dollars (\$500.00);

I, as a owner of the property, or my employees with wages as their sole compensation, will do the work, and the structure is not intended or offered for sale (Sec. 7044, Business and Professional Code: The Contractors License Law does not apply to an owner of property who builds or improves thereon, and who does such work himself or herself or through his/her own employees, provided that such improvements are not intended or offered for sale. If, however, the building or improvement is sold within one year of completion, the owner-builder will have the burden of proving that he/she did not build or improve for the purpose of sale.)

I, as owner of the property, am exclusively contracting with licensed contractors to construct the project (Sec. 7044, Business and Professions Code: The Contractors License Law does not apply to an owner of property who builds or improves thereon, and who contracts for such projects with a contractor(s) licensed pursuant to the Contractors License Law).

I am exempt under Sec. B & PC for this reason:

Date 11-26-01

Owner Signature

IN ISSUING THIS BUILDING PERMIT, the applicant represents, and the city relies on the representation of the applicant, that the applicant verified all measurements and locations shown on the application or accompanying drawings and that the improvement to be constructed does not violate any law or private agreement relating to permissible or prohibited locations for such improvements. This building permit does not authorize any illegal location of any improvement or the violation of any private agreement relating to location of improvements.

I certify that I have read this application and state that all information is correct. I agree to comply with all city and county ordinances and state laws relating to building construction and hereby authorize representative(s) of this city to enter upon the abovementioned property for inspection purposes.

Date 11-26-01

Applicant/Agent Signature

WORKER'S COMPENSATION DECLARATION: I hereby affirm under penalty of perjury one of the following declarations:

I have and will maintain a certificate of consent to self-insure for workers' compensation as provided for by Section 3700 of the Labor Code, for the performance of work for which the permit is issued.

I have and will maintain workers' compensation insurance, as required by Section 3700 of the Labor Code, for the performance of the work for which this permit is issued. My workers' compensation insurance carrier and policy number are:

Carrier STATE FUND

Policy Number 713-01 UNIT 0007764

Exp Date 10/01/2002

(This section need not be completed if the permit is for \$100 or less) I certify that in the performance of the work for which this permit is issued, I shall not employ any person in any manner so as to become subject to the workers' compensation laws of California and agree that if I should become subject to the workers' compensation provisions of Section 3700 of the Labor Code, I shall forthwith comply with those provisions.

Date 11-26-01

Applicant Signature

WARNING: FAILURE TO SECURE WORKER'S COMPENSATION COVERAGE IS UNLAWFUL AND SHALL SUBJECT AN EMPLOYER TO CRIMINAL PENALTIES AND CIVIL FINES UP TO ONE HUNDRED THOUSAND DOLLARS (\$100,000) IN ADDITION TO THE COST OF COMPENSATION, DAMAGES AS PROVIDED FOR IN SECTION 3706 OF THE LABOR CODE, INTEREST AND ATTORNEY'S FEE.

THIS PERMIT SHALL EXPIRE BY LIMITATION IF WORK IS NOT COMMENCED WITHIN 180 DAYS.

RESIDENTIAL SUBDIVISION BUILDING PERMIT APPLICATION

PLAN 2

132A

Project Address: 1236 Kondas
 Lot Number: 63

Assessor Parcel # 006-281-070
 Subdivision Capitol Park Homes

OWNER INFORMATION:

Legal Property Owner: Shasta Dawn Twin Dev. Phone# 449-8989
 Owner Address: 818 19th St. City Sacto. State CA Zip 95814

CONTRACTOR INFORMATION:

Contractor: CNM Const Lic. # 767087 Phone # 449-8989 Fax 449-8865

PROJECT INFORMATION:

Land Use Zone R1A Occupancy Group R3 Construction Type VN Fed Code 1A
 No. of Stories: 3 No. of Rooms: 9 Street Width: 20
 1st Floor Area 998 2nd Floor Area 432 Basement - Roof Material COMP

AREA IN SQUARE FOOT OF:

Dwelling/Living 1430
 Garage/Storage 626/355
 Decks/Balconies 91
 Carports -

SCOPE OF WORK: NEW SINGLE FAMILY RESIDENCE

FOR OFFICE USE ONLY

- Information Above Complete
- Violation Files Checked
- Standard Setbacks
- County Sewer
- AR Flood Waiver Required
- Flood Elevation Certificate Required
- Water Development Infill Area
- Planning Approval
- Design Review Approval
- Special Fee Districts Apply:

THE FOLLOWING MUST BE PROVIDED IN ORDER TO SUBMIT FOR PERMIT

- 2 COMPLETE PLOT PLANS, LEGIBLE & DRAWN TO SCALE
- 11 X 17 COPY OF FLOOR PLAN WITH FOLLOWING INFORMATION
 - a) Assessor's Parcel Number
 - b) New Floor Area
 - c) Owners Name
 - d) Project Address

Date: _____ Received by: (staff) _____ Permit # _____

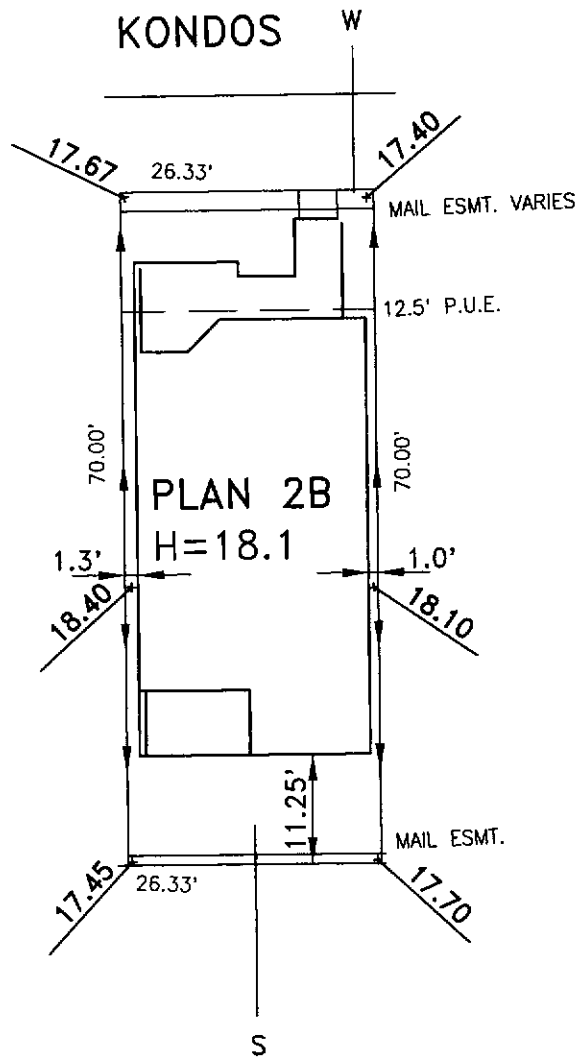

MOTOR COURT "E"

SCALE: 1"=20'

This set of plans and specifications must be kept on file in the office of the City Engineer to make any of the same available for use during the term of the same.

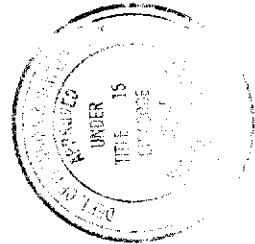

NOTE:

This plan is only intended to reference the building plan designated for this lot. All setbacks other than minimum code requirements are approximate. The "as-built" field condition may vary from this plan.

DATE: 10-23-01
A.P.N.: 006-281-070
ADDRESS: 1236 KONDOS

LOT AREA: 1843
LOT COVERAGE: 58%



Stantec

Stantec Consulting Inc.
 2590 Venture Oaks Way
 Sacramento, CA 95833-3288
 Tel. 916.925.5550
 Fax. 916.921.9274
 www.stantec.com

CAPITOL PARK
 LOT 63
 PLAN 2B

Client/Project
CNM CONSTRUCTION

Figure No.
1.0

Title
CAPITOL PARK
City of Sacramento, CA

October 2001
 84400121

CERTIFICATION OF INSULATION

ADDRESS OR TRACT

INSULATION BUILDING PRODUCTS

CNM CONST.

LOT # 63

- P.O. BOX 854, WEST SACRAMENTO, CA 95691 LIC. #202026
- 1309 MELODY ROAD, MARYSVILLE, CA 95901 LIC. #202026
- P.O. BOX 9651, FRESNO, CA 93793-9651 LIC. #202026
- P.O. BOX 1631, RENO, NV 89505 LIC. #10675
- 3326 A PONDEROSA WAY, LAS VEGAS, NV 89118 LIC. #10675

CAPITAL PARK HOME

DATE INSULATION COMPLETED
8-13-02

PART I GENERAL PART II AREAS INSULATED PART III CERTIFICATION

WALLS			CEILING			FLOORS		
(SQUARE FEET)			(SQUARE FEET)			(SQUARE FEET)		
TYPE OF INSULATION			TYPE OF INSULATION			TYPE OF INSULATION		
MATERIAL FIBERGLASS			MATERIAL FIBERGLASS			MATERIAL FIBERGLASS		
FORM BATTS			FORM BATTS & BLOW			FORM BATTS		
MANUFACTURER'S PRODUCT I.D.			MANUFACTURER'S PRODUCT I.D.			MANUFACTURER'S PRODUCT I.D.		
MANUFACTURER			MANUFACTURER			MANUFACTURER		
CT	OC	JM	CT	OC	JM	CT	OC	JM
BAGS								
R-VALUE INSTALLED	APPLIED THICKNESS	R-VALUE INSTALLED	APPLIED THICKNESS	MIN. INSTALLED WEIGHT PER SQUARE FOOT	R-VALUE INSTALLED	APPLIED THICKNESS		
13	3 1/2"	30	9"					

WALLS IF R-VALUE IS OTHER THAN WALLS ABOVE

MATERIAL FIBERGLASS	FORM BATTS	R VALUE	MANUFACTURER		
			CT	OC	JM

AIR INFILTRATION SEALANT

MATERIAL FOAM	MANUFACTURER	
	HILTI	HANDY FOAM

THIS IS TO CERTIFY THAT INSULATION AND/OR SEALANT HAS BEEN INSTALLED IN CONFORMANCE WITH APPLICABLE CODES, MATERIAL STANDARDS AND REGULATIONS.

SIGNATURE — INSULATION CONTRACTOR <i>[Signature]</i>	TITLE MANAGER	DATE 8-14-02
SIGNATURE — GENERAL CONTRACTOR <i>[Signature]</i>	TITLE	DATE

REMARKS