

CITY OF SACRAMENTO
1231 I Street, Sacramento, CA 95814

Permit No: 0103615
Insp Area: 4

Site Address: 150 LYMAN CR SAC
Parcel No: 225-1290-039 NORTHPT PK 13-1 LOT 39

Sub-Type: NSFR
Housing (Y/N): N

CONTRACTOR
WESTERN PACIFIC HOUSING
1210 CENTRAL BLVD
BRENTWOOD CA 94513

OWNER
WESTERN PACIFIC HOUSING
1210 CENTRAL BLVD
BRENTWOOD CA 94513

ARCHITECT

Nature of Work: NSFR MP2736/OPT 2 STORY 11 RMS

CONSTRUCTION LENDING AGENCY: I hereby affirm under penalty of perjury that there is a construction lending agency for the performance of the work for which this permit is issued (Sec. 3097, Civ. C).

Lender's Name _____ Lender's Address _____

LICENSED CONTRACTORS DECLARATION: I hereby affirm under penalty of perjury that I am licensed under provisions of Chapter 9 (commencing with section 7000) of Division 3 of the Business and Professions Code and my license is in full force and effect.

License Class B License Number 675769 Date 4/3/01 Contractor Signature N. Collins

OWNER-BUILDER DECLARATION: I hereby affirm under penalty of perjury that I am exempt from the contractors License Law for the following reason (Sec. 7031.5, Business and Professions Code, any city or county which requires a permit to construct, alter, improve, demolish, or repair any structure, prior to its issuance, also requires the applicant for such permit to file a signed statement that he or she is licensed pursuant to the provisions of the Contractors License Law (Chapter 9 (commencing with Section 7000) of Division 8 of the Business and Professions Code) or that he or she is exempt therefrom and the basis for the alleged exemption. Any violation of Section 7031.5 by any applicant for a permit subjects the applicant to a civil penalty of not more than five hundred dollars (\$500.00):

_____, I, as a owner of the property, or my employees with wages as their sole compensation, will do the work, and the structure is not intended or offered for sale (Sec. 7044, Business and Professional Code: The Contractors License Law does not apply to an owner of property who builds or improves thereon, and who does such work himself or herself or through his/her own employees, provided that such improvements are not intended or offered for sale. If, however, the building or improvement is sold within one year of completion, the owner-builder will have the burden of proving that he/she did not build or improve for the purpose of sale.)

_____, I, as owner of the property, am exclusively contracting with licensed contractors to construct the project (Sec. 7044, Business and Professions Code: The Contractors License Law does not apply to an owner of property who builds or improves thereon, and who contracts for such projects with a contractor(s) licensed pursuant to the Contractors License Law).

_____, I am exempt under Sec. _____ B & PC for this reason: _____

Date _____ Owner Signature _____

IN ISSUING THIS BUILDING PERMIT, the applicant represents, and the city relies on the representation of the applicant, that the applicant verified all measurements and locations shown on the application or accompanying drawings and that the improvement to be constructed does not violate any law or private agreement relating to permissible or prohibited locations for such improvements. This building permit does not authorize any illegal location of any improvement or the violation of any private agreement relating to location of improvements.

I certify that I have read this application and state that all information is correct. I agree to comply with all city and county ordinances and state laws relating to building construction and hereby authorize representative(s) of this city to enter upon the abovementioned property for inspection purposes.

Date 4/3/01 Applicant/Agent Signature N. Collins

WORKER'S COMPENSATION DECLARATION: I hereby affirm under penalty of perjury one of the following declarations:

_____, I have and will maintain a certificate of consent to self-insure for workers' compensation as provided for by Section 3700 of the Labor Code, for the performance of work for which the permit is issued

I have and will maintain workers' compensation insurance, as required by Section 3700 of the Labor Code, for the performance of the work for which this permit is issued. My workers' compensation insurance carrier and policy number are:

Carrier: EAGLE INS. CO. Policy Number 4S-0000273 Exp Date 03/19/2001

_____, (This section need not be completed if the permit is for \$100 or less) I certify that in the performance of the work for which this permit is issued, I shall not employ any person in any manner so as to become subject to the workers' compensation laws of California and agree that if I should become subject to the workers' compensation provisions of Section 3700 of the Labor Code, I shall forthwith comply with those provisions.

Date 4/3/01 Applicant Signature N. Collins

WARNING: FAILURE TO SECURE WORKER'S COMPENSATION COVERAGE IS UNLAWFUL AND SHALL SUBJECT AN EMPLOYER TO CRIMINAL PENALTIES AND CIVIL FINES UP TO ONE HUNDRED THOUSAND DOLLARS (\$100,000) IN ADDITION TO THE COST OF COMPENSATION, DAMAGES AS PROVIDED FOR IN SECTION 3706 OF THE LABOR CODE, INTEREST AND ATTORNEY'S FEE.

THIS PERMIT SHALL EXPIRE BY LIMITATION IF WORK IS NOT COMMENCED WITHIN 180 DAYS.

RESIDENTIAL SUBDIVISION BUILDING PERMIT APPLICATION

Project Address: 150 Lyman Circle Assessor Parcel # 225-1290-039
Lot Number: 39 Subdivision Northpointe Park Unit # 13 Pt 1

OWNER INFORMATION:

Legal Property Owner: Western Pacific Housing Phone# (925) 634-6023
Owner Address: 1210 Central Boulevard; City Brentwood, State Ca. Zip 94513

CONTRACTOR INFORMATION:

Contractor: Western Pacific Lic# 675709/B Phone # (925) 634-6023 Fax 634-6166

PROJECT INFORMATION:

Land Use Zone RIA Occupancy Group R3 Construction Type VN Fed Code 1A
No. of Stories: 2 No. of Rooms: 11 Street Width: _____
1st Floor Area 1359 2nd Floor Area _____ Basement _____ Roof Material _____

AREA IN SQUARE FOOT OF:

Dwelling/Living 2892
Garage/Storage 677
Decks/Balconies 122
Carports _____

SCOPE OF WORK: _____

- Information Above Complete
- Violation Files Checked
- Standard Setbacks
- County Sewer
- AR Flood Waiver Required
- Flood Elevation Certificate Required
- Water Development Infill Area
- Planning Approval
- Design Review Approval
- Special Fee Districts Apply:

THE FOLLOWING MUST BE PROVIDED IN ORDER TO SUBMIT FOR PERMIT

- 2 COMPLETE PLOT PLANS, LEGIBLE & DRAWN TO SCALE
- 11 X 17 COPY OF FLOOR PLAN WITH FOLLOWING INFORMATION
 - a) Assessor's Parcel Number
 - b) New Floor Area
 - c) Owners Name
 - d) Project Address

COUNTY SANITATION DISTRICT NO. 1
 SACRAMENTO REGIONAL COUNTY SANITATION DISTRICT
SEWER IMPACT FEE *ETB*
 PERMIT AND CALCULATION SHEET *4-2-01*

APPLICATION NO:

BLDG. PERMIT NO:

GENERAL INFORMATION
FEE PAID WITH

THIS PERMIT GOOD ONLY WHEN
 VALIDATED BY THE CASHIER

269449

269441

*CTY ETB
 4-2-01*

SADD 2601 - 00162

THIS PERMIT TO CONNECT EXPIRES
 ONE YEAR FROM DATE OF ISSUANCE

FEE CALCULATION

BUILDING USE

| INSPECTION | RESIDENTIAL | SF | <input checked="" type="checkbox"/> | MF | <input type="checkbox"/> | UNITS |
|------------------|-------------|--------------|-------------------------------------|----|--------------------------|-------|
| GSD-1 | | 118 | | | | |
| SRCSD | | 2,404 | | | | |
| CONSTRUCTION | | | | | | |
| IN-LIEU | | | | | | |
| TOTAL FEE | | 2,522 | | | | |

APN: *225-1290-039*

DESCRIPTION/
 SUBDIVISION *Northpointe Park Unit #13 Vill 1* LOT *38*

PROPERTY ADDRESS *150 Lyman Circle*

OWNER *Western Pacific Housing*

MAILING ADDRESS *1210 Central Boulevard*

CITY-STATE-ZIP *Brentwood, Ca. 94513* PHONE *(925) 634-6023*

ADDITIONAL FEES MAY BE DUE IF CHANGES IN USE INCREASE SEWER IMPACT.

APPLICANT SIGNATURE *[Signature]*

CONSOLIDATED UTILITY BILLING USE ONLY

ACCT _____ INPUT _____ START _____

INSPECTOR'S COPY

Natomas Unified School District
 1515 Sports Drive, #1 • Sacramento, CA 95834-1905
 Phone 916/641-3300 • Fax 916/928-1629

CERTIFICATION OF COMPLIANCE
SCHOOL DISTRICT DEVELOPMENT FEES

| PART I: TO BE COMPLETED BY APPLICANT | |
|--|---|
| Property Owner's Name | Western Pacific Housing (975) 634-5033 |
| Owner's Address | 1210 Central Blvd, Brentwood, Ca 94513 |
| Project Address | 150 Lyman Circle |
| Parcel Number | 225-1206-033 Lot 30 |
| Subdivision Name | Northpointe Park Unit #13 Village #1 |
| Number of Units | 1 |
| Print Applicant's Name | Deanna Collins |
| Title of Applicant | Operations |
| Date | 1/28/2001 |
| Applicant's Signature | <i>[Signature]</i> |
| Telephone Number | 801-8331 |
| PART II: TO BE COMPLETED BY BUILDING DEPARTMENT | |
| Plan Identification Number | 2892 |
| Building Type (Check One) | <input checked="" type="checkbox"/> Residential <input type="checkbox"/> Apartment/Condominium <input type="checkbox"/> Commercial/Industrial |
| Square Feet of Chargeable Building Area | 1400 |
| Signature | <i>[Signature]</i> |
| Title | 1/28/01 |
| Date | 3/30/01 |
| PART III: TO BE COMPLETED BY NATOMAS UNIFIED SCHOOL DISTRICT | |
| District Certification Number | 111133 |
| Fees Collected: | |
| Residential: | Sq. Ft. X \$ = \$ 9,399.00 |
| Apartment/Condominium: | Sq. Ft. X \$ = \$ |
| Commercial/Industrial: | Sq. Ft. X \$ = \$ |
| NOTICE TO APPLICANT: Pursuant to government code section 66020 (d), this will serve to notify you that the 90-day approval period in which you may protest the fees, or other payment identified above, will begin to run on the date in which the building or installation permit for this project is issued, or on which they are paid to the District, or to another public entity authorized to collect them on behalf of the District, whichever is earlier. | |
| Applicant Signature: | Date: 3/30/01 |

This certification covers only the amount of square footage indicated above. Any additions or corrections to the square footage for this project will require an amendment to the Certificate of Compliance.

As the authorize Natomas Unified School District official, I hereby certify that the requirements of Government Code Section 95995 have been complied with by the above signed applicant.

SIGNATURE: *Michael Morman* DATE: 3/30/01
 TITLE: Michael Morman
Facilities Planning Director

CERTIFICATION OF INSULATION

| | |
|--|--|
| <p>ADDRESS OR TRACT</p> <p style="font-size: 2em; font-family: cursive;">WESTERN PACIFIC LOT # 39</p> <p style="font-size: 2em; font-family: cursive;">BELLAGIO</p> | <p style="text-align: center;">SACRAMENTO INSULATION CONTRACTORS</p> <p><input checked="" type="checkbox"/> P.O. BOX 854, WEST SACRAMENTO, CA 95691 LIC. #202026</p> <p><input type="checkbox"/> 1309 MELODY ROAD, MARYSVILLE, CA 95901 LIC. #202026</p> <p><input type="checkbox"/> P.O. BOX 9651, FRESNO, CA 93793-9651 LIC. #202026</p> <p><input type="checkbox"/> P.O. BOX 1631, RENO, NV 89505 LIC. #10675</p> <p><input type="checkbox"/> 3326 A PONDEROSA WAY, LAS VEGAS, NV 89118 LIC. #10675</p> <p>DATE INSULATION COMPLETED</p> |
|--|--|

| WALLS | CEILINGS | FLOORS | | | | |
|---|-------------------------------|-----------------------------|-------------------------|---------------------------------------|-------------------|-------------------|
| (SQUARE FEET) | (SQUARE FEET) | (SQUARE FEET) | | | | |
| TYPE OF INSULATION | TYPE OF INSULATION | TYPE OF INSULATION | | | | |
| MATERIAL FIBERGLASS | MATERIAL FIBERGLASS | MATERIAL FIBERGLASS | | | | |
| FORM BATTS | FORM BATTS & BLOW | FORM BATTS | | | | |
| MANUFACTURER'S PRODUCT I.D. | MANUFACTURER'S PRODUCT I.D. | MANUFACTURER'S PRODUCT I.D. | | | | |
| MANUFACTURER | MANUFACTURER | MANUFACTURER | | | | |
| OCF | OCF | OCF | | | | |
| | BAGS | | | | | |
| R-VALUE INSTALLED | APPLIED THICKNESS | R-VALUE INSTALLED | APPLIED THICKNESS | MIN. INSTALLED WEIGHT PER SQUARE FOOT | R-VALUE INSTALLED | APPLIED THICKNESS |
| 13 | 3 5/8" | 30 30 | 9" 12" | | | |
| KNEE WALLS IF R-VALUE IS OTHER THAN WALLS ABOVE | | | | | | |
| MATERIAL FIBERGLASS | FORM BATTS | R VALUE | MANUFACTURER OCF | | | |
| AIR INFILTRATION SEALANT | | | | | | |
| MATERIAL FOAM | MANUFACTURER W R GRACE | | | | | |

THIS IS TO CERTIFY THAT INSULATION AND/OR SEALANT HAS BEEN INSTALLED IN CONFORMANCE WITH APPLICABLE CODES, MATERIAL STANDARDS AND REGULATIONS.

| | | |
|-----------------------------------|---------|---------|
| SIGNATURE - INSULATION CONTRACTOR | TITLE | DATE |
| Bell Hurligo | MANAGER | 7-27-01 |
| SIGNATURE - GENERAL CONTRACTOR | TITLE | DATE |
| REMARKS | | |

KwikKote

No. 200-002664

Stucco System Installation Card

Job Name: BELLAGIO
Address: 150 LYMAN CIR
SACRAMENTO, CA
Lot #: 0000039

Stucco System Trade Name: KWIK KOTE
Stucco System Manufacturer: KWIK KOTE CORP.

ICBO Evaluation Service, Inc.
Report No. 3607
Date of Job Completion:

Home Builder: WESTERN PACIFIC
Address: 1210 CENTRAL BLVD. WEST #200
BRENTWOOD, CA

Stucco Contractor: KENYON PLASTERING, INC.
Address: PO BOX 2077
North Highlands, CA

Telephone Number: 916/349-8191

Approved Contractor Number as
issued by the Stucco Manufacturer: 1001

Card Print Date: 06/19/2001

This is to certify that the stucco system on the building exterior at the above address had been installed in accordance with the evaluation report specified above and the manufacturer's instructions.

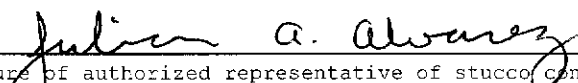

Signature of authorized representative of stucco contractor

8-21-01

Date

LEGEND

→ SWALE
 □ MAILBOX

* WOOD FENCE
 ○ SIDEYARD GATE

SS SEWER SERVICE
 WS WATER SERVICE

□ UTILITY SERVICE
 F.F. FINISH FLOOR

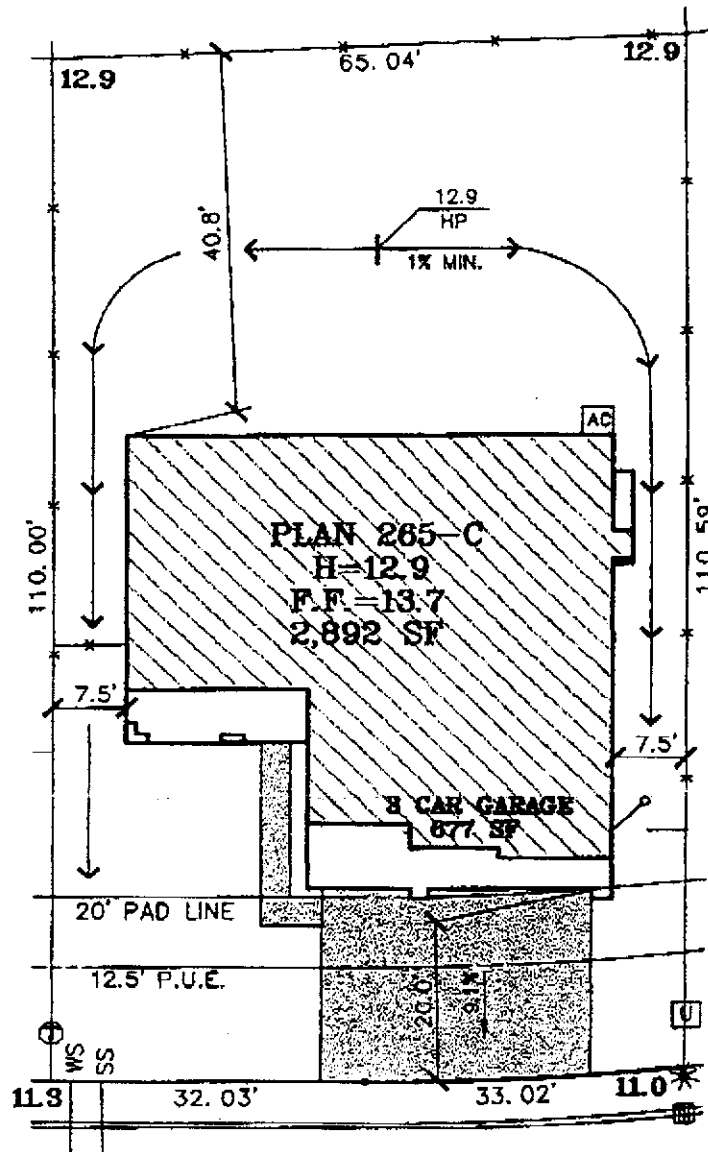

State of California
 Department of Industrial Relations
 Division of Occupational Safety and Health

LYMAN CIRCLE

LOT 39
 PLAN 265-C
 A.P.N.:
 ADDRESS: 150 LYMAN CIRCLE
 LOT AREA: 7,207 SF

DUE TO THE UNIQUE CONDITIONS OF THIS LOT, THE BUYER HAS WALKED AND APPROVED THE SITE FINAL GRADING CONDITIONS MAY VARY. THE INFORMATION ON THIS PLOT PLAN IS PROVIDED FOR YOUR CONVENIENCE AS A GUIDE TO THE GENERAL LOCATION OF THE SUBJECT PROPERTY. THE ACCURACY OF THIS PLOT PLAN IS NOT GUARANTEED NOR IS IT A PART OF ANY POLICY, REPORT OR GUARANTEE TO WHICH IT MAY BE ATTACHED. ACTUAL DIMENSIONS MAY VARY OR CHANGE WITHOUT PRIOR NOTICE DUE TO ACTUAL SITE CONDITIONS.

PLAN: 265
 ELEVATION: C
 ORIENTATION: R
 COLOR: 120

SIGNED (BUYER) _____ DATE _____

The Splink Corporation
 2590 VENTURE OAKS WAY
 SACRAMENTO, CA. 95833
 PH:(916)925-5550 FAX:(916)921-9274

 **Western Pacific Housing**
 1210 Central Boulevard
 Brentwood, CA 94513
 office: (925) 834-8023
 fax: (925) 834-8063

BELLAGIO
 NORTHPOINTE PARK VILLAGE 13 PHASE 1
 City of Sacramento, California
 Scale: 1"=20' February 6, 2001