

Report of Planning Director, R. L. Rathfon January 26, 1965

APPLICATION FOR VARIANCE

OWNER OF RECORD: Mildred Miller

APPLICANT: Mildred Miller, 1215 - 22nd Street

LEGAL DESCRIPTION OF PROPERTY: So. 40' Lot 1, Block 22nd & 23rd St,
L Street & Capitol Avenue

LOCATION: 1215-22nd Street.

SIZE: 40'x80'. 3200 Sq.Ft. No. Lots 1

USE: Existing - Multi-residential. Proposed - Same.

ZONING: Existing - R5 Proposed - Same.

REQUEST: Variance to legalize violation.

Request to waive 15' rear yard requirement in order to allow "ILLEGAL" car port addition with apartment above, to rear of existing building, to project to rear property line, and to within 4" of alley on South side, with roof-deck above carport, according to submitted plans.

STATEMENT

1. On July 23, 1954, the building department issued Permit B-41085, to Mr. Crawford Miller, for a 17'x18' 2-car carport to be erected to rear of existing dwelling, leaving a 10' rear yard as required.
2. Illegal extension of carport and apartment above to the rear of the multi-unit dwelling has been erected. No permits have been issued for any additional improvements on property other than the original 2-car carport.

Item # 265- 116-
10;

SKETCH FOR MILDRED MILLER APPLICATION FOR VARIANCE
APPLICANT: Mildred Miller, 1215-22nd Street

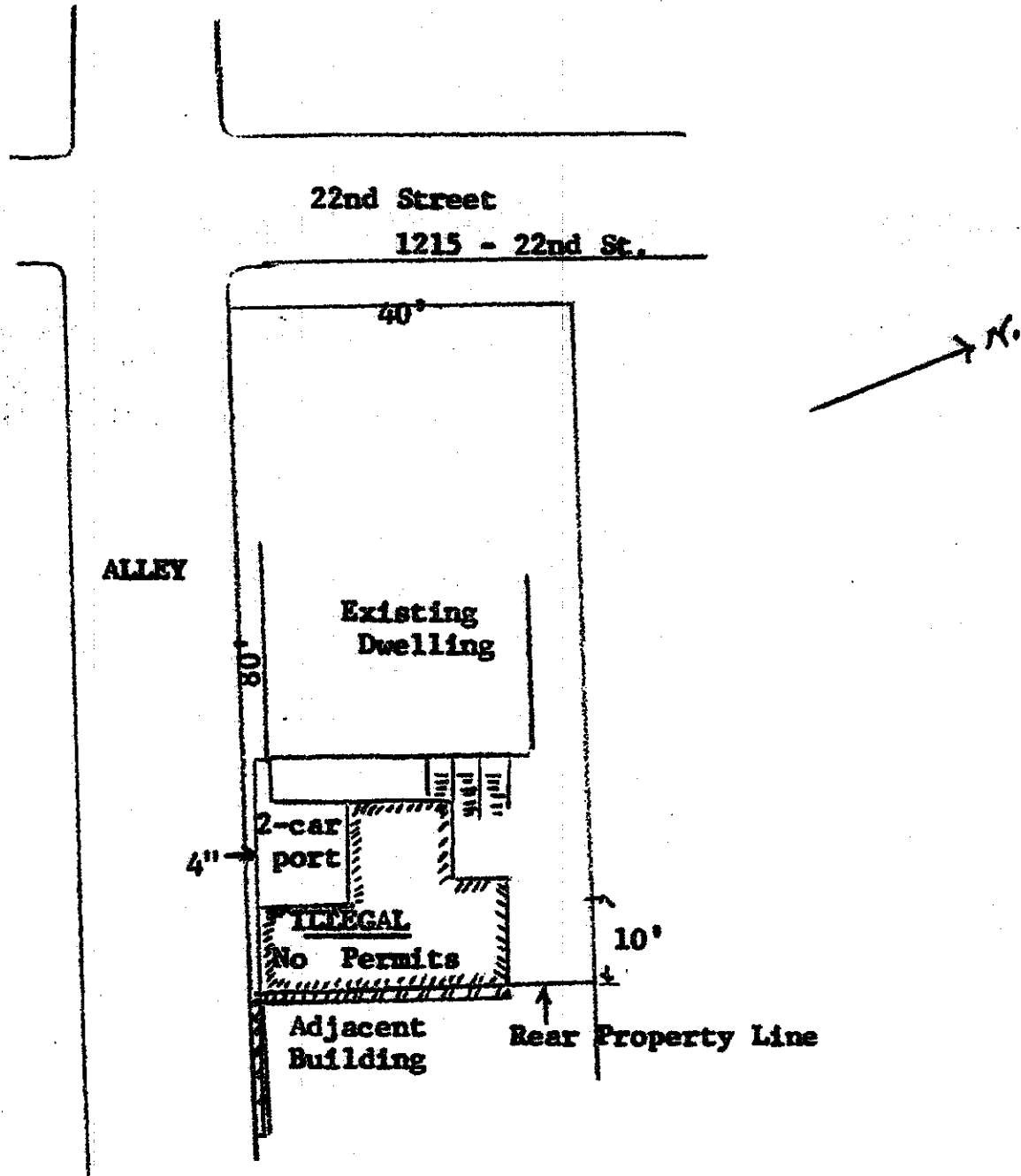

Item No. 2
65 12