

CITY OF SACRAMENTO
1231 I Street, Sacramento, CA 95814

Permit No: 9713163
Insp Area: 1

Site Address: 609 23RD ST SAC
Parcel No: 0030185003

Sub-Type: COM
Housing (Y/N): N

CONTRACTOR

OWNER

ARCHITECT

OLSON HAROLD G
2001 K ST
SACRAMENTO CA 95814

Phone:

Phone:

Phone:

Nature of Work: INTERIOR REMODEL OF AN OLD BARBER SHOP, SUBJECT TO FIELD APPROVA

CONSTRUCTION LENDING AGENCY : I hereby affirm under penalty of perjury that there is a construction lending agency for the performance of the work for which this permit is issued (Sec. 3097, Civ. C).

Lender's Name _____ Lender's Address _____

LICENSED CONTRACTORS DECLARATION: I hereby affirm under penalty of perjury that I am licensed under provisions of Chapter 9 (commencing with section 7000) of Division 3 of the Business and Professions Code and my license is in full force and effect.

License Class _____ License Number _____ Date _____ Contractor Signature _____

OWNER-BUILDER DECLARATION: I hereby affirm under penalty of perjury that I am exempt from the contractors License Law for the following reason (Sec. 7031.5, Business and Professions Code; any city or county which requires a permit to construct, alter, improve, demolish, or repair any structure, prior to its issuance, also requires the applicant for such permit to file a signed statement that he or she is licensed pursuant to the provisions of the Contractors License Law (Chapter 9 (commencing with Section 7000) of Division 8 of the Business and Professions Code) or that he or she is exempt therefrom and the basis for the alleged exemption. Any violation of Section 7031.5 by any applicant for a permit subjects the applicant to a civil penalty of not more than five hundred dollars (\$500.00);

I, as a owner of the property, or my employees with wages as their sole compensation, will do the work, and the structure is not intended or offered for sale (Sec. 7044, Business and Professional Code: The Contractors Law does not apply to an owner of property who builds or improves thereon, and who does such work himself or herself or through his or her own employees, provided that such improvements are not intended or offered for sale. If, however, the building or improvement is sold within one year of completion, the owner-builder will have the burden of proving that he or she did not build or improve for the purpose of sale.)

I, as owner of the property, am exclusively contracting with licensed contractors to construct the project (Sec. 7044, Business and Professions Code: The contractors License Law does not apply to an owner of property who builds or improves thereon, and who contracts for such projects with a contractor(s) licensed pursuant to the Contractors License Law).

I am exempt under Sec. _____ B & PC for this reason: _____

Date _____ Owner Signature _____

IN ISSUING THIS BUILDING PERMIT, the applicant represents, and the city relies on the representation of the applicant, that the applicant verified all measurements and locations shown on the application or accompanying drawings and that the improvement to be constructed does not violate any law or private agreement relating to permissible or prohibited locations for such improvements. This building permit does not authorize any illegal location of any improvement or the violation of any private agreement relating to location of improvements.

X Date 9-22-97 Applicant/Agent Signature Harold G. Olson

WORKER'S COMPENSATION DECLARATION: I hereby affirm under penalty of perjury one of the following declarations:

I have and will maintain a certificate of consent to self-insure for workers' compensation as provided for by Section 3700 of the Labor Code, for the performance of work for which the permit is issued.

I have and will maintain workers' compensation insurance, as required by Section 3700 of the Labor Code, for the performance of the work for which this permit is issued. My workers' compensation insurance carrier and policy number are:

Carrier _____ Policy Number _____

(This section need not be completed if the permit is for \$100 or less) I certify that in the performance of the work for which this permit is issued, I shall not employ any person in any manner so as to become subject to the workers' compensation laws of California and agree that if I should become subject to the workers' compensation provisions of Section 3700 of the Labor Code, I shall forthwith comply with those provisions.

X Date 9-22-97 Applicant Signature Harold G. Olson

WARNING: FAILURE TO SECURE WORKER'S COMPENSATION COVERAGE IS UNLAWFUL AND SHALL SUBJECT AN EMPLOYER TO CRIMINAL PENALTIES AND CIVIL FINES UP TO ONE HUNDRED THOUSAND DOLLARS (\$100,000) IN ADDITION TO THE COST OF COMPENSATION, DAMAGES AS PROVIDED FOR IN SECTION 3706 OF THE LABOR CODE, INTEREST AND ATTORNEY'S FEE.

THIS PERMIT SHALL EXPIRE BY LIMITATION IF WORK IS NOT COMMENCED WITHIN 180 DAYS.

OWNER-BUILDER VERIFICATION

ATTENTION PROPERTY OWNER

An owner-builder building permit has been applied for in your name and bearing your signature.

Please complete and return this information in the envelope provided at your earliest opportunity to avoid unnecessary delay in processing and issuing your building permit. No building permit will be issued until this verification is received.

1. I personally plan to provide the major labor and materials for construction of the proposed improvement (yes or no) YES

2. I (have/have not) HAVE signed an application for a building permit for the proposed work.

3. I have contracted with the following person (firm) to provide the proposed construction:

Name _____ Address _____

City _____ Telephone _____

Contractors License No. _____

4. I plan to provide portions of the work, but I have hired the following person to coordinate, supervise, and provide the major work.

Name _____ Address _____

City _____ Telephone _____

Contractors License No. _____

5. I will provide some of the work but I have contracted (hired) the following to provide the work indicated:

Name	Address	Phone	Type of Work
------	---------	-------	--------------

Signed [Signature]

Job Address 607 Date 9-22-97

Permit No.: 9713163

609 23RD ST 230 ϕ

LIGHTS @ 3W/ ϕ = .7 KW
MISC. RECEPTS @ 2W/ ϕ = .4
SHOW WNDW RECEPTS = 3.0
HEAT PUMP = 1.5
+ 25% LIGHTING = .9
+ 25% LARGEST MOTOR = .2

6.7 KW = 230V 1 ϕ = 29A

USE 100A 120/230V 1 ϕ PANEL

2300 1/2 F ST 1500W ϕ

LIGHTS @ 3W/ ϕ = 4.5 KW
MISC. RECEPTS @ 2W/ ϕ = 3.0
-1 HEAT PUMP @ 4.2 = 4.2
+ 25% LIGHTING = 1.1
+ 25% LARGEST MOTOR = 1.1

13.9 KW \div 230V 1 ϕ = 60A

USE 100A 120/230V 1 ϕ PANEL

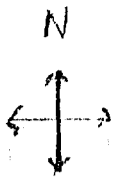

Replaced exist
w/ 20A kind of table
#12 or #20 Ang Braces

16'
3'
8'
5'

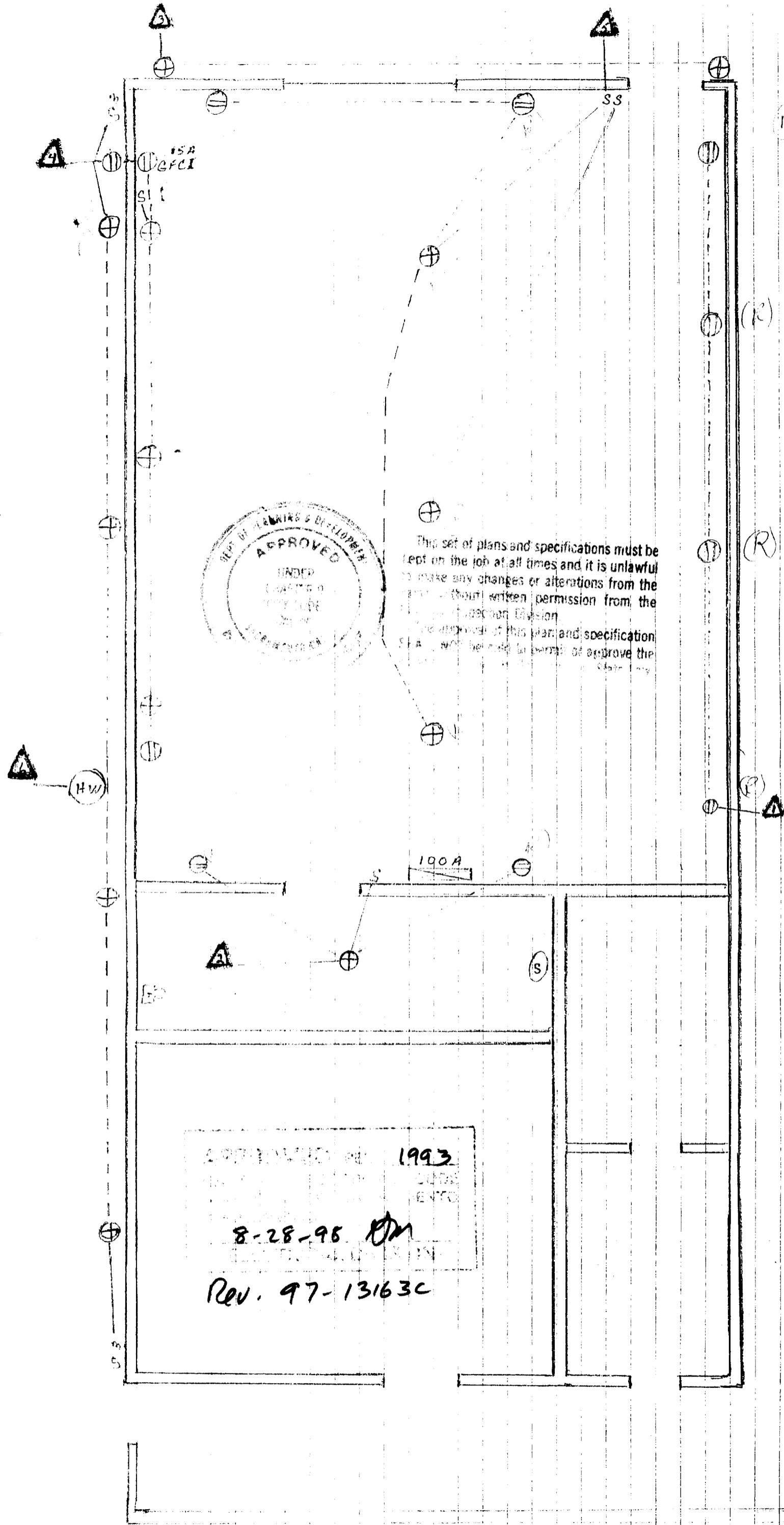

This set of plans and specifications must be left on the job at all times and it is unlawful to make any changes or alterations from the plans without written permission from the Planning & Development Division. The approval of this plan and specification shall not be held liable for approve the State of California.

ISSUED

AUG 28 1998

CITY OF SACRAMENTO
DEVELOPMENT SERVICES DIV.

APPROVED per 1993
8-28-98 DM
Rev. 97-13163C

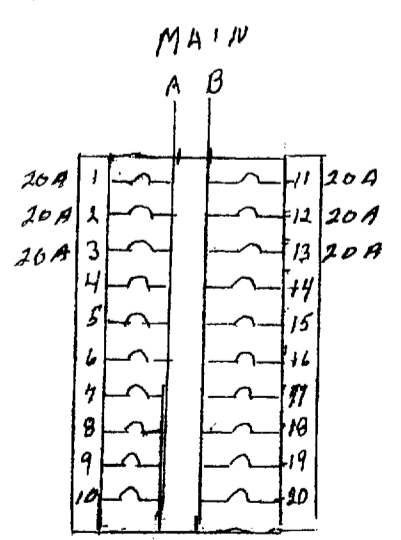

97-13163C

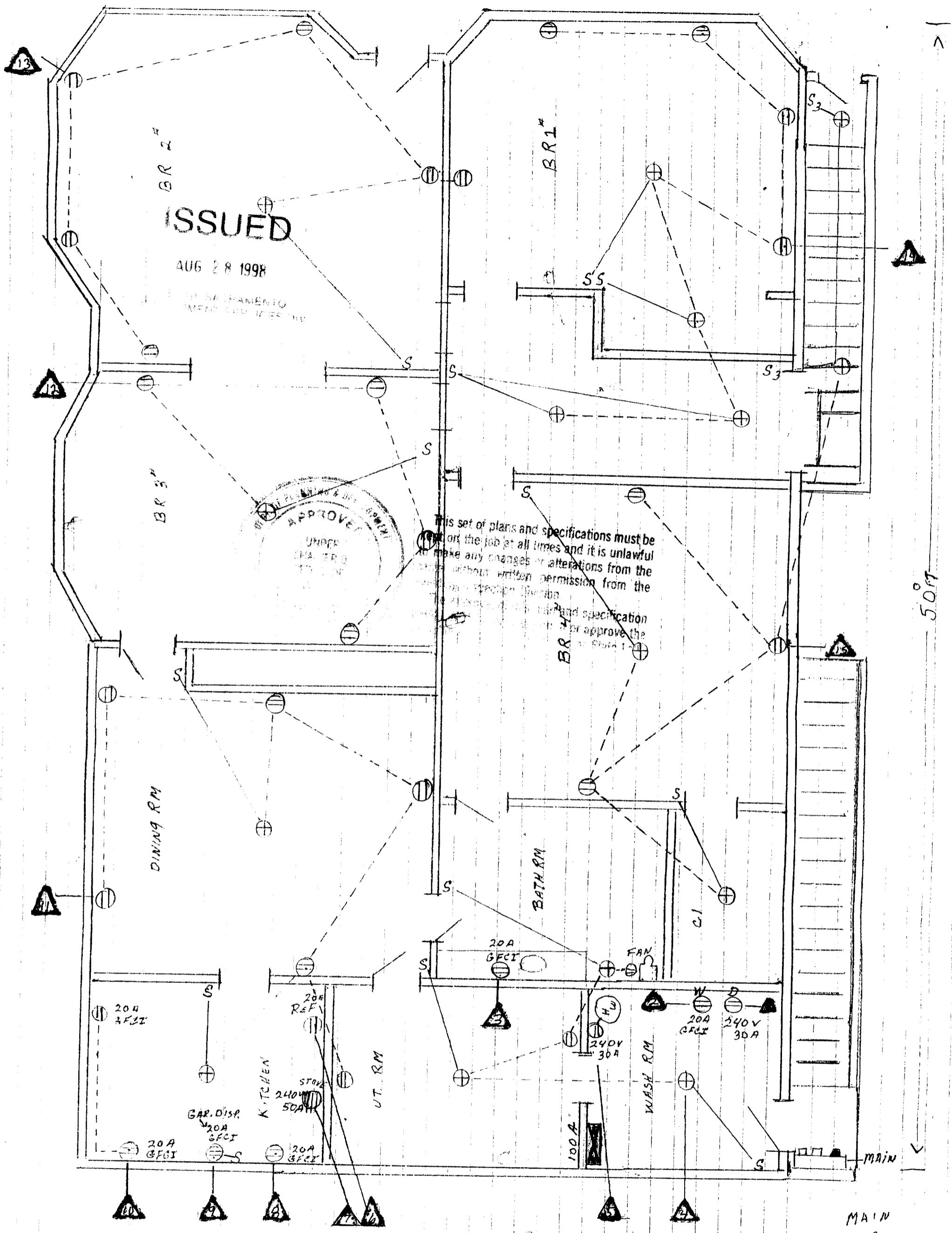

ISSUED

AUG 28 1998

IN CALIFORNIA
REGISTERED ELECTRICAL ENGINEER

APPROVED
[Signature]
DATE

This set of plans and specifications must be kept on the job at all times and it is unlawful to make any changes or alterations from the plans without written permission from the architect. The contractor shall not be held responsible for any errors or omissions in the plans and specification unless they are specifically noted or approved by the architect.

20A 3FCI

20A REF

20A GFCI

FAN

240V 30A

20A GFCI

240V 30A

20A GFCI

GAR. DISP. 20A GFCI

20A GFCI

240V 50A

100A

WASH. RM.

MAIN

1993
8-28-98
Rev. 98-415C

30 FT

Receptacles per 210-2

MAIN
A B

50A	1	11	30A
	2	12	
30A	3	13	20A
	4	14	20A
20A	5	15	20A
	6	16	20A
20A	7	17	20A
	8	18	20A
20A	9	19	SPARE
	10	20	SPARE

of all E...
field inspections