



43

SACRAMENTO HOUSING AND REDEVELOPMENT AGENCY

March 2, 1981

CITY MANAGER'S OFFICE
RECEIVED
MAR 3 1981

Housing Authority of the
City of Sacramento
Sacramento, California

Honorable Members in Session:

SUBJECT: Granting Utility Easement at 2830 Stockton Boulevard -
San Carlos Motel (Midtown Manor Residential Facility
for Mentally Disordered Adults)

SUMMARY

Attached is a resolution authorizing the Interim Executive Director to execute Grant of Easement to Pacific Telephone for utility purposes over Agency-owned property located at 2830 Stockton Boulevard (see attached map).

BACKGROUND

Attached is a Grant of Easement which would allow Pacific Telephone to place and maintain facilities on the aforementioned property as shown on the attached map.

The existing aerial wire attached to the back of the San Carlos Motel at 2830 Stockton Boulevard will be removed and replaced with a buried cable. The reason for this project is to provide service to the adjacent lots.

This easement will also allow Pacific Telephone to maintain the aerial cable that is existing along the north side of the Authority's property.

No structure is proposed to be constructed within this easement area and the easement will not conflict with any building plans for this property.

FINANCIAL DATA

There is no financial impact as a result of this transaction.

APPROVED
SACRAMENTO HOUSING AUTHORITY

Date 3/3/81

3-3-81

SACRAMENTO HOUSING AND REDEVELOPMENT AGENCY

Housing Authority of the
City of Sacramento
March 2, 1981
Page Two

VOTE AND RECOMMENDATION OF COMMISSION

At its regular meeting of March 2, 1981, the Sacramento Housing and Redevelopment Commission adopted a motion recommending adoption of the attached resolution. The votes were as follows:

AYES: Coleman, Kneprath, Luevano, A. Miller
Teramoto, B. Miller
NOES: None
NOT PRESENT TO VOTE: Serna
ABSENT: Fisher, Walton

RECOMMENDATION

The staff recommends adoption of the attached resolution which authorizes the Interim Executive Director to execute the above-mentioned Grant of Easement.

Respectfully submitted,

William H. Edgar

WILLIAM H. EDGAR
Interim Executive Director

TRANSMITTAL TO COUNCIL:

Walter J. Slipe

WALTER J. SLIPE
City Manager

Contact Person: Leo T. Goto

RESOLUTION NO. 81-020

Adopted by the Housing Authority of the City of Sacramento

March 3, 1981

GRANT OF EASEMENT - 2830 STOCKTON BOULEVARD
SAN CARLOS MOTEL

BE IT RESOLVED BY THE HOUSING AUTHORITY OF THE CITY
OF SACRAMENTO:

Section 1: The Interim Executive Director is hereby
authorized to execute a Grant of Easement for utility purposes
to the Pacific Telephone and Telegraph Company at 2830 Stockton
Boulevard.

CHAIRPERSON

ATTEST:

SECRETARY

APPROVED
SACRAMENTO HOUSING AUTHORITY
Date 3/3/81

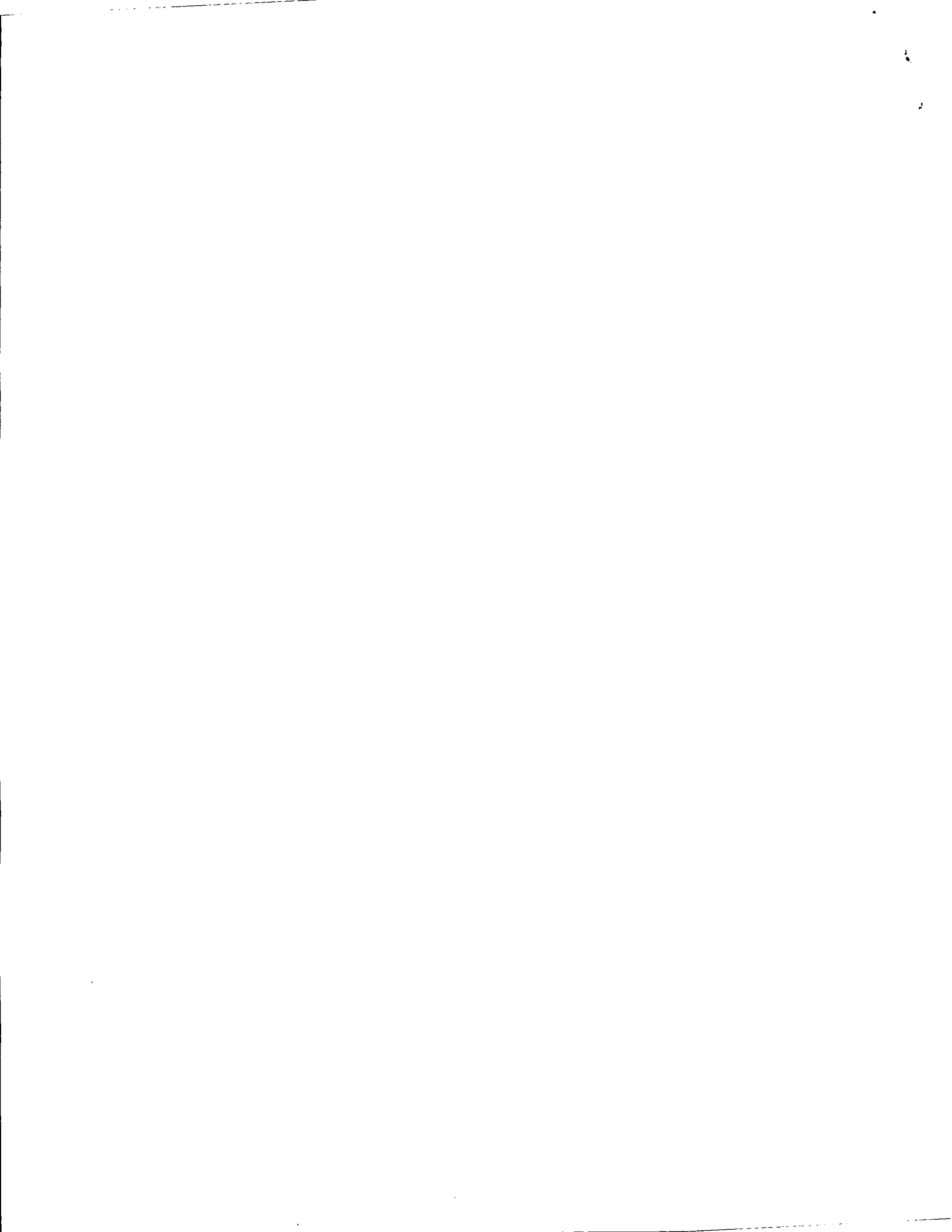

ALTA VISTA, ALTA VISTA ADD, M.J. DILLMAN SUB. 2, H.J. GOETHE ADD. "G" & POR. CITY BLVD.

Tax Area Code

14-12

BR. 11

STOCKTON

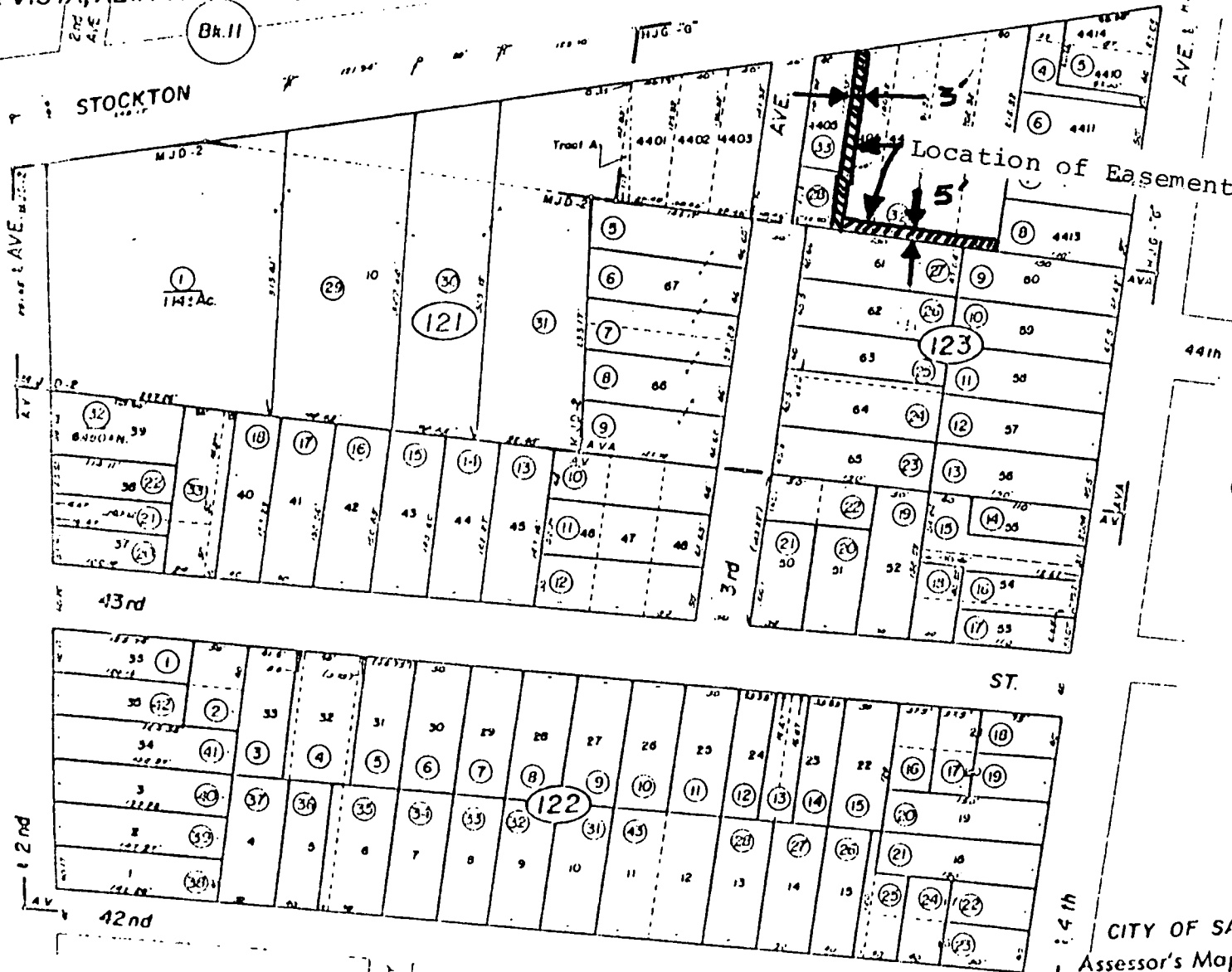

WHEN RECORDED RETURN TO

Name
Street
Address
City &
State

NO DOCUMENTARY TRANSFER TAX DUE. BY _____
THE PACIFIC TELEPHONE AND TELEGRAPH COMPANY AGENT GM

UC 7090Z Sacramento-Gladstone
A.P. NO. 014-123-32

GRANT OF EASEMENT Lots 4406, 4407, 4408, 4409 Plat of H.J.
Goethe Company's Addition "G" to
Sacramento Bk. 6 of Maps, Map No. 16

The undersigned Grantor(s) hereby grant(s) to THE PACIFIC TELEPHONE AND TELEGRAPH COMPANY, Grantee, its successors and assigns, an easement to construct and maintain (place, operate, inspect, repair, replace and remove) such aerial and underground communication facilities as Grantee may from time to time require (including ingress thereto and egress therefrom) consisting of poles, anchors, guys, cables, wires, crossarms, conduits, manholes, handholes, markers, pedestals, terminal equipment cabinets, electrical conductors and necessary fixtures and appurtenances in, over, under and upon that certain real property in the County of Sacramento, State of California, described as:

Said aerial facilities shall lie within the northerly 3.00 feet of Lot 4406 and said buried facilities shall lie within the Westerly 5.00 feet of Lots 4406, 4407, 4408 and 4409 as shown on "Plat of H. J. Goethe Company's Addition "G" to Sacramento", recorded in Book 6 of Maps, Map No. 16, records of said County.

EXCEPTING THEREFROM that portion of Lot 4406 described as follows:

Beginning at the Northeast corner of said Lot 4406 and running thence along the north line of the same, North 89° 43' 29" West 111.29 feet; thence South 00° 39' 02" East 0.60 feet; thence North 89° 58' 06" East 111.28 feet to the point of beginning.

Grantor(s) also grant(s) to Grantee the right to trim such trees and other foliage and to cut such roots on said property as may be necessary for the protection of said facilities. Grantee shall be responsible for damage caused intentionally or by any negligent act or omission of Grantee, its agents or employees while exercising the rights granted herein.

Executed this _____ day of _____ 19 _____

HOUSING AUTHORITY OF THE CITY OF SACRAMENTO
a public corporation

By: _____
President