

CITY OF SACRAMENTO
1231 I Street, Sacramento, CA 95814

Permit No: 0105644
Insp Area: 4

Site Address: 3427 DELPHINIUM WY SAC
Parcel No: 274-0500-068 NATOMAS W 2 LOT 74

Sub-Type: NSFR
Housing (Y/N): N

CONTRACTOR
KAUFMAN AND BROAD
611 ORANGE DR
VACAVILLE CA 95687

OWNER

ARCHITECT

Nature of Work: NSFR MP2106 8 RMS 2 STORY

CONSTRUCTION LENDING AGENCY: I hereby affirm under penalty of perjury that there is a construction lending agency for the performance of the work for which this permit is issued (Sec. 3097, Civ. C.)

Lender's Name _____ Lender's Address _____

LICENSED CONTRACTORS DECLARATION: I hereby affirm under penalty of perjury that I am licensed under provisions of Chapter 9 (commencing with section 7000) of Division 3 of the Business and Professions Code and my license is in full force and effect.

License Class B License Number 20101 Date 5/18/01 Contractor Signature [Signature]

OWNER-BUILDER DECLARATION: I hereby affirm under penalty of perjury that I am exempt from the contractors License Law for the following reason (Sec. 7031.5, Business and Professions Code, any city or county which requires a permit to construct, alter, improve, demolish, or repair any structure, prior to its issuance, also requires the applicant for such permit to file a signed statement that he or she is licensed pursuant to the provisions of the Contractors License Law (Chapter 9 (commencing with Section 7000) of Division 8 of the Business and Professions Code) or that he or she is exempt therefrom and the basis for the alleged exemption. Any violation of Section 7031.5 by any applicant for a permit subjects the applicant to a civil penalty of not more than five hundred dollars (\$500.00).

_____, I, as a owner of the property, or my employees with wages as their sole compensation, will do the work, and the structure is not intended or offered for sale (Sec. 7044, Business and Professional Code: The Contractors License Law does not apply to an owner of property who builds or improves thereon, and who does such work himself or herself or through his/her own employees, provided that such improvements are not intended or offered for sale. If, however, the building or improvement is sold within one year of completion, the owner-builder will have the burden of proving that he/she did not build or improve for the purpose of sale.)

_____, I, as owner of the property, am exclusively contracting with licensed contractors to construct the project (Sec. 7044, Business and Professions Code: The Contractors License Law does not apply to an owner of property who builds or improves thereon, and who contracts for such projects with a contractor(s) licensed pursuant to the Contractors License Law).

_____, I am exempt under Sec. _____ B & PC for this reason: _____
Date _____ Owner Signature _____

IN ISSUING THIS BUILDING PERMIT, the applicant represents, and the city relies on the representation of the applicant, that the applicant verified all measurements and locations shown on the application or accompanying drawings and that the improvement to be constructed does not violate any law or private agreement relating to permissible or prohibited locations for such improvements. This building permit does not authorize any illegal location of any improvement or the violation of any private agreement relating to location of improvements.

I certify that I have read this application and state that all information is correct. I agree to comply with all city and county ordinances and state laws relating to building construction and hereby authorize representative(s) of this city to enter upon the abovementioned property for inspection purposes.

Date 5/18/01 Applicant/Agent Signature [Signature]

WORKER'S COMPENSATION DECLARATION: I hereby affirm under penalty of perjury one of the following declarations:

_____, I have and will maintain a certificate of consent to self-insure for workers' compensation as provided for by Section 3700 of the Labor Code, for the performance of work for which the permit is issued

I have and will maintain workers' compensation insurance, as required by Section 3700 of the Labor Code, for the performance of the work for which this permit is issued. My workers' compensation insurance carrier and policy number are:

Carrier CONTINENTAL CAS. CO. Policy Number WC188899094 Exp Date 05/01/2000

_____, (This section need not be completed if the permit is for \$100 or less) I certify that in the performance of the work for which this permit is issued, I shall not employ any person in any manner so as to become subject to the workers' compensation laws of California and agree that if I should become subject to the workers' compensation provisions of Section 3700 of the Labor Code, I shall forthwith comply with those provisions.

Date 5/18/01 Applicant Signature [Signature]

WARNING: FAILURE TO SECURE WORKER'S COMPENSATION COVERAGE IS UNLAWFUL AND SHALL SUBJECT AN EMPLOYER TO CRIMINAL PENALTIES AND CIVIL FINES UP TO ONE HUNDRED THOUSAND DOLLARS (\$100,000) IN ADDITION TO THE COST OF COMPENSATION, DAMAGES AS PROVIDED FOR IN SECTION 3706 OF THE LABOR CODE, INTEREST AND ATTORNEY'S FEE.

THIS PERMIT SHALL EXPIRE BY LIMITATION IF WORK IS NOT COMMENCED WITHIN 180 DAYS.

CERTIFICATION OF INSULATION

ADDRESS OR TRACT		SACRAMENTO INSULATION CONTRACTORS					
<p style="font-size: 2em; font-family: cursive;">KB HOME</p> <p style="font-size: 1.5em;">LOT # 74</p> <p style="font-size: 1.5em; font-family: cursive;">CALIFORNIA GARDENS</p>		<input checked="" type="checkbox"/> P.O. BOX 854, WEST SACRAMENTO, CA 95681 LIC. #202026 <input type="checkbox"/> 1308 MELODY ROAD, MARYSVILLE, CA 95901 LIC. #202026 <input type="checkbox"/> P.O. BOX 9651, FRESNO, CA 93783-9651 LIC. #202026 <input type="checkbox"/> P.O. BOX 1631, RENO, NV 86505 LIC. #10675 <input type="checkbox"/> 3325 A PONDEROSA WAY, LAS VEGAS, NV 89118 LIC. #10675					
		DATE INSULATION COMPLETED					
WALLS		CEILING			FLOORS		
(SQUARE FEET)		(SQUARE FEET)			(SQUARE FEET)		
TYPE OF INSULATION		TYPE OF INSULATION			TYPE OF INSULATION		
MATERIAL FIBERGLASS		MATERIAL FIBERGLASS			MATERIAL FIBERGLASS		
FORM BATTS		FORM BATTS & BLOW			FORM BATTS		
MANUFACTURER'S PRODUCT I.D.		MANUFACTURER'S PRODUCT I.D.			MANUFACTURER'S PRODUCT I.D.		
MANUFACTURER		MANUFACTURER			MANUFACTURER		
OCF		OCF			OCF		
		BAGS					
R-VALUE INSTALLED	APPLIED THICKNESS	R-VALUE INSTALLED	APPLIED THICKNESS	MIN. INSTALLED WEIGHT PER SQUARE FOOT	R-VALUE INSTALLED	APPLIED THICKNESS	
13	3 5/8"	38 38	12 1/4" 14 1/4"				
KNEE WALLS IF R-VALUE IS OTHER THAN WALLS ABOVE							
MATERIAL FIBERGLASS		FORM BATTS		R-VALUE		MANUFACTURER OCF	
AIR INFILTRATION SEALANT							
MATERIAL FOAM				MANUFACTURER W R GRACE			
THIS IS TO CERTIFY THAT INSULATION AND/OR SEALANT HAS BEEN INSTALLED IN CONFORMANCE WITH APPLICABLE CODES, MATERIAL STANDARDS AND REGULATIONS							
SIGNATURE - INSULATION CONTRACTOR				TITLE MANAGER		DATE 2-19-02	
SIGNATURE - GENERAL CONTRACTOR				TITLE		DATE	
REMARKS							

COUNTY SANITATION DISTRICT NO. 1
 SACRAMENTO REGIONAL COUNTY SANITATION DISTRICT
SEWER IMPACT FEE
 PERMIT AND CALCULATION SHEET *city*

APPLICATION NO. *500209-00031* 267754
 BLDG PERMIT NO. *271291*

GENERAL INFORMATION

THIS PERMIT GOOD ONLY WHEN
 VALIDATED BY THE CASHIER

THIS PERMIT TO CONNECT *5/16/11*
 ONE YEAR FROM DATE OF ISSUANCE

FEE CALCULATION

BUILDING USE

INSPECTION	RESIDENTIAL	SF	MF	UNITS
CSD-1	<input checked="" type="checkbox"/>	<i>473</i>	<input type="checkbox"/>	
SRCSD	<input type="checkbox"/>	<i>2404</i>	<input type="checkbox"/>	
CONSTRUCTION	<input type="checkbox"/>		<input type="checkbox"/>	
IN-LEU	<input type="checkbox"/>		<input type="checkbox"/>	
TOTAL FEE	<input checked="" type="checkbox"/>			

APN: *274-0500-008*

DESCRIPTION/
 SUBDIVISION *Mathias West Village #2 LOT 74*

PROPERTY ADDRESS *3427 Delphinium way*
 OWNER *RB Home*

MAILING ADDRESS *611 Orange Drive*

CITY-STATE-ZIP *Vacaville CA 95687* PHONE *707-469-2464*

ADDITIONAL FEES MAY BE DUE IF CHANGES IN USE INCREASE SEWER IMPACT.

APPLICANT SIGNATURE

[Signature]

CONSOLIDATED UTILITY BILLING USE ONLY

ACCT _____ INPUT _____ START _____

Natomas Unified School District
 1515 Sports Drive, #1 • Sacramento, CA 95834-1905
 Phone 916/641-3300 • Fax 916/928-1629

CERTIFICATION OF COMPLIANCE
SCHOOL DISTRICT DEVELOPMENT FEES

PART I: TO BE COMPLETED BY APPLICANT			
Property Owner's Name			
Owner's Address			
Project Address			
Parcel Number			
Subdivision Name			
Number of Units			
Print Applicant's Name		Applicant's Signature	
Title of Applicant		Telephone Number	
Date			
PART II: TO BE COMPLETED BY BUILDING DEPARTMENT			
Plan Identification Number			
Building Type (Check One)			
<input checked="" type="checkbox"/> Residential	<input checked="" type="checkbox"/> Apartment/Condominium	<input type="checkbox"/> Commercial/Industrial	
Square Feet of Chargeable Building Area 2155			
Signature			
Title		Date 4/1	
PART III: TO BE COMPLETED BY NATOMAS UNIFIED SCHOOL DISTRICT			
District Certification Number 01-2035			
Fees Collected:			
Residential:	2155	Sq. Ft. X \$ 325	= \$ 7,219.25
Apartment/Condominium:		Sq. Ft. X \$	= \$
Commercial/Industrial:		Sq. Ft. X \$	= \$
NOTICE TO APPLICANT: Pursuant to government code section 66020 (d), this will serve to notify you that the 90-day approval period in which you may protest the fees, or other payment identified above, will begin to run on the date in which the building or installation permit for this project is issued, or on which they are paid to the District, or to another public entity authorized to collect them on behalf of the District, whichever is earlier.			
Applicant Signature:		Date: 4-27-01	

This certification covers only the amount of square footage indicated above. Any additions or corrections to the square footage for this project will require an amendment to the Certificate of Compliance.

As the authorize Natomas Unified School District official, I hereby certify that the requirements of Government Code Section 95995 have been complied with by the above signed applicant.

SIGNATURE: DATE: 4/27/01
 TITLE: Michael Norman
Facilities Manning Director

RESIDENTIAL SUBDIVISION BUILDING PERMIT APPLICATION

Project Address: 3427 Delphinium^{way} Assessor Parcel # 274-0500-068
Lot Number: 74 Subdivision Natomas West Village 2

OWNER INFORMATION:

Legal Property Owner: KB Home Phone# (907) 469-2464
Owner Address: 611 Orange Dr City Vacaville State CA Zip 95687

CONTRACTOR INFORMATION:

Contractor: KB Home Lic. # 255425 Phone # 469-2464 Fax 469-2405

PROJECT INFORMATION:

Land Use Zone _____ Occupancy Group _____ Construction Type _____ Fed Code _____
No. of Stories: 2 No. of Rooms: _____ Street Width: _____
1st Floor Area 885 2nd Floor Area 1270 Basement _____ Roof Material _____
AREA IN SQUARE FOOT OF:
Dwelling/Living 2155
Garage/Storage 375
Decks/Balconies 80
Carports _____
SCOPE OF WORK: New Single Family Dwelling

FOR OFFICE USE ONLY

- Information Above Complete
- Violation Files Checked
- Standard Setbacks
- County Sewer
- AR Flood Waiver Required
- Flood Elevation Certificate Required
- Water Development Infill Area
- Planning Approval
- Design Review Approval
- Special Fee Districts Apply:

THE FOLLOWING MUST BE PROVIDED IN ORDER TO SUBMIT FOR PERMIT

- 2 COMPLETE PLOT PLANS, LEGIBLE & DRAWN TO SCALE
- 11 X 17 COPY OF FLOOR PLAN WITH FOLLOWING INFORMATION
 - a) Assessor's Parcel Number
 - b) New Floor Area
 - c) Owners Name
 - d) Project Address

Date:

Received by: (staff)

Permit #

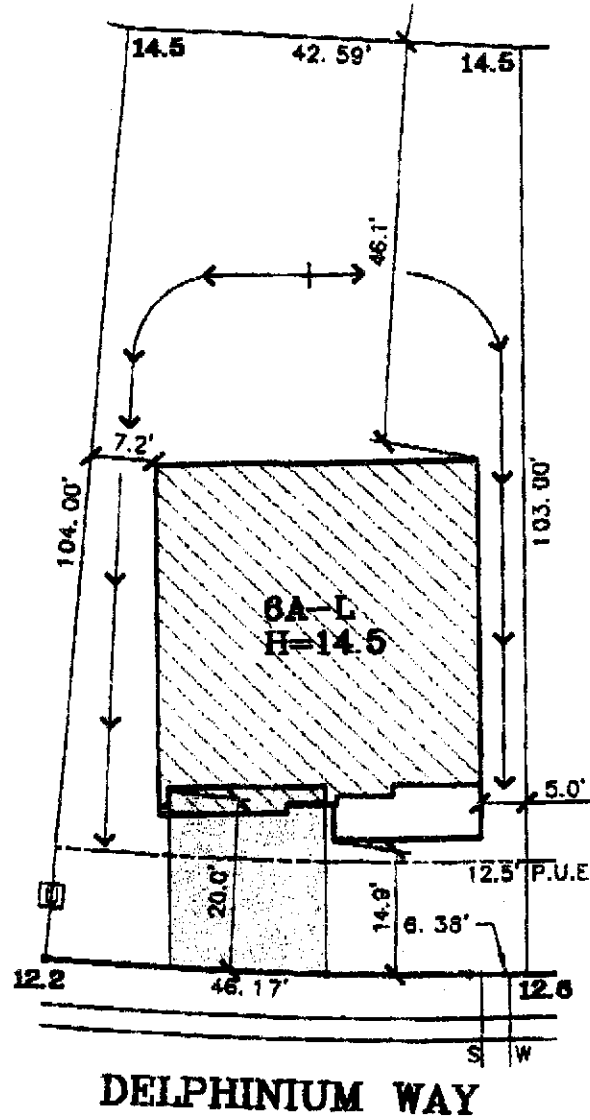

City of Sacramento
 Department of Planning
 400 Capitol Mall, Suite 100
 Sacramento, CA 95833
 Telephone: (916) 491-2200
 Fax: (916) 491-2201
 Website: www.cityofsacramento.gov

DATE: 4-2-01
 A.P.N.: 274-0500-068
 ADDRESS: 3427 DELPHINTUM WAY

LOT AREA: 4,941 SF
 LOT COVERAGE: 27%

The Splink Corporation
 2590 VENTURE OAKS WAY
 SACRAMENTO, CA. 95833
 PH (916)925-5550 FAX (916)921-9274

**NATOMAS WEST
 VILLAGE 2**
 LOT 74
 PLAN 6A

CALIFORNIA GARDENS
 CITY OF SACRAMENTO, CA
 CLIENT: KAUFMAN & BROAD