

**CITY OF SACRAMENTO**  
1231 I Street, Sacramento, CA 95814

**Permit No: 0105671**  
**Insp Area: 4**

**Site Address: 1918 KANE AV SAC**  
Parcel No: 225-1490-086  
N

NORTHPOINTE PARK VIL. 10 LOT 86

Sub-Type: NSFR  
Housing (Y/N):

**CONTRACTOR**  
WILLIAM LYON HOMES  
9216 KIEFER BL  
SAC CA 95827

**OWNER**

**ARCHITECT**

**Nature of Work: MP 2659 2 STORY 10 ROOM SFR**

**CONSTRUCTION LENDING AGENCY:** I hereby affirm under penalty of perjury that there is a construction lending agency for the performance of the work for which this permit is issued (Sec. 3097, Civ. C).

Lender's Name \_\_\_\_\_ Lender's Address \_\_\_\_\_

**LICENSED CONTRACTORS DECLARATION:** I hereby affirm under penalty of perjury that I am licensed under provisions of Chapter 9 (commencing with section 7000) of Division 3 of the Business and Professions Code and my license is in full force and effect.

License Class B License Number CC1155 Date 5/1/01 Contractor Signature Kellie Adams

**OWNER-BUILDER DECLARATION:** I hereby affirm under penalty of perjury that I am exempt from the contractors License Law for the following reason (Sec. 7031.5, Business and Professions Code; any city or county which requires a permit to construct, alter, improve, demolish, or repair any structure, prior to its issuance, also requires the applicant for such permit to file a signed statement that he or she is licensed pursuant to the provisions of the Contractors License Law (Chapter 9 (commencing with Section 7000) of Division 8 of the Business and Professions Code) or that he or she is exempt therefrom and the basis for the alleged exemption. Any violation of Section 7031.5 by any applicant for a permit subjects the applicant to a civil penalty of not more than five hundred dollars (\$500.00).

I, as a owner of the property, or my employees with wages as their sole compensation, will do the work, and the structure is not intended or offered for sale (Sec. 7044, Business and Professional Code. The Contractors License Law does not apply to an owner of property who builds or improves thereon, and who does such work himself or herself or through his/her own employees, provided that such improvements are not intended or offered for sale. If, however, the building or improvement is sold within one year of completion, the owner-builder will have the burden of proving that he/she did not build or improve for the purpose of sale.)

I, as owner of the property, am exclusively contracting with licensed contractors to construct the project (Sec. 7044, Business and Professions Code: The Contractors License Law does not apply to an owner of property who builds or improves thereon, and who contracts for such projects with a contractor(s) licensed pursuant to the Contractors License Law.)

I am exempt under Sec. \_\_\_\_\_ B & PC for this reason: \_\_\_\_\_

Date \_\_\_\_\_ Owner Signature \_\_\_\_\_

**IN ISSUING THIS BUILDING PERMIT,** the applicant represents, and the city relies on the representation of the applicant, that the applicant verified all measurements and locations shown on the application or accompanying drawings and that the improvement to be constructed does not violate any law or private agreement relating to permissible or prohibited locations for such improvements. This building permit does not authorize any illegal location of any improvement or the violation of any private agreement relating to location of improvements.

I certify that I have read this application and state that all information is correct. I agree to comply with all city and county ordinances and state laws relating to building construction and hereby authorize representative(s) of this city to enter upon the above-mentioned property for inspection purposes.

Date 5/1/01 Applicant/Agent Signature Kellie Adams

**WORKER'S COMPENSATION DECLARATION:** I hereby affirm under penalty of perjury one of the following declarations:

I have and will maintain a certificate of consent to self-insure for workers' compensation as provided for by Section 3700 of the Labor Code, for the performance of work for which the permit is issued

VA I have and will maintain workers' compensation insurance, as required by Section 3700 of the Labor Code, for the performance of the work for which this permit is issued. My workers' compensation insurance carrier and policy number are:

Carrier EAGLE PACIFIC Policy Number 45000285 Exp Date 07/01/2001

(This section need not be completed if the permit is for \$100 or less) I certify that in the performance of the work for which this permit is issued, I shall not employ any person in any manner so as to become subject to the workers' compensation laws of California and agree that if I should become subject to the workers' compensation provisions of Section 3700 of the Labor Code, I shall forthwith comply with those provisions.

Date 5/1/01 Applicant Signature Kellie Adams

**WARNING: FAILURE TO SECURE WORKER'S COMPENSATION COVERAGE IS UNLAWFUL AND SHALL SUBJECT AN EMPLOYER TO CRIMINAL PENALTIES AND CIVIL FINES UP TO ONE HUNDRED THOUSAND DOLLARS (\$100,000) IN ADDITION TO THE COST OF COMPENSATION, DAMAGES AS PROVIDED FOR IN SECTION 3706 OF THE LABOR CODE, INTEREST AND ATTORNEY'S FEE.**

**THIS PERMIT SHALL EXPIRE BY LIMITATION IF WORK IS NOT COMMENCED WITHIN 180 DAYS.**

# RESIDENTIAL SUBDIVISION BUILDING PERMIT APPLICATION

Project Address: 1918 Kane Avenue Assessor Parcel # 225-1490-086  
Lot Number: 86 Plan 3B Subdivision Lyon Palazzo

## OWNER INFORMATION:

Legal Property Owner: William Lyon Homes, Inc. Phone# (925) 543-5500  
Owner Address: 2603 Camino Ramon #150 City San Ramon State CA Zip 94583

## CONTRACTOR INFORMATION:

Contractor: William Lyon Homes Inc Lic. # 661158 Phone # (925) 543-5500 Fax 543-5501

## PROJECT INFORMATION:

Land Use Zone R1A Occupancy Group R3 Construction Type VN Fed Code 1A  
No. of Stories: 2 No. of Rooms: 13 Street Width: 40'  
1<sup>st</sup> Floor Area 1,371 2<sup>nd</sup> Floor Area 1,288 Basement 0 Roof Material Conc. Tile  
AREA IN SQUARE FOOT OF:  
Dwelling/Living 2,659  
Garage/Storage 638  
Decks/Balconies 0  
Carports 0  
SCOPE OF WORK: Construction of a Single Family Dwelling

FOR OFFICE USE ONLY

- Information Above Complete
- Violation Files Checked
- Standard Setbacks
- County Sewer
- AR Flood Waiver Required
- Flood Elevation Certificate Required
- Water Development Infill Area
- Planning Approval
- Design Review Approval
- Special Fee Districts Apply:

**THE FOLLOWING MUST BE PROVIDED IN ORDER TO SUBMIT FOR PERMIT**

- 2 COMPLETE PLOT PLANS, LEGIBLE & DRAWN TO SCALE
- 11 X 17 COPY OF FLOOR PLAN WITH FOLLOWING INFORMATION
  - a) Assessors Parcel Number
  - b) New Floor Area
  - c) Owners Name
  - d) Project Address

# CERTIFICATION OF INSULATION

PART I GENERAL

ADDRESS OF TRACT

SACRAMENTO INSULATION CONTRACTORS

WM. LYONS

LOT # 86

- P.O. BOX 854, WEST SACRAMENTO, CA 95891 LIC. #202026
- 1309 MELODY ROAD, MARYSVILLE, CA 95901 LIC. #202026
- P.O. BOX 9651, FRESNO, CA 93793-9651 LIC. #202026
- P.O. BOX 1631, RENO, NV 89505 LIC. #10675
- 3326 A PONDEROSA WAY, LAS VEGAS, NV 89118 LIC. #10675

PALAZZO

DATE INSULATION COMPLETED

PART II AREAS INSULATED

WALLS	CEILINGS	FLOORS
( SQUARE FEET)	( SQUARE FEET)	( SQUARE FEET)
TYPE OF INSULATION	TYPE OF INSULATION	TYPE OF INSULATION
MATERIAL <b>FIBERGLASS</b>	MATERIAL <b>FIBERGLASS</b>	MATERIAL <b>FIBERGLASS</b>
FORM <b>BATTS</b>	FORM <b>BATTS &amp; BLOW</b>	FORM <b>BATTS</b>
MANUFACTURER'S PRODUCT I.D.	MANUFACTURER'S PRODUCT I.D.	MANUFACTURER'S PRODUCT I.D.
MANUFACTURER	MANUFACTURER	MANUFACTURER
<b>OCF</b>	<b>OCF</b>	<b>OCF</b>
	BAGS	
R-VALUE INSTALLED	APPLIED THICKNESS	R-VALUE INSTALLED
13	3 5/4"	30 30
APPLIED THICKNESS	R-VALUE INSTALLED	APPLIED THICKNESS
	9' 12'	

KNEE WALLS IF R-VALUE IS OTHER THAN WALLS ABOVE

MATERIAL	FORM	R VALUE	MANUFACTURER
<b>FIBERGLASS</b>	<b>BATTS</b>		<b>OCF</b>

AIR INFILTRATION SEALANT

MATERIAL	MANUFACTURER
<b>FOAM</b>	<b>W R GRACE</b>

THIS IS TO CERTIFY THAT INSULATION AND/OR SEALANT HAS BEEN INSTALLED IN CONFORMANCE WITH APPLICABLE CODES, MATERIAL STANDARDS AND REGULATIONS

SIGNATURE—INSULATION CONTRACTOR <i>Jeff Cable</i>	TITLE MANAGER	DATE 11-20-01
SIGNATURE—GENERAL CONTRACTOR	TITLE	DATE

REMARKS

November 28, 2001

The City of Sacramento  
Building Department

SUBJECT: Lyon Palazze  
Sacramento, CA

PERMIT # 0105671  
1918 KANE AVE  
1-18-02

Dear Sir:

The purpose of this letter is to discuss the completion of houses at the above-referenced project.

Due to inclement weather conditions, we have been unable to finish the final grading and installation of front yard landscaping of the lots that are due for building finals. This letter will acknowledge that William Lyon Homes, Inc. hereby promises to complete all final grading and landscaping necessary as soon as weather and soil conditions permit.

If you require any further information, please feel free to contact our office at your earliest convenience. Thank you in advance for your assistance in this matter.

Very truly yours,

WILLIAM LYON HOMES, INC.

Robert F. Knobel,  
Vice President/Manager Sacramento Operations

krc

"For informational purposes only. This plot is intended to show the approximate house orientation and proposed lot drainage pattern. All setbacks, other than minimum code requirements, are approximate. This plot plan may not reflect the final "as built" conditions. Refer to final map, grading plans, improvement plans and title records for additional information that may affect this lot."

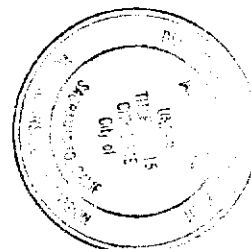
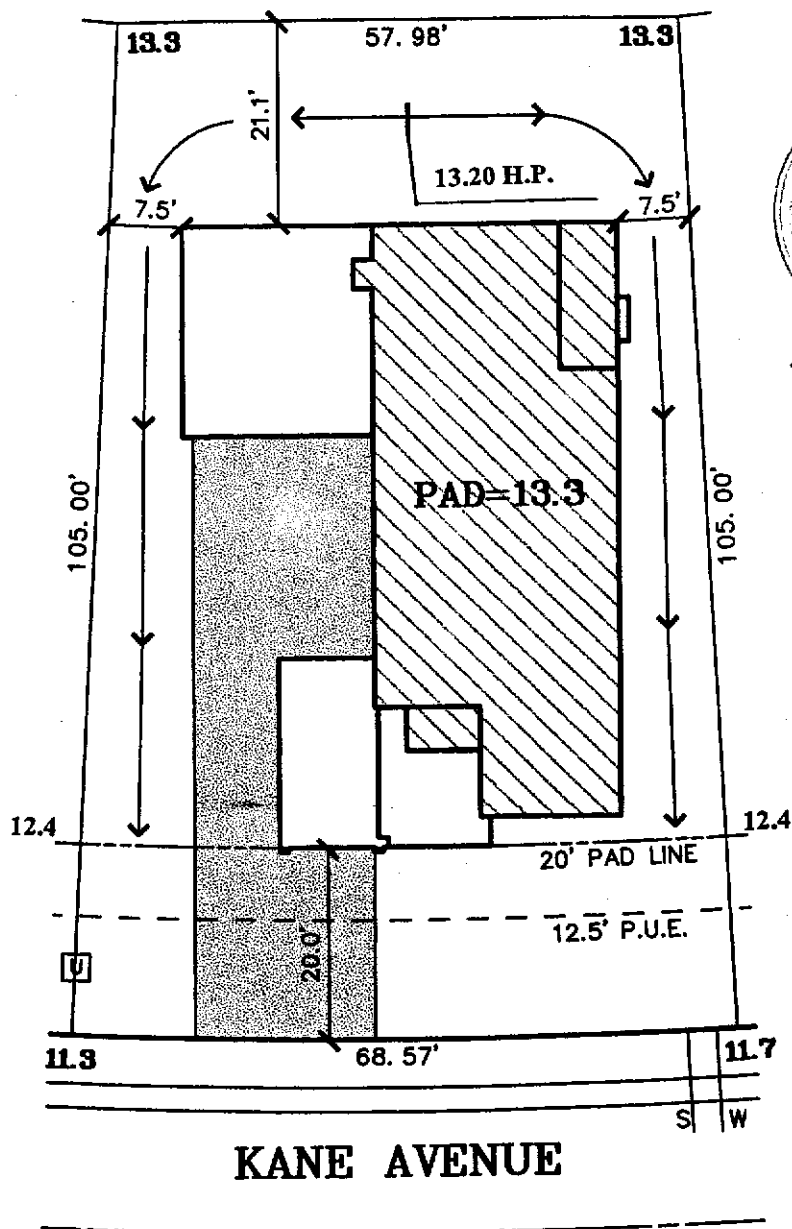

The approval of this plan and specification shall NOT be held to permit or approve the violation of any City Ordinance or State Law.

**LOT 86**  
**PLAN 3B LEFT**  
**A.P.N.: 225-1490-086**  
**ADDRESS: 1918 KANE AVENUE**  
**LOT AREA: 6,675 SF**  
**LOT COVERAGE: 31%**

**The Splink Corporation**  
 2590 VENTURE OAKS WAY  
 SACRAMENTO, CA. 95833

H:(916)925-5550 FAX:(916)921-9274

**WILLIAM LYON HOMES**

2803 Camino Ramon  
 Suite 150  
 San Ramon, Ca. 94583

office: (925) 543-5500  
 fax: (925) 543-5501

**NORTHPOINTE PARK**

**UNIT NO. 10**

City of Sacramento, California

Scale: 1"=20'

April 18, 2001