

**CITY OF SACRAMENTO**

**Permit No: 0110556**

**1231 I Street, Sacramento, CA 95814**

**Insp Area: 4**

**Site Address: 3424 JABBOUR WY SAC**

**Thos Bros:**

**Parcel No: RIVERVIEW 2 VIL. 4-B LOT 28**

**Sub-Type: NSFR**

**Housing (Y/N): N**

**CONTRACTOR**

**OWNER**

**ARCHITECT**

BEAZER HOMES  
3009 DOUGLAS BL #150  
ROSEVILLE CA 95661

**Nature of Work: NSFR MP1346 1 STORY 6 RMS**

**CONSTRUCTION LENDING AGENCY :** I hereby affirm under penalty of perjury that there is a construction lending agency for the performance of the work for which this permit is issued (Sec. 3097, Civ. C).

Lender's Name \_\_\_\_\_ Lender's Address \_\_\_\_\_

**LICENSED CONTRACTORS DECLARATION:** I hereby affirm under penalty of perjury that I am licensed under provisions of Chapter 9 (commencing with section 7000) of Division 3 of the Business and Professions Code and my license is in full force and effect.

License Class B License Number 724191 Date 9/4/01 Contractor Signature Sheuyf Van Maeren

**OWNER-BUILDER DECLARATION:** I hereby affirm under penalty of perjury that I am exempt from the Contractors License Law for the following reason (Sec. 7031.5, Business and Professions Code; any city or county which requires a permit to construct, alter, improve, demolish, or repair any structure, prior to its issuance, also requires the applicant for such permit to file a signed statement that he or she is licensed pursuant to the provisions of the Contractors License Law (Chapter 9 (commencing with Section 7000) of Division 8 of the Business and Professions Code) or that he or she is exempt therefrom and the basis for the alleged exemption. Any violation of Section 7031.5 by any applicant for a permit subjects the applicant to a civil penalty of not more than five hundred dollars (\$500.00);

\_\_\_\_\_, I, as a owner of the property, or my employees with wages as their sole compensation, will do the work, and the structure is not intended or offered for sale (Sec. 7044, Business and Professional Code: The Contractors License Law does not apply to an owner of property who builds or improves thereon, and who does such work himself or herself or through his/her own employees, provided that such improvements are not intended or offered for sale. If, however, the building or improvement is sold within one year of completion, the owner-builder will have the burden of proving that he/she did not build or improve for the purpose of sale.)

\_\_\_\_\_, I, as owner of the property, am exclusively contracting with licensed contractors to construct the project (Sec. 7044, Business and Professions Code: The Contractors License Law does not apply to an owner of property who builds or improves thereon, and who contracts for such projects with a contractor(s) licensed pursuant to the Contractors License Law).

\_\_\_\_\_, I am exempt under Sec. \_\_\_\_\_ B & PC for this reason: \_\_\_\_\_

Date \_\_\_\_\_ Owner Signature \_\_\_\_\_

**IN ISSUING THIS BUILDING PERMIT,** the applicant represents, and the city relies on the representation of the applicant, that the applicant verified all measurements and locations shown on the application or accompanying drawings and that the improvement to be constructed does not violate any law or private agreement relating to permissible or prohibited locations for such improvements. This building permit does not authorize any illegal location of any improvement or the violation of any private agreement relating to location of improvements.

I certify that I have read this application and state that all information is correct. I agree to comply with all city and county ordinances and state laws relating to building construction and hereby authorize representative(s) of this city to enter upon the abovementioned property for inspection purposes.

Date 9/4/01 Applicant/Agent Signature Sheuyf Van Maeren

**WORKER'S COMPENSATION DECLARATION:** I hereby affirm under penalty of perjury one of the following declarations:

\_\_\_\_\_, I have and will maintain a certificate of consent to self-insure for workers' compensation as provided for by Section 3700 of the Labor Code, for the performance of work for which the permit is issued.

I have and will maintain workers' compensation insurance, as required by Section 3700 of the Labor Code, for the performance of the work for which this permit is issued. My workers' compensation insurance carrier and policy number are:

Carrier LIBERTY MUTUAL INS CO. Policy Number WA2-651-004147-080 Exp Date 04/01/2002

\_\_\_\_\_, (This section need not be completed if the permit is for \$100 or less) I certify that in the performance of the work for which this permit is issued, I shall not employ any person in any manner so as to become subject to the workers' compensation laws of California and agree that if I should become subject to the workers' compensation provisions of Section 3700 of the Labor Code, I shall forthwith comply with those provisions.

Date 9/4/01 Applicant Signature Sheuyf Van Maeren

**WARNING: FAILURE TO SECURE WORKER'S COMPENSATION COVERAGE IS UNLAWFUL AND SHALL SUBJECT AN EMPLOYER TO CRIMINAL PENALTIES AND CIVIL FINES UP TO ONE HUNDRED THOUSAND DOLLARS (\$100,000) IN ADDITION TO THE COST OF COMPENSATION, DAMAGES AS PROVIDED FOR IN SECTION 3706 OF THE LABOR CODE, INTEREST AND ATTORNEY'S FEE.**

**THIS PERMIT SHALL EXPIRE BY LIMITATION IF WORK IS NOT COMMENCED WITHIN 180 DAYS.**

Lot 28

### RESIDENTIAL BUILDING PERMIT APPLICATION

New Construction     Addition     Remodels     Other

Project Address: 3424 Jabbar Way      Assessor Parcel # \_\_\_\_\_

#### OWNER INFORMATION:

Legal Property Owner: Beazer Homes Holdings Corp.      Phone # 916-773-3888  
Owner Address: 3009 Douglas Blvd. 150      City Roseville      State CA      Zip 95661

#### CONTRACTOR INFORMATION:

Contractor: Beazer Homes      Lic. # B724191      Phone # 916-773-3888      Fax # 916-773-0425

#### PROJECT INFORMATION:

Land Use Zone \_\_\_\_\_      Occupancy Group \_\_\_\_\_      Construction Type \_\_\_\_\_      Fed Code \_\_\_\_\_  
No. of stories: 1      No. of rooms: 6      Street width: \_\_\_\_\_  
1<sup>st</sup> Floor Area 1323      2<sup>nd</sup> Floor Area \_\_\_\_\_      Basement \_\_\_\_\_      Roof Material \_\_\_\_\_

AREA IN SQUARE FOOT OF:	EXISTING	NEW
Dwelling/Living	_____	<u>1323</u>
Garage/Storage	_____	<u>40</u>
Decks/Balconies	_____	<u>70</u>
Carports	_____	_____

SCOPE OF WORK: Single Family Dwelling

#### FOR OFFICE USE ONLY

- Information above complete       AR Flood Waiver required       Planning Approval
- Violation files checked       Flood Elevation Certificate Required       Design Review Approval
- Standard setbacks       Water Development Infill Area       Special Fee Districts Apply: \_\_\_\_\_
- County Sewer

#### NEW STRUCTURES & ADDITIONS

◆ THE FOLLOWING MUST BE PROVIDED IN ORDER TO SUBMIT FOR PLAN REVIEW

- 2 COMPLETE PLANS, LEGIBLE & DRAWN TO SCALE      ◆ Plans to include: site plan, floor plan, elevations, roof/ceiling plan, foundation and structural framing details, and structural calculations for non-conforming structures.
- 3 SETS IF PROJECT IS IN A DESIGN REVIEW AREA
- Title 24 Energy Compliance documentation       11" x 17" copy of floor plan for County Assessor
- Grading and Erosion Control Questionnaire       Plan Review Fees

Date: \_\_\_\_\_      Received by: (staff) \_\_\_\_\_

ACTIVITY/PERMIT # \_\_\_\_\_

# CERTIFICATION OF INSULATION

ADDRESS OR TRACT <div style="font-size: 2em; font-family: cursive;">BEAZER</div> <div style="margin-left: 200px;">LOT #</div> <div style="margin-left: 200px; font-size: 2em; font-family: cursive;">4028</div> <div style="margin-top: 20px;">CLASSICS</div>	SACRAMENTO INSULATION CONTRACTORS <input checked="" type="checkbox"/> P.O. BOX 854, WEST SACRAMENTO, CA 95691 LIC. #202026 <input type="checkbox"/> 1309 MELODY ROAD, MARYSVILLE, CA 95901 LIC. #202026 <input type="checkbox"/> P.O. BOX 9651, FRESNO, CA 93793-9651 LIC. #202026 <input type="checkbox"/> P.O. BOX 1631, RENO, NV 89505 LIC. #10675 <input type="checkbox"/> 3326 PONDEROSA WAY, LAS VEGAS, NV 89118 LIC. #10675 DATE INSULATION COMPLETED
--	--

WALLS		CEILINGS			FLOORS	
( SQUARE FEET)		( SQUARE FEET)			( SQUARE FEET)	
TYPE OF INSULATION		TYPE OF INSULATION			TYPE OF INSULATION	
MATERIAL <b>FIBERGLASS</b>		MATERIAL <b>FIBERGLASS</b>			MATERIAL <b>FIBERGLASS</b>	
FORM <b>BATTS</b>		FORM <b>BATTS &amp; BLOW</b>			FORM <b>BATTS</b>	
MANUFACTURER'S PRODUCT I.D.		MANUFACTURER'S PRODUCT I.D.			MANUFACTURER'S PRODUCT I.D.	
MANUFACTURER		MANUFACTURER			MANUFACTURER	
<b>OCF</b>		<b>OCF</b>			<b>OCF</b>	
BAGS						
R-VALUE INSTALLED	APPLIED THICKNESS	R-VALUE INSTALLED	APPLIED THICKNESS	MIN. INSTALLED WEIGHT PER SQUARE FOOT	R-VALUE INSTALLED	APPLIED THICKNESS
13	3 5/8"	30 30	9" 12"			
KNEE WALLS IF R-VALUE IS OTHER THAN WALLS ABOVE						
MATERIAL <b>FIBERGLASS</b>		FORM <b>BATTS</b>		R-VALUE		MANUFACTURER <b>OCF</b>
AIR INFILTRATION SEALANT						
MATERIAL <div style="font-size: 2em; font-family: cursive;">FOAM</div>				MANUFACTURER <b>W R GRACE</b>		

THIS IS TO CERTIFY THAT INSULATION AND/OR SEALANT HAS BEEN INSTALLED IN CONFORMANCE WITH APPLICABLE CODES, MATERIAL STANDARDS AND REGULATIONS.

SIGNATURE - INSULATION CONTRACTOR <div style="font-family: cursive; font-size: 1.5em;">Jeff Cable</div>	TITLE MANAGER	DATE 10-22-01
SIGNATURE - GENERAL CONTRACTOR	TITLE	DATE

REMARKS:

**KwikKote**

No. 200-003618

**Stucco System  
Installation Card**

Job Name: CLASSIC COLLECTION/RIVERVIEW  
Address: 3424 JABBOUR WAY  
SACRAMENTO,  
Lot #: 0004028

Stucco System Trade Name: KWIK KOTE  
Stucco System Manufacturer: KWIK KOTE CORP.

ICBO Evaluation Service, Inc.  
Report No. 3607  
Date of Job Completion:

Home Builder: BEAZER HOMES  
Address: 3009 DOUGLAS BLVD #150  
ROSEVILLE, CA

Stucco Contractor: KENYON PLASTERING, INC.  
Address: PO BOX 2077  
North Highlands, CA

Telephone Number: 916/349-8191

Approved Contractor Number as  
issued by the Stucco Manufacturer: 1001

Card Print Date: 08/20/2001

This is to certify that the stucco system on the building exterior at the above address had been installed in accordance with the evaluation report specified above and the manufacturer's instructions.

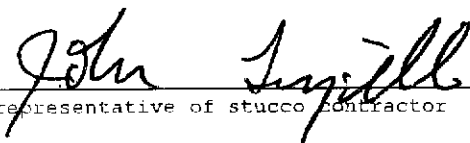

Signature of authorized representative of stucco contractor

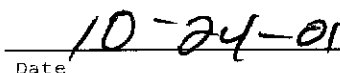

Date

THIS PLOT PLAN IS NOT FOR SALES PURPOSES. THIS PLOT PLAN IS FOR THE PURPOSES OF INDICATING COMPLIANCE WITH ZONING SET BACKS, GENERAL DRAINAGE DIRECTION, AND APPROXIMATE UTILITY CONNECTION. ALL OTHER DATA SHOWN HEREON IS CONCEPTUAL. THIS PLOT PLAN DOES NOT REFLECT AS-BUILT CONDITION. RETAINING WALL ARE OPTIONAL AND MAY OR MAY NOT BE CONSTRUCTED.

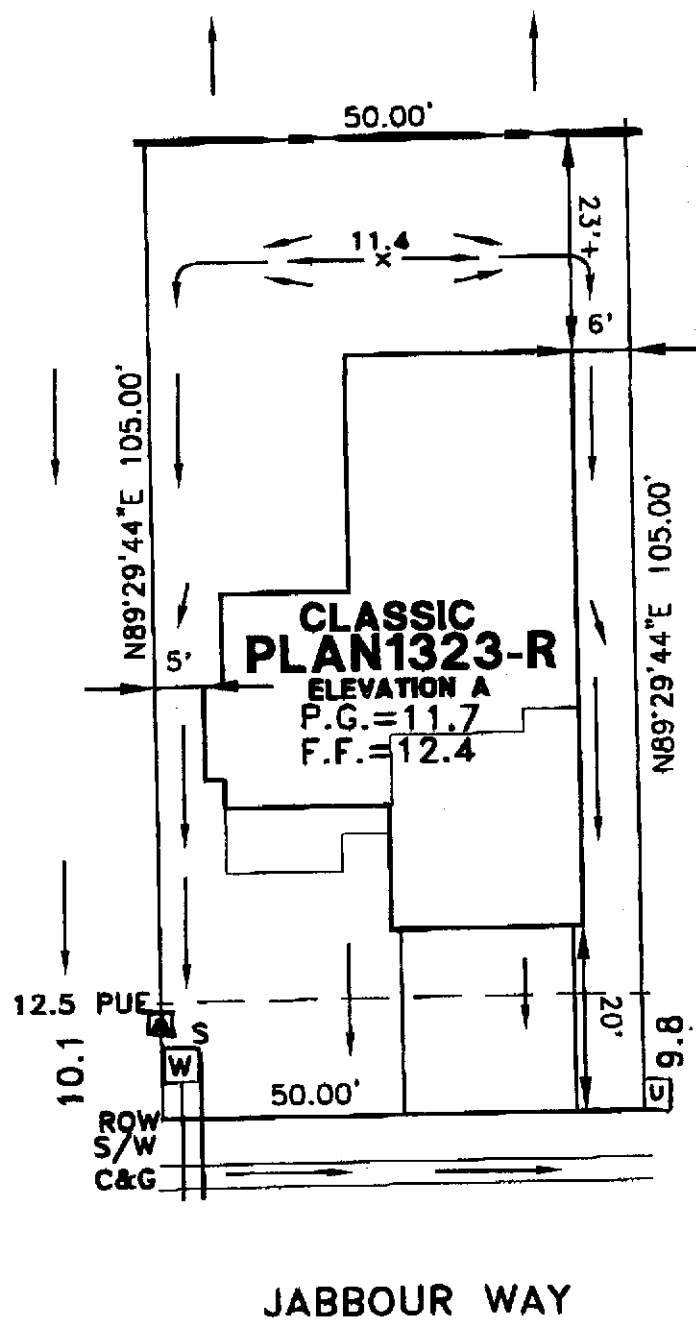
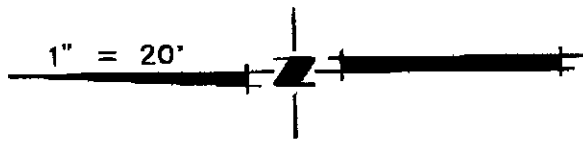

This plot plan and any other information shown hereon is for informational purposes only and does not constitute a contract. The user of this information shall be responsible for its accuracy and for any errors or omissions. The user shall indemnify and hold the engineer harmless from and against all claims, damages, and expenses, including reasonable attorneys' fees, arising out of or from the use of this information.

ROUTING/APPROVAL		INITIALS
President	✓	
Project Engineer		
Surveyor		
		✓

- ☐ = UTILITY SERVICE BOX
- ⚡ = TRANSFORMER

JABBOUR WAY

**PLOT PLAN**  
**LOT 28**  
 RIVER VIEW #2 VILLAGE 4B  
 FOR  
 BEAZER HOMES  
 CITY OF SACRAMENTO CALIFORNIA  
**WOOD RODGERS INC.**  
 ENGINEERING PLANNING MAPPING SURVEYING  
 3301 C STREET, BLDG. 100-B, SACRAMENTO, CA 95816  
 PHONE: (916) 341-7760 FAX: (916) 341-7767

DATE:	DRAWN:	CHECKED:	PROJECT NO:
JUN 2001	VM	MTG	1055.015

\\KRONOS\JOBS\JOBS\RIVERVIEW\DWG\FROMREY\UNIT2\PHASE4B\LOT PLANS\LOT-28.DWG 06/18/01 12:50