

CITY OF SACRAMENTO

1231 I Street, Sacramento, CA 95814

Permit No: 0506466

Insp Area: 4

Thos Bros: 277E3

Site Address: 899 MAPLEGROVE WY SAC

Parcel No: 250-0410-140

Sub-Type: AOTHR

Housing (Y/N): N

CONTRACTOR

PACIFIC BUILDERS
5421 84TH ST
SACRAMENTO CA 95826

OWNER

DAVIS JOSETTE J
899 MAPLEGROVE WY
SACRAMENTO, CA 95834

ARCHITECT

Nature of Work: NEW INCLOSED 225 SQFT ALUM OATIO COVER WITH ELECTRICAL FOR FAN, LIGHTS, AND OUTLETS.

CONSTRUCTION LENDING AGENCY: I hereby affirm under penalty of perjury that there is a construction lending agency for the performance of the work for which this permit is issued (Sec. 3097, Civ. C).

Lender's Name _____ Lender's Address _____

LICENSED CONTRACTORS DECLARATION: I hereby affirm under penalty of perjury that I am licensed under provisions of Chapter 9 (commencing with section 7000) of Division 3 of the Business and Professions Code and my license is in full force and effect.

License Class B1 License Number 214409 Date 5-9-05 Contractor Signature [Signature]

OWNER-BUILDER DECLARATION: I hereby affirm under penalty of perjury that I am exempt from the contractor License Law for the following reason (Sec. 7031.5, Business and Professions Code; any city or county which requires a permit to construct, alter, improve, demolish, or repair any structure, prior to its issuance, also requires the applicant for such permit to file a signed statement that he or she is licensed pursuant to the provisions of the Contractors License Law (Chapter 9 (commencing with Section 7000) of Division 8 of the Business and Professions Code) or that he or she is exempt therefrom and the basis for the alleged exemption. Any violation of Section 7031.5 by any applicant for a permit subjects the applicant to a civil penalty of not more than five hundred dollars (\$500.00);

I, as a owner of the property, or my employees with wages as their sole compensation, will do the work, and the structure is not intended or offered for sale (Sec. 7044, Business and Professional Code: The Contractors License Law does not apply to an owner of property who builds or improves thereon, and who does such work himself or herself or through his/her own employees, provided that such improvements are not intended or offered for sale. If, however, the building or improvement is sold within one year of completion, the owner-builder will have the burden of proving that he/she did not build or improve for the purpose of sale.)

I, as owner of the property, am exclusively contracting with licensed contractors to construct the project (Sec. 7044, Business and Professions Code: The Contractors License Law does not apply to an owner of property who builds or improves thereon and who contracts for such projects with a contractor(s) licensed pursuant to the Contractors License Law).

I am exempt under Sec. _____ B & PC for this reason: _____

Date _____ Owner Signature _____

PAID
CITY OF SACRAMENTO
MAY 09 2005
COURT PERMIT CENTER

IN ISSUING THIS BUILDING PERMIT, the applicant represents, and the city relies on the representation of the applicant, that the applicant verified all measurements and locations shown on the application or accompanying drawings and that the improvement to be constructed does not violate any law or private agreement relating to permissible or prohibited locations for such improvements. This building permit does not authorize any illegal location of any improvement or the violation of any private agreement relating to location of improvements.

I certify that I have read this application and state that all information is correct. I agree to comply with all city and county ordinances and state laws relating to building construction and hereby authorize representative(s) of this city to enter upon the above-referenced property for inspection purposes.

Date 5-9-05 Applicant/Agent Signature [Signature]

WORKER'S COMPENSATION DECLARATION: I hereby affirm under penalty of perjury one of the following declarations:

I have and will maintain a certificate of consent to self-insure for workers' compensation as provided for by Section 3700 of the Labor Code, for the performance of work for which the permit is issued.

I have and will maintain workers' compensation insurance, as required by Section 3700 of the Labor Code, for the performance of the work for which this permit is issued. My workers' compensation insurance carrier and policy number are:

Carrier COMBINED SPECIALTY INSURANCE Policy Number 005-00026483 Exp Date 01/01/2006

(This section need not be completed if the permit is for \$100 or less) I certify that in the performance of the work for which this permit is issued, I shall not employ any person in any manner so as to become subject to the workers' compensation laws of California and agree that if I should become subject to the workers' compensation provisions of Section 3700 of the Labor Code, I shall forthwith comply with those provisions.

Date 5-9-05 Applicant Signature [Signature]

WARNING: FAILURE TO SECURE WORKER'S COMPENSATION COVERAGE IS UNLAWFUL AND SHALL SUBJECT AN EMPLOYER TO CRIMINAL PENALTIES AND CIVIL FINES UP TO ONE HUNDRED THOUSAND DOLLARS (\$100,000) IN ADDITION TO THE COST OF COMPENSATION, DAMAGES AS PROVIDED FOR IN SECTION 3706 OF THE LABOR CODE, INTEREST AND ATTORNEY'S FEE.

THIS PERMIT SHALL EXPIRE BY LIMITATION IF WORK IS NOT COMMENCED WITHIN 180 DAYS.

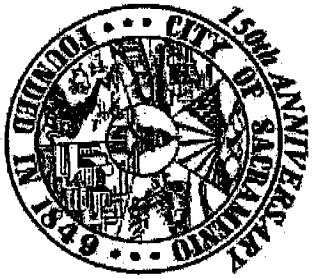

#050 6466

DATE: 5-4-05

CITY OF SACRAMENTO
DEVELOPMENT SERVICES DIVISION
FAXED PERMIT APPLICATION (certain restrictions apply)

Fax # 916-264-1901

Faxed request must be received in this office by 3:00 p.m. to be processed the following work day.
Note: Contractors must have a current certificate of Worker's Compensation Insurance.

Note: Work started before a Building Permit is issued will be subject to quad fee

IN ORDER TO PROCESS THIS REQUEST, ALL THE FOLLOWING INFORMATION MUST BE PROVIDED:

RESIDENTIAL APARTMENTS (4+ units per building) COMMERCIAL (limited)
JOB ADDRESS: 899 MARIE GROVE WY UNIT # _____ CONTRACT PRICE \$ 24,335.00
 CONTACT PERSON: CANYU CONTRACT PHONE: 38333168

Property Owner: JOSETE DAVIS
Address: 899 MARIE GROVE WY
City/State/Zip: SAC CA 95834
Phone: 5421-8425
Contractor: PACIFIC BLS License # 214409
Address: 5421-8425
City/State/Zip: SAC CA 95834
Phone: 38333168 FAX: _____

NATURE OF REQUEST: Indicate from the selections below & provide details under description of work.

<input type="checkbox"/> REROOF (excluding tile) <input type="checkbox"/> TEAR-OFF <input type="checkbox"/> RESHEET <input type="checkbox"/> HOUSE <input type="checkbox"/> GARAGE <input type="checkbox"/> # STAIRS: Material:	<input type="checkbox"/> HVAC INSTALLATIONS (residential ONLY) <input type="checkbox"/> CHANGE-OUT <input type="checkbox"/> NEW <input type="checkbox"/> Heat Pump <input type="checkbox"/> Package <input type="checkbox"/> Split system <input type="checkbox"/> Roof mount <input type="checkbox"/> Cut-in <input type="checkbox"/> Heat pump or elect. unit to gas. <input type="checkbox"/> Wall furnace <input type="checkbox"/> Other (describe below)	<input type="checkbox"/> WATER HEATER (residential ONLY) <input type="checkbox"/> GAS <input type="checkbox"/> ELECTRIC <input type="checkbox"/> Change-out <input type="checkbox"/> Electric to Gas <input type="checkbox"/> Relocate <input type="checkbox"/> New	<input type="checkbox"/> MINOR ELECTRIC and/or MINOR PLUMBING (residential ONLY) <input type="checkbox"/> Electric Service Change # amps <input type="checkbox"/> New electric circuits <input type="checkbox"/> Re-wire <input type="checkbox"/> Water Service Replacement <input type="checkbox"/> Sewer Service Replacement <input type="checkbox"/> Gas Line Replacement <input type="checkbox"/> Re-plumb <input type="checkbox"/> Water <input type="checkbox"/> Waste	<input type="checkbox"/> PUBLIC UTILITIES SAFETY INSPECTION* (Residential and single apartment units ONLY) <input type="checkbox"/> SMUD <input type="checkbox"/> PGE *NOTE: Correction Notice items will require an additional building permit
<input type="checkbox"/> SIDING <input type="checkbox"/> wood <input type="checkbox"/> T-111 <input type="checkbox"/> Horiz <input type="checkbox"/> vinyl <input type="checkbox"/> stucco Note: Design Review approval may be required in certain areas.	Value of duct work: Equipment: \$ Cut-in: \$ Note: Design Review approval may be required for rooftop units.	<input type="checkbox"/> DRY ROT OR TERMITTE DAMAGE REPAIR (Describe locations below) Note: Design Review approval may be required in certain areas.		

DESCRIPTION OF WORK:

PARTIAL EXPOSURE 15' X 15' W/ELECT

225 SAF

0506466

899 MAPLE GROVE WY

ISSUED
City of Sacramento
MAY 09 2004
NORTH PERMIT
CENTER

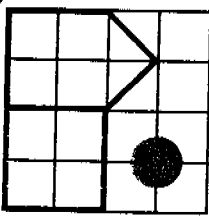

PACIFIC BUILDERS
5421 84TH ST.
SACRAMENTO 95826
(916) 383-3188

PLOT PLAN

SCALE: 1" = 20'

CUSTOMER: Joseette Davis
ADDRESS: 899 Maplegrove Way
City, St & Zip: Sacramento, CA 95834
PHONE: (916) 646-4813

Diagram and size approved by Customer
ESTIMATOR APPROVAL: Tony McDonald
PRE-SITE APPROVAL: Jay R Bell

PRINT DATE 4-29-05
SHEET 1 OF 5

DATE _____
DATE _____

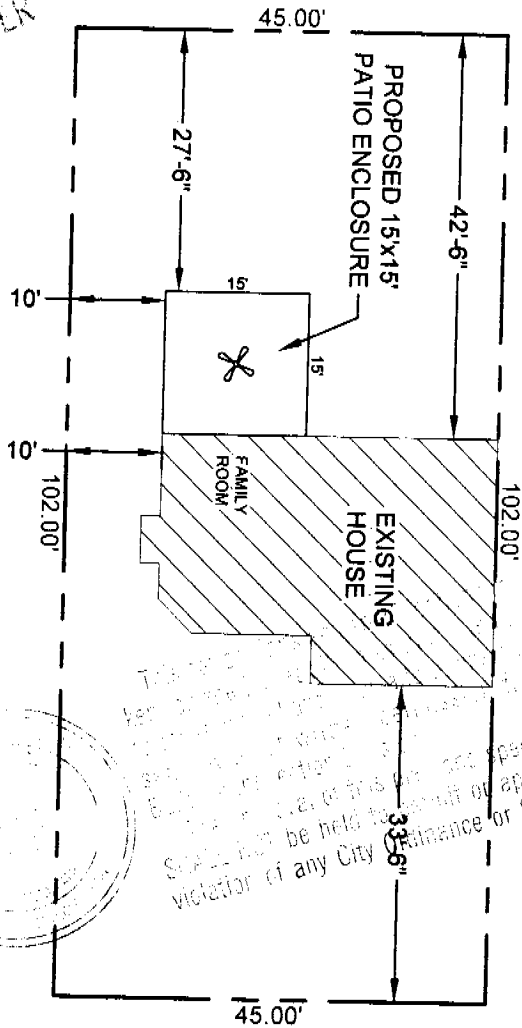

899 MAPLEGROVE WAY



Small, faint text: This is a preliminary drawing. It is not to be used for construction. It is subject to change without notice. The City of Sacramento does not approve or disapprove of this drawing. It is the responsibility of the applicant to obtain all necessary permits and approvals. The City of Sacramento is not responsible for any errors or omissions. The City of Sacramento is not liable for any damages, including consequential damages, arising from the use of this drawing. The City of Sacramento is not responsible for any delays or interruptions in the permit process. The City of Sacramento is not responsible for any costs or fees associated with the permit process. The City of Sacramento is not responsible for any other matters related to the permit process.

59.05
Share

THE APPROVAL OF ALL ELECTRICAL WORK
IS SUBJECT TO FIELD INSPECTIONS.

CITY COPY

#05 06466

899 MAPLE GROVE WY

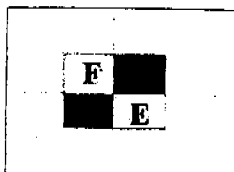

FOX ENGINEERING INC.

JAMES G. FOX, CIVIL ENGINEER
8060 TELEGRAPH RD., DOWNEY, CA 90240
(562) 806-1337 FAX (562) 927-2509
Email: foxeng@hotmail.com

STANDARD PLANS FOR:

I.C.B.O. ER-4383-P-K122
GLASS ENCLOSURE - 2" & 3" WALL SYSTEMS



World Class Sunrooms Since 1947

2285 FLEETWOOD DRIVE, RIVERSIDE, CA 92509
(909) 369-8777 FAX (909) 369-0847

WEBSITE: www.c-thru.com

ISSUED
City of Sacramento
MAY 09 2005
NORTH PERMIT
CENTER

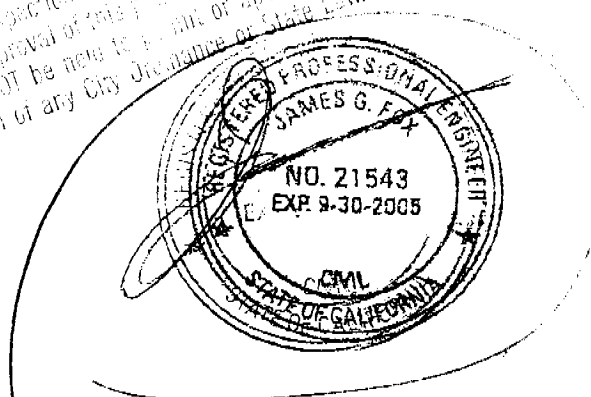
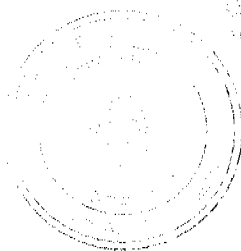

FOX ENGINEERING IS THE ENGINEER ON RECORD FOR STANDARD PLANS I.C.B.O. ER-4383-P. THIS COVER SHEET WITH FOX ENGINEERING'S STAMP & SIGNATURE SHALL COVER THESE SHEETS. ANY WET SIGNATURE'S WILL HAVE TO CONTACT C-THRU OR FOX ENGINEERING.

FOX ENGINEERING WAS ENGAGED TO PROVIDE CALCULATIONS AND CONSULTATION IN CONNECTION WITH THE ABOVE DESCRIBED PROJECT. WE HAVE NO AUTHORITY INSOFAR AS CONTRACTORS OR OWNERS PERSONNEL ARE CONCERNED. OWNER AND CONTRATOR ARE ADMONISHED TO OBSERVE ALL SAFETY ORDINANCES FOR PROTECTION OR PERSONNEL. IN MAKING USE OF THESE DOCUMENTS, CONTRACTOR/OWNER AGREES TO HOLD FOX ENGINEERING HARMLESS FROM ALL COSTS OF LITIGATION THAT MAY ARISE OUT OF ALLEGED DAMAGES OR INJURIES ASSOCIATED WITH THE WORK DEFINED BY THESE DOCUMENTS, INCLUDING ATTORNEY'S FEES AND JUDGEMENTS, UNLESS IT IS PROVEN THAT SAID INJURIES OR DAMAGES RESULTED FROM ERRORS IN, OR OMISSIONS FROM THE DOCUMENTS.

THE APPROVAL OF ALL ELECTRICAL WORK
IS SUBJECT TO FIELD INSPECTIONS.

CITY COPY

ATTACHMENT HEIGHT

ELEVATION REPORT RECOGNIZED ALUMINUM PATIO COVER

#14 METAL BACKED 5/8"Ø NEOPRENE WASHERED TEKS @ 8" O.C. MAX.

(2) #6 TEKS EA. SIDE TO MATCH "H" (4 PER "H") OR 1/8"Ø "POP" RIVETS

TOP & BOTTOM TRACK SHALL BEAR FIRMLY ON MULLION PRIOR TO INSTALLATION OF FASTENERS

TOP TRACK TO SPLICE DIRECTLY OVER MATED "H"

MAXIMUM ATTACHMENT HEIGHT SHALL NOT EXCEED 12' (HEIGHT) FROM FINISH GRADE (GROUND LEVEL)

1/4"Ø "KWIK-BOLT" OR EQUAL PER ICBO ES ER-4627.3" MAX. FROM EA. SIDE OF MATED "H" (2-PER PANEL)

BOTTOM TRACK SPLICE 8" MINIMUM FROM VERTICAL MULLION

2- #6 TEKS EA. SIDE TO MATED "H" (4-PER "H") OR 1/8"Ø "POP" RIVETS

MIN. HEIGHT = 6'-8" FOR MAX. HEIGHT SEE TABLES ON SHEET 2D

SOLID PANEL

6" MAX. WINDOW OPENING SEE GENERAL NOTE #7 ON SHEET 2D

30" MAX. SOLID PANEL

NOTE: 6'-0" MAX. WIDTH TEMPERED GLASS OR 1/8" PLASTIC SIDE SLIDING DOORS MAY BE INSTALLED IN END WALLS WHERE SOLID PANELS ARE PERMITTED (SEE NOTE ON FLOOR PLAN) 6'-0" MAX. WIDTH SIDE SLIDING DOORS WITH 1/8" MAX. THICKNESS PLASTIC MAY BE INSTALLED IN ANY NON-BEARING WALL SEE DETAIL (16) & (25) SHT. 1E & 2D FOR JAMES REQ'D. AT THESE DOORS, WALLS WHERE SLICING DOORS OCCUR SHALL NOT EXCEED 9'-6" IN HEIGHT

ISSUED City of Sacramento MAY 09 2005 NORTH PERMIT CENTER

STND. # WASHER

(6)

EXIST. CONC. SLAB IN GOOD CONDITION

2" MIN.

3 1/2" MIN.

1 1/2" MIN.

NOTE: FOR WALL ENCLOSURE ON WOOD DECK, SEE DETAIL (22) SHT. 4D.

BEARING SYSTEM (A)

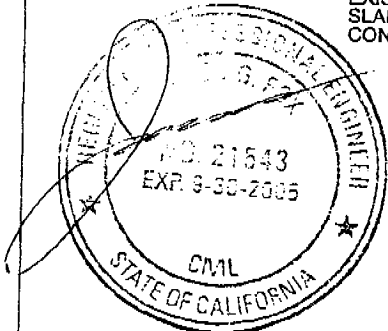

JOB NO. K-122
1B OF 24 SHEET

C-THRU INDUSTRIES, INC.
INDUSTRIAL BUILDING DIVISION
10000 FIVE POINTS DRIVE
DUBLIN, CA 94568
(916) 999-8777

PATIO COVER & ENCLOSURE BY

REVISION DATE: JANUARY 2003

"THE C-THRU GLASS ENCLOSURE" 3" WALL SYSTEM

FOX ENGINEERING INC.
JAMES M. FOX, STRUCTURAL ENGINEER
JAMES G. FOX, CIVIL ENGINEER
4440 FERRIS BLVD., SUITE 100, SACRAMENTO, CA 95821
(916) 486-1337 FAX: (916) 486-1338

DATE: 5/9/05
ACAD. REVISED: 10/7/01
Drawn by: I. DANILIA
Checked by: E.K.
SCALE: NONE

I.C.B.O. E.S. 4383 P
EVALUATION REPORT NO. K-122

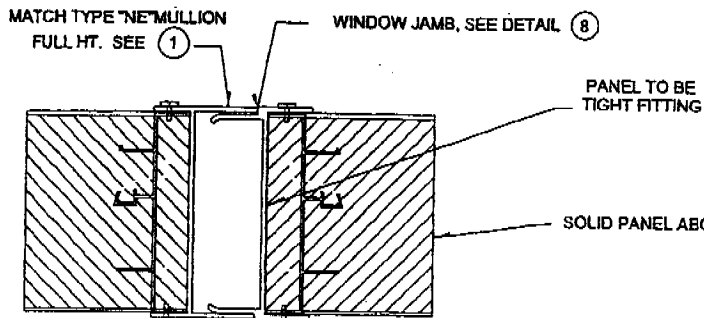

WINDOW-WINDOW MULLION-TYPE "NE" ⑨
ALUM. ALLOY 6063-T6

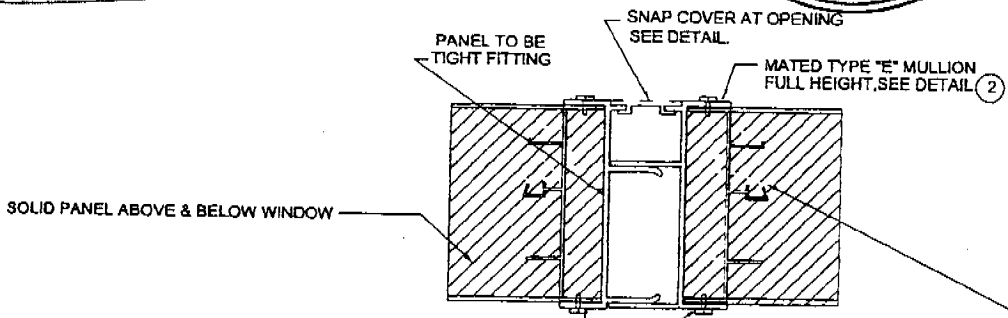
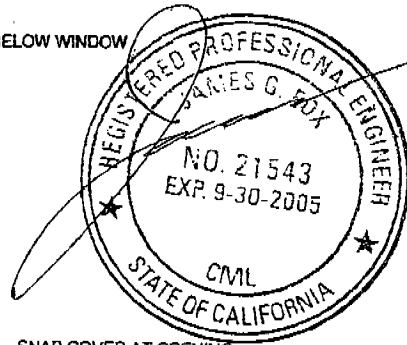

WINDOW-WINDOW MULLION-TYPE "E" ⑩
ALUM. ALLOY 6063-T6

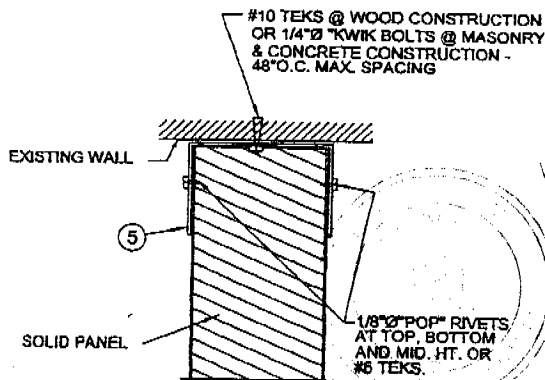

EXISTING WALL CONNECTION ⑪

This set of plans and specifications must be kept on the job at all times and it is unlawful to make any changes or alterations from the same without written permission from the Building Inspection Division. The approval of this plan and specifications SHALL NOT be held to permit or approve the violation of any City Ordinance or State Law.

ISSUED
City of Sacramento
MAY 09 2005
NORTH PLAZA
CENTER
DOOR HEAD & JAMB
JAMB EXTRUSION
16" MAX.
SOLID PANEL

DOOR JAMB ⑫
ALUM. ALLOY 6063-T6

Job No. K-122
1E OF 24 SHEET

C-THRU INDUSTRIES, INC. 10001 988-8777

REGISTERED PROFESSIONAL ENGINEER
JAMES G. FOX
NO. 21543
EXP. 9-30-2005
CML
STATE OF CALIFORNIA

REVISION DATE: JANUARY 2003

"THE C-THRU GLASS ENCLOSURE" 3" WALL SYSTEM

FOX ENGINEERING INC.
JAMES M. FOX STRUCTURAL ENGINEER
JAMES G. FOX CIVIL ENGINEER
1400 FT. FOREBARI RD. DUNSMY, CA 95820

DATE: 5/9/05
SCALE: NONE

I.C.B.O. E.S. 4983 P
EVALUATION REPORT NO. K-122

1/8"Ø"POP"RIVETS OR #6 TEKS
@ TOP, BOTT. & 27" O.C.
BETWEEN, TYP. EA. SIDE

MATED TYPE "E" MULLION
FULL HEIGHT SEE DET. (2)

1/8"Ø"POP"RIVETS OR #6 TEKS
@ TOP, BOTT. & 27" O.C.
BETWEEN, TYP. EA. SIDE

TIGHT FITTING PANEL
TYP. WHERE OCCURS

WINDOW JAMB
PER DETAIL (8)

SNAP COVER @ OPENING
SEE DETAIL (10)

MATED TYPE "NE" MULLION
FULL HEIGHT SEE DET. (1)

SOLID PANEL ABOVE
AND BELOW WINDOW

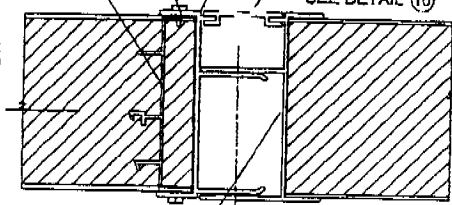

SOLID PANEL ABOVE
AND BELOW WINDOW

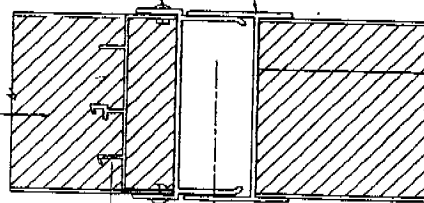

TIGHT FITTING PANEL
TYP. WHERE OCCURS

SOLID PANELS
SEE TABLES "A" & "B"
FOR MAX. MULLION SPACING

WINDOW JAMB
PER DETAIL (8)

SOLID PANELS
SEE TABLES "A" & "B"
FOR MAX. MULLION SPACING

WINDOW-PANEL MULLION (13)

TIGHT FITTING PANEL
TYP. WHERE OCCURS

MATED TYPE "E" MULLION
FULL HEIGHT SEE DET. (2)

MATED TYPE "NE" MULLION
FULL HT., SEE (1)

PANEL TO BE
TIGHT FITTING

SNAP COVER @ OPENING
SEE DETAIL (10)

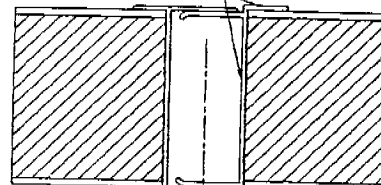
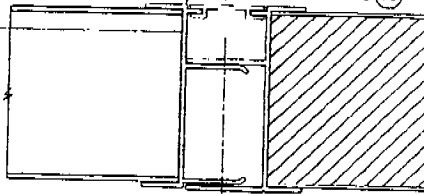

SOLID PANELS
SEE TABLES "B"
FOR MAX. MULLION SPACING

SOLID PANELS
SEE TABLES "B"
FOR MAX. MULLION SPACING

SOLID PANELS
SEE TABLES "B"
FOR MAX. MULLION SPACING

SOLID PANELS
SEE TABLES "B"
FOR MAX. MULLION SPACING

PANEL-PANEL MULLION (14)

1" x 2" x 1" x .05" THICK "U" CHANNEL
x 24" LONG (6063-T6 ALUM.) @ 24" O.C.
ATTACH TO EACH PANEL LOCK W/ #8 TEKS

#14 SMS @ 12" O.C. MAX.

CONNECTIONS SAME
AS SECTION (B)

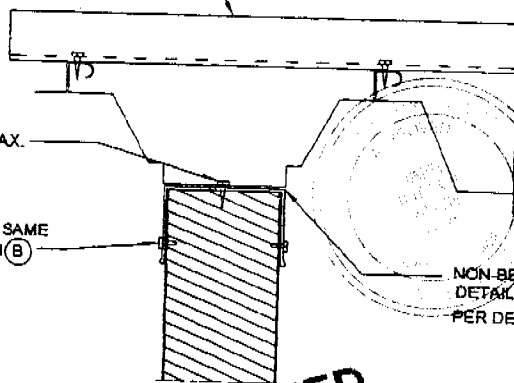

NON-BEARING TOP TRACK PER
DETAIL 5 OR BEARING TRACK
PER DETAILS (3) & (4)

ISSUED
City of Sacramento
MAY 09 2005
NORTH PERMIT
CENTER

(15)

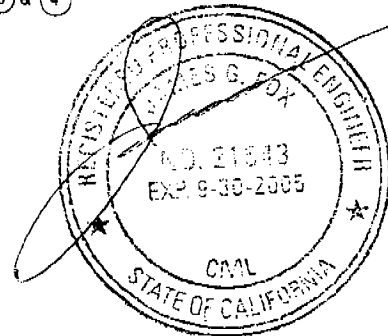

This set of plans and specifications must be kept on the job at all times and it is unlawful to make any changes or alterations from the same without written permission from the Building Inspection Division. The approval of this plan and specification SHALL NOT be held to permit or approve the violation of any City Ordinance or State Law

DATE: 2005
DRAWN BY: T. DANINA
SCALE: NONE

REVISION DATE:
JANUARY 2003

"THE C-THRU
GLASS ENCLOSURE"
5" WALL SYSTEM

FOX ENGINEERING INC.
JAMES M. FOX, STRUCTURAL ENGINEER
JAMES G. FOX, CIVIL ENGINEER
8000 TELEGRAPH RD., FERNANDINA, FL 32157
(904) 877-7768

DATE: 2005
DRAWN BY: T. DANINA
SCALE: NONE

I.C.B.O. E.S. 4383 P
EVALUATION
REPORT NO. K-122

C-THRU
GLASS ENCLOSURE
5" WALL SYSTEM
2208 FLEETWOOD DRIVE
FERNANDINA, FL 32157
(904) 388-8777

ASB NO. K-122
2C OF 24
SHEET

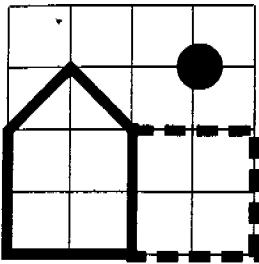

PACIFIC BUILDERS

5421 84th Street
Sacramento, CA 95826
(916) 383-3168

Work Sheet

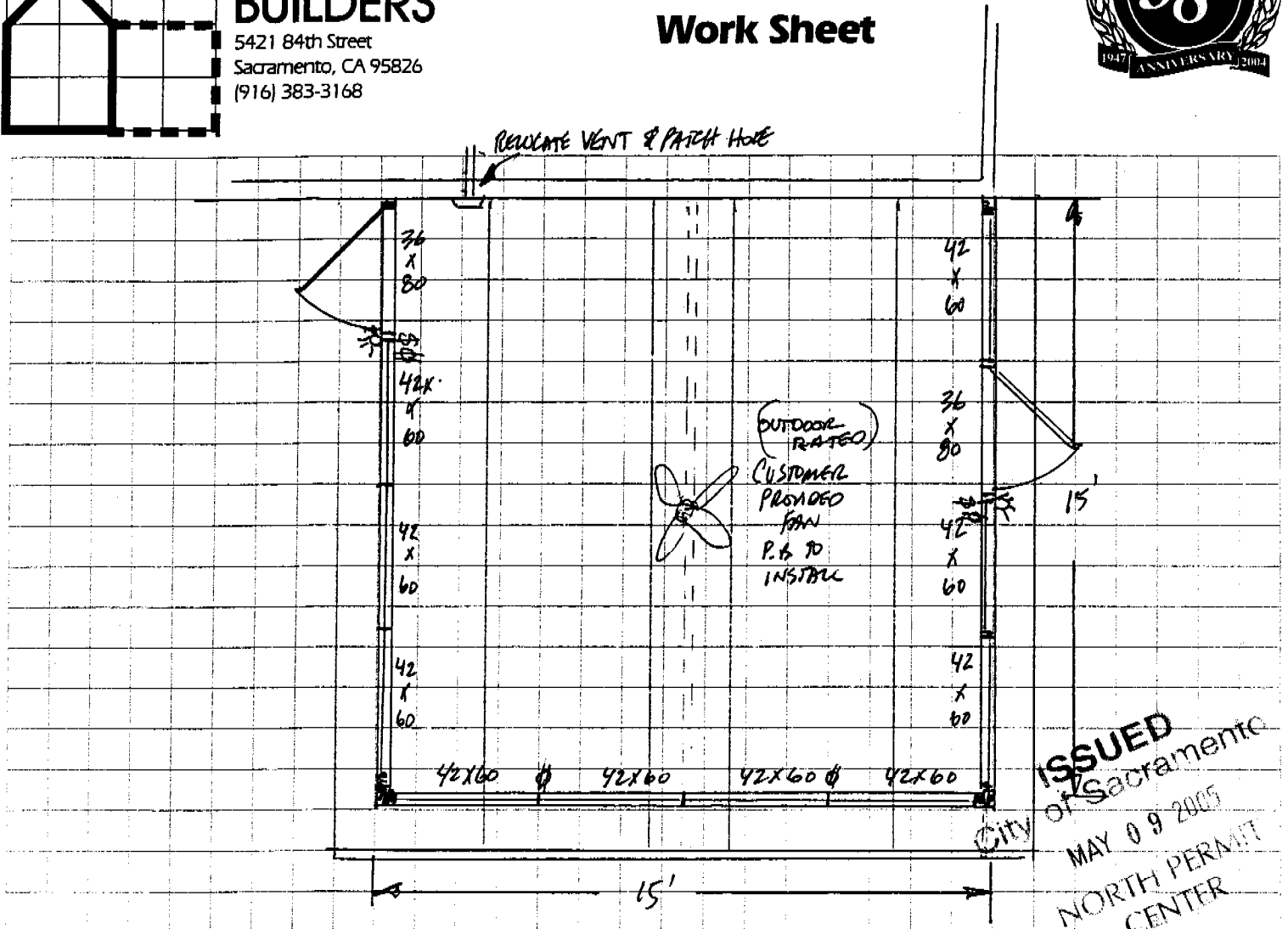

ISSUED
City of Sacramento
MAY 09 2005
NORTH PERMIT CENTER

- * 15 X 15 PATIO ENCLOSURE
- * 3" OMEGA WALL SYSTEM
- * COLOR IS ALMOND
- * STANDARD 60" SUNSHADE BOLTS/RODS
- * SOLID LAMINATES AND TRANSOMS
- * 1- 36 X 80 PEDISTAL/DOOR w/ SUNSHADE LOD
- * P.B. TO INSTALL CUSTOMER PROVIDED FAN
- * 4- 110V INTERIOR OUTLETS
- * 2- POTENTIALS AND SWITCHES
- * 17 X 16 ENCLOSURE ROOF
- * 4- 48" X 3" INSULATED ROOF PAGES X 16'
- * 1- 24" X 3" INSULATED FAN BEAM X 16'
- * 1- 3" T.B. WALL HANGER X 16'
- * 1- 3" SIDE FASCIA X 18'
- * 1- 3" SIDE FASCIA X 16'
- * 1- 3" MAB CUTTER X 17'
- * 1- 2 X 3 P.S. X 9'
- * COLOR IS ALMOND

Plans and specifications must be approved by the City of Sacramento and it is unlawful to make any alterations from the approved plans without the written permission from the City of Sacramento. This plan and specification are held to permit or approve the same in accordance with any City Ordinance or State Law.

Name: DAVIS
Address: 899 MAPLE GROVE WAY
City: SACRAMENTO, CA. 95834
Phone: _____

Diagram and Size approved by customer
THE APPROVAL OF ALL ELECTRICAL WORK IS SUBJECT TO FIELD INSPECTIONS.