

CITY OF SACRAMENTO
1231 I Street, Sacramento, CA 95814

Permit No: 0404942
Insp Area: 4
Thos Bros: 276J6

Site Address: 2921 MYOTIS DR SAC
Parcel No: 225-1950-043 PARKVIEW UNIT 5 LOT 43

Sub-Type: NSFR
Housing (Y/N): N

CONTRACTOR
KIMBALL HILL HOMES
10535 EAST STOCKTON BL. STE. K
ELK GROVE CA. 95624

OWNER

ARCHITECT

Nature of Work: MP 2212 2 STORY 9 ROOM SFR

CONSTRUCTION LENDING AGENCY: I hereby affirm under penalty of perjury that there is a construction lending agency for the performance of the work for which this permit is issued (Sec. 3097, Civ. C).

Lender's Name _____ Lender's Address _____

LICENSED CONTRACTORS DECLARATION: I hereby affirm under penalty of perjury that I am licensed under provisions of Chapter 9 (commencing with section 7000) of Division 3 of the Business and Professions Code and my license is in full force and effect.

License Class B License Number 701803 Date 4/8/04 Contractor Signature [Signature]

OWNER-BUILDER DECLARATION: I hereby affirm under penalty of perjury that I am exempt from the contractors License Law for the following reason (Sec. 7031.5, Business and Professions Code; any city or county which requires a permit to construct, alter, improve, demolish, or repair any structure, prior to its issuance, also requires the applicant for such permit to file a signed statement that he or she is licensed pursuant to the provisions of the Contractors License Law (Chapter 9 (commencing with Section 7000) of Division 8 of the Business and Professions Code) or that he or she is exempt therefrom and the basis for the alleged exemption. Any violation of Section 7031.5 by any applicant for a permit subjects the applicant to a civil penalty of not more than five hundred dollars (\$500.00);

_____, I, as a owner of the property, or my employees with wages as their sole compensation, will do the work, and the structure is not intended or offered for sale (Sec. 7044, Business and Professional Code: The Contractors License Law does not apply to an owner of property who builds or improves thereon, and who does such work himself or herself or through his/her own employees, provided that such improvements are not intended or offered for sale. If, however, the building or improvement is sold within one year of completion, the owner-builder will have the burden of proving that he/she did not build or improve for the purpose of sale.)

_____, I, as owner of the property, am exclusively contracting with licensed contractors to construct the project (Sec. 7044, Business and Professions Code: The Contractors License Law does not apply to an owner of property who builds or improves thereon, and who contracts for such projects with a contractor(s) licensed pursuant to the Contractors License Law).

I am exempt under Sec. _____ B & PC for this reason: _____
Date _____ Owner Signature _____

IN ISSUING THIS BUILDING PERMIT, the applicant represents, and the city relies on the representation of the applicant, that the applicant verified all measurements and locations shown on the application or accompanying drawings and that the improvement to be constructed does not violate any law or private agreement relating to permissible or prohibited locations for such improvements. This building permit does not authorize any illegal location of any improvement or the violation of any private agreement relating to location of improvements.

I certify that I have read this application and state that all information is correct. I agree to comply with all city and county ordinances and state laws relating to building construction and hereby authorize representative(s) of this city to enter upon the abovementioned property for inspection purposes.

Date 4/8/04 Applicant/Agent Signature [Signature]

WORKER'S COMPENSATION DECLARATION: I hereby affirm under penalty of perjury one of the following declarations:

_____, I have and will maintain a certificate of consent to self-insure for workers' compensation as provided for by Section 3700 of the Labor Code, for the performance of work for which the permit is issued.

[Signature] I have and will maintain workers' compensation insurance, as required by Section 3700 of the Labor Code, for the performance of the work for which this permit is issued. My workers' compensation insurance carrier and policy number are:

Carrier TRAVELERS Policy Number WC59663000527 Exp Date 10/01/2004

_____, (This section need not be completed if the permit is for \$100 or less) I certify that in the performance of the work for which this permit is issued, I shall not employ any person in any manner so as to become subject to the workers' compensation laws of California and agree that if I should become subject to the workers' compensation provisions of Section 3700 of the Labor Code, I shall forthwith comply with those provisions.

Date 4/8/04 Applicant Signature [Signature]

WARNING: FAILURE TO SECURE WORKER'S COMPENSATION COVERAGE IS UNLAWFUL AND SHALL SUBJECT AN EMPLOYER TO CRIMINAL PENALTIES AND CIVIL FINES UP TO ONE HUNDRED THOUSAND DOLLARS (\$100,000) IN ADDITION TO THE COST OF COMPENSATION, DAMAGES AS PROVIDED FOR IN SECTION 3706 OF THE LABOR CODE, INTEREST AND ATTORNEY'S FEE.

THIS PERMIT SHALL EXPIRE BY LIMITATION IF WORK IS NOT COMMENCED WITHIN 180 DAYS.

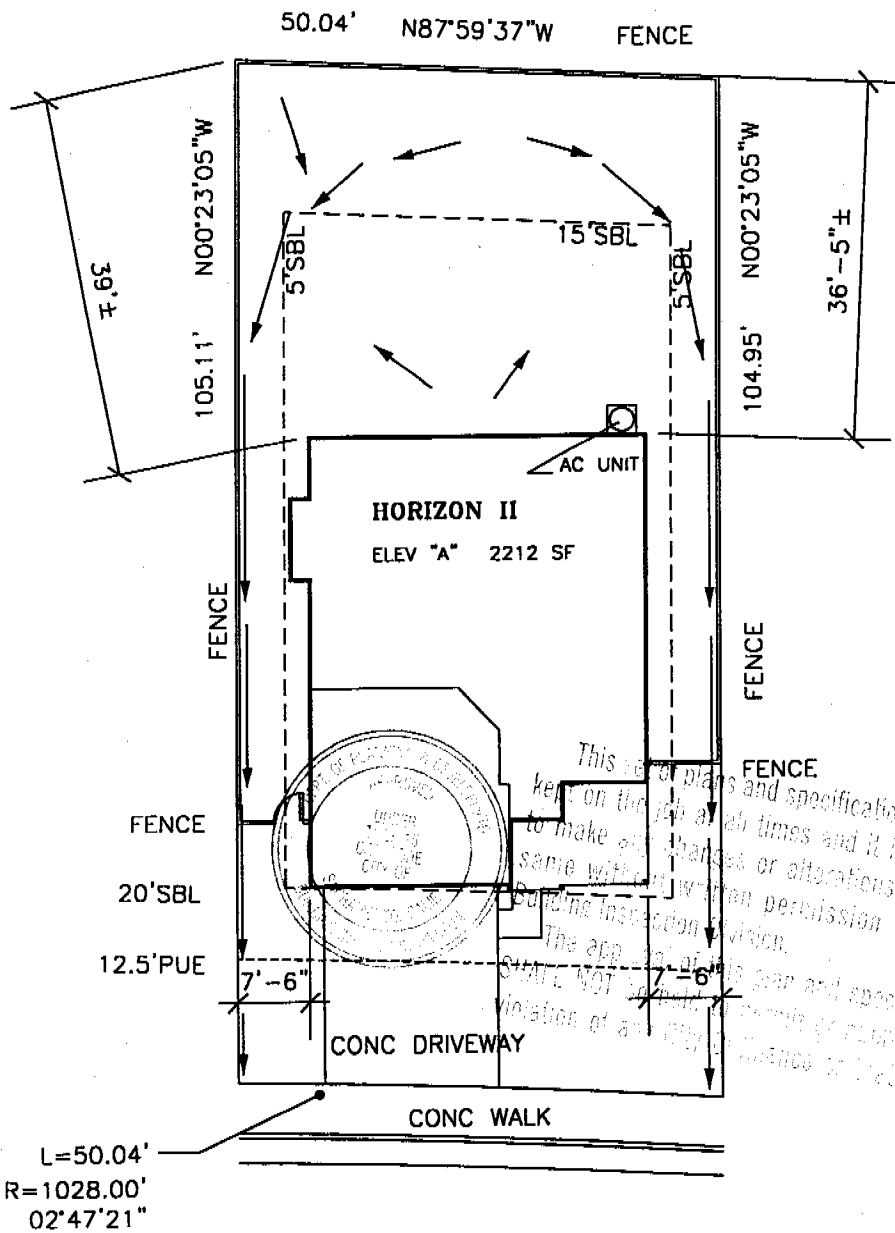

This set of plans and specifications must be kept on the job at all times and it is unlawful to make any changes or alterations from the same without written permission from the Building Inspection Division. The approval of this plan and specifications does not constitute a promise of payment for violation of any city ordinance.

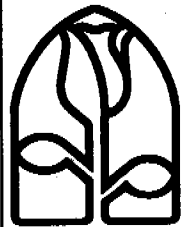

BLOOM
Architectural
Developments
Incorporated
 4437 Kenneth Avenue
 Fair Oaks, CA 95628
 (916)961-1553
 (916)967-3011 Fax

www.BloomArchitect.com

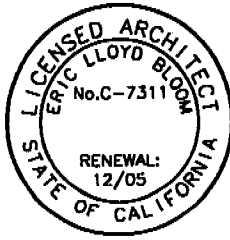

Plot Plan Disclosure This plot plan approximates a general representation of lot dimensions, easements, fence and home placement, etc. This illustration is not a condition of Kimball Hill Homes sales agreement. The actual placement and measurements demonstrated on this diagram are subject to change without notice.

Signature _____

KHH California, Inc. (916)714-1153
 10535 E. Stockton Blvd. Ste. K, Elk Grove, CA 95624



Job#	3075 43	Plan#	2212
Date	Mar 08 04	Draft	1
Plan	HORIZON2	Elev	A
Project	Parkview	Unit	5
Lot	43		
Address	2921 Myotis Drive		
City	Sacramento County CA		
APN	225-1950-043		



PLOT PLAN
 Scale 1"=20'



F. RODGERS INSULATION RESIDENTIAL, INC.

Thermal Insulation Contractors
Residential

INSULATION
CERTIFICATE

6957

7775 LAS POSITAS ROAD • LIVERMORE, CA 94550
(925) 294-9400 • FAX (925) 294-9475

1300 S. RIVER RD. #125 • W. SACRAMENTO, CA 95691
(916) 386-9400 • FAX (916) 386-9446

THIS IS TO CERTIFY THAT INSULATION HAS BEEN INSTALLED IN CONFORMANCE WITH CURRENT ENERGY REGULATION, CALIFORNIA ADMINISTRATIVE CODE, TITLE 24, STATE OF CALIFORNIA, IN THE BUILDING LOCATED AT:

K&H LOT # 43 TRACT # SIGNATURE
CITY SAC
STREET _____

EXTERIOR WALLS:
MANUFACTURER o/c THICKNESS/TYPE _____ R-VALUE 13

CEILINGS:
BATS: MANUFACTURER o/c THICKNESS/TYPE _____ R-VALUE 30

BLOWN IN: MANUFACTURER o/c THICKNESS/TYPE 1 3/4" R-VALUE 30

SQUARE FOOTAGE COVERED 1396 NUMBER OF BAGS USED 22

FLOORS & OVERHANGS:
MANUFACTURER o/c THICKNESS/TYPE _____ R-VALUE 13

OTHER: MANUFACTURER _____ THICKNESS/TYPE _____ R-VALUE _____

GENERAL CONTRACTOR _____
CALIFORNIA CONTRACTORS LICENSE # _____

DATE _____

SIGNATURE _____ TITLE _____

INSULATION CONTRACTOR F. RODGERS INSULATION RESIDENTIAL
CALIFORNIA CONTRACTORS LICENSE #771285

B. F. [Signature] DATE 8-19-04
SIGNATURE _____ TITLE _____

White - Customer Copy Yellow - Invoice Copy Pink - Field Copy Gold - Office Copy

INSTALLATION CARD

OMEGA DIAMOND WALL INSULATING ONE COAT SYSTEM
OMEGA PRODUCTS INTERNATIONAL, INC.

Job Address:

2921 MYOTTS DRIVE

ICBO Evaluation Service, Inc.
Report 4004

8/10/07
Date of Job Completion

Plastering Contractor:

Name: Mid Valley Plastering, Inc.

Address: 4807 S. Airport Way, Unit # 2
Stockton, CA 95206-4924

Telephone: (209) 234-2671

Approved Contractor Number as
Issued by the Coating Manufacturer

Omega Diamond Wall No. 2315

This is to certify that the exterior system on the building exterior at the above address has been installed in accordance with the evaluation report specified above and the manufacturer's instructions

Jeff Green
Signature of Plastering Contractor

8/10/07
Date

This installation card must be presented to the building inspector after completion of work and before final inspection



**F. RODGERS INSULATION
RESIDENTIAL, INC.**

Thermal Insulation Contractors
Residential

INSULATION
CERTIFICATE

0701

7775 LAS POSITAS ROAD • LIVERMORE, CA 94550
(925) 294-9400 • FAX (925) 294-9475

1300 S. RIVER RD. #125 • W. SACRAMENTO, CA 95691
(916) 386-9400 • FAX (916) 386-9446

THIS IS TO CERTIFY THAT INSULATION HAS BEEN INSTALLED IN CONFORMANCE WITH CURRENT ENERGY REGULATION, CALIFORNIA ADMINISTRATIVE CODE, TITLE 24, STATE OF CALIFORNIA, IN THE BUILDING LOCATED AT:

LOT # 40 TRACT # 54MTRP
STREET 4TH CITY SAC

EXTERIOR WALLS:

MANUFACTURER OK THICKNESS/TYPE _____ R-
VALUE 13

CEILING:

BATTS: MANUFACTURER OK THICKNESS/TYPE _____ R-
VALUE 30

BLOWN IN: MANUFACTURER OK MINIMUM THICKNESS/TYPE _____ R-
VALUE 30

MANUFACTURER _____ THICKNESS/TYPE _____ R-
VALUE _____

SQUARE FOOTAGE COVERED

446 NUMBER OF BAGS USED 23

FLOORS & OVERHANGS: MANUFACTURER _____ THICKNESS/TYPE _____ R-
VALUE _____

OTHER: MANUFACTURER _____ THICKNESS/TYPE _____ R-
VALUE _____

MANUFACTURER _____ THICKNESS/TYPE _____ R-
VALUE _____

GENERAL CONTRACTOR _____ DATE _____
CALIFORNIA CONTRACTORS LICENSE # _____

SIGNATURE _____ TITLE _____

INSULATION CONTRACTOR F. RODGERS INSULATION RESIDENTIAL
CALIFORNIA CONTRACTORS LICENSE #771285

DATE 8.5.04

SIGNATURE [Signature] TITLE _____

INSTALLATION CARD

OMEGA DIAMOND WALL SYSTEM ONE COAT SYSTEM
OMEGA PRODUCTS INTERNATIONAL, INC.

Job Address:

2939 Myotis Drive
Sacramento, Ca
95834

ICBO Evaluation Service, Inc.
Report 4004

8/19
Date of Job Completion

Plastering Contractor:

Name: Mid Valley Plastering, Inc.
Address: 4807 S. Airport Way, Unit # 3
Stockton, CA 95206-4974
Telephone: (209) 334-2677

Approved Contractor Number as
Issued by the Coating Manufacturer Omega Diamond Wall No. 2315

This is to certify that the exterior system on the building exterior at the above
address has been installed in accordance with the evaluation report specified above
and the manufacturer's instructions

[Signature]
Signature of Plastering Contractor

9/10
Date

This installation card must be presented to the building inspector after completion
of work and before final inspection