

CITY OF SACRAMENTO
1231 I Street, Sacramento, CA 95814

Permit No: 0101438
Insp Area: 4

Site Address: 6 STONEPINE CT SAC
Parcel No: 225-1430-034
N

NATOMAS CROSSING UNIT 22 LOT 34
Sub-Type: NSFR
Housing (Y/N):

CONTRACTOR
RYLAND HOMES
1380 LEAD HILL BLVD. STE 108
ROSEVILLE CA 95661

OWNER

ARCHITECT

Nature of Work: MP 2179 W/HOBBY OPT. 2 STORY 10 ROOM SFR

CONSTRUCTION LENDING AGENCY: I hereby affirm under penalty of perjury that there is a construction lending agency for the performance of the work for which this permit is issued (Sec. 3097, Civ. C).

Lender's Name _____ Lender's Address _____

LICENSED CONTRACTORS DECLARATION: I hereby affirm under penalty of perjury that I am licensed under provisions of Chapter 9 commencing with section 7000) of Division 3 of the Business and Professions Code and my license is in full force and effect.

License Class B License Number C-14118 Date 6-1-02 Contractor Signature [Signature]

OWNER-BUILDER DECLARATION: I hereby affirm under penalty of perjury that I am exempt from the contractors License Law for the following reason (Sec. 7031.5, Business and Professions Code: any city or county which requires a permit to construct, alter, improve, demolish, or repair any structure, prior to its issuance, also requires the applicant for such permit to file a signed statement that he or she is licensed pursuant to the provisions of the Contractors License Law (Chapter 9 (commencing with Section 7000) of Division 8 of the Business and Professions Code) or that he or she is exempt therefrom and the basis for the alleged exemption. Any violation of Section 7031.5 by any applicant for a permit subjects the applicant to a civil penalty of not more than five hundred dollars (\$500.00).

I, as a owner of the property, or my employees with wages as their sole compensation, will do the work, and the structure is not intended or offered for sale (Sec. 7044, Business and Professional Code: The Contractors License Law does not apply to an owner of property who builds or improves thereon, and who does such work himself or herself or through his/her own employees, provided that such improvements are not intended or offered for sale. If, however, the building or improvement is sold within one year of completion, the owner-builder will have the burden of proving that he/she did not build or improve for the purpose of sale.)

I, as owner of the property, am exclusively contracting with licensed contractors to construct the project (Sec. 7044, Business and Professions Code: The Contractors License Law does not apply to an owner of property who builds or improves thereon, and who contracts for such projects with a contractor(s) licensed pursuant to the Contractors License Law)

I am exempt under Sec. _____ B & PC for this reason: _____

Date [Signature] Owner Signature [Signature]

IN ISSUING THIS BUILDING PERMIT, the applicant represents, and the city relies on the representation of the applicant, that the applicant verified all measurements and locations shown on the application or accompanying drawings and that the improvement to be constructed does not violate any law or private agreement relating to permissible or prohibited locations for such improvements. This building permit does not authorize any illegal location of any improvement or the violation of any private agreement relating to location of improvements.

I certify that I have read this application and state that all information is correct. I agree to comply with all city and county ordinances and state laws relating to building construction and hereby authorize representative(s) of this city to enter upon the abovementioned property for inspection purposes.

Date _____ Applicant/Agent Signature [Signature]

WORKER'S COMPENSATION DECLARATION: I hereby affirm under penalty of perjury one of the following declarations:

I have and will maintain a certificate of consent to self-insure for workers' compensation as provided for by Section 3700 of the Labor Code, for the performance of work for which the permit is issued

I have and will maintain workers' compensation insurance, as required by Section 3700 of the Labor Code, for the performance of the work for which this permit is issued. My workers' compensation insurance carrier and policy number are:

Carrier Delta Policy Number 462032902 Exp Date 6-1-03

(This section need not be completed if the permit is for \$100 or less) I certify that in the performance of the work for which this permit is issued, I shall not employ any person in any manner so as to become subject to the workers' compensation laws of California and agree that if I should become subject to the workers' compensation provisions of Section 3700 of the Labor Code, I shall forthwith comply with those provisions.

Date 6-1-02 Applicant Signature [Signature]

WARNING: FAILURE TO SECURE WORKER'S COMPENSATION COVERAGE IS UNLAWFUL AND SHALL SUBJECT AN EMPLOYER TO CRIMINAL PENALTIES AND CIVIL FINES UP TO ONE HUNDRED THOUSAND DOLLARS (\$100,000) IN ADDITION TO THE COST OF COMPENSATION, DAMAGES AS PROVIDED FOR IN SECTION 3706 OF THE LABOR CODE, INTEREST AND ATTORNEY'S FEE.

THIS PERMIT SHALL EXPIRE BY LIMITATION IF WORK IS NOT COMMENCED WITHIN 180 DAYS.

Project Address: 6 STONE PINE CT
Lot Number: 34

Assessor Parcel # _____
Subdivision Natomas Crossing Unit#

0101438

OWNER INFORMATION

Legal Property Owner: Ryland Homes Phone# 784-1330 #14
Owner Address: 1380 Lead Hill Rd. City Roseville State CA Zip 95661

CONTRACTOR INFORMATION:

Contractor: Ryland Homes Lic. # 54648 Phone # 784-1330 #14 Fax 784-9805

PROJECT INFORMATION: Plan Three MP2339 w/Hobby Rm OR BDRMG 1LO TANDEM

Land Use Zone RIA Occupancy Group R3 Construction Type VN Fed Code 1A
No. of Stories: 2 No. of Rooms: 10 Street Width: 41'
1st Floor Area 1257 2nd Floor Area 1082 Basement _____ Roof Material Tile

AREA IN SQUARE FOOT OF:

Dwelling/Living 2339
Garage/Storage 581
Decks/Balconies _____
Carports _____

SCOPE OF WORK: SFD.

- Information Above Complete
- Violation Files Checked
- Standard Setbacks
- County Sewer
- AR Flood Waiver Required
- Flood Elevation Certificate Required
- Water Development Infill Area
- Planning Approval
- Design Review Approval
- Special Fee Districts Apply:

FOR OFFICE USE ONLY

-THE FOLLOWING MUST BE PROVIDED IN ORDER TO SUBMIT FOR PERMIT-

- 2 COMPLETE PLOT PLANS, LEGIBLE & DRAWN TO SCALE
- 11 X 17 COPY OF FLOOR PLAN WITH FOLLOWING INFORMATION
 - a) Assessor's Parcel Number
 - b) New Floor Area
 - c) Owners Name
 - d) Project Address

Date: _____ Received by: (staff) _____ Permit # _____

G1-27 T.R. PRINTING (702) 871-3018



WesPac

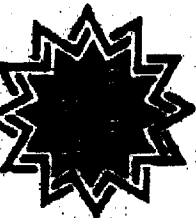

insulation

• MANSION Company

809 North Market Blvd., Ste. 11 • Sacramento, CA 95834
(916) 927-7149 • Fax (916) 927-4257
Lic. #487478

Installed Insulation Certificate

We certify that the building insulation listed herein is installed in conformance with current energy conservation regulations, California Administrative Code, Title 24, State of California.

R FACTOR	AREA	TYPE	INCHES/BAGS (BLOWN)
R38	CEILING	FIBERGLASS BLOWN	16" / 37 BAGS
R38	CEILING	FIBERGLASS BATT	13"
R19	EXTERIOR WALLS	FIBERGLASS BATT	5.5"

RYLAND HOMES

Certified by *Jimmy Kinney* HERITAGE MAIOMAS LOT 134

RYLAND HERITAGE/134
Address or Lot Number

Title Secretary

Date Installed 05/14/01

Phase #

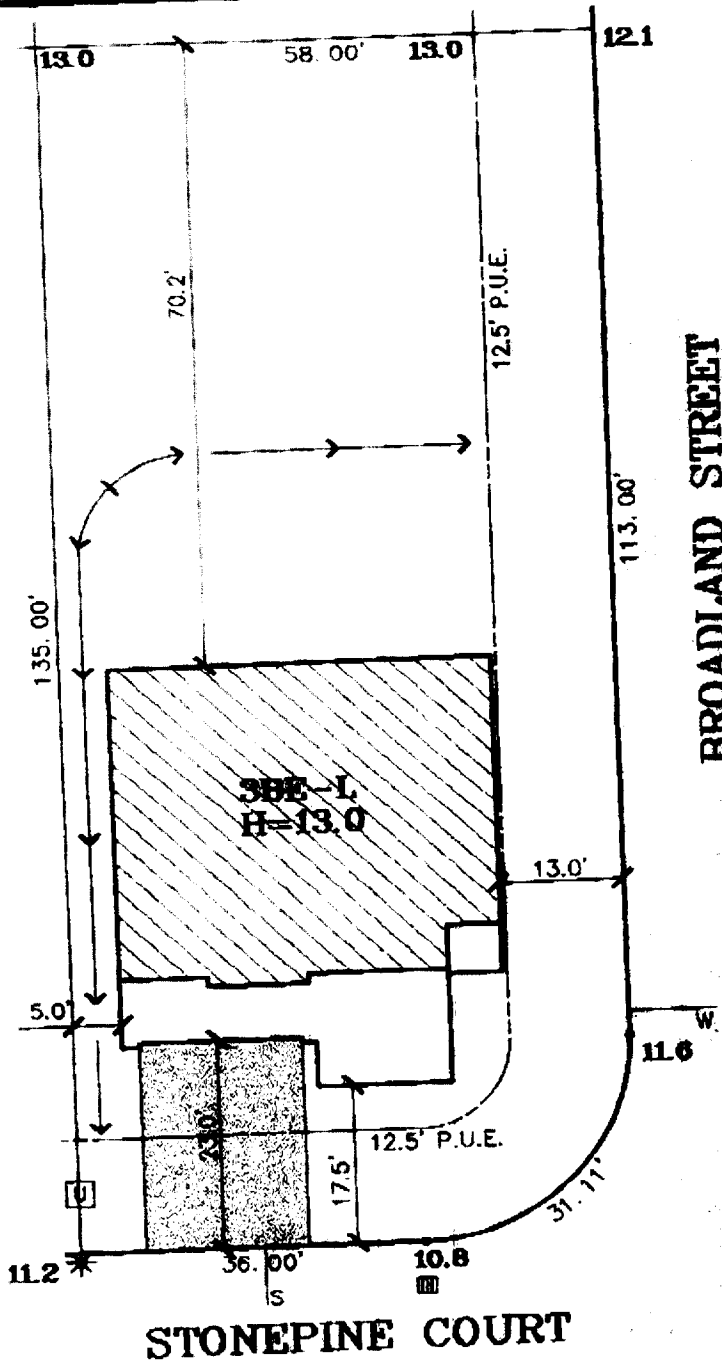

LEGEND

- PUBLIC UTILITY EASEMENT
- S SEWER SERVICE
- W WATER SERVICE
- UTILITY BOX
- * STREET LIGHT
- DRAIN INLET
- ◆ FIRE HYDRANT

DATE: 1-19-01
LOT AREA: 7,726 SF
LOT COVERAGE: 18%

THIS PLAN IS PREPARED TO SHOW THE DIMENSIONAL RELATIONSHIP FROM BUILDING FOUNDATION TO PROPERTY LINE, DESIGN DRAINAGE CONTROL ELEVATIONS, AND DIRECTION OF DRAINAGE FLOW TO CONFORM WITH LOCAL ORDINANCES FOR THE PURPOSE OF BUILDING PERMIT ISSUANCE. INFORMATION SHOWN IS APPROXIMATE EXCEPT FOR THOSE SETBACKS WHICH ARE MINIMUMS REQUIRED BY ORDINANCE. THIS PLAN DOES NOT REFLECT AS BUILT CONDITIONS WHICH WILL LIKELY VARY FROM THIS PLAN.

The Splink Corporation
 2590 VENTURE OAKS WAY
 SACRAMENTO, CA 95833
 PH:(916)925-5550 FAX:(916)921-9274

NATOMAS CROSSING
VILLAGE 22
6 STONEPINE CT.
A.P.N.:
LOT 34
PLAN 3B-E

RYLAND HERITAGE
 CITY OF SACRAMENTO, CA.
 CLIENT: RYLAND HOMES
 CONTACT: LINDA STEINFELDT
 PHONE: 916-784-1330
 JOB NO.: 7684-003