

CITY OF SACRAMENTO
1231 I Street, Sacramento, CA 95814

Permit No: 9913406
Insp Area: 4

Site Address: 2697 PICKERING WY SAC
Parcel No: 274-0540-032 LOT 32-3 HERITAGE PL 1

Sub-Type: NSFR
Housing (Y/N): N

CONTRACTOR
EPICK INC.
1263 THE ESPLANADE
CHICO CA 95926

OWNER

ARCHITECT

Nature of Work: NSFR MP1710 6 ROOMS

CONSTRUCTION LENDING AGENCY: I hereby affirm under penalty of perjury that there is a construction lending agency for the performance of the work for which this permit is issued (Sec. 3097, Civ. C).

Lender's Name 1st Bank Lender's Address 1825 Douglas Blvd Roseville 95661

LICENSED CONTRACTORS DECLARATION: I hereby affirm under penalty of perjury that I am licensed under provisions of Chapter 9 (commencing with section 7000) of Division 3 of the Business and Professions Code and my license is in full force and effect.

License Class B License Number 463708 Date 8/16/00 Contractor Signature [Signature]

OWNER-BUILDER DECLARATION: I hereby affirm under penalty of perjury that I am exempt from the contractors License Law for the following reason (Sec. 7031.5, Business and Professions Code; any city or county which requires a permit to construct, alter, improve, demolish, or repair any structure, prior to its issuance, also requires the applicant for such permit to file a signed statement that he or she is licensed pursuant to the provisions of the Contractors License Law (Chapter 9 (commencing with Section 7000) of Division 8 of the Business and Professions Code) or that he or she is exempt therefrom and the basis for the alleged exemption. Any violation of Section 7031.5 by any applicant for a permit subjects the applicant to a civil penalty of not more than five hundred dollars (\$500.00);

I, as a owner of the property, or my employees with wages as their sole compensation, will do the work, and the structure is not intended or offered for sale (Sec. 7044, Business and Professional Code: The Contractors License Law does not apply to an owner of property who builds or improves thereon, and who does such work himself or herself or through his/her own employees, provided that such improvements are not intended or offered for sale. If, however, the building or improvement is sold within one year of completion, the owner-builder will have the burden of proving that he/she did not build or improve for the purpose of sale.)

I, as owner of the property, am exclusively contracting with licensed contractors to construct thereon (Sec. 7044, Business and Professions Code: The Contractors License Law does not apply to an owner of property who builds or improves thereon, and who contracts for such projects with a contractor(s) licensed pursuant to the Contractors License Law).

FAIL
CITY OF SACRAMENTO
AUG 18 2000
NEIGHBORHOODS, PLANNING
AND DEVELOPMENT SERVICES

I am exempt under Sec. _____ B & PC for this reason: _____
Date _____ Owner Signature _____

IN ISSUING THIS BUILDING PERMIT, the applicant represents, and the city relies on the representation of the applicant, that the applicant verified all measurements and locations shown on the application or accompanying drawings and that the improvement to be constructed does not violate any law or private agreement relating to permissible or prohibited locations for such improvements. This building permit does not authorize any illegal location of any improvement or the violation of any private agreement relating to location of improvements.

I certify that I have read this application and state that all information is correct. I agree to comply with all city and county ordinances and state laws relating to building construction and hereby authorize representative(s) of this city to enter upon the above mentioned property for inspection purposes.

Date 8/16/00 Applicant/Agent Signature [Signature]

WORKER'S COMPENSATION DECLARATION: I hereby affirm under penalty of perjury one of the following declarations:

I have and will maintain a certificate of consent to self-insure for workers' compensation as provided for by Section 3700 of the Labor Code, for the performance of work for which the permit is issued.

I have and will maintain workers' compensation insurance, as required by Section 3700 of the Labor Code, for the performance of the work for which this permit is issued. My workers' compensation insurance carrier and policy number are:

Carrier STATE FUND Policy Number 144281298 Exp Date 10/01/1999

(This section need not be completed if the permit is for \$100 or less) I certify that in the performance of the work for which this permit is issued, I shall not employ any person in any manner so as to become subject to the workers' compensation laws of California and agree that if I should become subject to the workers' compensation provisions of Section 3700 of the Labor Code, I shall forthwith comply with those provisions.

Date 8/16/00 Applicant Signature [Signature]

WARNING: FAILURE TO SECURE WORKER'S COMPENSATION COVERAGE IS UNLAWFUL AND SHALL SUBJECT AN EMPLOYER TO CRIMINAL PENALTIES AND CIVIL FINES UP TO ONE HUNDRED THOUSAND DOLLARS (\$100,000) IN ADDITION TO THE COST OF COMPENSATION. DAMAGES AS PROVIDED FOR IN SECTION 3706 OF THE LABOR CODE, INTEREST AND ATTORNEY'S FEE.

THIS PERMIT SHALL EXPIRE BY LIMITATION IF WORK IS NOT COMMENCED WITHIN 180 DAYS.



INSULATION CONTRACTORS ASSOCIATION OF AMERICA

INSULATION CERTIFICATE
62346

1321 DUKE STREET, SUITE 303 • ALEXANDRIA, VA 22314 • (703) 739-0356

THIS IS TO CERTIFY THAT INSULATION HAS BEEN INSTALLED IN CONFORMANCE WITH CURRENT ENERGY REGULATIONS, CALIFORNIA ADMINISTRATIVE CODE, TITLE 24, STATE OF CALIFORNIA, IN THE BUILDING LOCATED AT:

7 PICKER WOODS INC LOT # 32-3 TRACT #
STREET 2697 Pickering Wy CITY SACRAMENTO

EXTERIOR WALLS:
MANUFACTURER _____ THICKNESS/TYPE _____ R-VALUE _____

CEILINGS:
BATTES:
MANUFACTURER _____ THICKNESS/TYPE _____ R-VALUE _____
BLOWN IN: MINIMUM _____ R-VALUE 38
MANUFACTURER _____ THICKNESS 15" _____

SQUARE FOOTAGE COVERED 10410 NUMBER OF BAGS USED 33

FLOORS:
MANUFACTURER _____ THICKNESS/TYPE _____ R-VALUE _____
SLAB ON GRADE:
MANUFACTURER _____ THICKNESS/TYPE _____ R-VALUE _____

WIDTH OF INSULATION _____ INCHES
FOUNDATION WALLS:
MANUFACTURER _____ THICKNESS/TYPE _____ R-VALUE _____

GENERAL CONTRACTOR _____
CALIFORNIA CONTRACTORS LICENSE # _____ DATE _____

SIGNATURE TITLE

INSULATION CONTRACTOR **ARCADE INSULATION**
CALIFORNIA CONTRACTORS LICENSE #263784
DATE 4-12-01

J. [Signature] SIGNATURE *R. [Signature]* TITLE

RESIDENTIAL BUILDING PERMIT APPLICATION

New Construction
 Addition
 Remodels
 Other

Project Address: 2697 Picketing Way
lot 32-3

Assessor Parcel # 274-0540-032

OWNER INFORMATION:

Legal Property Owner: Epick Homes #1 LLC Phone # (530) 891-4757
 Owner Address: 1263 The Esplanade* C City Chico State Calif Zip 95926

CONTRACTOR INFORMATION:

Contractor: Epick Inc. Lic. # 463708 Phone # (530) 891-4757 Fax # (530) 891-4206

PROJECT INFORMATION:

Land Use Zone RIA Occupancy Group R3 Construction Type VN Fed Code 1A
 No. of stories: 1 No. of rooms: 6 Street width: _____
 1st Floor Area 1710 2nd Floor Area - Basement - Roof Material conc. tile

AREA IN SQUARE FOOT OF:

	<u>EXISTING</u>	<u>NEW</u>
Dwelling/Living	_____	<u>1710</u>
Garage/Storage	_____	<u>557 (397) opt.</u>
Decks/Balconies	_____	_____
Carports	_____	_____

SCOPE OF WORK:

S.F.D.
M.P. 1710 (+ 160' off opt.)

FOR OFFICE USE ONLY:

- | | | |
|---|---|--|
| <input type="checkbox"/> Information above complete | <input type="checkbox"/> AR Flood Waiver required | <input type="checkbox"/> Planning Approval |
| <input type="checkbox"/> Violation files checked | <input type="checkbox"/> Flood Elevation Certificate Required | <input type="checkbox"/> Design Review Approval |
| <input type="checkbox"/> Standard setbacks | <input type="checkbox"/> Water Development Infill Area | <input type="checkbox"/> Special Fee Districts Apply : _____ |
| <input type="checkbox"/> County Sewer | | |

NEW STRUCTURES & ADDITIONS

❖ THE FOLLOWING MUST BE PROVIDED IN ORDER TO SUBMIT FOR PLAN REVIEW

- | | |
|---|---|
| <input type="checkbox"/> 2 COMPLETE PLANS, LEGIBLE & DRAWN TO SCALE | ❖ Plans to include: site plan, floor plan, elevations, roof/ceiling plan, foundation and structural framing details, and structural calculations for non-conforming structures. |
| <input type="checkbox"/> 3 SETS IF PROJECT IS IN A DESIGN REVIEW AREA | |
| <input type="checkbox"/> Title 24 Energy Compliance documentation | <input type="checkbox"/> 11" x 17" copy of floor plan for County Assessor |
| <input type="checkbox"/> Grading and Erosion Control Questionnaire | <input type="checkbox"/> Plan Review Fees |

Date: _____

Received by: (staff) _____

residentialapp [rev 3/09/99]

ACTIVITY/PERMIT #

[Stamp]

NOV 15 1999

Building Inspection Division

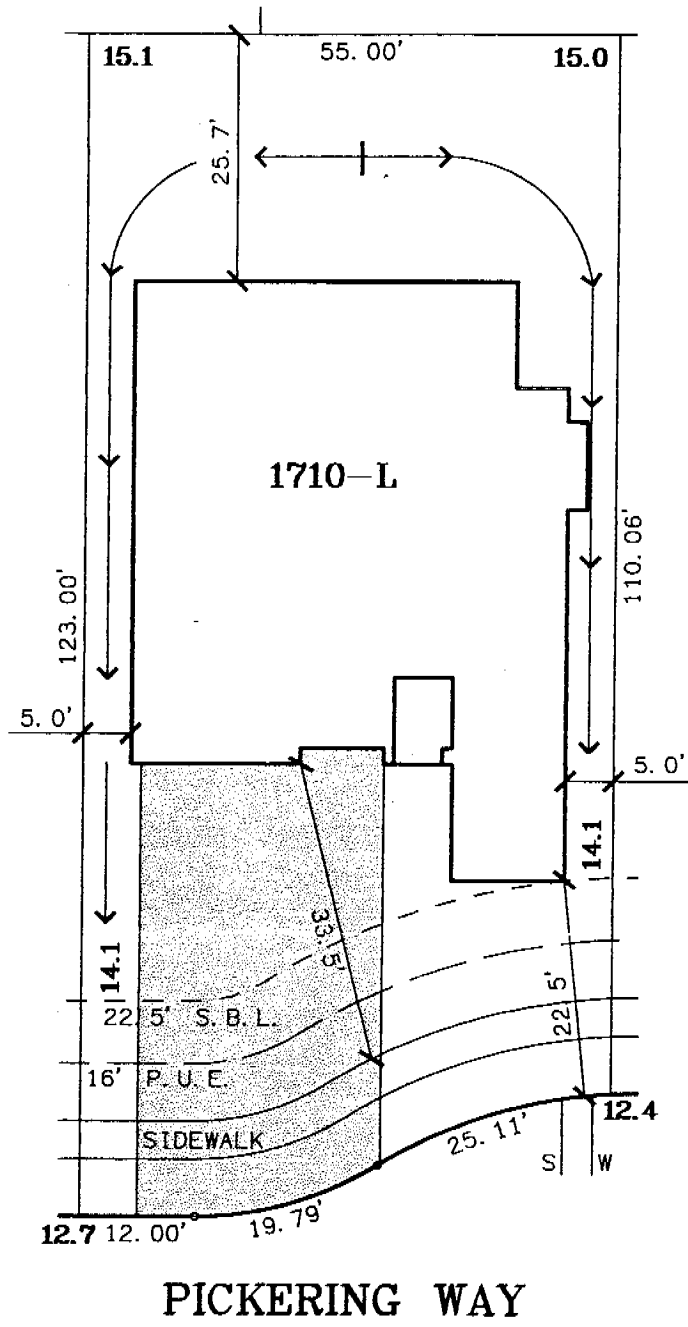

I, _____
 State Engineer
 State of California
 do hereby certify that the above is a true and correct copy of the original as filed in my office.
 Witness my hand and the seal of the State Engineer's Office at Sacramento, California, this _____ day of _____, 20____.

SCALE: 1" = 20'

LOT AREA: 6,484 SQ.FT.

DRAWN: 11-15-99

A. P. N. :

ADDRESS : 2697 PICKERING WAY

APPROVED BY _____

The Spink Corporation
 2590 VENTURE OAKS WAY
 SACRAMENTO, CA. 95833
 PH:(916)925-5550 FAX:(916)921-9274

HERITAGE PLACE
 UNIT NO. 3
 LOT 32-3
 PLAN 1710

RIVERSGATE
 CITY OF SACRAMENTO, CA.
 CLIENT: EPICK HOMES #1, L.L.C.
 JOB NO.: 2808-004