

CITY OF SACRAMENTO  
1231 I Street, Sacramento, CA 95814

Permit No: 0400808

Insp Area: 4

Thos Bros:

Sub-Type: NSFR

Site Address: 140 BOMBAY CR SAC

Parcel No: 201-0790-106

NORTHPOINTE PARK30 LOT 80 Housing (Y/N): N

CONTRACTOR  
LENNAR RENAISSANCE INC  
2240 DOUGLAS BL  
ROSEVILLE, CA 95661

OWNER

ARCHITECT

Nature of Work: MP423(1958) 1 STORY 9 ROOM SFR

**CONSTRUCTION LENDING AGENCY :** I hereby affirm under penalty of perjury that there is a construction lending agency for the performance of the work for which this permit is issued (Sec. 3097, Civ. C).

Lender's Name \_\_\_\_\_ Lender's Address \_\_\_\_\_

**LICENSED CONTRACTORS DECLARATION:** I hereby affirm under penalty of perjury that I am licensed under provisions of Chapter 9 (commencing with section 7000) of Division 3 of the Business and Professions Code and my license is in full force and effect.

License Class B License Number 732348 Date \_\_\_\_\_ Contractor Signature [Signature]

**OWNER-BUILDER DECLARATION:** I hereby affirm under penalty of perjury that I am exempt from the contractors License Law for the following reason (Sec. 7031.5, Business and Professions Code; any city or county which requires a permit to construct, alter, improve, demolish, or repair any structure, prior to its issuance, also requires the applicant for such permit to file a signed statement that he or she is licensed pursuant to the provisions of the Contractors License Law (Chapter 9 (commencing with Section 7000) of Division 8 of the Business and Professions Code) or that he or she is exempt therefrom and the basis for the alleged exemption. Any violation of Section 7031.5 by any applicant for a permit subjects the applicant to a civil penalty of not more than five hundred dollars (\$500.00);

\_\_\_\_ I, as a owner of the property, or my employees with wages as their sole compensation, will do the work, and the structure is not intended or offered for sale (Sec. 7044, Business and Professional Code: The Contractors License Law does not apply to an owner of property who builds or improves thereon, and who does such work himself or herself or through his/her own employees, provided that such improvements are not intended or offered for sale. If, however, the building or improvement is sold within one year of completion, the owner-builder will have the burden of proving that he/she did not build or improve for the purpose of sale.)

\_\_\_\_ I, as owner of the property, am exclusively contracting with licensed contractors to construct the project (Sec. 7044, Business and Professions Code: The Contractors License Law does not apply to an owner of property who builds or improves thereon, and who contracts for such projects with a contractor(s) licensed pursuant to the Contractors License Law).

**PAID**  
**CITY OF SACRAMENTO**

\_\_\_\_ I am exempt under Sec. \_\_\_\_\_ B & PC for this reason: \_\_\_\_\_  
Date \_\_\_\_\_ Owner Signature \_\_\_\_\_

**JAN 30 2004**  
**NORTH PERMIT**

**IN ISSUING THIS BUILDING PERMIT,** the applicant represents, and the city relies on the representation of the applicant, that the applicant verified all measurements and locations shown on the application or accompanying drawings and that the improvement to be constructed does not violate any law or private agreement relating to permissible or prohibited locations for such improvements. This building permit does not authorize any illegal location of any improvement or the violation of any private agreement relating to location of improvements.

I certify that I have read this application and state that all information is correct. I agree to comply with all city and county ordinances and state laws relating to building construction and hereby authorize representative(s) of this city to enter upon the abovementioned property for inspection purposes.

Date 1-30-04 Applicant/Agent Signature [Signature]

**WORKER'S COMPENSATION DECLARATION:** I hereby affirm under penalty of perjury one of the following declarations:  
\_\_\_\_ I have and will maintain a certificate of consent to self-insure for workers' compensation as provided for by Section 3700 of the Labor Code, for the performance of work for which the permit is issued.

X I have and will maintain workers' compensation insurance, as required by Section 3700 of the Labor Code, for the performance of the work for which this permit is issued. My workers' compensation insurance carrier and policy number are:

Carrier OLD REPUBLIC INS. CO. Policy Number MWC10845400 Exp Date 11/01/2004

\_\_\_\_ (This section need not be completed if the permit is for \$100 or less) I certify that in the performance of the work for which this permit is issued, I shall not employ any person in any manner so as to become subject to the workers' compensation laws of California and agree that if I should become subject to the workers' compensation provisions of Section 3700 of the Labor Code, I shall forthwith comply with those provisions.

Date 1-30-04 Applicant Signature [Signature]

**WARNING:** FAILURE TO SECURE WORKER'S COMPENSATION COVERAGE IS UNLAWFUL AND SHALL SUBJECT AN EMPLOYER TO CRIMINAL PENALTIES AND CIVIL FINES UP TO ONE HUNDRED THOUSAND DOLLARS (\$100,000) IN ADDITION TO THE COST OF COMPENSATION, DAMAGES AS PROVIDED FOR IN SECTION 3706 OF THE LABOR CODE, INTEREST AND ATTORNEY'S FEE.

**THIS PERMIT SHALL EXPIRE BY LIMITATION IF WORK IS NOT COMMENCED WITHIN 180 DAYS.**

# plot plan

THIS PLOT PLAN IS FOR THE PURPOSE OF SHOWING THE HOUSE TO BE CONSTRUCTED ON THE LOT AND MAY NOT REPRESENT THE FINAL AS-BUILT CONFIGURATION OF THE PROPERTY OR IMPROVEMENTS THEREON. THE ACCURACY OF THIS PLOT PLAN IS NOT GUARANTEED, NOR IS IT A PART OF ANY POLICY, REPORT OR GUARANTEE TO WHICH IT MAY BE ATTACHED. ACTUAL DIMENSIONS, OTHER THAN MINIMUM ORDINANCE, MAY VARY OR CHANGE WITHOUT PRIOR NOTICE, DUE TO ACTUAL SITE CONDITIONS.

MP 423(1958)

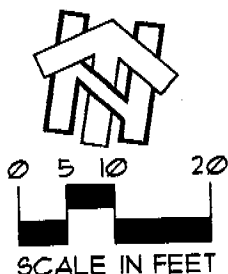

11.40'

50.91'

79  
PAD=12.9

80  
6048± SQ. FT.

81  
PAD=13.6

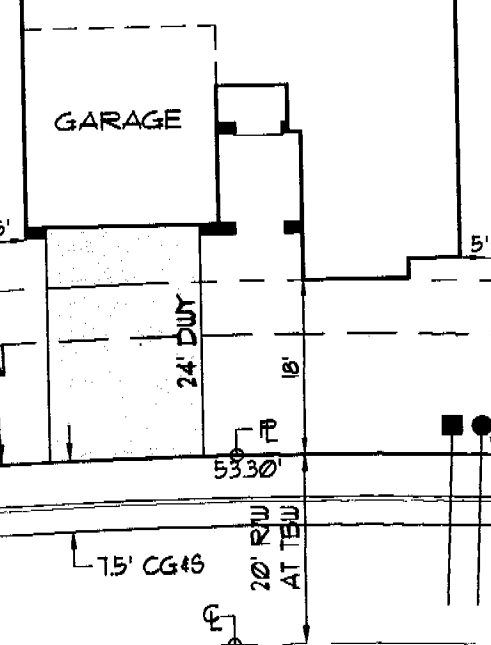
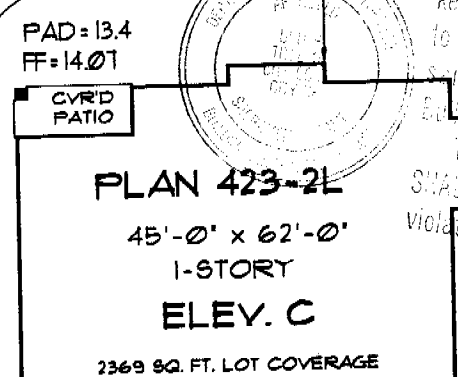
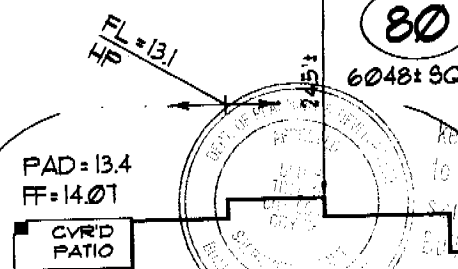

BOMBAY CIRCLE

This set of plans and specifications must be read on the lot at all times and it is unlawful to make any changes or alterations from the same without written permission from the Engineering Division.  
Violation of any part of this plan and specification shall be cause for revocation of the permit.

### lot coverage

LOT AREA: 6048± #  
BUILDING: 2369 #  
BLDG./ LOT AREA: 39 %

### retaining wall

HEIGHT: \_\_\_\_\_  
LENGTH: \_\_\_\_\_  
DISTANCE FROM P.L.: \_\_\_\_\_

### symbols legend

- DRAIN INLET:
- ELECTRIC SERVICE BOX:
- FIRE HYDRANT:
- FLOW LINE ELV./ HIGH POINT: FL=23.4 HP
- SIGN:
- PAD-MOUNT TRANSFORMER:
- SEWER SVC.:
- STREET LIGHT:
- TOP-BACK OF SIDEWALK ELEV.: 123.4 TBW
- SWALE (FLOW DIRECTION):
- WATER SVC.:
- EXTENTS OF 2ND STORY LEVEL:



Winncrest Homes

GOSSAMER SPRINGS

A REGENCY PARK COMMUNITY

home site #80

140 Bombay Circle

NORTHPOINTE PARK VILLAGE 30  
CITY OF SACRAMENTO, CALIFORNIA

a.p.n.: 201-0790-106

### general notes

- 1) DIMENSIONS ALONG CURVED LINES ARE ARC LENGTHS, U.O.N.
- 2) SETBACK DIMENSIONS ARE ROUNDED DOWN TO NEAREST HALF UNIT, U.O.N.
- 3) MAXIMUM ALLOWABLE LOT COVERAGE IS 45 PERCENT FOR 1-STORY HOMES AND 40 PERCENT FOR 2-STORY HOMES.
- 4) FOOTPRINT AREA CALCULATION (#) DOES NOT INCLUDE FRONT PORCH AREA.

4.2	BCB	12/22/03	20:1
phase	drawn by	issue	scale

# ENGEL INSULATION, INC.

CALIFORNIA CONTRACTOR'S LICENSE #745646

460 Roseville Road • Roseville, CA 95678

(916) 786-2088 / (916) 786-2064

THIS IS TO CERTIFY THAT INSULATION HAS BEEN INSTALLED IN CONFORMANCE WITH CURRENT ENERGY REGULATIONS, CALIFORNIA ADMINISTRATIVE CODE, TITLE 24, STATE OF CALIFORNIA, IN THE BUILDING LOCATED AT:

TRACT Gossamer Springs LOT 60 / 11th 443  
STREET \_\_\_\_\_ CITY Sacramento

EXTERIOR WALLS:  
MANUFACTURER CT THICKNESS 3 1/2 R-VALUE 13

CEILING AREA: BATTS  
MANUFACTURER CT THICKNESS 1 1/2 R-VALUE 3 1/2

CEILINGS: BLOWN IN  
MANUFACTURER Insul-Safe THICKNESS 14 1/2 R-VALUE 3 1/2  
SQUARE FOOTAGE 1024 NUMBER OF BAGS USED 37

FLOOR AREA:  
MANUFACTURER \_\_\_\_\_ THICKNESS \_\_\_\_\_ R-VALUE \_\_\_\_\_

EXTERIOR KNEEWALL:  
MANUFACTURER CT THICKNESS 6 1/2 R-VALUE 17

INTERIOR KNEEWALL:  
MANUFACTURER CT THICKNESS 3 1/2 R-VALUE 13

APPLIED CAULK & SEALANT TO ALL EXTERIOR OPENINGS & PENETRATIONS

YES  NO \_\_\_\_\_

GENERAL CONTRACTOR \_\_\_\_\_  
CALIFORNIA CONTRACTORS LICENSE # \_\_\_\_\_ DATE \_\_\_\_\_

SIGNATURE \_\_\_\_\_ TITLE \_\_\_\_\_  
Tommy Barton 6/3/04  
INSULATION CONT. SIGNATURE \_\_\_\_\_ TITLE \_\_\_\_\_ DATE \_\_\_\_\_

# INSTALLATION CERTIFICATE

Permit Number \_\_\_\_\_

Site Address \_\_\_\_\_

An installation certificate is required to be posted at the building site or made available for all appropriate inspections. (The information provided on this form is required; however, use of this form to provide the information is optional.) After completion of final inspection, a copy must be provided to the building department (upon request) and the building owner at occupancy, per Section 10-103(b).

### HVAC SYSTEMS:

#### Heating Equipment

Equip. Type (pkg. heat pump)	CBC Certified Mfr Name and Model Number	# of Identical Systems	Efficiency (AFUE, etc.) <sup>1</sup> (>CF-1R value)	Duct Location (attic, etc.)	Duct or Piping R-value	Heating Load (Btu/hr)	Heating Capacity (Btu/hr)
Furnace	Bryant 310JAV036070	1	.80	Attic	4.2	20824	51000

#### Cooling Equipment

Equip. Type (pkg. heat pump)	CBC Certified Compressor Unit Mfr Name and Model Number	# of Identical Systems	Efficiency (SEER, etc.) <sup>1</sup> (>CF-1R value)	Duct Location (attic, etc.)	Duct R-value	Cooling Load (Btu/hr)	Cooling Capacity (Btu/hr)
Split AC	Bryant 537A030	1	14.0	Attic	4.2	24504	29800

1.  $\geq$  reads greater than or equal to.  
I, the undersigned, verify that equipment listed above is: 1) the actual equipment installed, 2) equivalent to or more efficient than that specified in the certificate of compliance (Form CF-1R) submitted for compliance with the *Energy Efficiency Standards* for residential buildings, and 3) equipment that meets or exceeds the appropriate requirements for manufactured devices (from the *Appliance Efficiency Regulations* or Part 6), where applicable.

Robert Paul 4-30-03  
Signature, Date

Deal Sheet Metal Inc.  
Installing Subcontractor (Co. Name)  
OR General Contractor (Co. Name) OR Owner

### WATER HEATING SYSTEMS:

Heater Type	CBC Certified Mfr Name & Model Number	Distribution Type (Std. Point-of-Use)	If Recirculation Control Type	# of Identical Systems	Rated <sup>1</sup> Input (kW or Btu/hr)	Tank Volume (gallons)	Efficiency <sup>2</sup> (EF, RE)	Standby <sup>2</sup> Loss (%)	External Insulation R-value <sup>3</sup>

2. For small gas storage (rated input of less than or equal to 75,000 Btu/hr), electric resistance and heat pump water heaters, list Energy Factor.  
For large gas storage water heaters (rated input of greater than 75,000 Btu/hr), list Recovery Efficiency, Standby Loss and Rated Input.  
For instantaneous gas water heaters, list Recovery Efficiency and Rated Input.  
3. R-12 external insulation is mandatory for storage water heaters with an energy factor of less than 0.58.

#### Faucets & Shower Heads:

All faucets and showerheads installed are certified to the Commission; pursuant to Title 24, Part 6, Section 111.

I, the undersigned, verify that equipment listed above my signature is: 1) the actual equipment installed; 2) equivalent to or more efficient than that specified in the certificate of compliance (Form CF-1R) submitted for compliance with the *Energy Efficiency Standards* for residential buildings; and 3) equipment that meets or exceeds the appropriate requirements for manufactured devices (from the *Appliance Efficiency Regulations* or Part 6), where applicable.

\_\_\_\_\_  
Signature, Date

\_\_\_\_\_  
Installing Subcontractor (Co. Name) OR  
General Contractor (Co. Name) OR Owner

COPY TO: Building Department  
HERS Provider (if applicable)  
Building Owner at Occupancy

# INSTALLATION CERTIFICATE

## CF-6R

Site Address

Permit Number

An installation certificate is required to be posted at the building site or made available for all appropriate inspections. (This form is required; however, use of this form to provide the information is optional.) After completion of final inspection, a copy must be provided to the building department (upon request) and the building owner at \$3(b).

### HVAC SYSTEMS:

#### Heating Equipment

Equip. Type (pkgs. installed)	CEC Certified Unit Model

Name	# of Identical Systems	Efficiency (AFUE, etc.) (CEC-IR value)	Plant Location ( attic, etc.)	Dist or Piping Remarks	Heating Load (Btu/hr)	Heating Capacity (Btu/hr)

#### Cooling Equipment

Equip. Type (pkgs. installed)	CEC Certified Unit Model

Name	# of Identical Systems	Efficiency (SEER, etc.) (CEC-IR value)	Plant Location ( attic, etc.)	Dist or Piping Remarks	Cooling Load (Btu/hr)	Cooling Capacity (Btu/hr)

1. If rated greater than 1, the undersigned, we or efficient than that specified in Energy Efficiency Standards for manufactured devices

equal to that equipment listed above is: 1) the actual equipment installed, 2) equivalent to or more in the certificate of compliance (Form CP-1R) submitted for compliance with the Energy Efficiency Standards for residential buildings, and 3) equipment that meets or exceeds the appropriate requirements for in the Appliance Efficiency Regulations or Part 6, where applicable.

Signature, Date

Installing Subcontractor (Co. Name)  
OR General Contractor (Co. Name) OR Owner

### WATER HEATING

EMS

Equip. Type	CEC Certified Name & Model

Distribution Type (Hot, Recirculating)	If Recirculation Control Type	# of Identical Systems	Rated Input (kW or Btu/hr)	Tank Volume (gallons)	Efficiency (EF, EFC)	Standby Loss (%)	External Insulation R-value
			40,000				
			40,000				

2. For small gas storage (rated 1 or large gas storage water for instantaneous gas water heaters, the standby efficiency and rated input is 1. 8-12 gallon limitation is

1. If less than or equal to 75,000 Btu/hr, electric condenser and heat pump water heaters, hot energy water heaters (rated input of greater than 75,000 Btu/hr), hot energy efficiency, standby loss and rated input are: the standby efficiency and rated input is 1. For storage water heaters with an energy factor of less than 0.58.

Faucets & Shower Heats  
All faucets and showers

installed are certified to the Commission, pursuant to Title 24, Part 6, Section 111. that equipment listed above my signature is: 1) the actual equipment installed; 2) equivalent to 1 specified in the certificate of compliance (Form CP-1R) submitted for compliance with the code for residential buildings, and 3) equipment that meets or exceeds the appropriate requirements for manufactured devices (from the Appliance Efficiency Regulations or Part 6), where applicable.

I, the undersigned, we or more efficient than Energy Efficiency Standards for manufactured devices  
  
Signature, Date

WILMOR & SONS PLUMBING  
Installing Subcontractor (Co. Name) OR  
General Contractor (Co. Name) OR Owner

COPY TO: Building Dept  
HERS Pro Building O

mark (if applicable) at Occupancy

**OMEGA PRODUCTS INTERNATIONAL, INC.**  
**DIAMOND WALL INSULATING STUCCO SYSTEM**

ICBO Report # 4004

Job Address:

WINNCREST HO: ES-GOSSAMER SPRINGS

Date of Job Completion: June 23, 2004

Lot Number: 80

**PLASTERING CONTRACTOR:**

Name: STUCCO WORKS, INC.

Address: 5900 WAREHOUSE WAY - SACRAMENTO, CALIFORNIA 95826

Telephone No: 916) 383-6667

Contractor Number of Diamond Wall System: 2175

This is to certify that the exterior coating system on the building exterior at the above address has been installed in accordance with the evaluation report specified above and the manufacturer's inspections.

July 15, 2004

Date

  
Signature of authorized representative of Plastering Contractor

This installation card must be presented to the building inspector after completion of work and before final inspection.