

CITY OF SACRAMENTO

1231 I Street, Sacramento, CA 95814

Permit No: 9904070

Insp Area: 4

Site Address: 3601 POPPY HILL WY SAC

Parcel No: 225-1160-023

GATEWAY WEST LOT 96

Sub-Type: NSFR

Housing (Y/N): N

CONTRACTOR

BEAZER HOMES
3009 DOUGLAS BL #150
ROSEVILLE CA 95661

OWNER

ARCHITECT

BLOODGOOD SHARP BUSTER
2356 GOLD MEADOW WY #201
GOLD RIVER CA 95670

Nature of Work: NEW HOME, MP1441, 7 ROOMS

CONSTRUCTION LENDING AGENCY : I hereby affirm under penalty of perjury that there is a construction lending agency for the performance of the work for which this permit is issued (Sec. 3097, Civ. C).

Lender's Name _____ Lender's Address _____

LICENSED CONTRACTORS DECLARATION: I hereby affirm under penalty of perjury that I am licensed under provisions of Chapter 9 (commencing with section 7000) of Division 3 of the Business and Professions Code and my license is in full force and effect.

License Class B License Number 124191 Date 4/29/99 Contractor Signature Sheng Van Maen

OWNER-BUILDER DECLARATION: I hereby affirm under penalty of perjury that I am exempt from the contractors License Law for the following reason (Sec. 7031.5, Business and Professions Code; any city or county which requires a permit to construct, alter, improve, demolish, or repair any structure, prior to its issuance, also requires the applicant for such permit to file a signed statement that he or she is licensed pursuant to the provisions of the Contractors License Law (Chapter 9 (commencing with Section 7000) of Division 8 of the Business and Professions Code) or that he or she is exempt therefrom and the basis for the alleged exemption. Any violation of Section 7031.5 by any applicant for a permit subjects the applicant to a civil penalty of not more than five hundred dollars (\$500.00):

I, as a owner of the property, or my employees with wages as their sole compensation, will do the work, and the structure is not intended or offered for sale (Sec. 7044, Business and Professional Code: The Contractors License Law does not apply to an owner of property who builds or improves thereon, and who does such work himself or herself or through his/her own employees, provided that such improvements are not intended or offered for sale. If, however, the building or improvement is sold within one year of completion, the owner-builder will have the burden of proving that he/she did not build or improve for the purpose of sale.)

____ I, as owner of the property, am exclusively contracting with licensed contractors to construct the project (Sec. 7044, Business and Professions Code: The Contractors License Law does not apply to an owner of property who builds or improves thereon, and who contracts for such projects with a contractor(s) licensed pursuant to the Contractors License Law).

____ I am exempt under Sec. _____ B & PC for this reason: _____

Date _____ Owner Signature _____

IN ISSUING THIS BUILDING PERMIT, the applicant represents, and the city relies on the representation of the applicant, that the applicant verified all measurements and locations shown on the application or accompanying drawings and that the improvement to be constructed does not violate any law or private agreement relating to permissible or prohibited locations for such improvements. This building permit does not authorize any illegal location of any improvement or the violation of any private agreement relating to location of improvements.

I certify that I have read this application and state that all information is correct. I agree to comply with all city and county ordinances and state laws relating to building construction and hereby authorize representative(s) of this city to enter upon the abovementioned property for inspection purposes.

Date 4/29/99 Applicant/Agent Signature Sheng Van Maen

WORKER'S COMPENSATION DECLARATION: I hereby affirm under penalty of perjury one of the following declarations:

____ I have and will maintain a certificate of consent to self-insure for workers' compensation as provided for by Section 3700 of the Labor Code, for the performance of work for which the permit is issued.

I have and will maintain workers' compensation insurance, as required by Section 3700 of the Labor Code, for the performance of the work for which this permit is issued. My workers' compensation insurance carrier and policy number are:

Carrier _____ Policy Number 1000000000 Exp Date 4/99

____ (This section need not be completed if the permit is for \$100 or less) I certify that in the performance of the work for which this permit is issued, I shall not employ any person in any manner so as to become subject to the workers' compensation laws of California and agree that if I should become subject to the workers' compensation provisions of Section 3700 of the Labor Code, I shall forthwith comply with those provisions.

Date 4/29/99 Applicant Signature Sheng Van Maen

WARNING: FAILURE TO SECURE WORKER'S COMPENSATION COVERAGE IS UNLAWFUL AND SHALL SUBJECT AN EMPLOYER TO CRIMINAL PENALTIES AND CIVIL FINES UP TO ONE HUNDRED THOUSAND DOLLARS (\$100,000) IN ADDITION TO THE COST OF COMPENSATION, DAMAGES AS PROVIDED FOR IN SECTION 3706 OF THE LABOR CODE, INTEREST AND ATTORNEY'S FEE.

THIS PERMIT SHALL EXPIRE BY LIMITATION IF WORK IS NOT COMMENCED WITHIN 180 DAYS.

Natomas Unified School District

1515 Sports Drive, #1 • Sacramento, CA 95834-1905
 Phone 916/641-3300 • Fax 916/928-1629

CERTIFICATION OF COMPLIANCE
SCHOOL DISTRICT DEVELOPMENT FEES

Property Owner's Name Beazer Homes	
Owner's Address	3009 Douglas Blvd., Ste. 150., Roseville, CA. 95661
Project Address	3001 Poppy Hill Way
Parcel Number	225-1160-023
Subdivision Name	Gateway West Village 1 Lot 96
Number of Units	1
Print Applicant's Name	Sheryl Van Maren
Title of Applicant	Starts Coordinator
Date	4/23/99
Applicant's Signature	<i>Sheryl Van Maren</i>
Telephone Number	773-3888
BUILDING DEPARTMENT	
Plan Identification Number	1441
Building Type (Check One)	<input checked="" type="checkbox"/> Residential <input type="checkbox"/> Apartment/Condominium <input type="checkbox"/> Commercial/Industrial
Square Feet of Chargeable Building Area	1441
Signature	<i>[Signature]</i>
Title	Date 4-23-99
UNIFIED SCHOOL DISTRICT	
District Certification Number	99-282
Fees Collected:	
Residential:	1441 Sq. Ft. X \$ 4.57 = \$ 6585.37
Apartment/Condominium:	Sq. Ft. X \$ = \$
Commercial/Industrial:	Sq. Ft. X \$ = \$
NOTICE TO APPLICANT: Pursuant to government code section 66020 (d), this will serve to notify you that the 90-day approval period in which you may protest the fees, or other payment identified above, will begin to run on the date in which the building or installation permit for this project is issued, or on which they are paid to the District, or to another public entity authorized to collect them on behalf of the District, whichever is earlier.	
Applicant Signature:	<i>Sheryl Van Maren</i> Date: 4/23/99

This certification covers only the amount of square footage indicated above. Any additions or corrections to the square footage for this project will require an amendment to the Certificate of Compliance.

As the authorize Natomas Unified School District official, I hereby certify that the requirements of Government Code Section 95995 have been complied with by the above signed applicant.

SIGNATURE: *Peggy Thompson* DATE: 4/23/99
 TITLE: *Director Facilities*

COUNTY SANITATION DISTRICT NO. 1
SACRAMENTO REGIONAL COUNTY SANITATION DISTRICT

SEWER IMPACT FEE
PERMIT AND CALCULATION SHEET

APPLICATION NO: <u>CITY</u>		BLDG PERMIT NO:	
GENERAL INFORMATION		THIS PERMIT GOOD ONLY WHEN VALIDATED BY THE CASHIER 251245 4/23/99 - DEPT 26 \$2,414.00 - TR 387826 04/23/99 - RECEIPT 693349 C91 \$2,414.00 THIS PERMIT TO CONNECT EXPIRES ONE YEAR FROM DATE OF ISSUANCE	
FEE CALCULATION		BUILDING USE	
INSPECTION		RESIDENTIAL SF <input checked="" type="checkbox"/>	MF <input type="checkbox"/>
CSD-1	79.00	COMMERCIAL USE	UNITS
SRCSD	2,385.00		
CONSTRUCTION			
IN-LIEU			
TOTAL FEE	2,414.00		
APN: <u>225-1160-023</u>			
DESCRIPTION/ SUBDIVISION <u>Gateway West Village 1</u>		LOT: <u>96</u>	
PROPERTY ADDRESS <u>3601 Poppy Hill Way</u>			
OWNER <u>Beazer Homes</u>			
MAILING ADDRESS <u>3009 Douglas Blvd. Suite 150</u>			
CITY-STATE-ZIP <u>Roseville, CA 95661</u>		PHONE <u>773-3888</u>	
ADDITIONAL FEES MAY BE DUE IF CHANGES IN USE INCREASE SEWER IMPACT.			
APPLICANT SIGNATURE <u>Sheng VanHaren</u>			
CONSOLIDATED UTILITY BILLING USE ONLY			
ACCT _____	INPUT _____	START _____	
SEE REVERSE SIDE	INSPECTOR'S COPY		

THIS PLAN IS PREPARED TO SHOW THE DIMENSIONAL RELATIONSHIP FROM BUILDING FOUNDATION TO PROPERTY LINE, DESIGN DRAINAGE CONTROL ELEVATIONS, AND DIRECTION OF DRAINAGE FLOW TO CONFORM WITH LOCAL ORDINANCES FOR THE PURPOSE OF BUILDING PERMIT ISSUANCE. INFORMATION SHOWN IS APPROXIMATE EXCEPT FOR THOSE SETBACKS WHICH ARE MINIMUMS REQUIRED BY ORDINANCE. THIS PLOT DOES NOT REFLECT AS BUILT CONDITIONS WHICH WILL LIKELY VARY FROM THIS PLAN.

CHATEAU MONTELENA WAY

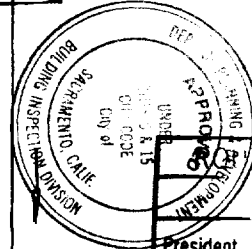
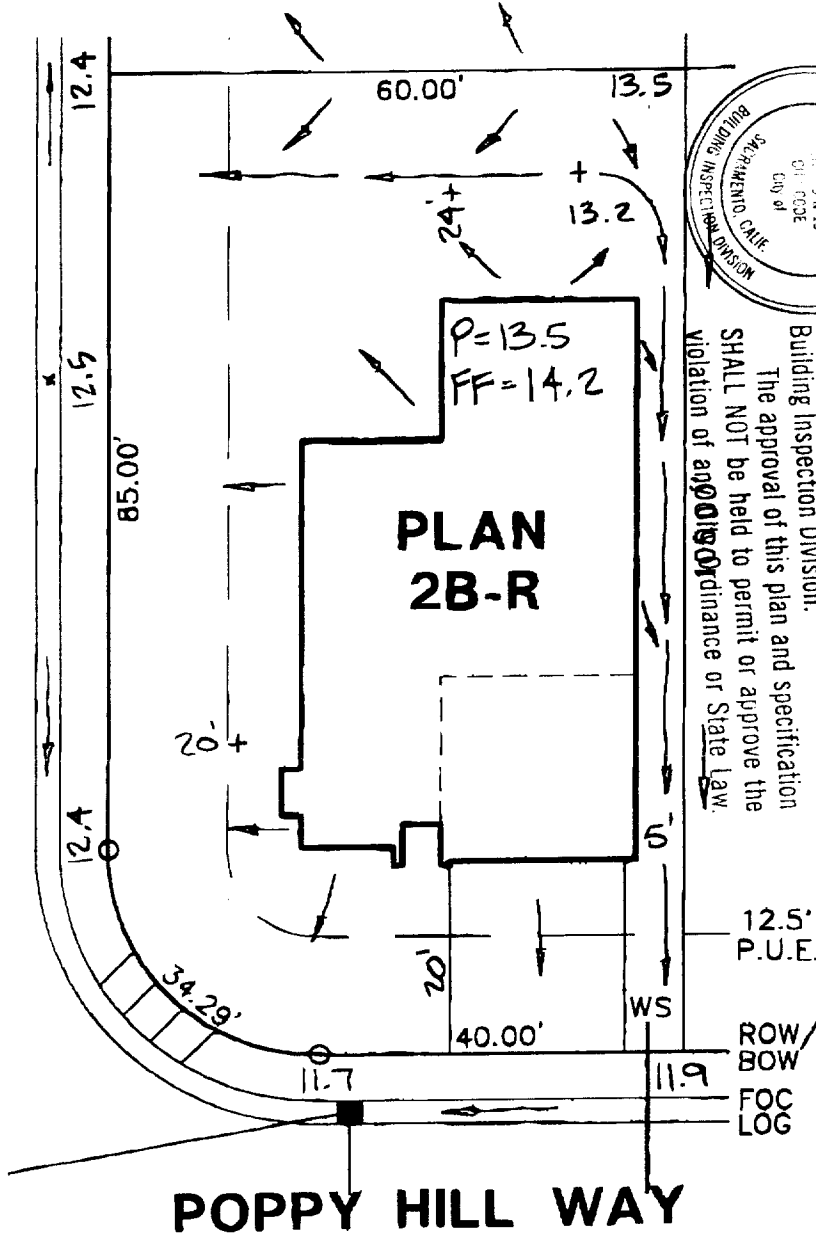

The approval of this plan and specification SHALL NOT be held to permit or approve the violation of any ordinance or State Law.

Building Inspection Division.

This set of plans and specifications is the property of Wood-Rodgers, Inc. and it is unlawful to reproduce or alter them without the written permission from the company.

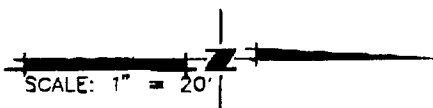

PLOT PLAN
LOT 96
GATEWAY WEST-VILLAGE NO. 1
FOR
BEAZER HOMES
SACRAMENTO CALIFORNIA

WOOD-RODGERS INC.

DATE: APR. 1999	DRAWN: LCS	CHECKED: JWH 4-20-99	PROJECT NO: 98BEZ-009
--------------------	---------------	----------------------------	--------------------------

LOT COVERAGE = 30%
3601 POPPY HILL WAY