

CITY OF SACRAMENTO

Permit No: 0011530

1231 I Street, Sacramento, CA 95814

Insp Area: 4

Site Address: 1930 NORTH BEND DR SAC

Sub-Type: NSFR

Parcel No: 225-1370-085

NORTHPT PK 8 LOT 65

Housing (Y/N): N

CONTRACTOR

OWNER

ARCHITECT

MOURIER JOHN CONSTRUCTION INC.
1830 VERNON ST
SUITE 9 95687

Nature of Work: MP 1850 1 STORY 8 ROOM SFR

CONSTRUCTION LENDING AGENCY : I hereby affirm under penalty of perjury that there is a construction lending agency for the performance of the work for which this permit is issued (Sec. 3097, Civ. C).

Lender's Name Lender's Address

LICENSED CONTRACTORS DECLARATION: I hereby affirm under penalty of perjury that I am licensed under provisions of Chapter 9 (commencing with section 7000) of Division 3 of the Business and Professions Code and my license is in full force and effect.

License Class B License Number 613004 Date 10/3/00 Contractor Signature M. Collins

OWNER-BUILDER DECLARATION: I hereby affirm under penalty of perjury that I am exempt from the contractors License Law for the following reason (Sec. 7031.5, Business and Professions Code; any city or county which requires a permit to construct, alter, improve, demolish, or repair any structure, prior to its issuance, also requires the applicant for such permit to file a signed statement that he or she is licensed pursuant to the provisions of the Contractors License Law (Chapter 9 (commencing with Section 7000) of Division 8 of the Business and Professions Code) or that he or she is exempt therefrom and the basis for the alleged exemption. Any violation of Section 7031.5 by any applicant for a permit subjects the applicant to a civil penalty of not more than five hundred dollars (\$500.00);

I, as a owner of the property, or my employees with wages as their sole compensation, will do the work, and the structure is not intended or offered for sale (Sec. 7044, Business and Professional Code: The Contractors License Law does not apply to an owner of property who builds or improves thereon, and who does such work himself or herself or through his/her own employees, provided that such improvements are not intended or offered for sale. If, however, the building or improvement is sold within one year of completion, the owner-builder will have the burden of proving that he/she did not build or improve for the purpose of sale.)

I, as owner of the property, am exclusively contracting with licensed contractors to construct the project (Sec. 7044, Business and Professions Code: The Contractors License Law does not apply to an owner of property who builds or improves thereon, and who contracts for such projects with a contractor(s) licensed pursuant to the Contractors License Law).

I am exempt under Sec. B & PC for this reason:

Date Owner Signature

IN ISSUING THIS BUILDING PERMIT, the applicant represents, and the city relies on the representation of the applicant, that the applicant verified all measurements and locations shown on the application or accompanying drawings and that the improvement to be constructed does not violate any law or private agreement relating to permissible or prohibited locations for such improvements. This building permit does not authorize any illegal location of any improvement or the violation of any private agreement relating to location of improvements.

I certify that I have read this application and state that all information is correct. I agree to comply with all city and county ordinances and state laws relating to building construction and hereby authorize representative(s) of this city to enter upon the abovementioned property for inspection purposes.

Date 10/3/00 Applicant/Agent Signature M. Collins

WORKER'S COMPENSATION DECLARATION: I hereby affirm under penalty of perjury one of the following declarations:

I have and will maintain a certificate of consent to self-insure for workers' compensation as provided for by Section 3700 of the Labor Code, for the performance of work for which the permit is issued.

I have and will maintain workers' compensation insurance, as required by Section 3700 of the Labor Code, for the performance of the work for which this permit is issued. My workers' compensation insurance carrier and policy number are:

Carrier FINANCIAL PACIFIC INS. CO. Policy Number 920137C Exp Date 10/1/2000

(This section need not be completed if the permit is for \$100 or less) I certify that in the performance of the work for which this permit is issued, I shall not employ any person in any manner so as to be exempt subject to the workers' compensation laws of California and agree that if I should become subject to the workers' compensation provisions of Section 3700 of the Labor Code, I shall forthwith comply with those provisions.

Date 10/3/00 Applicant Signature M. Collins

WARNING: FAILURE TO SECURE WORKER'S COMPENSATION COVERAGE IS UNLAWFUL AND SHALL SUBJECT AN EMPLOYER TO CRIMINAL PENALTIES AND CIVIL FINES UP TO ONE HUNDRED THOUSAND DOLLARS (\$100,000) IN ADDITION TO THE COST OF COMPENSATION, DAMAGES AS PROVIDED FOR IN SECTION 3706 OF THE LABOR CODE, INTEREST AND ATTORNEY'S FEE.

THIS PERMIT SHALL EXPIRE BY LIMITATION IF WORK IS NOT COMMENCED WITHIN 180 DAYS.

RESIDENTIAL BUILDING PERMIT APPLICATION

- New Construction
- Addition
- Remodels
- Other

Project Address: 1930 North Bend Drive Assessor Parcel # 225-1370-085

OWNER INFORMATION: Lot #65

Legal Property Owner: John Mourier Construction Phone # (916) 969-2842
 Owner Address: 1830 VERNON STREET #9 City Roseville State Ca. Zip 95678

CONTRACTOR INFORMATION: Northgate Park Unit #8 Village #1 B

Contractor: J.M.C. Lic. # 613004 Phone # 969-2842 Fax# 782-8903

PROJECT INFORMATION:

Land Use Zone R14 Occupancy Group R3 Construction Type VN Fed Code 14

No. of stories: 1 No. of rooms: 8 Street width: _____

1st Floor Area 1850 2nd Floor Area / Basement _____ Roof Material _____

AREA IN SQUARE FOOT OF:	EXISTING	NEW
Dwelling/Living	_____	<u>1850</u>
Garage/Storage	_____	<u>385</u>
Decks/Balconies	_____	<u>75</u>
Carports	_____	_____

SCOPE OF WORK: _____

FOR OFFICE USE ONLY

- Information above complete
- Violation files checked
- Standard setbacks
- County Sewer
- AR Flood Waiver required
- Flood Elevation Certificate Required
- Water Development Infill Area
- Planning Approval
- Design Review Approval
- Special Fee Districts Apply : _____

NEW STRUCTURES & ADDITIONS

◆ THE FOLLOWING MUST BE PROVIDED IN ORDER TO SUBMIT FOR PLAN REVIEW

- 2 COMPLETE PLANS, LEGIBLE & DRAWN TO SCALE
 - 3 SETS IF PROJECT IS IN A DESIGN REVIEW AREA
 - Title 24 Energy Compliance documentation
 - Grading and Erosion Control Questionnaire
 - 11" x 17" copy of floor plan for County Assessor
 - Plan Review Fees
- ◆ Plans to include: site plan, floor plan, elevations, roof/ceiling plan, foundation and structural framing details, and structural calculations for non-conforming structures.

Date: _____ Received by: (staff) _____

ACTIVITY/PERMIT # _____



**INSULATION CONTRACTORS
ASSOCIATION
OF AMERICA**

**INSULATION
CERTIFICATE**

62582

1321 DUKE STREET, SUITE 303 • ALEXANDRIA, VA 22314 • (703) 739-0356

THIS IS TO CERTIFY THAT INSULATION HAS BEEN INSTALLED IN CONFORMANCE WITH CURRENT ENERGY REGULATIONS, CALIFORNIA ADMINISTRATIVE CODE, TITLE 24, STATE OF CALIFORNIA, IN THE BUILDING LOCATED AT:

McMillan LOT # *65* TRACT # *Waldemars*

STREET _____ CITY *Sackville*

EXTERIOR WALLS

MANUFACTURER *1/E* THICKNESS/TYPE *3 5/8" R* VALUE *13*

CEILINGS

BATTS *1/E* THICKNESS TYPE *1 1/2"* R VALUE *3.8*

BLOWN IN MANUFACTURER *1/E* THICKNESS *1 1/2"* R VALUE *3.8*

SOFTENED INSULATION OVER REF *1/E* NUMBER OF BAGS USED *100* R VALUE *10*

FLOORING *1/E* THICKNESS/TYPE *1 1/2"* R VALUE *3.8*

SHADING DEVICES *1/E* NUMBER OF BAGS USED *100* R VALUE *10*

GLAZING *1/E* THICKNESS/TYPE *1 1/2"* R VALUE *3.8*

MANUFACTURER _____ THICKNESS/TYPE _____ R VALUE _____

GENERAL CONTRACTOR _____ TITLE _____

INSULATION CONTRACTOR _____ TITLE _____

ARCADIE INSULATION

CALIFORNIA CONTRACTORS LICENSE #263784

4/98 DATE

SIGNATURE

DATE

Natomas Unified School District

15 Sports Drive, #1 • Sacramento, CA 95834-1905
Phone 916/641-3300 • Fax 916/928-1629

CERTIFICATION OF COMPLIANCE

SCHOOL DISTRICT DEVELOPMENT FEES

PART I: TO BE COMPLETED BY APPLICANT

Property Owner's Name	J.M.C. Homes	(916) 989-2842
Owner's Address	1830 Veron street, Suite #9; Roseville, Ca. 95678	
Project Address	1930 North Bend Drive	
Parcel Number	225-1370-085	Lot 65
Subdivision Name	Northpointe Park unit #8 Village #1-B	
Number of Units	1	
Print Applicant's Name	Deanna Collins	Applicant's Signature <i>D Collins</i>
Title of Applicant	Operations	
Date	9/29/2000	Telephone Number 991-1200

PART II: TO BE COMPLETED BY BUILDING DEPARTMENT

Plan Identification Number	1850
Building Type (Check One)	<input checked="" type="checkbox"/> Residential <input type="checkbox"/> Apartment/Condominium <input type="checkbox"/> Commercial/Industrial
Square Feet of Chargeable Building Area	1850
Signature	<i>[Signature]</i>
Title	PTDg Insp
Date	10/7/00

PART III: TO BE COMPLETED BY NATOMAS UNIFIED SCHOOL DISTRICT

District Certification Number	01-591
Fees Collected:	
Residential:	1850 Sq. Ft. X \$ 3.25 = \$ 6,012.50
Apartment/Condominium:	Sq. Ft. X \$ = \$
Commercial/Industrial:	Sq. Ft. X \$ = \$

NOTICE TO APPLICANT: Pursuant to government code section 66020 (d), this will serve to notify you that the 90-day approval period in which you may protest the fees, or other payment identified above, will begin to run on the date in which the building or installation permit for this project is issued, or on which they are paid to the District, or to another public entity authorized to collect them on behalf of the District, whichever is earlier.

Applicant Signature: *D Collins* **Date:** **9/29/00**

This certification covers only the amount of square footage indicated above. Any additions or corrections to the square footage for this project will require an amendment to the Certificate of Compliance.

As the authorize Natomas Unified School District official, I hereby certify that the requirements of Government Code Section 95995 have been complied with by the above signed applicant.

SIGNATURE: *Maida Brogan* **DATE:** **10/2/00**
TITLE: *Acct Tech*

NORTHPOINTE 8-1

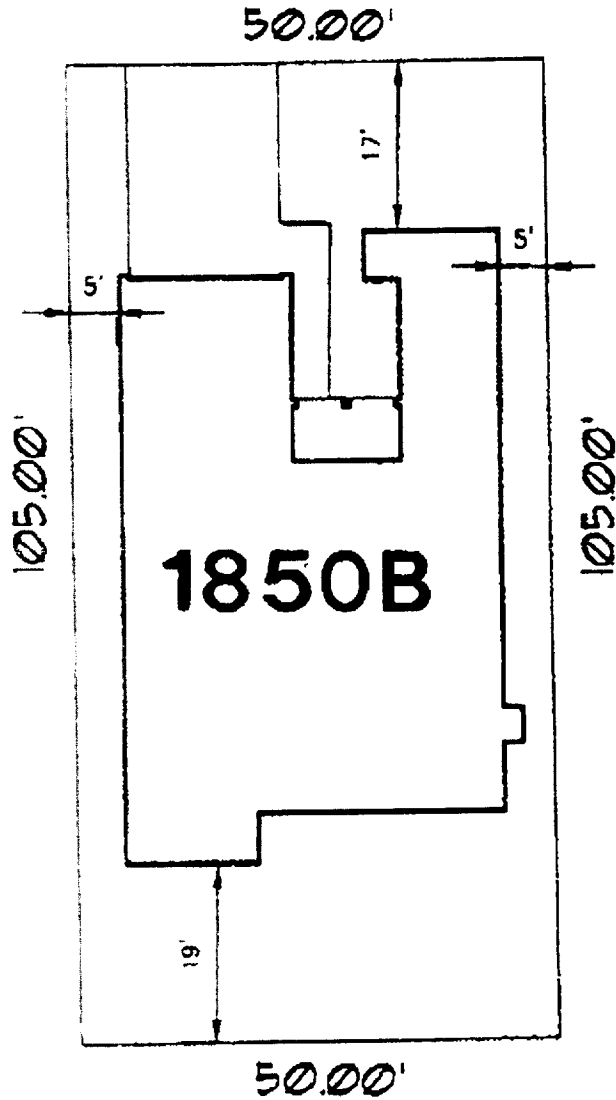

NOT TO SCALE
 ALL DIMENSIONS ARE APPROXIMATE
 AND SHOULD BE VERIFIED BY THE
 BUYER OR HIS REPRESENTATIVE
 PRIOR TO PURCHASE. THE
 BUYER SHALL BE RESPONSIBLE FOR
 OBTAINING ALL NECESSARY
 PERMITS AND APPROVALS FROM
 THE LOCAL GOVERNMENT
 AGENCIES. THE BUYER SHALL
 BE RESPONSIBLE FOR OBTAINING
 ALL NECESSARY PERMITS AND
 APPROVALS FROM THE LOCAL
 GOVERNMENT AGENCIES.

LOT: 65 SITE ADDRESS: 1930 NORTH BEND DR.

WHEN USED FOR SALES OR CONTRACT PURPOSES THIS DOCUMENT DOES NOT GUARANTEE ANY DIMENSIONS, DISTANCES, BEARINGS OR SETBACKS. JMC RESERVES THE RIGHT TO MAKE CHANGES AT ANY TIME WITHOUT PRIOR NOTICE AND IS NOT RESPONSIBLE FOR IRREGULARITIES OR DIFFERENCES IN ACTUAL OR "AS-BUILT" LOT CHARACTERISTICS.

SCALE: 1"=20'	APN:
LOT SIZE: 5250 +/-	1930 VERNON ST., No. 9 ROSELILLE, CA 94578 916-782-8978 CA. LIC. 97894
NP81-P-65 J 091400	

