

CITY OF SACRAMENTO
1231 I Street, Sacramento, CA 95814

Permit No: 0603398
Insp Area: 3
Thos Bros: 317E3

Site Address: 2740 24TH AV SAC
Parcel No: 019-0151-012

PAID
CITY OF SACRAMENTO

Sub-Type: RES
Housing (Y/N): N

MAY 16 2006

CONTRACTOR
OWNER BUILDER

OWNER
SILVA BRANDON
2740 24TH AV
SACRAMENTO, CA 95828

ARCHITECT

NEW CITY HALL

Nature of Work: DEMO OF EXISTING HOUSE TIGHTED TO 0603386 NSFR PERMIT

CONSTRUCTION LENDING AGENCY: I hereby affirm under penalty of perjury that there is a construction lending agency for the performance of the work for which this permit is issued (Sec. 3097, Civ. C).

Lender's Name _____ Lender's Address _____

LICENSED CONTRACTORS DECLARATION: I hereby affirm under penalty of perjury that I am licensed under provisions of Chapter 9 (commencing with section 7000) of Division 3 of the Business and Professions Code and my license is in full force and effect.

License Class _____ License Number 0 _____ Date _____ Contractor Signature _____

OWNER-BUILDER DECLARATION: I hereby affirm under penalty of perjury that I am exempt from the contractors License Law for the following reason (Sec. 7031.5, Business and Professions Code; any city or county which requires a permit to construct, alter, improve, demolish, or repair any structure, prior to its issuance, also requires the applicant for such permit to file a signed statement that he or she is licensed pursuant to the provisions of the Contractors License Law (Chapter 9 (commencing with Section 7000) of Division 8 of the Business and Professions Code) or that he or she is exempt therefrom and the basis for the alleged exemption. Any violation of Section 7031.5 by any applicant for a permit subjects the applicant to a civil penalty of not more than five hundred dollars (\$500.00);

BS I, as a owner of the property, or my employees with wages as their sole compensation, will do the work, and the structure is not intended or offered for sale (Sec. 7044, Business and Professional Code: The Contractors License Law does not apply to an owner of property who builds or improves thereon, and who does such work himself or herself or through his/her own employees, provided that such improvements are not intended or offered for sale. If, however, the building or improvement is sold within one year of completion, the owner-builder will have the burden of proving that he/she did not build or improve for the purpose of sale.)

I, as owner of the property, am exclusively contracting with licensed contractors to construct the project (Sec. 7044, Business and Professions Code: The Contractors License Law does not apply to an owner of property who builds or improves thereon, and who contracts for such projects with a contractor(s) licensed pursuant to the Contractors License Law).

I am exempt under Sec. _____ B & PC for this reason: _____

X Date 5-16-06 Owner Signature Brandon Silva

IN ISSUING THIS BUILDING PERMIT, the applicant represents, and the city relies on the representation of the applicant, that the applicant verified all measurements and locations shown on the application or accompanying drawings and that the improvement to be constructed does not violate any law or private agreement relating to permissible or prohibited locations for such improvements. This building permit does not authorize any illegal location of any improvement or the violation of any private agreement relating to location of improvements.

I certify that I have read this application and state that all information is correct. I agree to comply with all city and county ordinances and state laws relating to building construction and herby authorize representative(s) of this city to enter upon the abovementioned property for inspection purposes.

Date _____ Applicant/Agent Signature _____

WORKER'S COMPENSATION DECLARATION: I hereby affirm under penalty of perjury one of the following declarations:

I have and will maintain a certificate of consent to self-insure for workers' compensation as provided for by Section 3700 of the Labor Code, for the performance of work for which the permit is issued.

I have and will maintain workers' compensation insurance, as required by Section 3700 of the Labor Code, for the performance of the work for which this permit is issued. My workers' compensation insurance carrier and policy number are:

Carrier _____ Policy Number _____ Exp Date _____

(This section need not be completed if the permit is for \$100 or less) I certify that in the performance of the work for which this permit is issued, I shall not employ any person in any manner so as to become subject to the workers' compensation laws of California and agree that if I should become subject to the workers' compensation provisions of Section 3700 of the Labor Code, I shall forthwith comply with those provisions.

Date _____ Applicant Signature _____

WARNING: FAILURE TO SECURE WORKER'S COMPENSATION COVERAGE IS UNLAWFUL AND SHALL SUBJECT AN EMPLOYER TO CRIMINAL PENALTIES AND CIVIL FINES UP TO ONE HUNDRED THOUSAND DOLLARS (\$100,000) IN ADDITION TO THE COST OF COMPENSATION, DAMAGES AS PROVIDED FOR IN SECTION 3706 OF THE LABOR CODE, INTEREST AND ATTORNEY'S FEE.

THIS PERMIT SHALL EXPIRE BY LIMITATION IF WORK IS NOT COMMENCED WITHIN 180 DAYS.



CITY OF SACRAMENTO

www.cityofsacramento.org
Help Line: 1-916-808-5656 OR 1-866-EZ-PERMIT
Inspection: 1-916-808-7622

New City Hall
915 I Street, 3rd Floor
Sacramento, CA 95814

North Permit Center
2101 Arena Blvd., Suite 200
Sacramento, CA 95834

PERMIT # 0605398 APPLICATION FOR WRECKING PERMIT

LOCATION
Address: 2740 24th Ave
Lot: _____ Tract: _____
Lot Depth: 161.88" Lot Width: 60.00 Corner Lot: No Interior Lot: _____
Owner: Brandon Silva
Address: 2740 24th Ave

BUILDING DATA
Length: 36'-2" Width: 38'-4" First Floor Area: 1295 (Sq. Ft.) No. Stories: 1
Use of Building: Single family Dwelling Construction Type: wood Height: 8'+
of Units: 1 Rear Yard: Yes Side Yard: Yes Set Back: Yes
City Sewer: Yes Water: Yes Septic: _____ Well: _____

CONTRACTOR INFORMATION
Name: _____ State License No: _____
Address: _____
Phone: _____ Fax: _____
Liability Insurance P.L. _____ P.D. _____ Policy on File: _____

CODE REQUIREMENTS
Notification of Adjacent Property Owners: _____ Date: _____
Copy of Notification on File: _____ Use of Property Required: _____
Pedestrian Protection Required: _____ Requirements Attached: _____
Basement or Other Excavations on Lot: _____ To Be Filled: _____ Fenced: _____

PREPARE PLOT PLAN SHOWING LOCATION OF BUILDING ON LOT. ALSO TYPE AND LOCATION OF BUILDING BARRICADE.

SPECIAL CONDITIONS
I have read the above application and know the contents thereof; the same is true and correct. I further state that I am familiar with the laws governing the demolition of buildings within the City of Sacramento and the State of California and that the above structure will be razed in conformity therewith. I further state that I understand that this permit may be revoked for any violation of the provisions of the Code of the City of Sacramento pertaining to or affected by the demolition procedure to be used on the above building.

No. W _____ Applicant: Brandon Silva
Date: _____ Title: Owner
Fee: _____ (Applicant/Owner)

PERMIT EXPIRES		
Month /	Day /	Year

Y THIS IS A REVOCABLE PERMIT



CITY OF SACRAMENTO

www.cityofsacramento.org

Help Line: 1-916-808-5656 OR 1-866-EZ-PERMIT
Inspection: 1-916-808-7622

New City Hall
915 I Street, 3rd Floor
Sacramento, CA 95814

North Permit Center
2101 Arena Blvd., Suite 200
Sacramento, CA 95834

AGREEMENT TO HOLD CITY HARMLESS FROM LIABILITY
BY REASON OF DEMOLITION OF BUILDING

DATED: 5-16 - 2006

KNOW ALL BY THESE PRESENT:

The undersigned owner of the premises at 2740 24TH AV

pursuant to provisions of the City Code, hereby agrees as follows:

- 1. That the building to be demolished consists of no more than a two (2) story building, garage, and other supplemental buildings to be demolished by owner with personnel employed by him/her.
2. That the structure to be demolished will be so torn down as to complete all operations within the normal setback area from the property line.
3. That in accordance with provisions set forth in Title 15, Sec. 15.44.110 and .120 of the City Building Code, the undersigned shall comply with the following:

“Prior to the start of any demolition work on any building or structure in excess of two (2) stories in height, the permittee shall give written notice to owners or tenants of adjoining property not less than ten (10) days before such demolition is started and shall contemporaneously send a copy of each such notice to the director.

The permittee shall take all necessary precautions to adequately protect adjacent property and its occupants.”

- 4. That in consideration of waiver of insurance as allowed Title 9, Sec. 9.11.427 the undersigned owner hereby agrees to the following:

“indemnify and hold harmless the City of Sacramento, its officers, employees, and agents from and against any and all actions, damages, claims, losses or expenses of every type and description to which they may be subject or put, by reason of or resulting from directly or indirectly, negligent injury to persons or property arising out of the granting of permission by the City to the undersigned to demolish the building and salvage the materials from the premises above named.”

IN WITNESS THEREOF, the undersigned has fully read the Agreement and executed this Agreement the day and year first above written.

Owner: Brandon Silva Address: 2740 24TH AV

Subscribed and sworn to before this 16th day of May 20 06

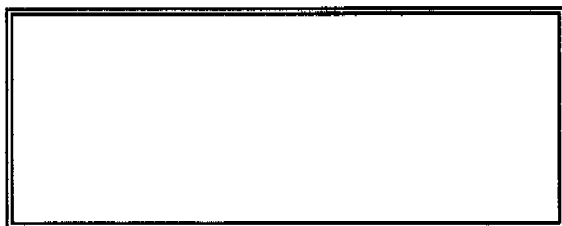

Notary Public in and for the
County of Sacramento,
State of California



CITY OF SACRAMENTO

www.cityofsacramento.org

Help Line: 1-916-808-5656 OR 1-866-EZ-PERMIT
Inspection: 1-916-808-7622

New City Hall
915 I Street, 3rd Floor
Sacramento, CA 95814

North Permit Center
2101 Arena Blvd., Suite 200
Sacramento, CA 95834

DEMOLITION PERMIT NOTIFICATION

WRECKING PERMIT # 0603398

A Demolition Permit for a 1 story building at:

2740 24TH AVE
(Address)

Parcel No. 019-0151-012 has been issued on 5-16-00
(Date)

The structure is scheduled for demolition within 30 days.

Please update your service and billing records accordingly.

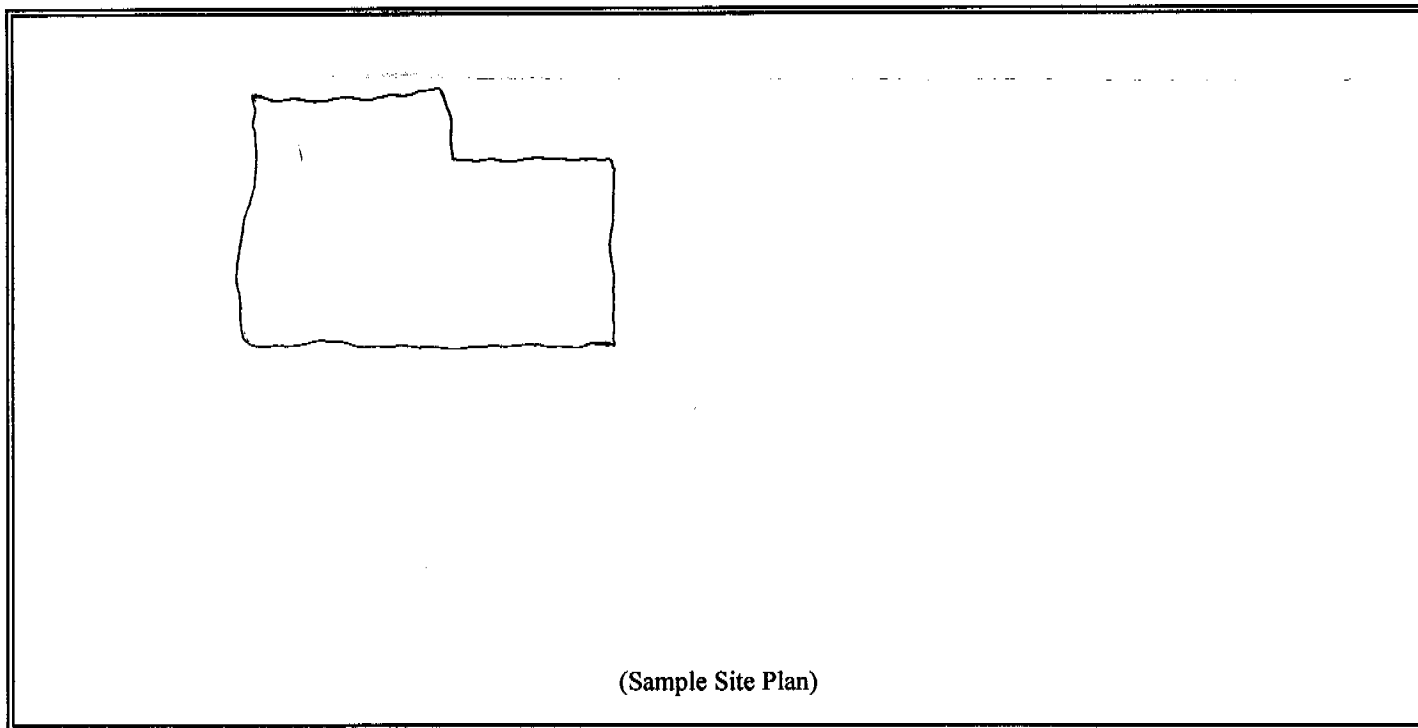

(Sample Site Plan)

- cc: P.G. & E (Terry Clark)
- SMUD
- SOLID WASTE (3141)
- UTILITIES (3350)
- UTILBILLING (1125)
- FIRE DEPT. (2510)



CITY OF SACRAMENTO

www.cityofsacramento.org

Help Line: 1-916-808-5656 OR 1-866-EZ-PERMIT
 Inspection: 1-916-808-7622

New City Hall
 915 I Street, 3rd Floor
 Sacramento, CA 95814

North Permit Center
 2101 Arena Blvd., Suite 200
 Sacramento, CA 95834

WRECKING INSPECTION FORM

Approval by the following City Departments must be obtained prior to the issuance of a wrecking permit by the Building & Planning Department. Design Review approval required on all wrecking permits in Central City or Alhambra Blvd. Corridor prior to sewer disconnect permit being issued.

Address: 2740 24th Ave #0603398
 Owner: Brandon Silva

Design Review/Planning 915 I Street, 3 rd Floor 916-808-5656 – Helpline Selection #3 X <u>PRESERVATION NOT OPPOSED TO DEMO</u>	Housing & Dangerous Buildings (If applicable*) 915 I Street, 3 rd Floor 916-808-5404 X
 Traffic Engineer (If applicable *) 1000 I Street, Suite 170 916-808-5307 X 	Fire Department (All) 5770 Freeport Blvd., Suite 200 916-433-1300 or 916-433-1628 X <u>[Signature]</u>
	 Arborist/Tree Service (If applicable *) Call for Appointment 5730 24th Street 916-433-6345 X

* may or may not apply depending on scope and location of project

1. Route to Planning and Fire
2. Bring Permit (signed off by Plumbing Inspector) back to the Building Dept. to apply for a Wrecking Permit. *Unless City Awarded Contract Sewer Disconnect will be called in by Bldg. Tech. - 264-5371 Kill Tap
3. Commercial buildings are required to have an Asbestos Form and are not to be issued before Air Quality Date is on the Asbestos Form (bottom right corner).