

**CITY OF SACRAMENTO**

**1231 I Street, Sacramento, CA 95814**

**Permit No: 0012298**

**Insp Area: 2**

**Site Address: 7924 JACINTO RD SAC**

**Parcel No: 117-1360-011**

**JACINTO VILLAGE LOT 11**

**Sub-Type: NSFR**

**Housing (Y/N): N**

**CONTRACTOR**

BEAZER HOMES  
3009 DOUGLAS BL #150  
ROSEVILLE CA 95661

**OWNER**

**ARCHITECT**

**Nature of Work: NSFR MP2516 11 RMS 2 STORY**

**CONSTRUCTION LENDING AGENCY:** I hereby affirm under penalty of perjury that there is a construction lending agency for the performance of the work for which this permit is issued (Sec. 3097, Civ. C).

Lender's Name \_\_\_\_\_ Lender's Address \_\_\_\_\_

**LICENSED CONTRACTORS DECLARATION:** I hereby affirm under penalty of perjury that I am licensed under provisions of Chapter 9 (commencing with section 7000) of Division 3 of the Business and Professions Code and my license is in full force and effect.

License Class 1 License Number 124791 Date 10/1/00 Contractor Signature [Signature]

**OWNER-BUILDER DECLARATION:** I hereby affirm under penalty of perjury that I am exempt from the contractors License Law for the following reason (Sec. 7031.5, Business and Professions Code; any city or county which requires a permit to construct, alter, improve, demolish, or repair any structure, prior to its issuance, also requires the applicant for such permit to file a signed statement that he or she is licensed pursuant to the provisions of the Contractors License Law (Chapter 9 (commencing with Section 7000) of Division 8 of the Business and Professions Code) or that he or she is exempt therefrom and the basis for the alleged exemption. Any violation of Section 7031.5 by any applicant for a permit subjects the applicant to a civil penalty of not more than five hundred dollars (\$500.00);

\_\_\_\_ I, as a owner of the property, or my employees with wages as their sole compensation, will do the work, and the structure is not intended or offered for sale (Sec. 7044, Business and Professional Code: The Contractors License Law does not apply to an owner of property who builds or improves thereon, and who does such work himself or herself or through his/her own employees, provided that such improvements are not intended or offered for sale. If, however, the building or improvement is sold within one year of completion, the owner-builder will have the burden of proving that he/she did not build or improve for the purpose of sale.)

\_\_\_\_ I, as owner of the property, am exclusively contracting with licensed contractors to construct the project (Sec. 7044, Business and Professions Code: The Contractors License Law does not apply to an owner of property who builds or improves thereon, and who contracts for such projects with a contractor(s) licensed pursuant to the Contractors License Law).

\_\_\_\_ I am exempt under Sec. \_\_\_\_\_ B & PC for this reason: \_\_\_\_\_

Date \_\_\_\_\_ Owner Signature \_\_\_\_\_

**IN ISSUING THIS BUILDING PERMIT,** the applicant represents, and the city relies on the representation of the applicant, that the applicant verified all measurements and locations shown on the application or accompanying drawings and that the improvement to be constructed does not violate any law or private agreement relating to permissible or prohibited locations for such improvements. This building permit does not authorize any illegal location of any improvement or the violation of any private agreement relating to location of improvements.

I certify that I have read this application and state that all information is correct. I agree to comply with all city and county ordinances and state laws relating to building construction and hereby authorize representative(s) of this city to enter upon the abovementioned property for inspection purposes.

Date 10/1/00 Applicant/Agent Signature [Signature]

**WORKER'S COMPENSATION DECLARATION:** I hereby affirm under penalty of perjury one of the following declarations:

\_\_\_\_ I have and will maintain a certificate of consent to self-insure for workers' compensation as provided for by Section 3700 of the Labor Code, for the performance of work for which the permit is issued.

I have and will maintain workers' compensation insurance, as required by Section 3700 of the Labor Code, for the performance of the work for which this permit is issued. My workers' compensation insurance carrier and policy number are:

Carrier LIBERTY MUTUAL INS CO. Policy Number WA2-651-004147-080 Exp Date 4/1/2001

\_\_\_\_ (This section need not be completed if the permit is for \$100 or less) I certify that in the performance of the work for which this permit is issued, I shall not employ any person in any manner so as to become subject to workers' compensation laws of California and agree that if I should become subject to the workers' compensation provisions of the Labor Code, I shall forthwith comply with those provisions.

Date 10/1/00 Applicant Signature [Signature]

**WARNING: FAILURE TO SECURE WORKER'S COMPENSATION COVERAGE IS UNLAWFUL AND SHALL SUBJECT AN EMPLOYER TO CRIMINAL PENALTIES AND CIVIL FINES UP TO ONE HUNDRED THOUSAND DOLLARS (\$100,000) IN ADDITION TO THE COST OF COMPENSATION, DAMAGES AS PROVIDED FOR IN SECTION 3706 OF THE LABOR CODE, INTEREST AND ATTORNEY'S FEE.**

**THIS PERMIT SHALL EXPIRE BY LIMITATION IF WORK IS NOT COMMENCED WITHIN 180 DAYS.**

**KWIKKOTE**  
STUCCO SYSTEM  
INSTALLATION CARD

# 21378

BEAZER HOMES

BELLEFLEUR I LOT 11

924 JACINTO ROAD SACRAMENTO

Stucco System Trade Name: KWIK KOTE

Name Stucco Manufacturer: KWIK KOTE CORP

ICBO Evaluation Service, Inc. Report No. 3607

Date of Job Completion \_\_\_\_\_

Stucco Contractor Name Kenyon Plastering, Inc.  
Address John W. Kenyon, III  
P.O. Box 2077  
North Highlands, CA 95660  
Telephone # (916) 349-8191

Approved Contractor Number as issued by the Stucco Manufacturer: 1

This is to certify that the stucco system on the building exterior at the above address had been installed in accordance with the evaluation report specified above and the manufacturer's instructions.

Signature of authorized representative of stucco contractor:

Date: 7-26-01

Builder Copy

# CERTIFICATION OF INSULATION

PART I GENERAL

ADDRESS OR TRACT

SACRAMENTO INSULATION CONTRACTORS

- P.O. BOX 854, WEST SACRAMENTO, CA 95691 LIC. #202026
- 1309 MELODY ROAD, MARYSVILLE, CA 95901 LIC. #202026
- P.O. BOX 9651, FRESNO, CA 93793-9651 LIC. #202026
- P.O. BOX 1631, RENO, NV 89505 LIC. #10675
- 3326 A PONDEROSA WAY, LAS VEGAS, NV 89118 LIC. #10675

DATE INSULATION COMPLETED

*7/18/01*

PART II AREAS INSULATED

WALLS		CEILING			FLOORS	
SQUARE FEET		SQUARE FEET			SQUARE FEET	
TYPE OF INSULATION		TYPE OF INSULATION			TYPE OF INSULATION	
MATERIAL <b>FIBERGLASS</b>	MATERIAL <b>FIBERGLASS</b>	MATERIAL <b>FIBERGLASS</b>	MATERIAL <b>FIBERGLASS</b>			MATERIAL <b>FIBERGLASS</b>
FORM <b>BATTS</b>	FORM <b>BATTS &amp; BLOW</b>	FORM <b>BATTS &amp; BLOW</b>	FORM <b>BATTS &amp; BLOW</b>			FORM <b>BATTS</b>
MANUFACTURER'S PRODUCT ID		MANUFACTURER'S PRODUCT ID			MANUFACTURER'S PRODUCT ID	
MANUFACTURER		MANUFACTURER			MANUFACTURER	
OCF		OCF			OCF	
R - VALUE INSTALLED	APPLIED THICKNESS	R - VALUE INSTALLED	APPLIED THICKNESS	MIN. INSTALLED WEIGHT PER SQUARE FOOT	R - VALUE INSTALLED	APPLIED THICKNESS
<i>13</i>	<i>3 7/8"</i>	<i>35</i>	<i>7 1/2"</i>			

KNEE WALLS IF R-VALUE IS OTHER THAN WALLS ABOVE

MATERIAL <b>FIBERGLASS</b>	FORM <b>BATTS</b>	R-VALUE	MANUFACTURER <b>OCF</b>
-------------------------------	----------------------	---------	----------------------------

AIR INFILTRATION SEALANT

MATERIAL <b>FLAM</b>	MANUFACTURER <b>W R GRACE</b>
-------------------------	----------------------------------

**THIS IS TO CERTIFY THAT INSULATION AND/OR SEALANT HAS BEEN INSTALLED IN CONFORMANCE WITH APPLICABLE CODES, MATERIAL STANDARDS AND REGULATIONS.**

SIGNATURE - INSULATION CONTRACTOR <i>Bull G...</i>	TITLE MANAGER	DATE <i>3/30/01</i>
SIGNATURE - GENERAL CONTRACTOR	TITLE	DATE

REMARKS

THIS PLOT PLAN IS NOT FOR SALES PURPOSES. THIS PLOT PLAN IS FOR THE PURPOSES OF INDICATING COMPLIANCE WITH ZONING SET BACKS, GENERAL DRAINAGE DIRECTION, AND APPROXIMATE UTILITY CONNECTION. ALL OTHER DATA SHOWN HEREON IS CONCEPTUAL. THIS PLOT PLAN DOES NOT REFLECT AS-BUILT CONDITION. RETAINING WALLS ARE OPTIONAL AND MAY OR MAY NOT BE CONSTRUCTED.

# JACINTO RD.

- ☒ — WATER METER BOX
- ☒ — ELECTRICAL BOX
- ⊕ — UTILITY RISERS
- ⊙ — SEWER CLEANOUT
- ⊗ — STREET LIGHT
- — DRAIN INLET
- Ⓜ — TELEPHONE PED.

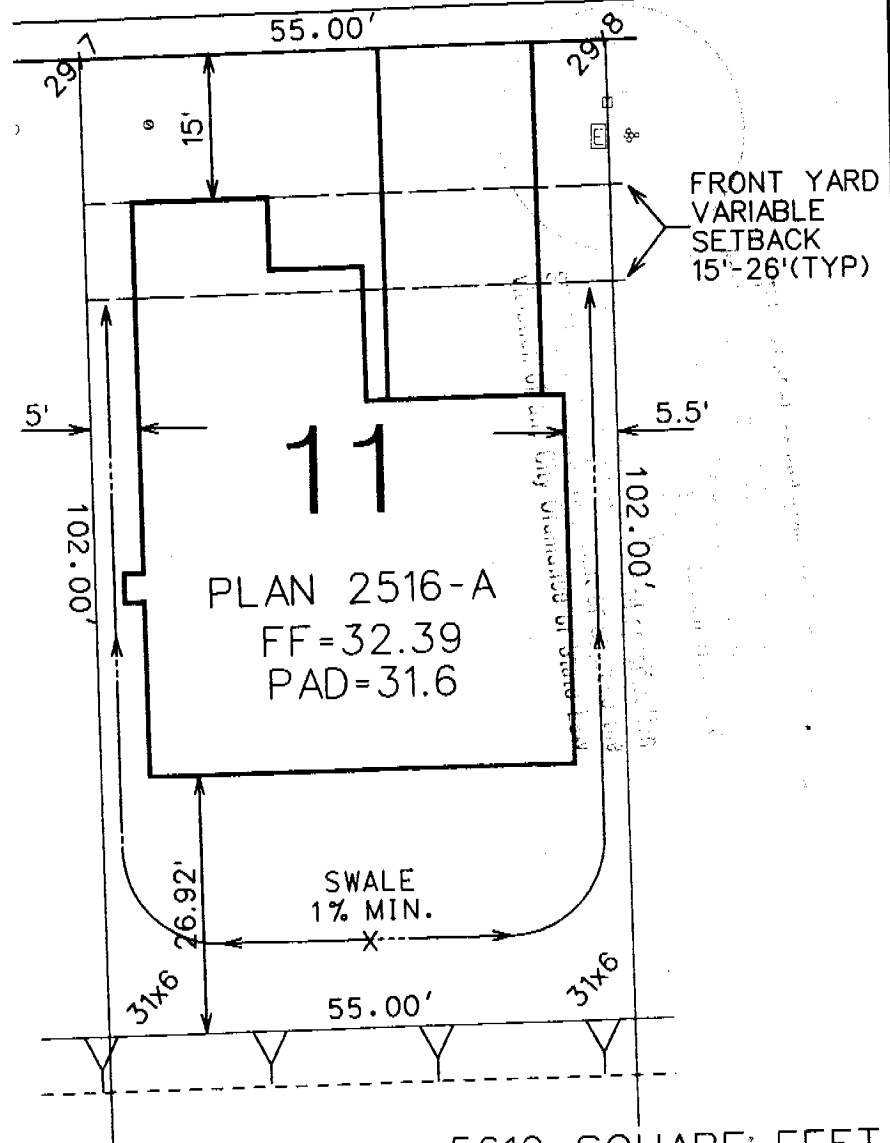

REVISION APPROVAL		INITIALS
President	✓	
Project Development		
Construction	✓	PRA
Marketing	✓	LK
Accounting		

SCALE: 1"=20'

<p><b>KASL</b> ENGINEERS CIVIL - WATER RESOURCES - SURVEYING</p>	<p>7777 Greenback Lane Suite 104 Citrus Heights, CA 95610 Tel: (916) 722-1800 Fax: (916) 722-4595</p>	<p>PLOT PLAN FOR LOT 11</p>	<p>SCALE: 1"=20'</p>
	<p>JACINTO VILLAGE SOUTH</p>		<p>DATE: 09-14-00</p>
	<p>A.P.N. 117-1360-011</p>		<p>REVISED:</p>
	<p>ADDRESS: COUNTY: SACRAMENTO</p>		<p>DRAWN BY: PRA</p>
			<p>CHK'D. BY: LK</p>
			<p>W.O. 0435-01</p>

**RESIDENTIAL BUILDING PERMIT APPLICATION**

New Construction       Addition       Remodels       Other

Project Address: 7924 Jacinto Road      Assessor Parcel # 117-1360-011

**OWNER INFORMATION:**

Lot 11

Legal Property Owner: BEAZER HOMES      Phone # (916) 773-3888  
 Owner Address: 3009 Douglas Blvd. #150, City ROSEVILLE, State Ca. Zip 95661

**CONTRACTOR INFORMATION:**

Contractor: BEAZER HOMES Lic. # 724191 Phone # 773-3888 Fax# 773-0425

**PROJECT INFORMATION:**

Jacinto Village South

Land Use Zone R14      Occupancy Group R3      Construction Type VN      Fed Code 14

No. of stories: 2      No. of rooms: \_\_\_\_\_      Street width: \_\_\_\_\_

1<sup>st</sup> Floor Area 1278      2<sup>nd</sup> Floor Area 1238      Basement \_\_\_\_\_      Roof Material \_\_\_\_\_

AREA IN SQUARE FOOT OF:	EXISTING	NEW
Dwelling/Living	_____	<u>2516</u>
Garage/Storage	_____	<u>808</u>
Decks/Balconies	_____	_____
Carports	_____	_____

SCOPE OF WORK: \_\_\_\_\_

**FOR OFFICE USE ONLY**

- |   |   |  |
|---|---|--|
| <input type="checkbox"/> Information above complete | <input type="checkbox"/> AR Flood Waiver required             | <input type="checkbox"/> Planning Approval                   |
| <input type="checkbox"/> Violation files checked    | <input type="checkbox"/> Flood Elevation Certificate Required | <input type="checkbox"/> Design Review Approval              |
| <input type="checkbox"/> Standard setbacks          | <input type="checkbox"/> Water Development Infill Area        | <input type="checkbox"/> Special Fee Districts Apply : _____ |
| <input type="checkbox"/> County Sewer               |   |  |

**NEW STRUCTURES & ADDITIONS**

❖ THE FOLLOWING MUST BE PROVIDED IN ORDER TO SUBMIT FOR PLAN REVIEW

- |   |   |
|---|---|
| <input type="checkbox"/> 2 COMPLETE PLANS, LEGIBLE & DRAWN TO SCALE   | ❖ Plans to include: site plan, floor plan, elevations, roof/ceiling plan, foundation and structural framing details, and structural calculations for non-conforming structures. |
| <input type="checkbox"/> 3 SETS IF PROJECT IS IN A DESIGN REVIEW AREA |   |
| <input type="checkbox"/> Title 24 Energy Compliance documentation     | <input type="checkbox"/> 11" x 17" copy of floor plan for County Assessor   |
| <input type="checkbox"/> Grading and Erosion Control Questionnaire    | <input type="checkbox"/> Plan Review Fees   |

Date: \_\_\_\_\_

Received by: (staff) \_\_\_\_\_

ACTIVITY/PERMIT #