

**CITY OF SACRAMENTO**  
1231 I Street, Sacramento, CA 95814

**Permit No: 0011032**

**Insp Area: 4**

**Site Address: 3824 INNOVATOR DR SAC**  
Parcel No: 225-1340-086 NATOMAS CROSSING 21 LOT 57  
N

Sub-Type: NSFR  
Housing (Y/N):

**CONTRACTOR**  
KIMBALL HILL HOMES  
10535 EAST STOCKTON BL. STE. K  
ELK GROVE CA. 95624

**OWNER**

**ARCHITECT**

**Nature of Work: MP 2954 2 STORY 10 ROOM SFR**

**CONSTRUCTION LENDING AGENCY:** I hereby affirm under penalty of perjury that there is a construction lending agency for the performance of the work for which this permit is issued (Sec. 3097, Civ. C).

Lender's Name \_\_\_\_\_ Lender's Address \_\_\_\_\_

**LICENSED CONTRACTORS DECLARATION:** I hereby affirm under penalty of perjury that I am licensed under provisions of Chapter 9 commencing with section 7000) of Division 3 of the Business and Professions Code and my license is in full force and effect.

License Class B License Number 71803 Date 2/15/01 Contractor Signature N. Collins

**OWNER-BUILDER DECLARATION:** I hereby affirm under penalty of perjury that I am exempt from the contractors License Law for the following reason (Sec. 7021.5, Business and Professions Code, any city or county which requires a permit to construct, alter, improve, demolish, or repair any structure, prior to its issuance, also requires the applicant for such permit to file a signed statement that he or she is licensed pursuant to the provisions of the Contractors License Law (Chapter 9 (commencing with Section 7000) of Division 8 of the Business and Professions Code) or that he or she is exempt therefrom and the basis for the alleged exemption. Any violation of Section 7031.5 by any applicant for a permit subjects the applicant to a civil penalty of not more than five hundred dollars (\$500.00):

I, as a owner of the property, or my employees with wages as their sole compensation, will do the work, and the structure is not intended or offered for sale (Sec. 7044, Business and Professional Code. The Contractors License Law does not apply to an owner of property who builds or improves thereon, and who does such work himself or herself or through his/her own employees, provided that such improvements are not intended or offered for sale. If, however, the building or improvement is sold within one year of completion, the owner-builder will have the burden of proving that he/she did not build or improve for the purpose of sale.)

I, as owner of the property, am exclusively contracting with licensed contractors to construct the project (Sec. 7044, Business and Professions Code. The Contractors License Law does not apply to an owner of property who builds or improves thereon, and who contracts for such projects with a contractor(s) licensed pursuant to the Contractors License Law)

I am exempt under Sec. \_\_\_\_\_ B & PC for this reason: \_\_\_\_\_

Date \_\_\_\_\_ Owner Signature \_\_\_\_\_

**IN ISSUING THIS BUILDING PERMIT,** the applicant represents, and the city relies on the representation of the applicant, that the applicant verified all measurements and locations shown on the application or accompanying drawings and that the improvement to be constructed does not violate any law or private agreement relating to permissible or prohibited locations for such improvements. This building permit does not authorize any illegal location of any improvement or the violation of any private agreement relating to location of improvements.

I certify that I have read this application and state that all information is correct. I agree to comply with all city and county ordinances and state laws relating to building construction and hereby authorize representative(s) of this city to enter upon the abovementioned property for inspection purposes.

Date 2/15/01 Applicant/Agent Signature N. Collins

**WORKER'S COMPENSATION DECLARATION:** I hereby affirm under penalty of perjury one of the following declarations:

I have and will maintain a certificate of consent to self-insure for workers' compensation as provided for by Section 3700 of the Labor Code, for the performance of work for which the permit is issued

I have and will maintain workers' compensation insurance, as required by Section 3700 of the Labor Code, for the performance of the work for which this permit is issued. My workers' compensation insurance carrier and policy number are:

Carrier CLAREDON NAT. INS. CO Policy Number SCF98-3482-000 Exp Date 10/01/2000

(This section need not be completed if the permit is for \$100 or less) I certify that in the performance of the work for which this permit is issued, I shall not employ any person in any manner so as to become subject to the workers' compensation laws of California and agree that if I should become subject to the workers' compensation provisions of Section 3700 of the Labor Code, I shall forthwith comply with those provisions.

Date 2/15/01 Applicant Signature N. Collins

**WARNING:** FAILURE TO SECURE WORKER'S COMPENSATION COVERAGE IS UNLAWFUL AND SHALL SUBJECT AN EMPLOYER TO CRIMINAL PENALTIES AND CIVIL FINES UP TO ONE HUNDRED THOUSAND DOLLARS (\$100,000) IN ADDITION TO THE COST OF COMPENSATION, DAMAGES AS PROVIDED FOR IN SECTION 3706 OF THE LABOR CODE, INTEREST AND ATTORNEY'S FEE.

**THIS PERMIT SHALL EXPIRE BY LIMITATION IF WORK IS NOT COMMENCED WITHIN 180 DAYS.**



**INSULATION CONTRACTORS  
ASSOCIATION  
OF AMERICA**

INSULATION  
CERTIFICATE

**73615**

1321 DUKE STREET, SUITE 303 • ALEXANDRIA, VA 22314 • (703) 739-0356

THIS CERTIFICATE IS VALID ONLY WHEN THE WORK IS DONE IN ACCORDANCE WITH THE NATIONAL ENERGY PROGRAMS AND THE INSULATION CONTRACTORS ASSOCIATION OF AMERICA'S STANDARD PRACTICES FOR INSTALLING INSULATION IN THE BUILDING INDUSTRY.

Kimball Hill Homeslot # 57 Tract # A-400005 X-

STREET 3021 HUNTERS LK CITY Sacramento

**EXTERIOR WALLS:**

MANUFACTURER 466 THICKNESS/TYPE 3 1/2 R- 13  
VALUE 13

**CEILINGS:**

BAITS: 116 THICKNESS/TYPE 11 R- 30  
VALUE 30

MANUFACTURER 121 MINIMUM THICKNESS 121 R- 30  
VALUE 30

SQUARE FOOTAGE COVERED 1200 NUMBER OF BAGS USED 22

FLOORS: MANUFACTURER \_\_\_\_\_ THICKNESS/TYPE \_\_\_\_\_ R- \_\_\_\_\_  
VALUE \_\_\_\_\_

SLAB ON GRADE: MANUFACTURER \_\_\_\_\_ THICKNESS/TYPE \_\_\_\_\_ R- \_\_\_\_\_  
VALUE \_\_\_\_\_

WIDTH OF INSULATION \_\_\_\_\_ INCHES

FOUNDATION WALLS: MANUFACTURER \_\_\_\_\_ THICKNESS/TYPE \_\_\_\_\_ R- \_\_\_\_\_  
VALUE \_\_\_\_\_

GENERAL CONTRACTOR \_\_\_\_\_ DATE \_\_\_\_\_  
CALIFORNIA CONTRACTORS LICENSE # \_\_\_\_\_

SIGNATURE \_\_\_\_\_ TITLE \_\_\_\_\_

INSULATION CONTRACTOR **ARCADE INSULATION** DATE 11/17/01  
CALIFORNIA CONTRACTORS LICENSE #263794

Kimball Hill SIGNATURE \_\_\_\_\_ TITLE \_\_\_\_\_  
Kimball Hill

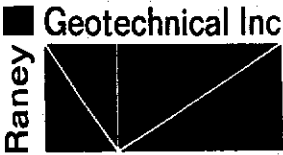

# DAILY FIELD REPORT

Project #: 1828-001-00		Date: 5-31-01	Day: THU	Weather: CLEAR	PAGE 1 11
Project Name: NATOMIS CROSSING UNITS 18-19-20		Project Location: AIRPORT RD		Permit #:	
Client: RIMBALL HILL HOMES			Client's Representative:		
General Contractor:			Superintendent:		
Sub-Contractor: TEICHERT			Other Persons Contacted:		
Type of Work: SAT check	Location/Element:		Equipment used:	Time: 1:0	
Type of Work:	Location/Element:		Equipment used:	Time:	
Plans/Specifications: 12" PRE SATURATION REQUIRED					
ARRIVED AT SITE INSPECTED LOTS OBSERVED					
FOOTING AND FORMS IN PLACE, VAPOR BARRIER WITH					
SAND ON TOP WITH WIRE MESH REINFORCEMENT					
PERFORMED PROBE CHECK OF RANDOM AREAS IN					
EACH LOT AND REACHED REQUIRED PRESATURATION					
DEPTH ALSO OBSERVED MOISTURE AND OR STANDING WATER					
OUTSIDE OF FORMS					
LOTS ARE READY TO POUR AND WILL REMAIN SO					
FOR 48 HRS					
LOTS READY ARE 153-154-155-156-157-159					
ATTACHMENTS: <input type="checkbox"/> FIELD DENSITY DATA <input type="checkbox"/> CONCRETE PLACEMENT DATA <input type="checkbox"/> SKETCH <input type="checkbox"/> OTHER:					
Copy received by/given to: [Signature]		Arrived: 8:45	Departed: 9:15	Report by: A.J. MAGAROWICZ	

# @lpha Inspections & Material Testing

70 Rancho Del Sol • Camino, CA 95709  
(530) 644-6726 • (916) 825-7733

DATE: 9-8-01  
PROJECT NO. 2001  
PROJECT: 3 B / 2nd floor concrete  
LOCATION: \_\_\_\_\_

DSA FILE/APPL. NO. \_\_\_\_\_  
OSHPD NO. \_\_\_\_\_  
PERMIT NO. \_\_\_\_\_  
WEATHER: \_\_\_\_\_ TEMP: \_\_\_\_\_

**PROOF LOAD**     **TORQUE**     **WITNESSING**

Testing was performed on the following items. All tests were performed with the following calibrated equipment:

RAM: AT #255    GAGE: AT #1004    TORQUE WRENCH: \_\_\_\_\_  
RAM: \_\_\_\_\_    GAGE: \_\_\_\_\_    TORQUE WRENCH: \_\_\_\_\_

LOCATION OF TEST	TYPE / SIZE	# TESTED	% of TOTAL	LOAD lb or Ft Lbs	GAGE (PSI)	# ACC.	# REJ.	# RETEST
<u>PROS EPOXIED anchor Bolt</u>	<u>5/8"</u>	<u>1</u>		<u>6855</u>	<u>2670</u>	<u>1</u>	<u>0</u>	<u>0</u>

- Type of epoxy / grout used: \_\_\_\_\_ Method of application / cleaning: \_\_\_\_\_
- Visual inspection was performed on \_\_\_\_\_
- Show up / Stand by time. Job Canceled / Delayed due to: \_\_\_\_\_
- All non-compliance items were brought to the attention of: \_\_\_\_\_ at the job site.

NON-COMPLIANCE REPORT ATTACHED     ADDITIONAL TESTS ATTACHED

NOTES: \_\_\_\_\_  
\_\_\_\_\_  
\_\_\_\_\_  
\_\_\_\_\_

To the best of my knowledge, the above ~~WAS~~ **WAS NOT** performed in accordance with the approved plans, specifications, and regulatory requirements.

Superintendent/Representative: \_\_\_\_\_ Inspector: 

INSTALLATION CARD

OMEGA DIAMOND WALL INSULATING ONE COAT SYSTEM  
OMEGA PRODUCTS INTERNATIONAL, INC.

Job Address:

NATOMAS CROSSING LOT 157  
3824 INNOVATOR, SAC, CA  
KIMBALL HILL

ICBO Evaluation Service, Inc.  
Report 4004

10/27/01  
Date of Job Completion

Plastering Contractor:

Name: Mid Valley Plastering, Inc.  
Address: 4807 S. Airport Way, Unit # D  
Stockton, CA 95206-4924  
Telephone: (209) 234-2671

Approved Contractor Number as  
Issued by the Coating Manufacturer Omega Diamond Wall No. 2315

This is to certify that the exterior system on the building exterior at the above  
address has been installed in accordance with the evaluation report specified above  
and the manufacturer's instructions

Jeff Lane  
Signature of Plastering Contractor

10/30/01  
Date

This installation card must be presented to the building inspector after completion  
of work and before final inspection

Lot 57

RESIDENTIAL BUILDING PERMIT APPLICATION

New Construction     Addition     Remodels     Other

Project Address: 3824 Innovator Drive    Assessor Parcel # 22S-1340-086

OWNER INFORMATION: Natomas Crossing #21

Legal Property Owner: Kimball Hill Homes    Phone # (916) 714-1153  
Owner Address: 10535 East Stockton Blvd City Elk Grove    State Ca.    Zip 95624  
Suite K

CONTRACTOR INFORMATION:

Contractor: Kimball Hill Homes Lic. # 701803    Phone # 714-1153    Fax# 714-1425

PROJECT INFORMATION:

Land Use Zone R-14    Occupancy Group R-3    Construction Type VN    Fed Code 1A  
No. of stories: 2    No. of rooms: 10    Street width: \_\_\_\_\_  
1<sup>st</sup> Floor Area 1308    2<sup>nd</sup> Floor Area 1646    Basement \_\_\_\_\_    Roof Material \_\_\_\_\_

AREA IN SQUARE FOOT OF:	EXISTING	NEW
Dwelling/Living	_____	<u>2954</u>
Garage/Storage	_____	<u>407</u>
Decks/Balconies	_____	<u>94</u>
Carports	_____	_____

SCOPE OF WORK: \_\_\_\_\_

FOR OFFICE USE ONLY

- Information above complete     AR Flood Waiver required     Planning Approval
- Violation files checked     Flood Elevation Certificate Required     Design Review Approval
- Standard setbacks     Water Development Infill Area     Special Fee Districts Apply : \_\_\_\_\_
- County Sewer

NEW STRUCTURES & ADDITIONS

◆ THE FOLLOWING MUST BE PROVIDED IN ORDER TO SUBMIT FOR PLAN REVIEW

- 2 COMPLETE PLANS, LEGIBLE & DRAWN TO SCALE    ◆ Plans to include: site plan, floor plan, elevations, roof/ceiling plan, foundation and structural framing details, and structural calculations for non-conforming structures.
- 3 SETS IF PROJECT IS IN A DESIGN REVIEW AREA
- Title 24 Energy Compliance documentation     11" x 17" copy of floor plan for County Assessor
- Grading and Erosion Control Questionnaire     Plan Review Fees

Date: \_\_\_\_\_

Received by: (staff) \_\_\_\_\_



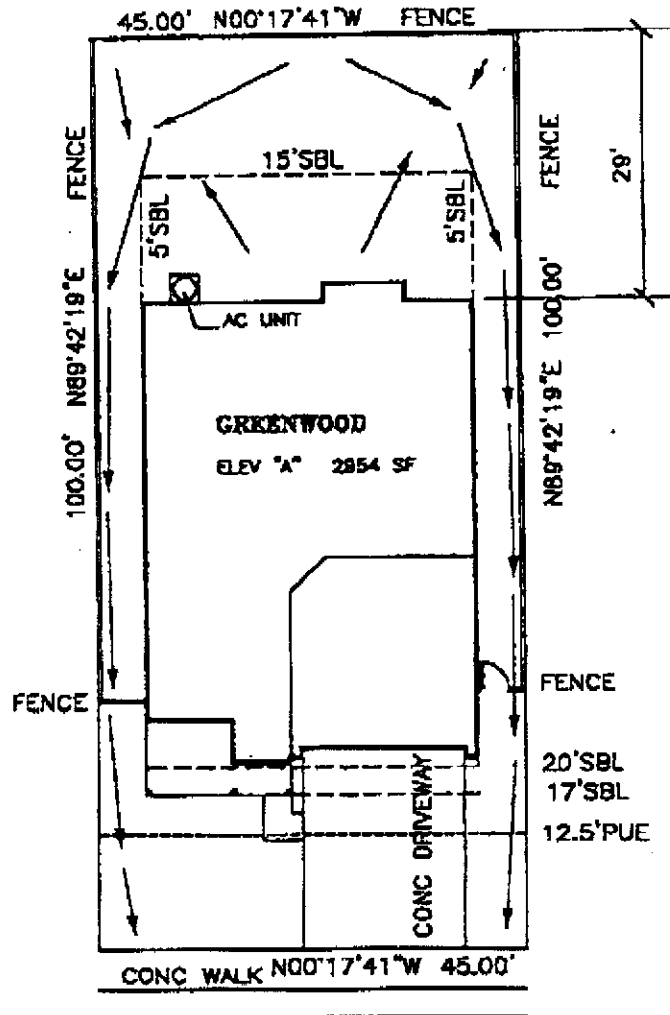

**INNOVATOR DRIVE**



**BLOOM**  
**Architectural**  
**Developments**  
**Incorporated**  
 4437 Kenneth Avenue  
 Fair Oaks, CA 95628  
 (916)981-1553  
 (916)967-3011 Fax



**Plot Plan Disclosure** This plot plan approximates a general representation of lot dimensions, easements, fence and home placement, etc. This illustration is not a condition of Kimball Hill Homes sales agreement. The actual placement and measurements demonstrated on this diagram are subject to change without notice.

Signature \_\_\_\_\_

**KHH California, Inc.** (916)714-1153  
 10535 E.Stockton Blvd. Ste.K, Elk Grove, CA 95758



**Job#** 164157 **Plan#** 2954  
**Date** Aug 25 00 **Draft** 1  
**Plan** GREENWOOD **Elev** A  
**Project** Natomas Crossing  
**Lot** 57 **Unit** 21  
**Address** 3624 Innovator Dr  
**City** Sacramento **State** CA  
**APN** -----0000

**PLOT PLAN**  
 Scale 1"=20'