

CITY OF SACRAMENTO
1231 I Street, Sacramento, CA 95814

Permit No: **0508563**

Insp Area: 2
Thos Bros: 337D3

Site Address: **7634 22ND ST SAC**
Parcel No: 052-0032-008

Sub-Type: REM
Housing (Y/N): N

CONTRACTOR
SEARS HOME IMPROVEMENT
283 E. AIRWAY BL
LIVERMORE CA 94550

OWNER
DAVIS ERMA R/LEIGH A
7634 22ND ST
SACRAMENTO, CA 95832

ARCHITECT

Nature of Work NON-STRUCTURAL REMODEL R&R CABINETS, COUNTERTOP, REPLACE APPLIANCES, UPGRADE OUTLET STOPS, GFCI, ADD 2 BREAKERS. REPLACE FAUCET, SINK, INSTALL NEW GARBAGE DISPOSAL

CONSTRUCTION LENDING AGENCY : I hereby affirm under penalty of perjury that there is a construction lending agency for the performance of the work for which this permit is issued (Sec. 3097, Civ. C).

Lender's Name _____ Lender's Address _____

LICENSED CONTRACTORS DECLARATION: I hereby affirm under penalty of perjury that I am licensed under provisions of Chapter 9 (commencing with section 7000) of Division 3 of the Business and Professions Code and my license is in full force and effect.

License Class B License Number 721379 Date 6/15/05 Contractor Signature [Signature]

OWNER-BUILDER DECLARATION: I hereby affirm under penalty of perjury that I am exempt from the contractors License Law for the following reason (Sec. 7031.5, Business and Professions Code; any city or county which requires a permit to construct, alter, improve, demolish, or repair any structure, prior to its issuance, also requires the applicant for such permit to file a signed statement that he or she is licensed pursuant to the provisions of the Contractors License Law (Chapter 9 (commencing with Section 7000) of Division 8 of the Business and Professions Code) or that he or she is exempt therefrom and the basis for the alleged exemption. Any violation of Section 7031.5 by any applicant for a permit subjects the applicant to a civil penalty of not more than five hundred dollars (\$500.00);

I, as a owner of the property, or my employees with wages as their sole compensation, will do the work, and the structure is not intended or offered for sale (Sec. 7044, Business and Professional Code: The Contractors License Law does not apply to an owner of property who builds or improves thereon, and who does such work himself or herself or through his/her own employees, provided that such improvements are not intended or offered for sale. If, however, the building or improvement is sold within one year of completion, the owner-builder will have the burden of proving that he/she did not build or improve for the purpose of sale.)

I, as owner of the property, am exclusively contracting with licensed contractors to construct the project (Sec. 7044, Business and Professions Code: The Contractors License Law does not apply to an owner of property who builds or improves thereon, and who contracts for such projects with a contractor(s) licensed pursuant to the Contractors License Law).

I am exempt under Sec. _____ B& PC for this reason: _____
Date _____ Owner Signature _____

PAID
CITY OF SACRAMENTO
JUN 15 2005

IN ISSUING THIS BUILDING PERMIT, the applicant represents, and the city relies on the representation of the applicant, that the applicant verified all measurements and locations shown on the application or accompanying drawings and that the improvement to be constructed does not violate any law or private agreement relating to permissible or prohibited locations for such improvements. This building permit does not authorize any illegal location of any improvement or the violation of any private agreement relating to location of improvements.

I certify that I have read this application and state that all information is correct. I agree to comply with all city and county ordinances and state laws relating to building construction and hereby authorize representative(s) of this city to enter upon the abovementioned property for inspection purposes.

Date _____ Applicant/Agent Signature _____

WORKER'S COMPENSATION DECLARATION: I hereby affirm under penalty of perjury one of the following declarations:
I have and will maintain a certificate of consent to self-insure for workers' compensation as provided for by Section 3700 of the Labor Code, for the performance of work for which the permit is issued.

(X) I have and will maintain workers' compensation insurance, as required by Section 3700 of the Labor Code, for the performance of the work for which this permit is issued. My workers' compensation insurance carrier and policy number are:

Carrier INDEMNITY INSURANCE COMPANY OF Policy Number WLRC44187000 Exp Date 04/01/2006

() (This section need not be completed if the permit is for \$100 or less) I certify that in the performance of the work for which this permit is issued, I shall not employ any person in any manner so as to become subject to the workers' compensation laws of California and agree that if I should become subject to the workers' compensation provisions of Section 3700 of the Labor Code, I shall forthwith comply with those provisions.

Date 6/15/05 Applicant Signature [Signature]

WARNING: FAILURE TO SECURE WORKER'S COMPENSATION COVERAGE IS UNLAWFUL AND SHALL SUBJECT AN EMPLOYER TO CRIMINAL PENALTIES AND CIVIL FINES UP TO ONE HUNDRED THOUSAND DOLLARS (\$100,000) IN ADDITION TO THE COST OF COMPENSATION, DAMAGES AS PROVIDED FOR IN SECTION 3706 OF THE LABOR CODE, INTEREST AND ATTORNEY'S FEE.

The approval of all
 Plumbing and Mechanical work
 is subject to field inspection

ISSUED
 City of Sacramento

JUN 15 2005

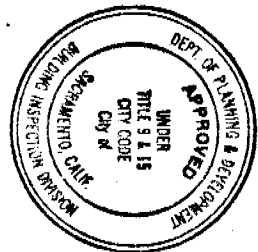

This set of plans and specifications must be kept on the job at all times and it is unlawful to make any changes or alterations from the same without written permission from the Building Inspection Division.
 The approval of this plan and specification SHALL NOT be held to permit or approve the violation of any City Ordinance or State Law.

CITY COPY

THE APPROVAL OF ALL ELECTRICAL WORK IS SUBJECT TO FIELD INSPECTIONS.

SEARS NORTH PERMIT
 NAME LEIGH ANGENBERS 4489931
 ADDRESS 7634 22nd ST.
 SAC, CA



CUSTOMER APPROVAL *X*
 CUSTOMER APPROVAL *X*
 DATE 6-6-05

CEILING HT 95%

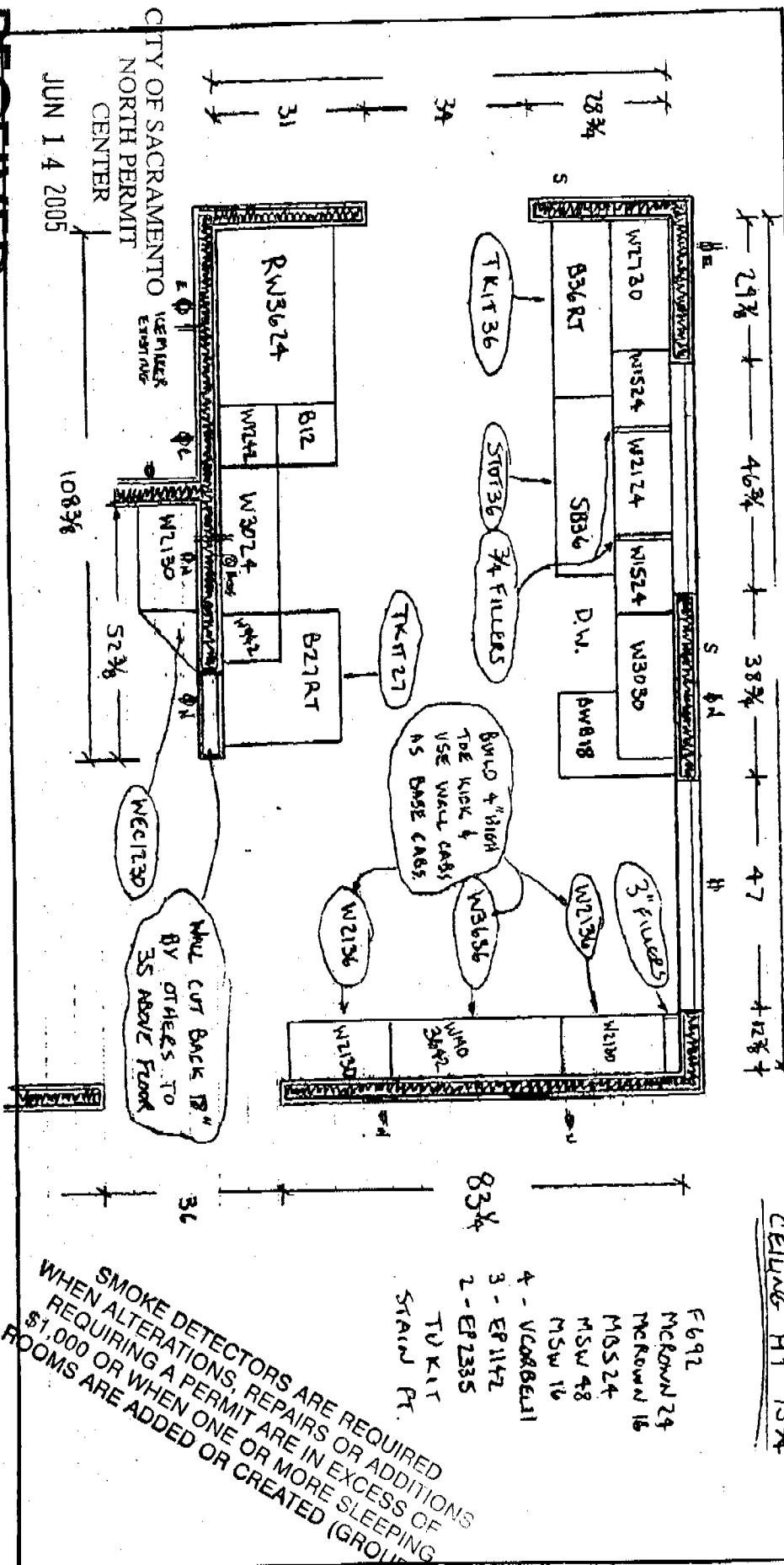

RECEIVED

SMOKE DETECTORS ARE REQUIRED WHEN ALTERATIONS, REPAIRS OR ADDITIONS REQUIRING A PERMIT ARE IN EXCESS OF \$1,000 OR WHEN ONE OR MORE SLEEPING ROOMS ARE ADDED OR CREATED (GROUP R)