

CITY OF SACRAMENTO  
1231 I Street, Sacramento, CA 95814

Permit No: 9908110  
Insp Area: 4

Site Address: 1445 MAYFIELD ST SAC  
Parcel No: 225-1120-022  
N

Sub-Type: NSFR  
NORTHPOINTE PARK UNIT 14 LOT 22  
Housing (Y/N):

CONTRACTOR  
11 NNAR RENAISSANCE INC.  
2240 DOUGLAS BL  
ROSEVILLE CA 95661

OWNER

ARCHITECT

Nature of Work: MP 2196 2 STORY 9 ROOM SFR W/LOFT

**CONSTRUCTION LENDING AGENCY:** I hereby affirm under penalty of perjury that there is a construction lending agency for the performance of the work for which this permit is issued (Sec. 3097, Civ. C).

Lender's Name \_\_\_\_\_ Lender's Address \_\_\_\_\_

**LICENSED CONTRACTORS DECLARATION:** I hereby affirm under penalty of perjury that I am licensed under provisions of Chapter 9 (commencing with section 7000) of Division 3 of the Business and Professions Code and my license is in full force and effect.

License Class B License Number 732348 Date 2/28/01 Contractor Signature [Signature]

**OWNER-BUILDER DECLARATION:** I hereby affirm under penalty of perjury that I am exempt from the contractors License Law for the following reason (Sec. 7031.5, Business and Professions Code): any city or county which requires a permit to construct, alter, improve, demolish, or repair any structure, prior to its issuance, also requires the applicant for such permit to file a signed statement that he or she is licensed pursuant to the provisions of the Contractors License Law (Chapter 9 (commencing with Section 7000) of Division 8 of the Business and Professions Code) or that he or she is exempt therefrom and the basis for the alleged exemption. Any violation of Section 7031.5 by any applicant for a permit subjects the applicant to a civil penalty of not more than five hundred dollars (\$500.00).

I, \_\_\_\_\_, as a owner of the property, or my employees with wages as their sole compensation, will do the work, and the structure is not intended or offered for sale (Sec. 7044, Business and Professional Code). The Contractors License Law does not apply to an owner of property who builds or improves thereon, and who does such work himself or herself or through his/her own employees, provided that such improvements are not intended or offered for sale. If, however, the building or improvement is sold within one year of completion, the owner-builder will have the burden of proving that he/she did not build or improve for the purpose of sale.

I, \_\_\_\_\_, as owner of the property, am exclusively contracting with licensed contractors to construct the project (Sec. 7044, Business and Professions Code). The Contractors License Law does not apply to an owner of property who builds or improves thereon, and who contracts for such projects with a contractor(s) licensed pursuant to the Contractors License Law.

I am exempt under Sec. \_\_\_\_\_ B & PC for this reason: \_\_\_\_\_

Date \_\_\_\_\_ Owner Signature \_\_\_\_\_

**IN ISSUING THIS BUILDING PERMIT,** the applicant represents, and the city relies on the representation of the applicant, that the applicant verified all measurements and locations shown on the application or accompanying drawings and that the improvement to be constructed does not violate any law or private agreement relating to permissible or prohibited locations for such improvements. This building permit does not authorize any illegal location of any improvement or the violation of any private agreement relating to location of improvements.

I certify that I have read this application and state that all information is correct. I agree to comply with all city and county ordinances and state laws relating to building construction and hereby authorize representative(s) of this city to enter upon the abovementioned property for inspection purposes.

Date 2-15-99 Applicant/Agent Signature [Signature]

**WORKER'S COMPENSATION DECLARATION:** I hereby affirm under penalty of perjury one of the following declarations:

\_\_\_\_\_ have and will maintain a certificate of consent to self-insure for workers' compensation as provided for by Section 3700 of the Labor Code, for the performance of work for which the permit is issued.

\_\_\_\_\_ have and will maintain workers' compensation insurance, as required by Section 3700 of the Labor Code, for the performance of the work for which this permit is issued. My workers' compensation insurance carrier and policy number are:

Carrier: CONTINENTAL CAS. INC Policy Number: WC166792277 Exp Date: 06/01/2000

This section need not be completed if the permit is for \$100 or less. I certify that in the performance of the work for which this permit is issued, I shall not employ any person in any manner so as to become subject to the workers' compensation laws of California and agree that if I should become subject to the workers' compensation provisions of Section 3700 of the Labor Code, I shall forthwith comply with those provisions.

Date 2-15-99 Applicant Signature [Signature]

**WARNING:** FAILURE TO SECURE WORKER'S COMPENSATION COVERAGE IS UNLAWFUL AND SHALL SUBJECT AN EMPLOYER TO CRIMINAL PENALTIES AND CIVIL FINES UP TO ONE HUNDRED THOUSAND DOLLARS (\$100,000) IN ADDITION TO THE COST OF COMPENSATION, DAMAGES AS PROVIDED FOR IN SECTION 3706 OF THE LABOR CODE, INTEREST AND ATTORNEY'S FEE.

**THIS PERMIT SHALL EXPIRE BY LIMITATION IF WORK IS NOT COMMENCED WITHIN 180 DAYS.**

4-22

# OMEGA PRODUCTS INTERNATIONAL, INC.

DIAMOND WALL INSULATING STUCCO SYSTEM

JOB ADDRESS:

101 West F. Homes

ICBO Report #4004

PLASTERING CONTRACTOR:

Stucco Works Inc.

Date of Job Completion

4-22-60

Name: STUCCO WORKS INC.

Address: 5900 WALKERHOUSE WAY

Telephone No: (916) 383-6699

Contractor Number of Diamond Wall System: 2175

This is to certify that the exterior coating system on the building exterior at the above address has been installed in accordance with the evaluation report specified above and the manufacturer's instructions.

Signature of authorized representative of plastering contractor

This installation card must be presented to the building inspector at the time of final inspection.

# CERTIFICATION OF INSULATION

ADDRESS OR TRACT

SACRAMENTO INSULATION CONTRACTORS

WINNCREST

LOT # 22

- P.O. BOX 854, WEST SACRAMENTO, CA 95691 LIC. #202026
- 1309 MELODY ROAD, MARYSVILLE, CA 95901 LIC. #202026
- P.O. BOX 9651, FRESNO, CA 93793-9651 LIC. #202026
- P.O. BOX 1631, RENO, NV 89505 LIC. #10675
- 3326 A PONDEROSA WAY, LAS VEGAS, NV 89118 LIC. #10675

GLENNMEIRE

DATE INSULATION COMPLETED  
4-13-00

WALLS

CEILING

FLOORS

( SQUARE FEET)

( SQUARE FEET)

( SQUARE FEET)

TYPE OF INSULATION

TYPE OF INSULATION

TYPE OF INSULATION

MATERIAL

FIBERGLASS

MATERIAL

FIBERGLASS

MATERIAL

FIBERGLASS

FORM

BATTS

FORM

BATTS & BLOW

FORM

BATTS

MANUFACTURER'S PRODUCT I D

MANUFACTURER'S PRODUCT I D

MANUFACTURER'S PRODUCT I D

MANUFACTURER

OCF

MANUFACTURER

OCF

BAGS

MANUFACTURER

OCF

R-VALUE  
INSTALLED

APPLIED  
THICKNESS

R-VALUE  
INSTALLED

APPLIED  
THICKNESS

MIN. INSTALLED  
WEIGHT PER  
SQUARE FOOT

R-VALUE  
INSTALLED

APPLIED  
THICKNESS

13  
19

3 5/8"  
5 1/2"

38

12 1/4"

KNEE WALLS IF R-VALUE IS OTHER THAN WALLS ABOVE

MATERIAL

FIBERGLASS

FORM

BATTS

R VALUE

MANUFACTURER

OCF

AIR INFILTRATION SEALANT

MATERIAL

FOAM

MANUFACTURER

W R GRACE

THIS IS TO CERTIFY THAT INSULATION AND/OR SEALANT HAS BEEN INSTALLED IN CONFORMANCE WITH APPLICABLE CODES, MATERIAL STANDARDS AND REGULATIONS.

SIGNATURE - INSULATION CONTRACTOR

*Bill Hardinger*

TITLE

MANAGER

DATE

4-14-00

SIGNATURE - GENERAL CONTRACTOR

*John A. ...*

TITLE

DATE

REMARKS

## RESIDENTIAL BUILDING PERMIT APPLICATION

New Construction    
  Addition    
  Remodels    
  Other

Project Address: 1445 MAYFIELD STREET     Assessor Parcel # 225-112-022

OWNER INFORMATION: LOT # 22

Legal Property Owner: <u>LENNAR RENAISSANCE</u>	Phone # <u>(916) 773-7471</u>
Owner Address: <u>2240 DOUGLAS BLVD.</u>	City <u>ROSEVILLE</u> State <u>CA</u> Zip <u>95661</u>

**CONTRACTOR INFORMATION:**

Contractor: <u>LENNAR RENAISSANCE</u>	Lic. # <u>732348</u>	Phone # <u>(916) 773-7471</u> Fax# <u>(916) 773-4086</u>
---------------------------------------	----------------------	----------------------------------------------------------

**PROJECT INFORMATION:**

Land Use Zone <u>R1A</u>	Occupancy Group <u>R3</u>	Construction Type <u>UM</u>	Fed Code <u>1A</u>
No. of stories: <u>2</u>	No. of rooms: <u>5</u>	Street width: _____	
1 <sup>st</sup> Floor Area <u>1252</u>	2 <sup>nd</sup> Floor Area <u>1114</u>	Basement _____	Roof Material <u>TILE</u>

AREA IN SQUARE FOOT OF:	EXISTING	NEW
Dwelling/Living	_____	<u>2366</u>
Garage/Storage	_____	<u>621</u>
Decks/Balconies	_____	<u>175</u>
Carports	_____	_____

SCOPE OF WORK: NEW CONSTRUCTION SFD MP 204 X

**FOR OFFICE USE ONLY:**

<input type="checkbox"/> Information above complete	<input type="checkbox"/> AR Flood Waiver required	<input type="checkbox"/> Planning Approval
<input type="checkbox"/> Violation files checked	<input type="checkbox"/> Flood Elevation Certificate Required	<input type="checkbox"/> Design Review Approval
<input type="checkbox"/> Standard setbacks	<input type="checkbox"/> Water Development Infill Area	<input type="checkbox"/> Special Fee Districts Apply : _____
<input type="checkbox"/> County Sewer	_____	

**NEW STRUCTURES & ADDITIONS**

❖ THE FOLLOWING MUST BE PROVIDED IN ORDER TO SUBMIT FOR PLAN REVIEW

- |                                                                                                                                              |                                                                                                                                                                                 |
|----------------------------------------------------------------------------------------------------------------------------------------------|---------------------------------------------------------------------------------------------------------------------------------------------------------------------------------|
| <input type="checkbox"/> 2 COMPLETE PLANS, LEGIBLE & DRAWN TO SCALE<br><input type="checkbox"/> 3 SETS IF PROJECT IS IN A DESIGN REVIEW AREA | ❖ Plans to include: site plan, floor plan, elevations, roof/ceiling plan, foundation and structural framing details, and structural calculations for non-conforming structures. |
| <input type="checkbox"/> Title 24 Energy Compliance documentation<br><input type="checkbox"/> Grading and Erosion Control Questionnaire      | <input type="checkbox"/> 11" x 17" copy of floor plan for County Assessor<br><input type="checkbox"/> Plan Review Fees                                                          |

Date: \_\_\_\_\_ Received by: (staff) \_\_\_\_\_

ACTIVITY/PERMIT # \_\_\_\_\_

Date of Request: \_\_\_\_\_

By: \_\_\_\_\_

**CITY OF SACRAMENTO DEVELOPMENT SERVICES DIVISION  
PLANNING AND ZONING INFORMATION REQUEST**

Project Address: 1731 Arden Way

Assessor's Parcel Number: 277-0160-066

Previous Use: \_\_\_\_\_

Description of Request/Proposed Use: CANOPY over ATM

Is This a Change of Use? \_\_\_\_\_

Zoning Designation: C2

Prior Applications for Project Site(P#, Z#, DRPB#): \_\_\_\_\_

Comments: \_\_\_\_\_

Are There Any Planning Issues?: (circle one) YES NO

\* Staff Site Plan Check Required? (Circle one) YES NO

\* Field Inspection Required? (Circle one) YES NO

\* Design Review/Preservation Required?: (Circle one) YES NO

Planning Review by/Date: [Signature]

4-25-00

A list of items that must be reviewed by Planning is provided on the reverse side of this form.

**MICROFILM AFTER FINAL**

**NOTES**

1. MEASUREMENTS ALONG CURVED LINES ARE ARC LENGTHS, U.O.N.

<b>LOT COVERAGE</b>
Lot Area: 5775 s.f.
Building: 1898 s.f.
Building/Lot Area: 33 %

<b>RETAINING WALL</b>
Height: _____
Length: _____
Distance From P.L.: _____

DRAWN BY: BCB	DATE: 6/22/99	CHKD BY: GRS	DATE: _____
---------------	---------------	--------------	-------------

**SYMBOLS**

- Drainage Inlet: [Symbol]
- Fire Hydrant: [Symbol]
- Street Light: [Symbol]
- Sewer: [Symbol]
- Sign: [Symbol]
- Water: [Symbol]
- Transformer Pad: [Symbol]

DRWG SCALE: 1" = 20'

CITY OF SACRAMENTO, CALIFORNIA  
NORTHPOINTE PARK VILLAGE No. 14  
A.P.N.: 225-112-022-000

**Home Site #22**

**Glenmere**  
a Northpointe Park Village Community

**Wincrest Homes**  
A Lennar Company

**1445 MAYFIELD STREET**

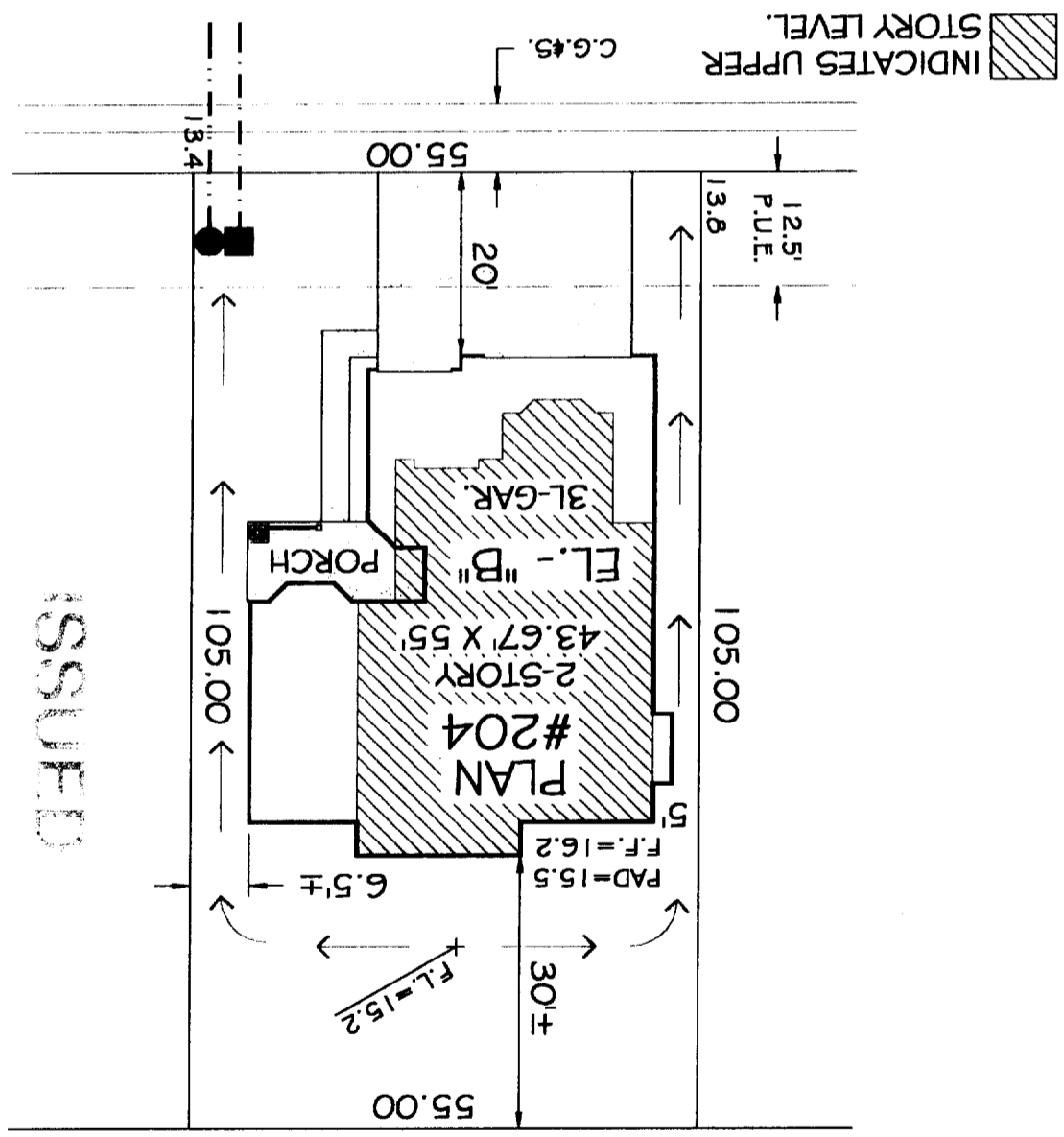

**ISSUED**

DATE: 6/22/99

PROJECT: 1445 MAYFIELD STREET

SCALE: 1" = 20'

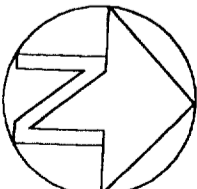

This set of plans and specifications shall be kept on the job at all times and the contractor shall be responsible for making any changes or corrections to the same without written permission from the Building Inspection Division. The approval of this plan and specification SHALL NOT be held to permit or approve the violation of any City Ordinance or State Law.



This Plot Plan is for the purpose of showing the house to be constructed on the lot and may not represent the final as-built configuration of the property or improvements thereon. Setbacks, other than minimum ordinance, are approximate only and must not be assumed to be precise.