

CITY OF SACRAMENTO  
1231 I Street, Sacramento, CA 95814

Permit No: 0100010  
Insp Area: 4

Site Address: 4241 RIVER SWAN LN SAC  
Parcel No: 225-1240-056 GATEWAY N 2 LOT 91

Sub-Type: NSFR  
Housing (Y/N): N

CONTRACTOR  
MARCHBROOK BUILDING CO  
PO BOX 7576  
STOCKTON CA 95267

OWNER

ARCHITECT

Nature of Work: NSFR MP3446 2 STORY 11 RMS

**CONSTRUCTION LENDING AGENCY:** I hereby affirm under penalty of perjury that there is a construction lending agency for the performance of the work for which this permit is issued (Sec. 3097, Civ. C).

Lender's Name \_\_\_\_\_ Lender's Address \_\_\_\_\_

**LICENSED CONTRACTORS DECLARATION:** I hereby affirm under penalty of perjury that I am licensed under provisions of Chapter 9 (commencing with section 7000) of Division 3 of the Business and Professions Code and my license is in full force and effect.

License Class B License Number 740353 Date 1/9/01 Contractor Signature Paul B...

**OWNER-BUILDER DECLARATION:** I hereby affirm under penalty of perjury that I am exempt from the contractors License Law for the following reason (Sec. 7031.5, Business and Professions Code, any city or county which requires a permit to construct, alter, improve, demolish, or repair any structure, prior to its issuance, also requires the applicant for such permit to file a signed statement that he or she is licensed pursuant to the provisions of the Contractors License Law (Chapter 9 (commencing with Section 7000) of Division 8 of the Business and Professions Code) or that he or she is exempt therefrom and the basis for the alleged exemption. Any violation of Section 7031.5 by any applicant for a permit subjects the applicant to a civil penalty of not more than five hundred dollars (\$500.00).

I, as a owner of the property, or my employees with wages as their sole compensation, will do the work, and the structure is not intended or offered for sale (Sec. 7044, Business and Professional Code. The Contractors License Law does not apply to an owner of property who builds or improves thereon, and who does such work himself or herself or through his/her own employees, provided that such improvements are not intended or offered for sale. If, however, the building or improvement is sold within one year of completion, the owner-builder will have the burden of proving that he/she did not build or improve for the purpose of sale.)

I, as owner of the property, am exclusively contracting with licensed contractors to construct the project (Sec. 7044, Business and Professions Code. The Contractors License Law does not apply to an owner of property who builds or improves thereon, and who contracts for such projects with a contractor(s) licensed pursuant to the Contractors License Law).

I am exempt under Sec. \_\_\_\_\_ B & PC for this reason: \_\_\_\_\_

Date \_\_\_\_\_ Owner Signature \_\_\_\_\_

PAID  
CITY OF SACRAMENTO  
JAN 09 2001  
NEIGHBORHOODS PLANNING  
AND DEVELOPMENT SERVICES

**IN ISSUING THIS BUILDING PERMIT,** the applicant represents, and the city relies on the representation of the applicant that the applicant verified all measurements and locations shown on the application or accompanying drawings and that the improvement to be constructed does not violate any law or private agreement relating to permissible or prohibited locations for such improvements. This building permit does not authorize any illegal location of any improvement or the violation of any private agreement relating to location of improvements.

I certify that I have read this application and state that all information is correct. I agree to comply with all city ordinances and state laws relating to building construction and hereby authorize representative(s) of this city to enter upon the above mentioned property for inspection purposes.

Date 1/9/01 Applicant-Agent Signature Paul B...

**WORKER'S COMPENSATION DECLARATION:** I hereby affirm under penalty of perjury one of the following declarations:

I have and will maintain a certificate of consent to self-insure for workers' compensation as provided for by Section 3700 of the Labor Code, for the performance of work for which the permit is issued

B I have and will maintain workers' compensation insurance, as required by Section 3700 of the Labor Code, for the performance of the work for which this permit is issued. My workers' compensation insurance carrier and policy number are:

Carrier SAFECO INSURANCE CO OF AMERICA Policy Number WC2342690D Exp Date 07/01/2001

(This section need not be completed if the permit is for \$100 or less) I certify that in the performance of the work for which this permit is issued, I shall not employ any person in any manner so as to become subject to the workers' compensation laws of California and agree that if I should become subject to the workers' compensation provisions of Section 3700 of the Labor Code, I shall forthwith comply with those provisions.

Date 1/9/01 Applicant Signature Paul B...

WARNING: FAILURE TO SECURE WORKER'S COMPENSATION COVERAGE IS UNLAWFUL AND SHALL SUBJECT AN EMPLOYER TO CRIMINAL PENALTIES AND CIVIL FINES UP TO ONE HUNDRED THOUSAND DOLLARS (\$100,000) IN ADDITION TO THE COST OF COMPENSATION, DAMAGES AS PROVIDED FOR IN SECTION 3706 OF THE LABOR CODE, INTEREST AND ATTORNEY'S FEE.

THIS PERMIT SHALL EXPIRE BY LIMITATION IF WORK IS NOT COMMENCED WITHIN 180 DAYS.

**RESIDENTIAL BUILDING PERMIT APPLICATION**

New Construction     Addition     Remodels     Other

Project Address 4241 Riverwood Lane

Assessor Parcel # 225-1240-0576

OWNER INFORMATION: 16991-MP 3444

Legal Property Owner	Sundance Lake LLC, A Delaware Limited Liability Co.	Phone #	(209)473-6000
Owner Address	P.O. Box 7576	City	Stockton State CA Zip 95267

**CONTRACTOR INFORMATION:**

Contractor: <u>Marchbrook Building Co Lic. # 740353</u>	Phone # <u>(209)473-6000</u>	Fax # <u>(209)473-6044</u>
---	------------------------------	----------------------------

**PROJECT INFORMATION:**

Land Use Zone _____	Occupancy Group _____	Construction Type _____	Fed Code _____
No. of stories: <u>2</u>	No. of rooms <u>11</u>	Street width: _____	
1 <sup>st</sup> Floor Area <u>1593</u>	2 <sup>nd</sup> Floor Area <u>1853</u>	Basement _____	Roof Material _____
<b>AREA IN SQUARE FOOT OF:</b>	<b>EXISTING</b>	<b>NEW</b>	
Dwelling/Living	<u>3246</u>	_____	
Garage/Storage	<u>1632</u>	_____	
Decks/Balconies	<u>144</u>	_____	
Carports	<u>N/A</u>	_____	
<b>SCOPE OF WORK:</b> <u>SFD</u>			

**FOR OFFICE USE ONLY**

<input type="checkbox"/> Information above complete	<input type="checkbox"/> AR Flood Waiver required	<input type="checkbox"/> Planning Approval
<input type="checkbox"/> Violation files checked	<input type="checkbox"/> Flood Elevation Certificate Required	<input type="checkbox"/> Design Review Approval
<input type="checkbox"/> Standard setbacks	<input type="checkbox"/> Water Development Infill Area	<input type="checkbox"/> Special Fee Districts Apply : _____
<input type="checkbox"/> County Sewer		
<b>NEW STRUCTURES &amp; ADDITIONS</b>		
❖ THE FOLLOWING MUST BE PROVIDED IN ORDER TO SUBMIT FOR PLAN REVIEW		
<input type="checkbox"/> 2 COMPLETE PLANS, LEGIBLE & DRAWN TO SCALE	❖ Plans to include: site plan, floor plan, elevations, roof/ceiling plan, foundation and structural framing details, and structural calculations for non-conforming structures.	
<input type="checkbox"/> 3 SETS IF PROJECT IS IN A DESIGN REVIEW AREA		
<input type="checkbox"/> Title 24 Energy Compliance documentation	<input type="checkbox"/> 11" x 17" copy of floor plan for County Assessor	
<input type="checkbox"/> Grading and Erosion Control Questionnaire	<input type="checkbox"/> Plan Review Fees	

Date \_\_\_\_\_

Received by: (staff) \_\_\_\_\_

ACTIVITY/PERMIT # _____
-------------------------

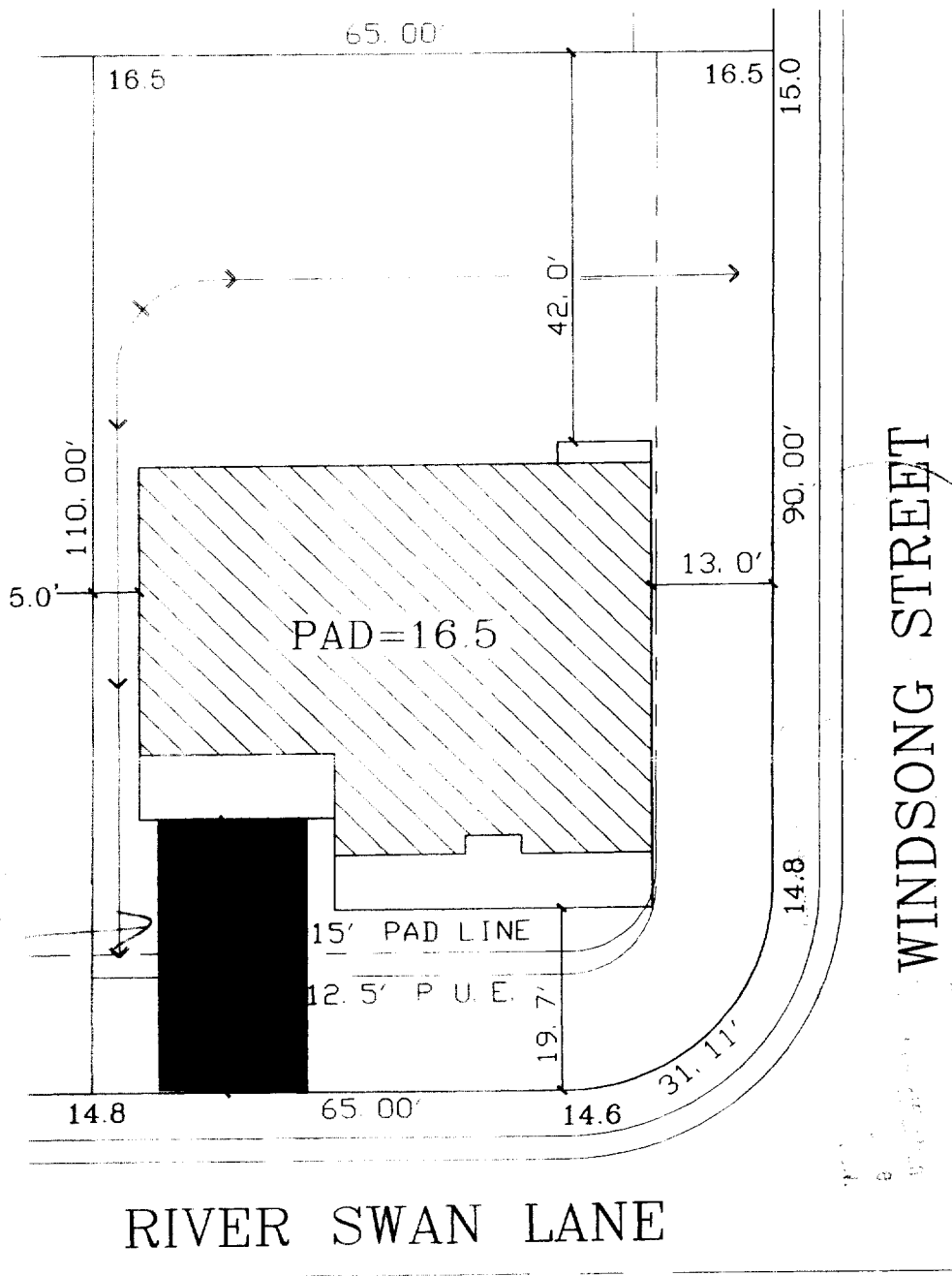

LOT 91  
 PLAN 4D LEFT  
 A.P.N.:  
 ADDRESS: RIVER SWAN LANE  
 LOT AREA: 8,072 SF  
 LOT COVERAGE: 30%

**The Splink Corporation**  
 2590 VENTURE OAKS WAY  
 SACRAMENTO, CA. 95833  
 H:(916)925-5550 FAX:(916)921-9274

**MARCHBROOK BUILDING COMPANY**  
 P.O. Box 7576  
 Stockton, Ca 95267  
 office: (209) 473-6053  
 fax: (209) 951-0684

**GATEWAY NORTH VILLAGE 2**  
 City of Sacramento, California  
 Scale: 1"=20'  
 December 13, 2000