

CITY OF SACRAMENTO
1231 I Street, Sacramento, CA 95814

Permit No: 0302127
Insp Area: 2
Thos Bros: 337-C4

Site Address: 7800 AMHERST ST SAC
Parcel No: 052-0180-019 STEAMBOAT BEND LOT 19

Sub-Type: NSFR
Housing (Y/N): N

CONTRACTOR
HOFMANN CONSTRUCTION
PO BOX 907
CONCORD CA 94522

OWNER

ARCHITECT

Nature of Work: NSFR MP2309 10 RMS 2 STORY

CONSTRUCTION LENDING AGENCY : I hereby affirm under penalty of perjury that there is a construction lending agency for the performance of the work for which this permit is issued (Sec. 3097, Civ. C).

Lender's Name _____ Lender's Address _____

LICENSED CONTRACTORS DECLARATION: I hereby affirm under penalty of perjury that I am licensed under provisions of Chapter 9 (commencing with section 7000) of Division 3 of the Business and Professions Code and my license is in full force and effect.

License Class B1 License Number 189167 Date 5-27-03 Contractor Signature A. Hester Walters

OWNER-BUILDER DECLARATION: I hereby affirm under penalty of perjury that I am exempt from the contractors License Law for the following reason (Sec. 7031.5, Business and Professions Code; any city or county which requires a permit to construct, alter, improve, demolish, or repair any structure, prior to its issuance, also requires the applicant for such permit to file a signed statement that he or she is licensed pursuant to the provisions of the Contractors License Law (Chapter 9 (commencing with Section 7000) of Division 8 of the Business and Professions Code) or that he or she is exempt therefrom and the basis for the alleged exemption. Any violation of Section 7031.5 by any applicant for a permit subjects the applicant to a civil penalty of not more than five hundred dollars (\$500.00);

I, as a owner of the property, or my employees with wages as their sole compensation, will do the work, and the structure is not intended or offered for sale (Sec. 7044, Business and Professional Code: The Contractors License Law does not apply to an owner of property who builds or improves thereon, and who does such work himself or herself or through his/her own employees, provided that such improvements are not intended or offered for sale. If, however, the building or improvement is sold within one year of completion, the owner-builder will have the burden of proving that he/she did not build or improve for the purpose of sale.)

I, as owner of the property, am exclusively contracting with licensed contractors to construct the project (Sec. 7044, Business and Professions Code: The Contractors License Law does not apply to an owner of property who builds or improves thereon, and who contracts for such projects with a contractor(s) licensed pursuant to the Contractors License Law).

I am exempt under Sec. _____ B & PC for this reason: _____

Date _____ Owner Signature _____

IN ISSUING THIS BUILDING PERMIT, the applicant represents, and the city relies on the representation of the applicant, that the applicant verified all measurements and locations shown on the application or accompanying drawings and that the improvement to be constructed does not violate any law or private agreement relating to permissible or prohibited locations for such improvements. This building permit does not authorize any illegal location of any improvement or the violation of any private agreement relating to location of improvements.

I certify that I have read this application and state that all information is correct. I agree to comply with all city and county ordinances and state laws relating to building construction and hereby authorize representative(s) of this city to enter upon the abovementioned property for inspection purposes.

Date 5-27-03 Applicant/Agent Signature A. Hester Walters

WORKER'S COMPENSATION DECLARATION: I hereby affirm under penalty of perjury one of the following declarations:

I have and will maintain a certificate of consent to self-insure for workers' compensation as provided for by Section 3700 of the Labor Code, for the performance of work for which the permit is issued.

I have and will maintain workers' compensation insurance, as required by Section 3700 of the Labor Code, for the performance of the work for which this permit is issued. My workers' compensation insurance carrier and policy number are:

Carrier STATE FUND Policy Number 1633130 Exp Date 04/01/2003

(This section need not be completed if the permit is for \$100 or less) I certify that in the performance of the work for which this permit is issued, I shall not employ any person in any manner so as to become subject to the workers' compensation laws of California and agree that if I should become subject to the workers' compensation provisions of Section 3700 of the Labor Code, I shall forthwith comply with those provisions.

Date 5-27-03 Applicant Signature A. Hester Walters

WARNING: FAILURE TO SECURE WORKER'S COMPENSATION COVERAGE IS UNLAWFUL AND SHALL SUBJECT AN EMPLOYER TO CRIMINAL PENALTIES AND CIVIL FINES UP TO ONE HUNDRED THOUSAND DOLLARS (\$100,000) IN ADDITION TO THE COST OF COMPENSATION, DAMAGES AS PROVIDED FOR IN SECTION 3706 OF THE LABOR CODE, INTEREST AND ATTORNEY'S FEE.

THIS PERMIT SHALL EXPIRE BY LIMITATION IF WORK IS NOT COMMENCED WITHIN 180 DAYS.

RESIDENTIAL SUBDIVISION BUILDING PERMIT APPLICATION

6

Project Address: 7800 Amherst Street

Assessor Parcel # 052-0180-019-0000

Lot Number: 19

Subdivision Steamboat Bend Unit 1

OWNER INFORMATION:

Legal Property Owner: <u>The Hofmann Company</u>	Phone# <u>(925) 682-4830</u>
Owner Address: <u>PO Box 907</u> City <u>Concord</u>	State <u>CA</u> Zip <u>94522</u>

CONTRACTOR INFORMATION:

Contractor: <u>Hofmann Construction Lic. # 189167</u>	Phone# <u>(925) 682-4830</u> Fax <u>(925) 603-9453</u>
---	--

PROJECT INFORMATION:

Land Use Zone <u>R1A</u>	Occupancy Group <u>R3</u>	Construction Type <u>VN</u>	Fed Code <u>1A</u>
No. of Stories: <u>2</u>	No. of Rooms: <u>11</u>	Street Width: <u>56</u>	
1 st Floor Area <u>1041</u>	2 nd Floor Area <u>1227</u>	Basement <u>0</u>	Roof Material <u>Composition Shingle</u>
AREA IN SQUARE FOOT OF:			0302127
Dwelling/Living	<u>2271</u>		
Garage/Storage	<u>520</u>		
Decks/Balconies	<u>43</u>		
Carports	<u>0</u>		
SCOPE OF WORK: <u>Single family residence with attached garage</u> <u>Master Plan Check #0201354</u>			

FOR OFFICE USE ONLY

<input type="checkbox"/> Information Above Complete	<input type="checkbox"/> AR Flood Waiver Required	<input type="checkbox"/> Planning Approval
<input type="checkbox"/> Violation Files Checked	<input type="checkbox"/> Flood Elevation Certificate Required	<input type="checkbox"/> Design Review Approval
<input type="checkbox"/> Standard Setbacks	<input type="checkbox"/> Water Development Infill Area	<input type="checkbox"/> Special Fee Districts Apply:
<input type="checkbox"/> County Sewer		
THE FOLLOWING MUST BE PROVIDED IN ORDER TO SUBMIT FOR PERMIT		
<input checked="" type="checkbox"/> 2 COMPLETE PLOT PLANS, LEGIBLE & DRAWN TO SCALE		
<input checked="" type="checkbox"/> 11 X 17 COPY OF FLOOR PLAN WITH FOLLOWING INFORMATION		
a) Assessor's Parcel Number	c) Owners Name	
b) New Floor Area	d) Project Address	

CERTIFICATION OF INSULATION

SACRAMENTO BUILDING PRODUCTS

Hoffman
7800 Amherst
Steambath

- P.O. BOX 854, WEST SACRAMENTO, CA 95691 LIC. #202026
- 1309 MELBOY ROAD, MARYSVILLE, CA 95901 LIC. #202026
- P.O. BOX 9851, FRESNO, CA 93793-9851 LIC. #202026
- P.O. BOX 1631, RENO, NV 89505 LIC. #10675
- 3526 A PONDEROSA WAY, LAS VEGAS, NV 89118 LIC. #10675

DATE INSULATION COMPLETED _____

(SQUARE FEET)			(SQUARE FEET)			(SQUARE FEET)			
MATERIAL FIBERGLASS			MATERIAL FIBERGLASS			MATERIAL FIBERGLASS			
FORM BATTS			FORM BATTS & BLOW			FORM BATTS			
MANUFACTURER'S PRODUCT I.D.			MANUFACTURER'S PRODUCT I.D.			MANUFACTURER'S PRODUCT I.D.			
CT	OC	JM	CT	OC	JM	CT	OC	JM	
R-VALUE	APPLIED		R-VALUE	APPLIED		MIN. INSTALLED	R-VALUE	APPLIED	
13	3 1/2		38	12 14 3/4					

MATERIAL	FORM	R-VALUE	MANUFACTURER		
FIBERGLASS	BATTS		CT	OC	JM
Foam			FIBEL	HANDY FOAM	

SIGNATURE - INSULATION CONTRACTOR <i>J.C.</i>	TITLE MANAGER	DATE
SIGNATURE - GENERAL CONTRACTOR	TITLE	DATE

REMARKS

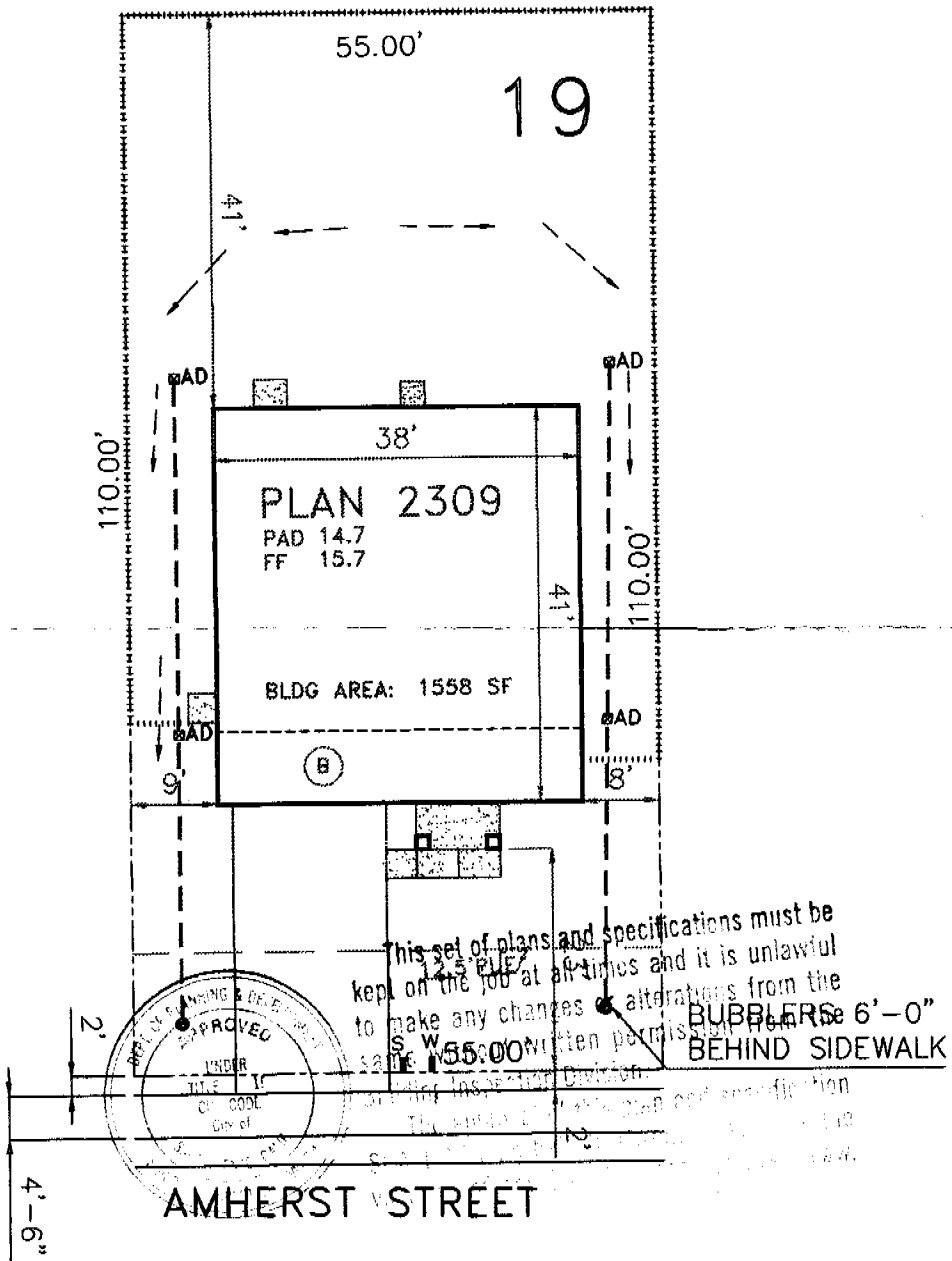

ADDRESS: 7800 AMHERST ST.
SACRAMENTO, CA. 95832-1176

LOT AREA: 6,050 SF
BLDG COVERAGE: 1,558.00 SF
% LOT COVERAGE: 25.75%

6/14/02
PLOT PLAN
SCALE: 1"=20'-0" STEAMBOAT BEND
LOT 19 SUB UNIT No. 1
STEAMBOAT BEND
SACRAMENTO, CA.
HOFMANN CONST. CO.