

CITY OF SACRAMENTO
1231 I Street, Sacramento, CA 95814

Permit No: 0210949

Insp Area: 4

Thos Bros:

Sub-Type: NSFR

Housing (Y/N): N

Site Address: 2216 CITRINE WY SAC

Parcel No: 225-1340-003

NATOMAS CROSSING 19 LOT 3

CONTRACTOR

KIMBALL HILL HOMES
10535 EAST STOCKTON BL. STE. K
ELK GROVE CA. 95624

OWNER

ARCHITECT

Nature of Work: NATOMAS CROSSING MP3161 2 STORY 10 ROOM SFR

CONSTRUCTION LENDING AGENCY : I hereby affirm under penalty of perjury that there is a construction lending agency for the performance of the work for which this permit is issued (Sec. 3097, Civ. C).

Lender's Name _____ Lender's Address _____

LICENSED CONTRACTORS DECLARATION: I hereby affirm under penalty of perjury that I am licensed under provisions of Chapter 9 (commencing with section 7000) of Division 3 of the Business and Professions Code and my license is in full force and effect.

License Class B License Number 701803 Date 9/3/02 Contractor Signature D. Collins

OWNER-BUILDER DECLARATION: I hereby affirm under penalty of perjury that I am exempt from the contractors License Law for the following reason (Sec. 7031.5, Business and Professions Code; any city or county which requires a permit to construct, alter, improve, demolish, or repair any structure, prior to its issuance, also requires the applicant for such permit to file a signed statement that he or she is licensed pursuant to the provisions of the Contractors License Law (Chapter 9 (commencing with Section 7000) of Division 8 of the Business and Professions Code) or that he or she is exempt therefrom and the basis for the alleged exemption. Any violation of Section 7031.5 by any applicant for a permit subjects the applicant to a civil penalty of not more than five hundred dollars (\$500.00);

I, as a owner of the property, or my employees with wages as their sole compensation, will do the work, and the structure is not intended or offered for sale (Sec. 7044, Business and Professional Code: The Contractors License Law does not apply to an owner of property who builds or improves thereon, and who does such work himself or herself or through his/her own employees, provided that such improvements are not intended or offered for sale. If, however, the building or improvement is sold within one year of completion, the owner-builder will have the burden of proving that he/she did not build or improve for the purpose of sale.)

I, as owner of the property, am exclusively contracting with licensed contractors to construct the project (Sec. 7044, Business and Professions Code: The Contractors License Law does not apply to an owner of property who builds or improves thereon, and who contracts for such projects with a contractor(s) licensed pursuant to the Contractors License Law).

I am exempt under Sec. _____ B & PC for this reason: _____

Date _____ Owner Signature _____

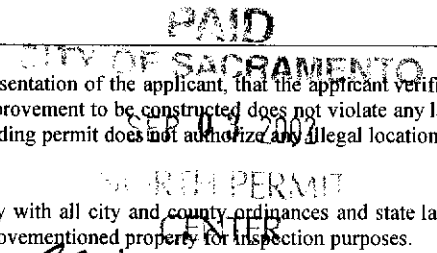

IN ISSUING THIS BUILDING PERMIT, the applicant represents, and the city relies on the representation of the applicant, that the applicant verified all measurements and locations shown on the application or accompanying drawings and that the improvement to be constructed does not violate any law or private agreement relating to permissible or prohibited locations for such improvements. This building permit does not authorize any illegal location of any improvement or the violation of any private agreement relating to location of improvements.

I certify that I have read this application and state that all information is correct. I agree to comply with all city and county ordinances and state laws relating to building construction and hereby authorize representative(s) of this city to enter upon the abovementioned property for inspection purposes.

Date 9/3/02 Applicant/Agent Signature D. Collins

WORKER'S COMPENSATION DECLARATION: I hereby affirm under penalty of perjury one of the following declarations:

I have and will maintain a certificate of consent to self-insure for workers' compensation as provided for by Section 3700 of the Labor Code, for the performance of work for which the permit is issued.

I have and will maintain workers' compensation insurance, as required by Section 3700 of the Labor Code, for the performance of the work for which this permit is issued. My workers' compensation insurance carrier and policy number are:

Carrier AMERICAN SAFETY RRG, INC Policy Number WC347274800 Exp Date 10/01/2002

(This section need not be completed if the permit is for \$100 or less) I certify that in the performance of the work for which this permit is issued, I shall not employ any person in any manner so as to become subject to the workers' compensation laws of California and agree that if I should become subject to the workers' compensation provisions of Section 3700 of the Labor Code, I shall forthwith comply with those provisions.

Date 9/3/02 Applicant Signature D. Collins

WARNING: FAILURE TO SECURE WORKER'S COMPENSATION COVERAGE IS UNLAWFUL AND SHALL SUBJECT AN EMPLOYER TO CRIMINAL PENALTIES AND CIVIL FINES UP TO ONE HUNDRED THOUSAND DOLLARS (\$100,000) IN ADDITION TO THE COST OF COMPENSATION, DAMAGES AS PROVIDED FOR IN SECTION 3706 OF THE LABOR CODE, INTEREST AND ATTORNEY'S FEE.

THIS PERMIT SHALL EXPIRE BY LIMITATION IF WORK IS NOT COMMENCED WITHIN 180 DAYS.

RESIDENTIAL BUILDING PERMIT APPLICATION

New Construction Addition Remodels Other

Project Address: 2216 Citrus Way Assessor Parcel # 225-1340-003

OWNER INFORMATION:

Lot 3

Legal Property Owner: Kimball Hill Homes Phone # (916) 714-1153
Owner Address: 10535 East Stockton Blvd City Elk Grove State Ca. Zip 95624
suite K

CONTRACTOR INFORMATION:

Natomas Crossing Village #19

Contractor: Kimball Hill Homes Lic. # 701803 Phone # 714-1153 Fax # 714-1425

PROJECT INFORMATION:

Land Use Zone R-14 Occupancy Group R-3 Construction Type VN Fed Code 1A

No. of stories: 2 No. of rooms: 10 Street width: _____

1st Floor Area 1620 2nd Floor Area 1541 Basement _____ Roof Material _____

AREA IN SQUARE FOOT OF:

EXISTING NEW

Dwelling/Living	_____	<u>3161</u>	<u>0210949</u>
Garage/Storage	_____	<u>653</u>	<u>\$208,753.15</u>
Decks/Balconies	_____	<u>316</u>	
Carports	_____	_____	

SCOPE OF WORK: _____

FOR OFFICE USE ONLY

- Information above complete
- Violation files checked
- Standard setbacks
- County Sewer
- AR Flood Waiver required
- Flood Elevation Certificate Required
- Water Development Infill Area
- Planning Approval
- Design Review Approval
- Special Fee Districts Apply: _____

NEW STRUCTURES & ADDITIONS

THE FOLLOWING MUST BE PROVIDED IN ORDER TO SUBMIT FOR PLAN REVIEW

- 2 COMPLETE PLANS, LEGIBLE & DRAWN TO SCALE
 - 3 SETS IF PROJECT IS IN A DESIGN REVIEW AREA
 - Title 24 Energy Compliance documentation
 - Grading and Erosion Control Questionnaire
 - 11' x 17" copy of floor plan for County Assessor
 - Plan Review Fees
- Plans to include: site plan, floor plan, elevations, roof/ceiling plan, foundation and structural framing details, and structural calculations for non-conforming structures.

Date: _____

Received by: (staff) _____



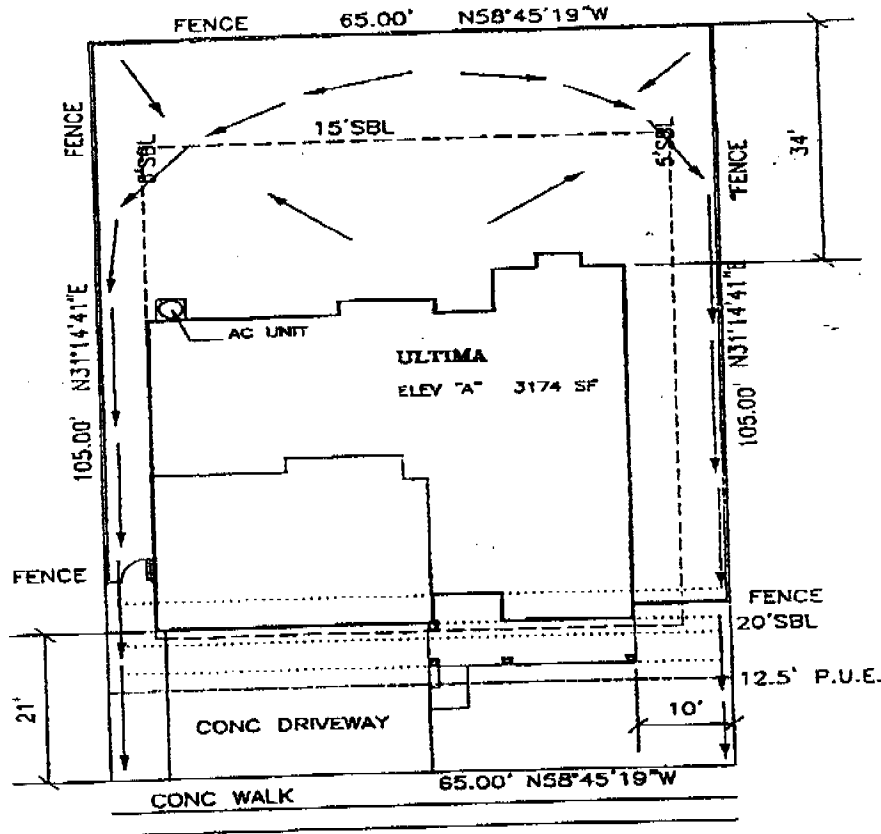

CITRINE WAY

This set of plans and specifications shall govern over all other plans and specifications for this project.



BLOOM
Architectural
Developments
Incorporated
 4437 Kenneth Avenue
 Fair Oaks, CA 95628
 (916)881-1553
 (916)967-3011 Fax

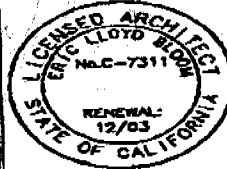

Plot Plan Disclosure This plot plan approximates a general representation of lot dimensions, easements, fence and home placement, etc. This illustration is not a condition of Kimball Hill Homes sales agreement. The actual placement and measurements demonstrated on this diagram are subject to change without notice.

Signature

KHH California, Inc. (916)714-1153
 10535 E. Stockton Blvd. Ste. K, Elk Grove, CA 95758



Job# 1642 03 **Plan#** 3161
Date May 03 02 **Draft** 1
Plan ULTIMA **Elev** A
Project Natomas Crossing
Lot 03 **Unit** 19
Address 2216 Citrine Way
City Sacramento **State** CA
APN _____ -0000

PLOT PLAN
Scale 1"=20'