

CITY OF SACRAMENTO

1231 I Street, Sacramento, CA 95814

Permit No: 0610740

Insp Area: 4

Site Address: 1430 H ST SAC

Parcel No:

PAID
CITY OF SACRAMENTO Sub-Type: REM

Housing (Y/N) JUL 18 2006

Thos Bros:

N

N

CONTRACTOR
HAWTHORNE CONSTR.
11000 OLSON DR.
STE. 125 95670

OWNER

NEIGHBORHOODS PLANNING
AND DEVELOPMENT SERVICES

ARCHITECT

Nature of Work: ADD 1 30AMP/208V SINGLE PHASE RECEPTACLE & 1 15AMP DEDICATED RECEPTACLE (FOR REFRIGERATOR & WARMER)

CONSTRUCTION LENDING AGENCY: I hereby affirm under penalty of perjury that there is a construction lending agency for the performance of the work for which this permit is issued (Sec. 3097, Civ. C).

Lender's Name _____ Lender's Address _____

LICENSED CONTRACTORS DECLARATION: I hereby affirm under penalty of perjury that I am licensed under provisions of Chapter 9 (commencing with section 7000) of Division 3 of the Business and Professions Code and my license is in full force and effect.

License Class B License Number 740135 Date 7-18-06 Contractor Signature [Signature]

OWNER-BUILDER DECLARATION: I hereby affirm under penalty of perjury that I am exempt from the contractors License Law for the following reason (Sec. 7031.5, Business and Professions Code; any city or county which requires a permit to construct, alter, improve, demolish, or repair any structure, prior to its issuance, also requires the applicant for such permit to file a signed statement that he or she is licensed pursuant to the provisions of the Contractors License Law (Chapter 9 (commencing with Section 7000) of Division 8 of the Business and Professions Code) or that he or she is exempt therefrom and the basis for the alleged exemption. Any violation of Section 7031.5 by any applicant for a permit subjects the applicant to a civil penalty of not more than five hundred dollars (\$500.00);

I, as a owner of the property, or my employees with wages as their sole compensation, will do the work, and the structure is not intended or offered for sale (Sec. 7044, Business and Professional Code: The Contractors License Law does not apply to an owner of property who builds or improves thereon, and who does such work himself or herself or through his/her own employees, provided that such improvements are not intended or offered for sale. If, however, the building or improvement is sold within one year of completion, the owner-builder will have the burden of proving that he/she did not build or improve for the purpose of sale.)

I, as owner of the property, am exclusively contracting with licensed contractors to construct the project (Sec. 7044, Business and Professions Code: The Contractors License Law does not apply to an owner of property who builds or improves thereon, and who contracts for such projects with a contractor(s) licensed pursuant to the Contractors License Law).

I am exempt under Sec. _____ B & PC for this reason: _____

Date _____ Owner Signature _____

IN ISSUING THIS BUILDING PERMIT, the applicant represents, and the city relies on the representation of the applicant, that the applicant verified all measurements and locations shown on the application or accompanying drawings and that the improvement to be constructed does not violate any law or private agreement relating to permissible or prohibited locations for such improvements. This building permit does not authorize any illegal location of any improvement or the violation of any private agreement relating to location of improvements.

I certify that I have read this application and state that all information is correct. I agree to comply with all city and county ordinances and state laws relating to building construction and hereby authorize representative(s) of this city to enter upon the abovementioned property for inspection purposes.

Date 7-18-06 Applicant/Agent Signature [Signature]

WORKER'S COMPENSATION DECLARATION: I hereby affirm under penalty of perjury one of the following declarations:
I have and will maintain a certificate of consent to self-insure for workers' compensation as provided for by Section 3700 of the Labor Code, for the performance of work for which the permit is issued.

I have and will maintain workers' compensation insurance, as required by Section 3700 of the Labor Code, for the performance of the work for which this permit is issued. My workers' compensation insurance carrier and policy number are:

Carrier STATE FUND Policy Number 713-0011841 Exp Date 10/01/2006

(This section need not be completed if the permit is for \$100 or less) I certify that in the performance of the work for which this permit is issued, I shall not employ any person in any manner so as to become subject to the workers' compensation laws of California and agree that if I should become subject to the workers' compensation provisions of Section 3700 of the Labor Code, I shall forthwith comply with those provisions.

Date 7-18-06 Applicant Signature [Signature]

WARNING: FAILURE TO SECURE WORKER'S COMPENSATION COVERAGE IS UNLAWFUL AND SHALL SUBJECT AN EMPLOYER TO CRIMINAL PENALTIES AND CIVIL FINES UP TO ONE HUNDRED THOUSAND DOLLARS (\$100,000) IN ADDITION TO THE COST OF COMPENSATION, DAMAGES AS PROVIDED FOR IN SECTION 3706 OF THE LABOR CODE, INTEREST AND ATTORNEY'S FEE.

THIS PERMIT SHALL EXPIRE BY LIMITATION IF WORK IS NOT COMMENCED WITHIN 180 DAYS.

APPLICATION FOR COMMERCIAL BUILDING PERMIT

CITY OF SACRAMENTO
Development Services Department - Building Division

New City Hall
915 I Street, 3rd floor
Sacramento, CA 95834
Fax: 916-808-1901

North Permit Center
2101 Arena Blvd., Suite 200
Sacramento, CA 95834
Fax: 916-808-8370

ACTIVITY # 0610740	Insp. Area 4
------------------------------	------------------------

Applicant **MUST** complete ALL Unshaded areas

ADDRESS 805 14th Street, Sacramento 95815 Suite _____
PARCEL # 1430 H. ST.

CONTACT		LICENSED CONTRACTOR Lic No. # 740135	
Name <u>Mike Chilimidos</u>		Name <u>Hawthorn Construction, INC</u>	
Street Address <u>11000 Olson Drive, Ste. 125</u>		Address <u>11000 Olson Drive, Ste. 125</u>	
City/State/Zip <u>Rancho Cordova, CA 95670</u>		City/State/Zip <u>Rancho Cordova, CA 95670</u>	
Phone <u>(916) 425-1577</u> FAX <u>(916) 852-9822</u>		Phone <u>(916) 425-1577</u> FAX <u>(916) 852-9822</u>	
E-mail: <u>michaelchilimidos@yahoo.com</u>		E-mail: <u>michaelchilimidos@yahoo.com</u>	
ARCHITECT/ENGINEER		OWNER	
Name <u>Lagomarsino Electric Co.</u>		Name <u>Starbucks Coffee Company</u>	
Address <u>P.O. Box 1415</u>		Address <u>2401 Utah Avenue, South</u>	
City/State/Zip <u>Carmichael, CA 95609</u>		City/State/Zip <u>Seattle, Washington 98134</u>	
Phone <u>(916) 9447027</u> FAX <u>(916) 9447028</u>		Phone <u>(206) 318-1575</u> FAX _____	
E-mail: _____		E-mail: _____	

→ Will permittee have any employees on the jobsite? No Yes → **INSURANCE CO:** State Fund
→ **WORKER'S COMPENSATION POLICY #** 0011841-2005 **EXPIRATION DATE:** 10/1/06

NATURE OF WORK IN DETAIL: Add one 30 AMP/208V single phase receptacle and one 15 AMP dedicated receptacle

OCCUPANT/TENANT: Starbucks Coffee **VALUATION:** \$ 1550.00

FLOOD STATUS						S.C.A.T.				
JOB DESCRIPTION		BLDG <input type="checkbox"/>	SHELL <input type="checkbox"/>	APT <input type="checkbox"/>	TI () <input type="checkbox"/>	REM () <input type="checkbox"/>	SW <input type="checkbox"/>	FIRE <input type="checkbox"/>	ADD <input type="checkbox"/>	OTHER <input checked="" type="checkbox"/> Misc. Elec.
INSPECTION DISCIPLINES		BLDG	MECH	PLUMB	XX ELEC	SITE	FIRE			
# Stories	1 st flr Area.	Total Area	Use Zone	Occp Group	Const type	Fire Req. Y / N		Fed Code	Vio. File	
						SPR	ALARM		PW	UTIL
B	L	P	M	E	F	S		D		

COMMENTS:

REGIONAL SANITATION FEES? Yes No **HEALTH DEPARTMENT?** Yes No
WATER FLOW TEST FOR NEW BUILDINGS OR ADDITIONS? Yes No

PANEL A EXISTING				400 AMP BUS ON 400 A BKR			
120/208 V 3PH 4W				WITH 200A BKR PNL B			
LOAD	CB	KVA	N0	N0	KVA	CB	LOAD
TELE DATA PLUG	20/1	.54	1	2		20/1	SPARE
TELE DATA PLUG	20/1	.54	3	4		20/1	SPARE
RECEPTICALS	20/1	1.44	5	6		20/1	SPARE
TELE DATA PLUG	20/1	.54	7	8		20/1	SPARE
TELE DATA PLUG	20/1	.54	9	10		20/1	SPARE
TELE DATA PLUG	20/1	.54	11	12		20/1	SPARE
LITES	20/1	1.3	13	14		20/1	SPARE
LITES	20/1	1.2	15	16		20/1	SPARE
SPARE	20/1		17	18		20/1	SPARE
LITES	20/1	.72	19	20	5.0	30	WTR HTR
SPARE	20/1		21	22	5.0	/	
LITES	20/1	.72	23	24	5.0	3	
LITES	20/1	.54	25	26	3.12	40	AC #1
LITES	20/1	.54	27	28	3.12	/	
NITE LITES	20/1	.23	29	30	3.12	3	
SPARE	20/1		31	32	3.36	40	AC#2
SPARE	20/1		33	34	3.36	/	
RECEPTICALS	20/1	1.0	35	36	3.36	3	
RECEPTICALS	20/1	1.2	37	38	3.36	40	AC#3
SPARE	20/1		39	40	3.36	/	
SPARE	20/1		41	42	3.36	3	

56.11 KVA = 155.9 AMPS

ISSUED
City of Sacramento
JUL 18 2006
NORTH PERMIT
CENTER

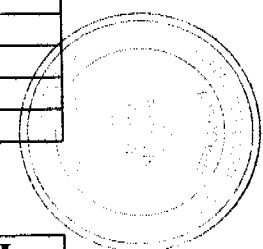

PANEL B				200 AMP BUS FROM PANEL			
120/208 V 3PH 4W				A FEED THRU			
LOAD	CB	KVA	N0	N0	KVA	CB	LOAD
RECEPTICALS	20/1	.72	1	2	1.1	20/1	LITES
POS PLUG	20/1	.54	3	4	.3	20/1	EXIT LITES
POS PLUG	20/1	.54	5	6	.7	20/1	LITES
20/1	20/1	.9	7	8		20/1	SPARE
HAND DRYER	20/1	1.5	9	10	.75	20/1	LITES
HAND DRYER	20/1	1.5	11	12	1.1	20/1	LITES
SMOKE DETECTOR	20/1	.3	13	14	.76	20/1	LITES
RECEPTICAL	20/1	.72	15	16	.54	20/1	LITES
LITES	20/1	.35	17	18	.8	20/1	LITES
RECEPTICAL	20/1	.72	19	20	1.2	20/1	BLENDER
RECEPTICAL	20/1	.72	21	22	1.0	20/1	BLENDER
SPARE	20/1		23	24	1.0	20/1	BLENDER
RECEPTICAL	20	1.1	25	26	1.0	20/1	BLENDER
RECEPTICAL	/2	1.1	27	28		20/1	SPARE
ICE MACHINE	20	1.1	29	30	1.2	20/1	WARMER
	/2	1.1	31	32	.9	20/1	RECEPTICALS
INSTA HOT	20/1	1.5	33	34	1.44	20/1	RECEPTICALS
SPARE	20/1		35	36	1.0	20/1	RCEPTICALS
SPARE	20/1		37	38	1.9	30	WARMER OVEN SPARE
WARMER OVEN	30		39	40	1.9	/2	RECEPTICAL
RECEPTICAL //	/2		41	42	1.0	15/1	RECEPTICAL REF

39.2 KVA = 108.89 AMPS

TOTAL LOAD A AND B SECTIONS 264.79 AMPS

THE APPROVAL OF ALL ELECTRICAL WORK
IS SUBJECT TO FIELD INSPECTIONS

This set of plans and specifications must be kept on the job at all times and it is intended to make any change or additions from the same without written permission from the building department. The approval of this set of specifications is subject to field inspection.

ISSUED
City of Sacramento
JUL 18 2006
NORTH PERMIT
CENTER

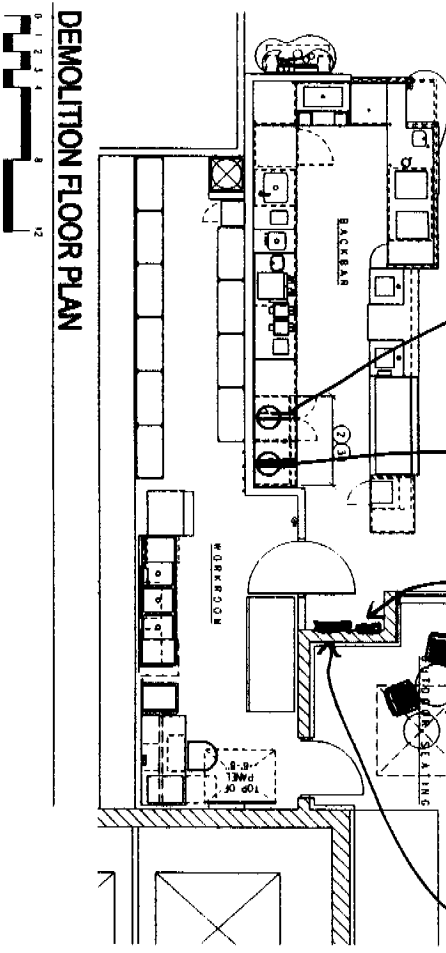
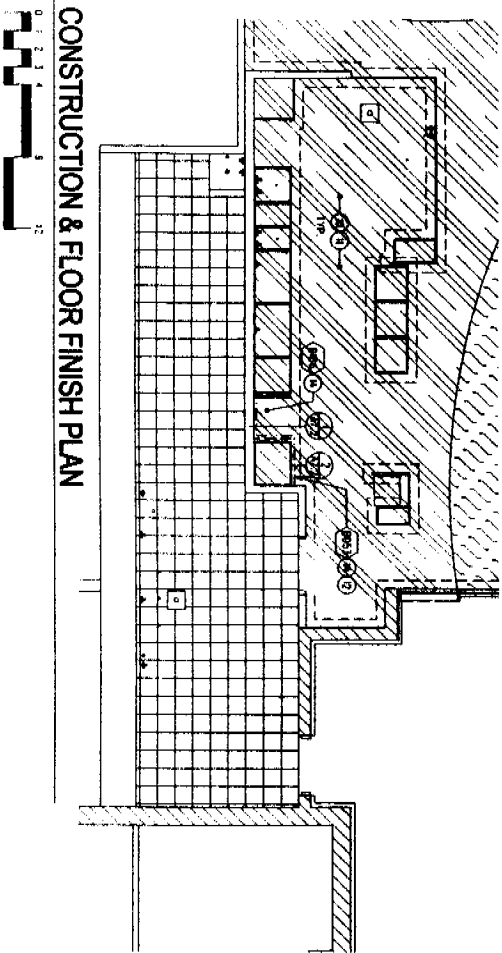

B-42
#12 CU
B-39, 41
#10 CU
Pnt "B"
Pnt "A"

FLOOR FINISH SCHEDULE:

NO.	DESCRIPTION	UNIT	QTY	PRICE	TOTAL
1	TILE BASE	SQ. FT.			
2	TILE NEED BASE	SQ. FT.			
3	CASTORITE	SQ. FT.			
4	CASTORITE	SQ. FT.			
5	CASTORITE	SQ. FT.			
6	CASTORITE	SQ. FT.			
7	CASTORITE	SQ. FT.			
8	CASTORITE	SQ. FT.			
9	CASTORITE	SQ. FT.			
10	CASTORITE	SQ. FT.			
11	CASTORITE	SQ. FT.			
12	CASTORITE	SQ. FT.			
13	CASTORITE	SQ. FT.			
14	CASTORITE	SQ. FT.			
15	CASTORITE	SQ. FT.			
16	CASTORITE	SQ. FT.			
17	CASTORITE	SQ. FT.			
18	CASTORITE	SQ. FT.			
19	CASTORITE	SQ. FT.			
20	CASTORITE	SQ. FT.			
21	CASTORITE	SQ. FT.			
22	CASTORITE	SQ. FT.			
23	CASTORITE	SQ. FT.			
24	CASTORITE	SQ. FT.			
25	CASTORITE	SQ. FT.			
26	CASTORITE	SQ. FT.			
27	CASTORITE	SQ. FT.			
28	CASTORITE	SQ. FT.			
29	CASTORITE	SQ. FT.			
30	CASTORITE	SQ. FT.			
31	CASTORITE	SQ. FT.			
32	CASTORITE	SQ. FT.			
33	CASTORITE	SQ. FT.			
34	CASTORITE	SQ. FT.			
35	CASTORITE	SQ. FT.			
36	CASTORITE	SQ. FT.			
37	CASTORITE	SQ. FT.			
38	CASTORITE	SQ. FT.			
39	CASTORITE	SQ. FT.			
40	CASTORITE	SQ. FT.			
41	CASTORITE	SQ. FT.			
42	CASTORITE	SQ. FT.			
43	CASTORITE	SQ. FT.			
44	CASTORITE	SQ. FT.			
45	CASTORITE	SQ. FT.			
46	CASTORITE	SQ. FT.			
47	CASTORITE	SQ. FT.			
48	CASTORITE	SQ. FT.			
49	CASTORITE	SQ. FT.			
50	CASTORITE	SQ. FT.			
51	CASTORITE	SQ. FT.			
52	CASTORITE	SQ. FT.			
53	CASTORITE	SQ. FT.			
54	CASTORITE	SQ. FT.			
55	CASTORITE	SQ. FT.			
56	CASTORITE	SQ. FT.			
57	CASTORITE	SQ. FT.			
58	CASTORITE	SQ. FT.			
59	CASTORITE	SQ. FT.			
60	CASTORITE	SQ. FT.			
61	CASTORITE	SQ. FT.			
62	CASTORITE	SQ. FT.			
63	CASTORITE	SQ. FT.			
64	CASTORITE	SQ. FT.			
65	CASTORITE	SQ. FT.			
66	CASTORITE	SQ. FT.			
67	CASTORITE	SQ. FT.			
68	CASTORITE	SQ. FT.			
69	CASTORITE	SQ. FT.			
70	CASTORITE	SQ. FT.			
71	CASTORITE	SQ. FT.			
72	CASTORITE	SQ. FT.			
73	CASTORITE	SQ. FT.			
74	CASTORITE	SQ. FT.			
75	CASTORITE	SQ. FT.			
76	CASTORITE	SQ. FT.			
77	CASTORITE	SQ. FT.			
78	CASTORITE	SQ. FT.			
79	CASTORITE	SQ. FT.			
80	CASTORITE	SQ. FT.			
81	CASTORITE	SQ. FT.			
82	CASTORITE	SQ. FT.			
83	CASTORITE	SQ. FT.			
84	CASTORITE	SQ. FT.			
85	CASTORITE	SQ. FT.			
86	CASTORITE	SQ. FT.			
87	CASTORITE	SQ. FT.			
88	CASTORITE	SQ. FT.			
89	CASTORITE	SQ. FT.			
90	CASTORITE	SQ. FT.			
91	CASTORITE	SQ. FT.			
92	CASTORITE	SQ. FT.			
93	CASTORITE	SQ. FT.			
94	CASTORITE	SQ. FT.			
95	CASTORITE	SQ. FT.			
96	CASTORITE	SQ. FT.			
97	CASTORITE	SQ. FT.			
98	CASTORITE	SQ. FT.			
99	CASTORITE	SQ. FT.			
100	CASTORITE	SQ. FT.			

APPROVED PER 2002
NATIONAL ELECTRICAL CODE
AND CITY OF SACRAMENTO
AMENDMENTS
7-17-06
ELECTRICAL DIVISION

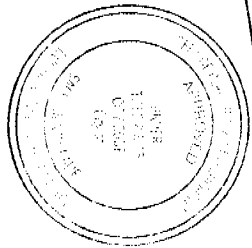

VERIFY NUMBER
RATING OF EQUIPMENTS

ALL NON-PORTABLE EQUIPMENT
REQUIRED TO BE HARDWIRED

THE APPROVAL OF ALL ELECTRICAL WORK
IS SUBJECT TO FIELD INSPECTIONS.

This set of plans and specifications must be kept on the job at all times and to make any change or addition to same without written consent of the Engineer. The approval of this plan and specification shall not be held to constitute a violation of any City Ordinance or State Law.

LEGEND:

EXISTING TO REMAIN

EXISTING TO BE DEMOLISHED

DEMO PLAN NOTES:

1. ALL WORK SHALL BE DONE IN ACCORDANCE WITH THE CITY OF SACRAMENTO SPECIFICATIONS AND THE NATIONAL ELECTRICAL CODE.

2. DEMOLITION SHALL BE DONE IN ACCORDANCE WITH THE CITY OF SACRAMENTO SPECIFICATIONS AND THE NATIONAL ELECTRICAL CODE.

3. DEMOLITION SHALL BE DONE IN ACCORDANCE WITH THE CITY OF SACRAMENTO SPECIFICATIONS AND THE NATIONAL ELECTRICAL CODE.

ITEMS TO PRESERVE:

1. ALL EXISTING EQUIPMENT SHALL BE PRESERVED AND REPAIRED AS NECESSARY TO BRING THEM UP TO THE CITY OF SACRAMENTO SPECIFICATIONS AND THE NATIONAL ELECTRICAL CODE.

CONSTRUCTION NOTES:

1. ALL WORK SHALL BE DONE IN ACCORDANCE WITH THE CITY OF SACRAMENTO SPECIFICATIONS AND THE NATIONAL ELECTRICAL CODE.

2. ALL WORK SHALL BE DONE IN ACCORDANCE WITH THE CITY OF SACRAMENTO SPECIFICATIONS AND THE NATIONAL ELECTRICAL CODE.

3. ALL WORK SHALL BE DONE IN ACCORDANCE WITH THE CITY OF SACRAMENTO SPECIFICATIONS AND THE NATIONAL ELECTRICAL CODE.

<p>STARBUCKS COFFEE COMPANY 2001 UNION AVENUE SOUTH SACRAMENTO, CA 95811 (916) 441-1111</p>	<p>ARCHITECT OF RECORD</p>	<p>REV DATE JC DESCRIPTION</p>	<p>PROJECT # 0610740 PHONE # 916-441-1111 SCALE DATE: 1/1/06 DATE: 7/17/06 CHECKED: KENNETH SCHWARTZ DRAWN: DAN SWALLEY</p>	<p>PROJECT # 0610740 PHONE # 916-441-1111 SCALE DATE: 1/1/06 DATE: 7/17/06 CHECKED: KENNETH SCHWARTZ DRAWN: DAN SWALLEY</p>	<p>FOOD STATION PROGRAM 15TH & H STREET 1430 - H ST. 809 14TH STREET SACRAMENTO, CA 95815 SACRAMENTO</p>	<p>SHEET # 11 SCALE 1/4" = 1'-0" DO NOT SCALE DIMENSIONS</p>
---	----------------------------	--------------------------------	---	---	--	--

0610740 1430 H ST.