

CITY OF SACRAMENTO
1231 I Street, Sacramento, CA 95814

Permit No: 0107156
Insp Area: 4

Site Address: 3301 TIERRA NUEVO WY SAC
Parcel No: DEL PASO NUEVO LOT 1 Housing (Y/N):

Sub-Type: NSFR
N

CONTRACTOR
MYERS HOMES INC
3300 FITZGERALD RD.
RANCHO CORDOVA CA. 95742

OWNER

ARCHITECT

Nature of Work: NSFR MP1765 8 RMS 2 STORY

CONSTRUCTION LENDING AGENCY : I hereby affirm under penalty of perjury that there is a construction lending agency for the performance of the work for which this permit is issued (Sec. 3097, Civ. C)

Lender's Name _____ Lender's Address _____

LICENSED CONTRACTORS DECLARATION: I hereby affirm under penalty of perjury that I am licensed under provisions of Chapter 9 (commencing with section 7000) of Division 3 of the Business and Professions Code and my license is in full force and effect.

License Class B License Number 744473 Date 6-7-01 Contractor Signature Rhonda Rose

OWNER-BUILDER DECLARATION: I hereby affirm under penalty of perjury that I am exempt from the contractors License Law for the following reason (Sec. 7031.5, Business and Professions Code; any city or county which requires a permit to construct, alter, improve, demolish, or repair any structure, prior to its issuance, also requires the applicant for such permit to file a signed statement that he or she is licensed pursuant to the provisions of the Contractors License Law (Chapter 9 (commencing with Section 7000) of Division 8 of the Business and Professions Code) or that he or she is exempt therefrom and the basis for the alleged exemption. Any violation of Section 7031.5 by any applicant for a permit subjects the applicant to a civil penalty of not more than five hundred dollars (\$500.00).

_____, I, as a owner of the property, or my employees with wages as their sole compensation, will do the work, and the structure is not intended or offered for sale (Sec. 7044, Business and Professional Code. The Contractors License Law does not apply to an owner of property who builds or improves thereon, and who does such work himself or herself or through his/her own employees, provided that such improvements are not intended or offered for sale. If, however, the building or improvement is sold within one year of completion, the owner-builder will have the burden of proving that he/she did not build or improve for the purpose of sale.)

_____, I, as owner of the property, am exclusively contracting with licensed contractors to construct the project (Sec. 7044, Business and Professions Code. The Contractors License Law does not apply to an owner of property who builds or improves thereon, and who contracts for such projects with a contractor(s) licensed pursuant to the Contractors License Law)

I am exempt under Sec _____ B & PC for this reason: NEIGHBORHOODS, PLANNING AND DEVELOPMENT SERVICES
Date _____ Owner Signature _____

IN ISSUING THIS BUILDING PERMIT, the applicant represents, and the city relies on the representation of the applicant, that the applicant verified all measurements and locations shown on the application or accompanying drawings and that the improvement to be constructed does not violate any law or private agreement relating to permissible or prohibited locations for such improvements. This building permit does not authorize any illegal location of any improvement or the violation of any private agreement relating to location of improvements.

I certify that I have read this application and state that all information is correct. I agree to comply with all city and county ordinances and state laws relating to building construction and hereby authorize representative(s) of this city to enter upon the abovementioned property for inspection purposes.

Date 6/7/01 Applicant/Agent Signature Rhonda Rose

WORKER'S COMPENSATION DECLARATION: I hereby affirm under penalty of perjury one of the following declarations:

_____, I have and will maintain a certificate of consent to self-insure for workers' compensation as provided for by Section 3700 of the Labor Code, for the performance of work for which the permit is issued

_____, I have and will maintain workers' compensation insurance, as required by Section 3700 of the Labor Code, for the performance of the work for which this permit is issued. My workers' compensation insurance carrier and policy number are:

Carrier RELANCE NAT INS CO Policy Number NWAO154613-01 Exp Date 04/01/2001

_____, (This section need not be completed if the permit is for \$100 or less) I certify that in the performance of the work for which this permit is issued, I shall not employ any person in any manner so as to become subject to the workers' compensation laws of California and agree that if I should become subject to the workers' compensation provisions of Section 3700 of the Labor Code, I shall forthwith comply with those provisions.

Date 6/7/01 Applicant Signature Rhonda Rose

WARNING: FAILURE TO SECURE WORKER'S COMPENSATION COVERAGE IS UNLAWFUL AND SHALL SUBJECT AN EMPLOYER TO CRIMINAL PENALTIES AND CIVIL FINES UP TO ONE HUNDRED THOUSAND DOLLARS (\$100,000) IN ADDITION TO THE COST OF COMPENSATION. DAMAGES AS PROVIDED FOR IN SECTION 3706 OF THE LABOR CODE, INTEREST AND ATTORNEY'S FEE.

THIS PERMIT SHALL EXPIRE BY LIMITATION IF WORK IS NOT COMMENCED WITHIN 180 DAYS.

ENGEL INSULATION, INC.

CALIFORNIA CONTRACTOR'S LICENSE #745646
460 Roseville Road • Roseville, CA 95678
(916) 786-2088 / (916) 969-6191

THIS IS TO CERTIFY THAT INSULATION HAS BEEN INSTALLED IN CONFORMANCE WITH CURRENT ENERGY REGULATIONS, CALIFORNIA ADMINISTRATIVE CODE, TITLE 24, STATE OF CALIFORNIA, IN THE BUILDING LOCATED AT:

TRACT Del Rio Avenue lot 611114003
STREET _____ CITY San Francisco

EXTERIOR WALLS: _____ THICKNESS 1 1/2 R-VALUE 11

MANUFACTURER _____ THICKNESS _____ R-VALUE _____

CEILING AREA BATT _____ THICKNESS _____ R-VALUE _____

MANUFACTURER _____ THICKNESS 1 1/4 R-VALUE 11

CEILINGS: BLOWN IN _____ THICKNESS _____ R-VALUE _____

MANUFACTURER _____ THICKNESS 1 1/2 R-VALUE 21

SQUARE FOOTAGE _____ NUMBER OF BAGS USED _____

FLOOR AREA _____

MANUFACTURER _____ THICKNESS _____ R-VALUE _____

EXTERIOR KNEEWALL _____ THICKNESS _____ R-VALUE _____

MANUFACTURER _____ THICKNESS 1 1/4 R-VALUE 11

INTERIOR KNEEWALL _____ THICKNESS _____ R-VALUE _____

MANUFACTURER _____ THICKNESS _____ R-VALUE _____

APPLIED CAULK & SEALANT TO ALL EXTERIOR OPENINGS & PENETRATIONS

YES NO

GENERAL CONTRACTOR Myers Homes

CALIFORNIA CONTRACTORS LICENSE # 97144073 DATE 9/19/01

[Signature] SIGNATURE TITLE Super

[Signature] INSULATION CONT. SIGNATURE TITLE 9/19/01 DATE



WALLACE • KUHL & ASSOCIATES INC.
 GEOTECHNICAL ENGINEERING • CONSTRUCTION TESTING

3050 Industrial Blvd.
 PO Box 1137
 West Sacramento
 California 95691
 916-372-1434

DATE 4-4-62		JOB NO.		WEATHER		TEMP. * at * at AM PM	
PROJECT Del Pass Nucvo - MYERS HOMES				Technician I <input type="checkbox"/>		Staff E/G <input type="checkbox"/>	
LOCATION				Technician II <input type="checkbox"/>		Project E/G <input type="checkbox"/>	
TYPE OF WORK FIRE RETARDANT PAINT APPLICATION				Technician III <input type="checkbox"/>		Senior E/G <input type="checkbox"/>	
Inside 50 mi. radius <input type="checkbox"/>		Outside 50 mi. radius <input type="checkbox"/>		Nuclear Densities <input type="checkbox"/>		Principal E/G <input type="checkbox"/>	
PERSONNEL	REG. HRS	OT HRS	TOTAL HRS	TRAVEL	ON JOB	VEHICLE	MILES
P. Laiglois							

OBSERVATIONS:
 OBSERVED THE APPLICATION OF FLAMMORT INTUMESCENT FIRE
 RETARDANT PAINT (ASTM E-84 CLASS 0 / CLASS 1) AT HORIZONTAL
 UNDERLIE OF GARAGE OVERHANGS WHERE DISTANCE TO PROPERTY
 WERE NOT PER BUILDING CODE NOTED AMPLE COVERAGE TO AREAS
 SPRAYED GIVEN THE SQUARE FOOTAGE OF AREAS SPRAYED APPROX
 5.2 GALLONS REQUIRED 7+ GALLONS USED.
 LOTS SPRAYED 1, 2, 4, 5, 7, 9, 11, 15, 18, 20-22, 25, 26, 28, 32, 34, 35, 39,
 41, 42, 46, 49, 49, 51-54

FIELD REPORT

Signed



BASALITE[®]
PACIFIC STUCCO SYSTEMS

4290 Roseville Road
North Highlands, CA 95660-5710
(916) 486-4094
Fax (916) 486-4167

Installation Card
Fiber Reinforced Stucco

Job Name and Address : Meyers Homes
Del Paso Nuevo
Lot - 1
Tierra Nueva Road
Sacramento, CA

ICBO# 5269

8/15/01
Date of job completion

Plastering Contractor

Name: G. Glenn Plastering

Address: 6330 Main Ave, Ste. 4, Orangevale, CA 95662

Telephone No. (916) 989-8755

Approved contractor as issued by Basalite/Pacific Stucco

This is to certify the exterior coating system at the above address, has been installed in accordance with the evaluation report specified above and the manufacturers instructions.

Delores Glenn
Signature of authorized representative of
plastering contractor

09/14/01
Date

This installation card must be presented to the building inspector after completion of work and before final inspection.

12/06/2000 14:50

13602934702

DAVID

PAGE 02

This set of plans and specifications were prepared by me or under my direct supervision and I am a duly Licensed Professional Engineer in the State of California. I am hereby certifying that I am a duly Licensed Professional Engineer in the State of California and that I am the author of these plans and specifications. I am hereby certifying that I am a duly Licensed Professional Engineer in the State of California and that I am the author of these plans and specifications.

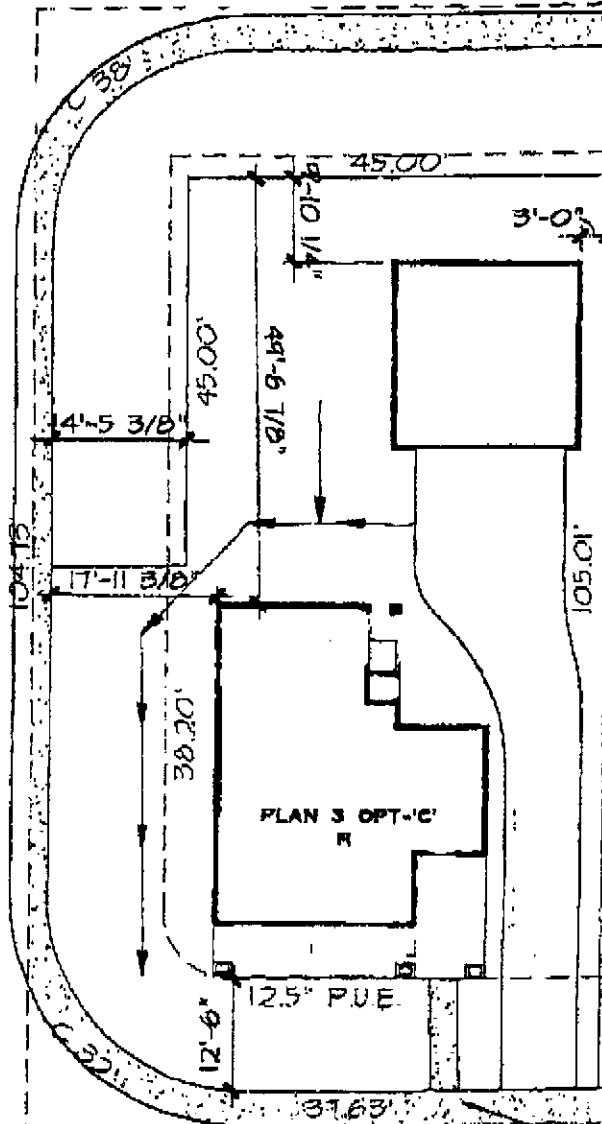
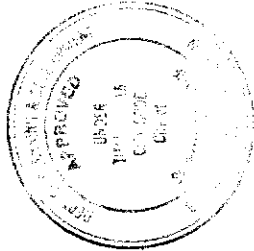

B.O.W./PROP. LINE

S/W

TIERRA NUEVO WAY

DATE: Nov. 4, 00

AKN:

ADDRESS: TIERRA NUEVO WAY

LOT AREA: 3,400 SF.

LOT COVERAGE: 27%



MDCAYENQ
KOTESTYNE
ASSOCIATES

709 J ST.
SACRAMENTO, CA.
PHONE: (916) 233-1000
FAX: (916) 415-1211

DEL PASO NUEVO

LOT 1
PLAN SC R

DEL PASO NUEVO

CITY OF SACRAMENTO, CA.
CLIENT: MYERS HOMES & NEW PHAZE
JOB No. 99101



WALLACE • KUHL & ASSOCIATES INC.
 GEOTECHNICAL ENGINEERING • CONSTRUCTION TESTING

3050 Industrial Blvd.
 PO Box 1137
 West Sacramento
 California 95691
 916-372-1434

DATE 7.13.01		JOB NO.		WEATHER		TEMP. ° at		AM	
PROJECT DEL PASO NUEVO		Technician I <input type="checkbox"/>		Staff E/G <input type="checkbox"/>					
LOCATION LOTS 1, 2, 3		Technician II <input type="checkbox"/>		Project E/G <input type="checkbox"/>					
TYPE OF WORK ANCHOR BOLT TESTING		Technician III <input type="checkbox"/>		Senior E/G <input type="checkbox"/>					
Inside 50 mi. radius <input checked="" type="checkbox"/>		Outside 50 mi. radius <input type="checkbox"/>		Nuclear Densities <input type="checkbox"/>		Principal E/G <input type="checkbox"/>			
PERSONNEL	REG. HRS	OT HRS	TOTAL HRS	TRAVEL	ON JOB	VEHICLE	MILES		
J. KUNDRAK									
OBSERVATIONS:									
PULL TESTED 26 ANCHOR BOLTS AS FOLLOWS FOR									
LOTS 1, 2, 3									
LOT (1) - SIX TOTAL									
" (2) - THREE TOTAL (2 IN HOUSE / 1 IN GARAGE)									
" (3) - SEVEN TOTAL									
* MARKED ALL TESTED BOLTS WITH GREEN SPRAY PAINT									
USED SIMPSON'S VALUES TO ENGINEERING STANDARDS									
FOR HOLD DOWN TYPE 3:									
VALUES = 14570 = 11395 * @ 2100 PSI = PASSED.									
ALL 26 BOLTS HOLD FOR APPROX 1 MINUTE = PASSED.									
GAVE REPORT TO M. F. W. MYERS.									
FIELD REPORT				Signed <u>J. Kundrak</u>					

Project Address: 3301 Tierra Nueva Way Assessor Parcel # 250-0220-030
Lot Number: 1 Subdivision Del Paso Nuevo

OWNER INFORMATION: 0107156
Legal Property Owner: Myers Homes of California, LLC Phone# (916) 851-0530
Owner Address: 3480 Sunrise Blvd., St.200 City Rancho Cordova State CA Zip 95742

CONTRACTOR INFORMATION:
Contractor: Myers Homes, Inc. Lic. # 744473 Phone # (916)851-0530 Fax (916)851-0535

PROJECT INFORMATION:
Land Use Zone R1A Occupancy Group R3 Construction Type VN Fed Code 1A
No. of Stories: 2 No. of Rooms: 11 Street Width: 45 Ft.
1st Floor Area 840 2nd Floor Area 925 Basement N/A Roof Material Tile
AREA IN SQUARE FOOT OF:
Dwelling/Living 1765
Garage/Storage 419.25
Decks/Balconies _____
Carports _____
SCOPE OF WORK: New construction of single family residence.

DPN 6-6

- Information Above Complete
- Violation Files Checked
- Standard Setbacks
- County Sewer
- AR Flood Waiver Required
- Flood Elevation Certificate Required
- Water Development Infill Area
- Planning Approval
- Design Review Approval
- Special Fee Districts Apply:

FOR OFFICE USE ONLY

THE FOLLOWING MUST BE PROVIDED IN ORDER TO SUBMIT FOR PERMIT--
 2 COMPLETE PLOT PLANS, LEGIBLE & DRAWN TO SCALE
 11 X 17 COPY OF FLOOR PLAN WITH FOLLOWING INFORMATION
a) Assessor's Parcel Number c) Owners Name
b) New Floor Area d) Project Address

Date: _____ Received by: (staff) _____ Permit # _____

