

CITY OF SACRAMENTO

1231 I Street, Sacramento, CA 95814

Permit No: 0114226

Insp Area: 4

Site Address: 3378 SHEARWATER DR SAC

Thos Bros:

Parcel No: 274-0610-062

SHOREBIRD UNIT 2 LOT 62

Sub-Type: NSFR

Housing (Y/N): N

CONTRACTOR

CITATION NORTHERN
597 CENTER AVE. STE. 150
MARTINEZ CAL. 94553

OWNER

ARCHITECT

Nature of Work: MP 2322 2 STORY 9 ROOM SFR

CONSTRUCTION LENDING AGENCY : I hereby affirm under penalty of perjury that there is a construction lending agency for the performance of the work for which this permit is issued (Sec. 3097, Civ. C).

Lender's Name _____ Lender's Address _____

LICENSED CONTRACTORS DECLARATION: I hereby affirm under penalty of perjury that I am licensed under provisions of Chapter 9 (commencing with section 7000) of Division 3 of the Business and Professions Code and my license is in full force and effect.

License Class B License Number 547764 Date 11-13-01 Contractor Signature 

OWNER-BUILDER DECLARATION: I hereby affirm under penalty of perjury that I am exempt from the contractors License Law for the following reason (Sec. 7031.5, Business and Professions Code; any city or county which requires a permit to construct, alter, improve, demolish, or repair any structure, prior to its issuance, also requires the applicant for such permit to file a signed statement that he or she is licensed pursuant to the provisions of the Contractors License Law (Chapter 9 (commencing with Section 7000) of Division 8 of the Business and Professions Code) or that he or she is exempt therefrom and the basis for the alleged exemption. Any violation of Section 7031.5 by any applicant for a permit subjects the applicant to a civil penalty of not more than five hundred dollars (\$500.00);

I, as a owner of the property, or my employees with wages as their sole compensation, will do the work, and the structure is not intended or offered for sale (Sec. 7044, Business and Professional Code: The Contractors License Law does not apply to an owner of property who builds or improves thereon, and who does such work himself or herself or through his/her own employees, provided that such improvements are not intended or offered for sale. If, however, the building or improvement is sold within one year of completion, the owner-builder will have the burden of proving that he/she did not build or improve for the purpose of sale.)

I, as owner of the property, am exclusively contracting with licensed contractors to construct the project (Sec. 7044, Business and Professions Code: The Contractors License Law does not apply to an owner of property who builds or improves thereon, and who contracts for such projects with a contractor(s) licensed pursuant to the Contractors License Law).

I am exempt under Sec. _____ B & PC for this reason: _____

Date _____ Owner Signature _____

IN ISSUING THIS BUILDING PERMIT, the applicant represents, and the city relies on the representation of the applicant, that the applicant verified all measurements and locations shown on the application or accompanying drawings and that the improvement to be constructed does not violate any law or private agreement relating to permissible or prohibited locations for such improvements. This building permit does not authorize any illegal location of any improvement or the violation of any private agreement relating to location of improvements.

I certify that I have read this application and state that all information is correct. I agree to comply with all city and county ordinances and state laws relating to building construction and hereby authorize representative(s) of this city to enter upon the abovementioned property for inspection purposes.

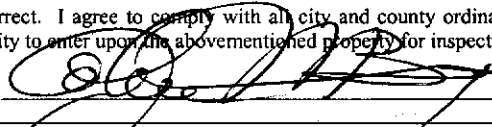
Date 11-13-01 Applicant/Agent Signature 

WORKER'S COMPENSATION DECLARATION: I hereby affirm under penalty of perjury one of the following declarations:
I have and will maintain a certificate of consent to self-insure for workers' compensation as provided for by Section 3700 of the Labor Code, for the performance of work for which the permit is issued.

I have and will maintain workers' compensation insurance, as required by Section 3700 of the Labor Code, for the performance of the work for which this permit is issued. My workers' compensation insurance carrier and policy number are:

Carrier FREMONT IND. CO. Policy Number WN9010750-03 Exp Date 06/30/2002

(This section need not be completed if the permit is for \$100 or less) I certify that in the performance of the work for which this permit is issued, I shall not employ any person in any manner so as to become subject to the workers' compensation laws of California and agree that if I should become subject to the workers' compensation provisions of Section 3700 of the Labor Code, I shall comply with those provisions.

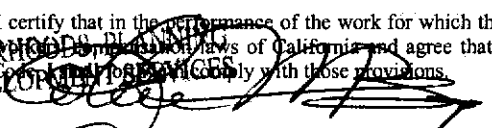
Date 11-13-01 Applicant Signature 

WARNING: FAILURE TO SECURE WORKER'S COMPENSATION COVERAGE IS UNLAWFUL AND SHALL SUBJECT AN EMPLOYER TO CRIMINAL PENALTIES AND CIVIL FINES UP TO ONE HUNDRED THOUSAND DOLLARS (\$100,000) IN ADDITION TO THE COST OF COMPENSATION, DAMAGES AS PROVIDED FOR IN SECTION 3706 OF THE LABOR CODE, INTEREST AND ATTORNEY'S FEE.

THIS PERMIT SHALL EXPIRE BY LIMITATION IF WORK IS NOT COMMENCED WITHIN 180 DAYS.



**INSULATION CONTRACTORS
ASSOCIATION
OF AMERICA**

INSULATION
CERTIFICATE
70280

1321 DUKE STREET, SUITE 303 • ALEXANDRIA, VA 22314 • (703) 739-0356

THIS IS TO CERTIFY THAT INSULATION HAS BEEN INSTALLED IN CONFORMANCE WITH CURRENT ENERGY REGULATIONS, CALIFORNIA ADMINISTRATIVE CODE, TITLE 24, STATE OF CALIFORNIA, IN THE BUILDING LOCATED AT _____

STREET 3328 Shearwater LOT # _____ TRACT # _____
CITY _____

EXTERIOR WALLS:

MANUFACTURER _____ THICKNESS/TYPE _____ VALUE 13 R-

CEILING:

BATTS: _____ THICKNESS/TYPE _____ VALUE 38 R-

MANUFACTURER _____ THICKNESS/TYPE _____ VALUE _____ R-

BLOWN IN: _____ MINIMUM _____ VALUE 38 R-

MANUFACTURER _____ THICKNESS _____ VALUE _____ R-

SQUARE FOOTAGE COVERED 5 NUMBER OF BAGS USED _____ R-

FLOORS: _____ THICKNESS/TYPE _____ VALUE _____ R-

MANUFACTURER _____ THICKNESS/TYPE _____ VALUE _____ R-

SLAB ON GRADE: _____ THICKNESS/TYPE _____ VALUE _____ R-

MANUFACTURER _____ THICKNESS/TYPE _____ VALUE _____ R-

WIDTH OF INSULATION _____ INCHES _____ R-

FOUNDATION WALLS: _____ THICKNESS/TYPE _____ VALUE _____ R-

MANUFACTURER _____ THICKNESS/TYPE _____ VALUE _____ R-

GENERAL CONTRACTOR _____ TITLE _____

CALIFORNIA CONTRACTORS LICENSE # _____ DATE _____

SIGNATURE _____ TITLE _____

INSULATION CONTRACTOR **ARCADE INSULATION** _____

CALIFORNIA CONTRACTORS LICENSE #263784 _____ DATE _____

SIGNATURE _____ TITLE _____

LOT 62

RESIDENTIAL BUILDING PERMIT APPLICATION

- New Construction
 Addition
 Remodels
 Other

Project Address: 3378 SHEARWATER DR. Assessor Parcel # 274-0610-062

OWNER INFORMATION:

Legal Property Owner: <u>Citation Northern</u>	Phone # <u>(925) 372-0300</u>
Owner Address: <u>597 Center Avenue, #150 City Martinez</u>	State <u>CA</u> Zip <u>94553</u>

CONTRACTOR INFORMATION:

Contractor: <u>Citation Northern Lic. # 547764</u>	Phone # <u>925-372-0300</u> <u>925-228-1833</u>
--	---

PROJECT INFORMATION:

Land Use Zone _____	Occupancy Group _____	Construction Type _____	Fed Code _____
No. of stories: <u>2</u>	No. of rooms: <u>9</u>	Street width: <u>46' R/W</u>	
1 st Floor Area <u>1,241</u>	2 nd Floor Area <u>1,081</u>	Basement _____	Roof Material <u>TILE</u>
AREA IN SQUARE FOOT OF:		<u>EXISTING</u>	<u>NEW</u>
Dwelling/Living	_____	_____	<u>2,322</u>
Garage/Storage	_____	_____	<u>635</u>
Decks/Balconies	_____	_____	_____
Carports	_____	_____	<u>2957</u>
SCOPE OF WORK: <u>Single Family</u>		Plan <u>23 MASTER</u>	

FOR OFFICE USE ONLY

<input type="checkbox"/> Information above complete	<input type="checkbox"/> AR Flood Waiver required	<input type="checkbox"/> Planning Approval
<input type="checkbox"/> Violation files checked	<input type="checkbox"/> Flood Elevation Certificate Required	<input type="checkbox"/> Design Review Approval
<input type="checkbox"/> Standard setbacks	<input type="checkbox"/> Water Development Infill Area	<input type="checkbox"/> Special Fee Districts Apply: _____
<input type="checkbox"/> County Sewer		

NEW STRUCTURES & ADDITIONS

◆ THE FOLLOWING MUST BE PROVIDED IN ORDER TO SUBMIT FOR PLAN REVIEW

- 2 COMPLETE PLANS, LEGIBLE & DRAWN TO SCALE ◆ Plans to include: site plan, floor plan, elevations, roof/calling plan, foundation and structural framing details, and structural calculations for non-conforming structures.
- 3 SETS IF PROJECT IS IN A DESIGN REVIEW AREA
- Title 24 Energy Compliance documentation
- 11" x 17" copy of floor plan for County Assessor
- Grading and Erosion Control Questionnaire
- Plan Review Fees

Date: _____ Received by: (staff) _____



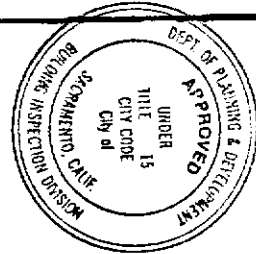

This set of plans and specifications must be kept on the job at all times and it is unlawful to make any changes or alterations from the same without written permission from the Building Inspection Division.
 The approval of this plan and specification SHALL NOT be held to permit or approve the violation of any City Ordinance or State Law.

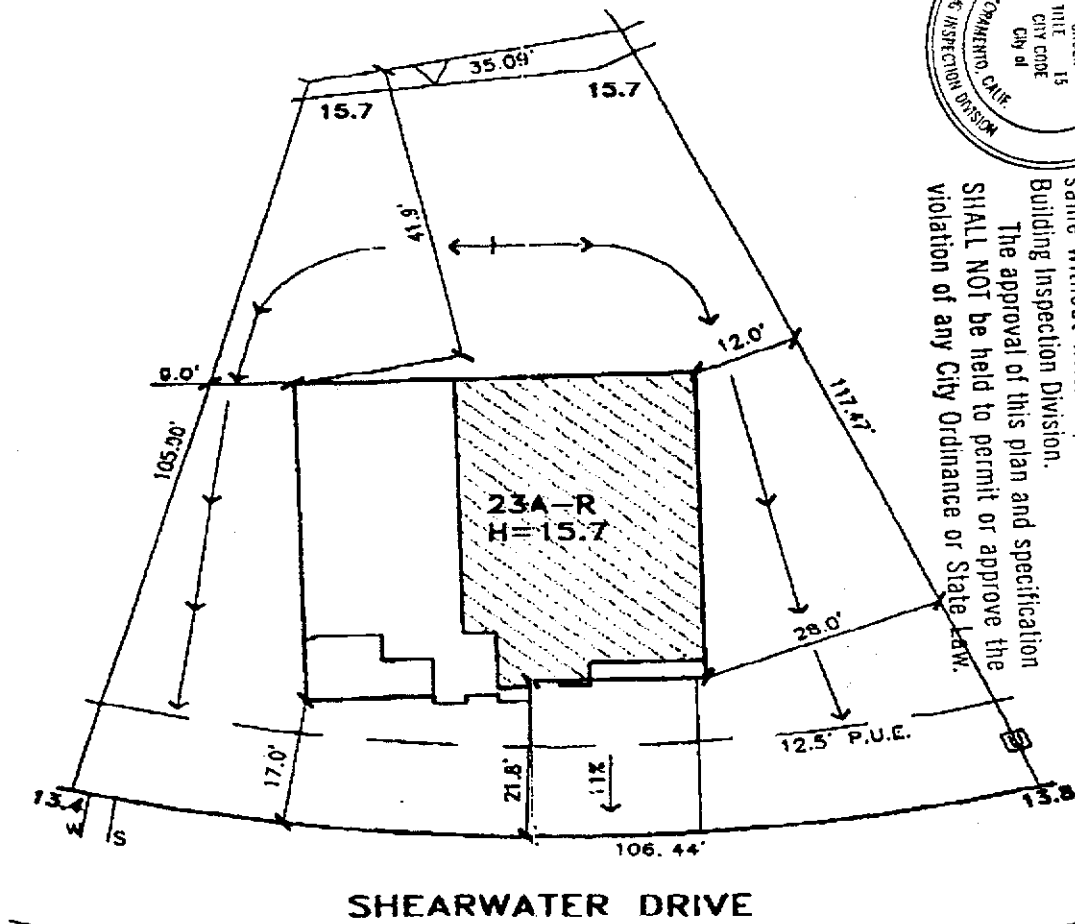

SHEARWATER DRIVE



DATE: 9-20-01

A.P.N.:

ADDRESS: SHEARWATER DRIVE

LOT AREA: 7,913 SF
 LOT COVERAGE: 25%

Stantec

Stantec Consulting Inc.
 2590 Venture Oaks Way
 Sacramento, CA 95833-3288
 Tel. 916.925.5550
 Fax. 916.921.9274
 www.stantec.com

**SHOREBIRD
 UNIT NO. 2
 LOT 62
 PLAN 23A**

SHOREBIRD

CITY OF SACRAMENTO, CA
 CLIENT: CITATION NORTHERN
 JOB NO.: 1579-001