

**CITY OF SACRAMENTO**  
1231 I Street, Sacramento, CA 95814

**Permit No: 0605439**  
**Insp Area: 4**  
**Thos Bros: 278-B6**

**Site Address: 2646 DOBBINS WY SAC**  
**Parcel No: FRIENZA SUBDIVISION LOT #3**

PAID  
CITY OF SACRAMENTO  
MAY 26 2006

**Sub-Type: NSFR**  
**Housing (Y/N): N**

**CONTRACTOR**  
KAT CONSTRUCTION  
2947 FULTON AVE  
SAC CA 95821

**OWNER**

**ARCHITECT**

NEIGHBORHOODS PLANNING  
AND DEVELOPMENT SERVICES

**Nature of Work: MP 1350 2 STORY 6 ROOM SFR**

**CONSTRUCTION LENDING AGENCY:** I hereby affirm under penalty of perjury that there is a construction lending agency for the performance of the work for which this permit is issued (Sec. 3097, Civ. C).

Lender's Name \_\_\_\_\_ Lender's Address \_\_\_\_\_

**LICENSED CONTRACTORS DECLARATION:** I hereby affirm under penalty of perjury that I am licensed under provisions of Chapter 9 (commencing with section 7000) of Division 3 of the Business and Professions Code and my license is in full force and effect.

License Class B License Number 809667 Date 5/26/06 Contractor Signature \_\_\_\_\_

**OWNER-BUILDER DECLARATION:** I hereby affirm under penalty of perjury that I am exempt from the contractors License Law for the following reason (Sec. 7031.5, Business and Professions Code; any city or county which requires a permit to construct, alter, improve, demolish, or repair any structure, prior to its issuance, also requires the applicant for such permit to file a signed statement that he or she is licensed pursuant to the provisions of the Contractors License Law (Chapter 9 (commencing with Section 7000) of Division 8 of the Business and Professions Code) or that he or she is exempt therefrom and the basis for the alleged exemption. Any violation of Section 7031.5 by any applicant for a permit subjects the applicant to a civil penalty of not more than five hundred dollars (\$500.00);

I, as a owner of the property, or my employees with wages as their sole compensation, will do the work, and the structure is not intended or offered for sale (Sec. 7044, Business and Professional Code: The Contractors License Law does not apply to an owner of property who builds or improves thereon, and who does such work himself or herself or through his/her own employees, provided that such improvements are not intended or offered for sale. If, however, the building or improvement is sold within one year of completion, the owner-builder will have the burden of proving that he/she did not build or improve for the purpose of sale.)

I, as owner of the property, am exclusively contracting with licensed contractors to construct the project (Sec. 7044, Business and Professions Code: The Contractors License Law does not apply to an owner of property who builds or improves thereon, and who contracts for such projects with a contractor(s) licensed pursuant to the Contractors License Law).

I am exempt under Sec. \_\_\_\_\_ B & PC for this reason: \_\_\_\_\_

Date \_\_\_\_\_ Owner Signature \_\_\_\_\_

**IN ISSUING THIS BUILDING PERMIT,** the applicant represents, and the city relies on the representation of the applicant, that the applicant verified all measurements and locations shown on the application or accompanying drawings and that the improvement to be constructed does not violate any law or private agreement relating to permissible or prohibited locations for such improvements. This building permit does not authorize any illegal location of a ny improvement or the violation of any private agreement relating to location of improvements.

I certify that I have read this application and state that all information is correct. I agree to comply with all city and county ordinances and state laws relating to building construction and herby authorize representative(s) of this city to enter upon the abovementioned property for inspection purposes.

Date 5/26/06 Applicant/Agent Signature \_\_\_\_\_

**WORKER'S COMPENSATION DECLARATION:** I hereby affirm under penalty of perjury one of the following declarations:  
I have and will maintain a certificate of consent to self-insure for workers' compensation as provided for by Section 3700 of the Labor Code, for the performance of work for which the permit is issued.

N I have and will maintain workers' compensation insurance, as required by Section 3700 of the Labor Code, for the performance of the work for which this permit is issued. My workers' compensation insurance carrier and policy number are:

Carrier STATE FUND Policy Number 1820034 Exp Date 01/01/2007

(This section need not be completed if the permit is for \$100 or less) I certify that in the performance of the work for which this permit is issued, I shall not employ any person in any manner so as to become subject to the workers' compensation laws of California and agree that if I should become subject to the workers' compensation provisions of Section 3700 of the Labor Code, I shall forthwith comply with those provisions.

Date 5/26/06 Applicant Signature \_\_\_\_\_

**WARNING: FAILURE TO SECURE WORKER'S COMPENSATION COVERAGE IS UNLAWFUL AND SHALL SUBJECT AN EMPLOYER TO CRIMINAL PENALTIES AND CIVIL FINES UP TO ONE HUNDRED THOUSAND DOLLARS (\$100,000) IN ADDITION TO THE COST OF COMPENSATION, DAMAGES AS PROVIDED FOR IN SECTION 3706 OF THE LABOR CODE, INTEREST AND ATTORNEY'S FEE.**

**THIS PERMIT SHALL EXPIRE BY LIMITATION IF WORK IS NOT COMMENCED WITHIN 180 DAYS.**



SCALE: 1" = 20'

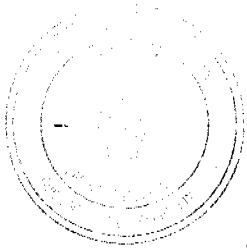

This set of plans is prepared by me or under my direct supervision and I am a duly licensed Professional Engineer in the State of California. I hereby certify that I am a duly licensed Professional Engineer in the State of California and that I am the author of these plans. I shall not be held liable for any violation of any City Ordinance or State Law.

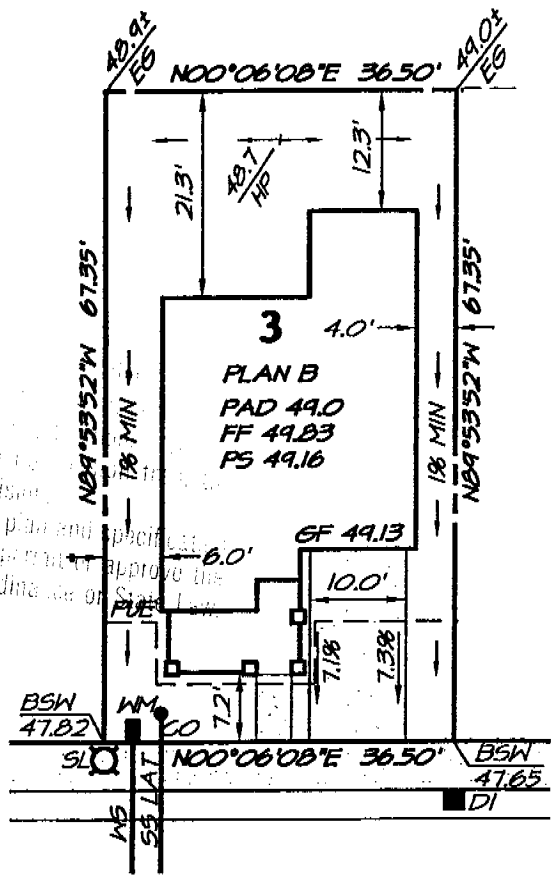

DOBBINS WAY

**LEGEND**

- Δ ANGLE OF CURVE
- L LENGTH OF CURVE
- R RADIUS OF CURVE
- BFP BACK FLOW PREVENTER
- BSW BACK OF SIDEWALK
- BW BOTTOM OF RETAINING WALL
- CB CATCH BASIN
- CO SANITARY SEWER CLEAN OUT
- DI DRAINAGE INLET
- FF FINISH FLOOR
- FG FINISH GRADE
- FH FIRE HYDRANT
- GF GARAGE FLOOR
- IOD IRREVOCABLE OFFER OF DEDICATION
- PAD PAD ELEVATION
- PSDE PRIVATE STORM DRAIN EASEMENT
- PS PROTECTIVE SLOPE
- PUE PUBLIC UTILITY EASEMENT
- SDCO STORM DRAIN CLEANOUT
- SL STREET LIGHT
- SS LAT SEWER LATERAL
- TC TOP OF CURB GRADE
- TS TOP OF SLAB GRADE
- TW TOP OF RETAINING WALL
- WM 1 1/2" WATER METER
- WS 1 1/2" WATER SERVICE
- DRAINAGE SWALE (1/8" MIN SLOPE)
- STREET LIGHT
- ▨ BACK OF SIDEWALK
- ▩ BACK OF ROLLED CURB
- LIP OF GUTTER

**PLOT PLAN  
LOT 3  
FRIENZA SUBDIVISION  
SACRAMENTO, CALIFORNIA**



3350 Watt Ave., Suite B  
Sacramento, CA 95821

V 916.488.8263  
F 916.488.1679

JULY 2005

JOB NO. 5104015.0