

CITY OF SACRAMENTO
1231 I Street, Sacramento, CA 95814

Permit No: 0209964

Insp Area: 4

Thos Bros:

Sub-Type: NSFR

Housing (Y/N): N

Site Address: 1720 EDMORE AV SAC

Parcel No: 225-1110-080

NORTHPT PARK 12 LOT 80

CONTRACTOR

LENNAR RENAISSANCE INC
2240 DOUGLAS BL
ROSEVILLE, CA 95661

OWNER

ARCHITECT

Nature of Work: NSFR MP652C 9 RMS

CONSTRUCTION LENDING AGENCY : I hereby affirm under penalty of perjury that there is a construction lending agency for the performance of the work for which this permit is issued (Sec. 3097, Civ. C).

Lender's Name _____ Lender's Address _____

LICENSED CONTRACTORS DECLARATION: I hereby affirm under penalty of perjury that I am licensed under provisions of Chapter 9 (commencing with section 7000) of Division 3 of the Business and Professions Code and my license is in full force and effect.

License Class B License Number 732348 Date 9/21/02 Contractor Signature Jeffrey J. Parat

OWNER-BUILDER DECLARATION: I hereby affirm under penalty of perjury that I am exempt from the contractors License Law for the following reason (Sec. 7031.5, Business and Professions Code; any city or county which requires a permit to construct, alter, improve, demolish, or repair any structure, prior to its issuance, also requires the applicant for such permit to file a signed statement that he or she is licensed pursuant to the provisions of the Contractors License Law (Chapter 9 (commencing with Section 7000) of Division 8 of the Business and Professions Code) or that he or she is exempt therefrom and the basis for the alleged exemption. Any violation of Section 7031.5 by any applicant for a permit subjects the applicant to a civil penalty of not more than five hundred dollars (\$500.00);

____ I, as a owner of the property, or my employees with wages as their sole compensation, will do the work, and the structure is not intended or offered for sale (Sec. 7044, Business and Professional Code: The Contractors License Law does not apply to an owner of property who builds or improves thereon, and who does such work himself or herself or through his/her own employees, provided that such improvements are not intended or offered for sale. If, however, the building or improvement is sold within one year of completion, the owner-builder will have the burden of proving that he/she did not build or improve for the purpose of sale.)

____ I, as owner of the property, am exclusively contracting with licensed contractors to construct the project (Sec. 7044, Business and Professions Code: The Contractors License Law does not apply to an owner of property who builds or improves thereon, and who contracts for such projects with a contractor(s) licensed pursuant to the Contractors License Law).

____ I am exempt under Sec. _____ B & PC for this reason: _____

Date _____ Owner Signature _____

IN ISSUING THIS BUILDING PERMIT, the applicant represents, and the city relies on the representation of the applicant, that the applicant verified all measurements and locations shown on the application or accompanying drawings and that the improvement to be constructed does not violate any law or private agreement relating to permissible or prohibited locations for such improvements. This building permit does not authorize any illegal location of any improvement or the violation of any private agreement relating to location of improvements.

I certify that I have read this application and state that all information is correct. I agree to comply with all city and county ordinances and state laws relating to building construction and hereby authorize representative(s) of this city to enter upon the above-mentioned property for inspection purposes.

Date 9/21/02 Applicant/Agent Signature Jeffrey J. Parat

WORKER'S COMPENSATION DECLARATION: I hereby affirm under penalty of perjury one of the following declarations:

____ I have and will maintain a certificate of consent to self-insure for workers' compensation as provided for by Section 3700 of the Labor Code, for the performance of work for which the permit is issued.

____ I have and will maintain workers' compensation insurance, as required by Section 3700 of the Labor Code, for the performance of the work for which this permit is issued. My workers' compensation insurance carrier and policy number are:

Carrier OLD REPUBLIC INS. CO. Policy Number MWC10815000 Exp Date 11/01/2002

____ (This section need not be completed if the permit is for \$100 or less) I certify that in the performance of the work for which this permit is issued, I shall not employ any person in any manner so as to become subject to the workers' compensation laws of California and agree that if I should become subject to the workers' compensation provisions of Section 3700 of the Labor Code, I shall forthwith comply with those provisions.

Date 9/21/02 Applicant Signature Jeffrey J. Parat

WARNING: FAILURE TO SECURE WORKER'S COMPENSATION COVERAGE IS UNLAWFUL AND SHALL SUBJECT AN EMPLOYER TO CRIMINAL PENALTIES AND CIVIL FINES UP TO ONE HUNDRED THOUSAND DOLLARS (\$100,000) IN ADDITION TO THE COST OF COMPENSATION, DAMAGES AS PROVIDED FOR IN SECTION 3706 OF THE LABOR CODE, INTEREST AND ATTORNEY'S FEE.

THIS PERMIT SHALL EXPIRE BY LIMITATION IF WORK IS NOT COMMENCED WITHIN 180 DAYS.

RESIDENTIAL BUILDING PERMIT APPLICATION
 New Construction Addition Remodels Other

Lot: 80

Project Address: 1720 Edgemere Ave Assessor Parcel # 225-110-080-00

OWNER INFORMATION: North Pointe Park IZ

Legal Property Owner: LENNAR RENAISSANCE Phone # (916) 773-7471
Owner Address: 2240 DOUGLAS BLVD. City ROSEVILLE State CA Zip 95601

CONTRACTOR INFORMATION:

Contractor: LENNAR RENAISSANCE Lic. # 732343 Phone # (916) 773-7471 Fax # (916) 773-4186

PROJECT INFORMATION:

Land Use Zone R/A Occupancy Group R3 Construction Type UN Fed Code 1A
No. of stories: 1 No. of rooms: X Street width: 40'
1st Floor Area 274 2nd Floor Area Basement N/A Roof Material TILE

AREA IN SQUARE FOOT OF:	EXISTING	NEW
Dwelling/Living	_____	<u>274</u>
Garage/Storage	_____	<u>660 662</u>
Decks/Balconies	_____	_____
Porches	_____	_____

SCOPE OF WORK: NEW CONSTRUCTION SED

FOR OFFICE USE ONLY

- Information above complete AR Flood Waiver required Planning Approval
- Violation files checked Flood Elevation Certificate Required Design Review Approval
- Standard setbacks Water Development Infill Area Special Fee District App.
- County Sewer

NEW STRUCTURES & ADDITIONS

THE FOLLOWING MUST BE PROVIDED IN ORDER TO SUBMIT FOR PLAN REVIEW:

- 2 COMPLETE PLANS, LEGIBLE & DRAWN TO SCALE * Plans to include site plan, floor plan, sections, roof/ceiling plan, foundation and structural framing details, and structural calculations for non-conforming structures
- 3 SETS IF PROJECT IS IN A DESIGN REVIEW AREA
- Title 24 Energy Compliance documentation 11" x 17" copy of floor plan for County Assessor
- Grading and Erosion Control Questionnaire Plan Review Fees

Date: _____ Received by: _____

A COUNTY PERMIT # _____

EMGEL INSULATION, INC.

CALIFORNIA CONTRACTOR'S LICENSE #745646

460 Roseville Road • Roseville, CA 95678
 (916) 786-2088 / (916) 969-6191

THIS IS TO CERTIFY THAT INSULATION HAS BEEN INSTALLED IN CONFORMANCE WITH CURRENT ENERGY REGULATIONS, CALIFORNIA ADMINISTRATIVE CODE, TITLE 24, STATE OF CALIFORNIA, IN THE BUILDING LOCATED AT:

TRACT SOMERSET LOT 010 PHASE SIX
 STREET 1720 Edgemoor CITY COLLETON

EXTERIOR WALLS: CT 2x4 2 1/2 13
 MANUFACTURER CT 2x6 6 1/4 19
 THICKNESS R-VALUE

CEILING AREA: BATTIS
 MANUFACTURER CT THICKNESS 12 R-VALUE 38

CEILINGS: BLOWN IN
 MANUFACTURER JULIE JAYE THICKNESS 1 1/2 R-VALUE 38

SQUARE FOOTAGE 2150 NUMBER OF BAGS USED 49
~~FLOOR AREA~~ 3/4

MANUFACTURER CT THICKNESS 6 1/4 R-VALUE 19

EXTERIOR KNEEWALL:
 MANUFACTURER CT THICKNESS 6 1/4 R-VALUE 19

INTERIOR KNEEWALL:
 MANUFACTURER CT THICKNESS 6 1/4 R-VALUE 19

APPLIED CAULK & SEALANT TO ALL EXTERIOR OPENINGS & PENETRATIONS
 YES NO

GENERAL CONTRACTOR _____
 CALIFORNIA CONTRACTORS LICENSE # _____ DATE _____

SIGNATURE _____ TITLE _____
 INSULATION CONT. SIGNATURE _____ DATE _____

KwikKote

No. 200-911779

Stucco System Installation Card

Job Name: SOMERSET
Address: 1720 EDGEMORE AVE.
SACRAMENTO, CA
Lot #: 0000080

Stucco System Trade Name: KWIK KOTE
Stucco System Manufacturer: KWIK KOTE CORP.

ICBO Evaluation Service, Inc.
Report No. 3607
Date of Job Completion:

Home Builder: LENNAR RENAISSANCE
Address: 2240 DOUGLAS BLVD #250
ROSEVILLE, CA

Stucco Contractor: KENYON PLASTERING, INC.
Address: PO BOX 2077
North Highlands, CA

Telephone Number: 916/349-8191

Approved Contractor Number as
issued by the Stucco Manufacturer: 1001

Card Print Date: 06/02/2003

This is to certify that the stucco system on the building exterior at the above address had been installed in accordance with the evaluation report specified above and the manufacturer's instructions.



signature of authorized representative of stucco contractor

6-2-03

Date

KwikKote

No. 200-911779

Stucco System Installation Card

Job Name: SOMERSET
Address: 1720 EDGEMORE AVE.
SACRAMENTO, CA
Lot #: 0000080

Stucco System Trade Name: KWIK KOTE
Stucco System Manufacturer: KWIK KOTE CORP.

ICBO Evaluation Service, Inc.
Report No. 3607
Date of Job Completion:

Home Builder: LENNAR RENAISSANCE
Address: 2240 DOUGLAS BLVD #250
ROSEVILLE, CA

Stucco Contractor: KENYON PLASTERING, INC.
Address: PO BOX 2077
North Highlands, CA

Telephone Number: 916/349-8191

Approved Contractor Number as
issued by the Stucco Manufacturer: 1001

Card Print Date: 06/02/2003

This is to certify that the stucco system on the building exterior at the above address had been installed in accordance with the evaluation report specified above and the manufacturer's instructions.



Signature of authorized representative of stucco contractor

6-2-03

Date



CAPITOL ENGINEERING LABORATORIES, INC.

631 Commerce Drive, Suite #200 • Roseville, California 95678 • (916) 786-2488

JOB REPORT

PAGE: _____

PROJECT NAME: B+B - Somerset FILE NO. 5317

INSPECTOR: JEAN REE DATE: 2-12-03

PERSONS CONTACTED: Demando w/STR PERMIT #: _____

REFERENCE DOCUMENTS: WBO Report 4945 WEATHER: _____

SERVICE PROVIDED: CONCRETE (INSP / SAMPLE ONLY / PU) MASONRY WELDING (SHOP / FIELD) SOILS

OTHER Epoxy Witness and Proof Load

Lot 76 - Witnessed 1-5/8" ϕ anchor epoxy set into clean 8" + holes.

Lot 77 - Proof loaded 3-5/8" ϕ anchors to 6015 #.

Lot 79 - Proof loaded 3-5/8" ϕ anchors to 6015 #.

Lot 80 - Proof loaded 1-5/8" ϕ anchor to 6015 #.

No movement on all.

COMPLIANCE OF WORK: OK

ATTACHMENTS: _____

EQUIPMENT/SUPPLIES USED: hydraulics

NEXT VISIT: _____

Jean Ree

REMARKS: _____

REVIEWED BY: _____ DATE: _____

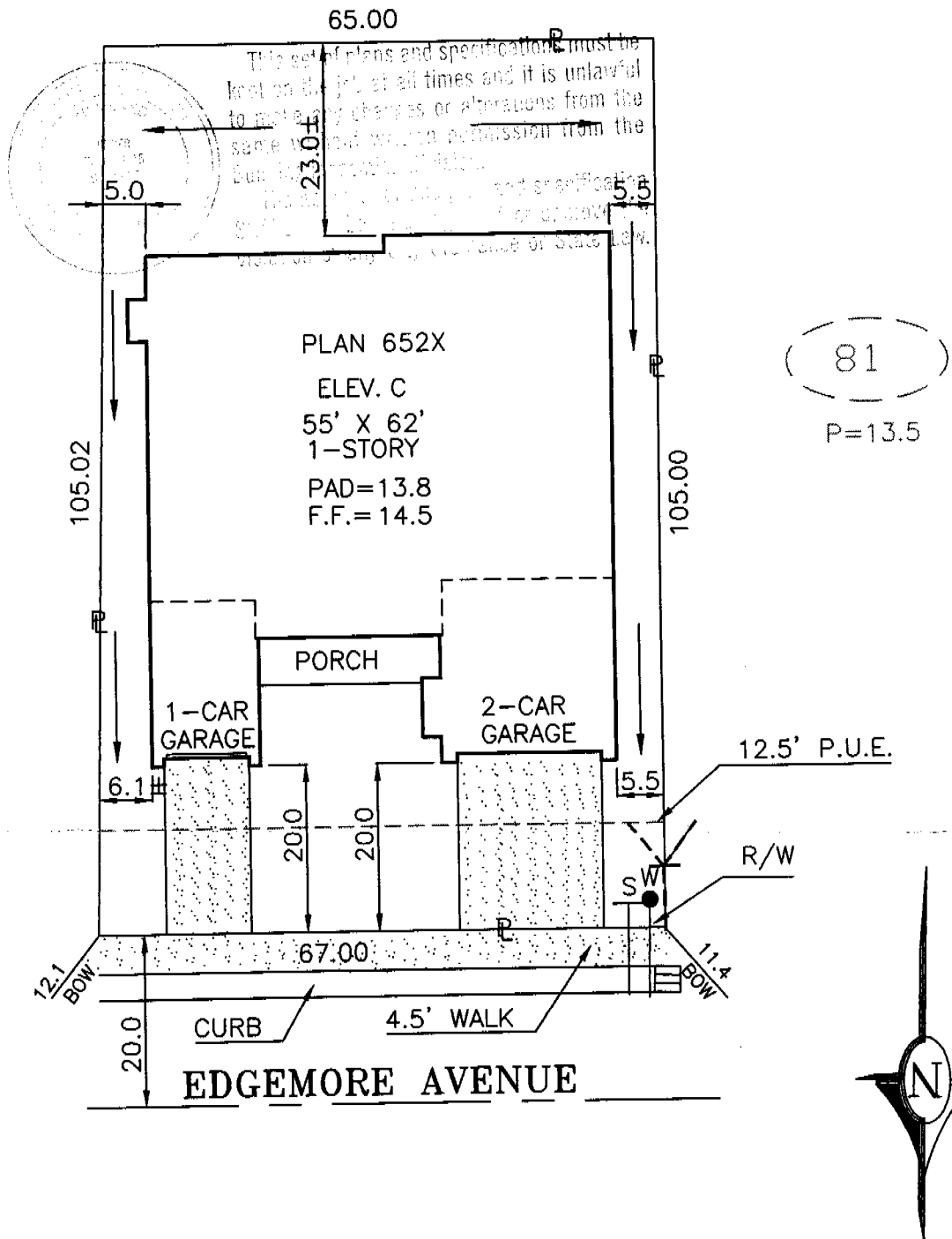

DIMENSIONS SHOWN ARE APPROXIMATE EXCEPT FOR MINIMUMS REQUIRED BY ORDINANCE. THIS PLOT DOES NOT REFLECT AS BUILT CONDITIONS AND MAY VARY FROM THIS PLAN.

RENAISSANCE HOMES 2240 DOUGLAS BLVD. SUITE 250, ROSEVILLE, CALIFORNIA 95681 PHONE (916) 773-4083 FAX (916) 773-4086	SOMERSET		PLOT PLAN
	NORTHPOINTE PARK UNIT 12 CITY OF SACRAMENTO SACTO. COUNTY CALIFORNIA		NOTES: CURVED LINES ARE CHORD MEASUREMENTS.
ADDRESS: 1720 EDGEMORE AVENUE	LOT COV: 43.7 %	APN:	LOT 80
PLAN NO.: 652X-C	LOT SQ. FT.: 6,930.0	REAR YARD COVERAGE: %	
DRAWN BY: R.P.	APPROVED BY: <i>[Signature]</i>	DATE: 6/24/02 SCALE: 1"=20'	