

CITY OF SACRAMENTO
1231 I Street, Sacramento, CA 95814

Permit No: 0404179
Insp Area: 4
Thos Bros: 277-F4

Site Address: 381 WINTER GARDEN AV SAC
Parcel No: GARDEN OAKS LOT 18 Housing (Y/N):

Sub-Type: NSFR
N

CONTRACTOR
TIM LEWIS COMMUNITIES
5750 SUNRISE BLVD
CITRUS HEIGHTS 95610

OWNER

ARCHITECT

Nature of Work: MP 1695 1 STORY 9 ROOM SFR

CONSTRUCTION LENDING AGENCY : I hereby affirm under penalty of perjury that there is a construction lending agency for the performance of the work for which this permit is issued (Sec. 3097, Civ. C).

Lender's Name _____ Lender's Address _____

LICENSED CONTRACTORS DECLARATION: I hereby affirm under penalty of perjury that I am licensed under provisions of Chapter 9 (commencing with section 7000) of Division 3 of the Business and Professions Code and my license is in full force and effect.

License Class B License Number 492827 Date 3/24/04 Contractor Signature De Ry

OWNER-BUILDER DECLARATION: I hereby affirm under penalty of perjury that I am exempt from the contractors License Law for the following reason (Sec. 7031.5, Business and Professions Code; any city or county which requires a permit to construct, alter, improve, demolish, or repair any structure, prior to its issuance, also requires the applicant for such permit to file a signed statement that he or she is licensed pursuant to the provisions of the Contractors License Law (Chapter 9 (commencing with Section 7000) of Division 8 of the Business and Professions Code) or that he or she is exempt therefrom and the basis for the alleged exemption. Any violation of Section 7031.5 by any applicant for a permit subjects the applicant to a civil penalty of not more than five hundred dollars (\$500.00);

I, as a owner of the property, or my employees with wages as their sole compensation, will do the work, and the structure is not intended or offered for sale (Sec. 7044, Business and Professional Code: The Contractors License Law does not apply to an owner of property who builds or improves thereon, and who does such work himself or herself or through his/her own employees, provided that such improvements are not intended or offered for sale. If, however, the building or improvement is sold within one year of completion, the owner-builder will have the burden of proving that he/she did not build or improve for the purpose of sale.)

I, as owner of the property, am exclusively contracting with licensed contractors to construct the project (Sec. 7044, Business and Professions Code: The Contractors License Law does not apply to an owner of property who builds or improves thereon, and who contracts for such projects with a contractor(s) licensed pursuant to the Contractors License Law).

I am exempt under Sec. _____ B & PC for this reason: _____

Date _____ Owner Signature _____

PAID
CITY OF SACRAMENTO
MAR 24 2004

IN ISSUING THIS BUILDING PERMIT, the applicant represents, and the city relies on the representation of the applicant, that the applicant verified all measurements and locations shown on the application or accompanying drawings and that the improvement to be constructed does not violate any law or private agreement relating to permissible or prohibited locations for such improvements. This building permit does not authorize any illegal location of any improvement or the violation of any private agreement relating to location of improvements.

I certify that I have read this application and state that all information is correct. I agree to comply with all city and county ordinances and state laws relating to building construction and hereby authorize representative(s) of this city to enter upon the abovementioned property for inspection purposes.

Date 3/24/04 Applicant/Agent Signature De Ry

WORKER'S COMPENSATION DECLARATION: I hereby affirm under penalty of perjury one of the following declarations:

I have and will maintain a certificate of consent to self-insure for workers' compensation as provided for by Section 3700 of the Labor Code, for the performance of work for which the permit is issued.

I have and will maintain workers' compensation insurance, as required by Section 3700 of the Labor Code, for the performance of the work for which this permit is issued. My workers' compensation insurance carrier and policy number are:

Carrier _____ Policy Number _____ Exp Date _____

(This section need not be completed if the permit is for \$100 or less) I certify that in the performance of the work for which this permit is issued, I shall not employ any person in any manner so as to become subject to the workers' compensation laws of California and agree that if I should become subject to the workers' compensation provisions of Section 3700 of the Labor Code, I shall forthwith comply with those provisions.

Date 3/24/04 Applicant Signature De Ry

WARNING: FAILURE TO SECURE WORKER'S COMPENSATION COVERAGE IS UNLAWFUL AND SHALL SUBJECT AN EMPLOYER TO CRIMINAL PENALTIES AND CIVIL FINES UP TO ONE HUNDRED THOUSAND DOLLARS (\$100,000) IN ADDITION TO THE COST OF COMPENSATION, DAMAGES AS PROVIDED FOR IN SECTION 3706 OF THE LABOR CODE, INTEREST AND ATTORNEY'S FEE.

THIS PERMIT SHALL EXPIRE BY LIMITATION IF WORK IS NOT COMMENCED WITHIN 180 DAYS.

TIM LEWIS COMMUNITIES
GARDEN OAKS SUBDIVISION
ROTATION 7
OCT. 07, 2003



Lot 17

Lot 19

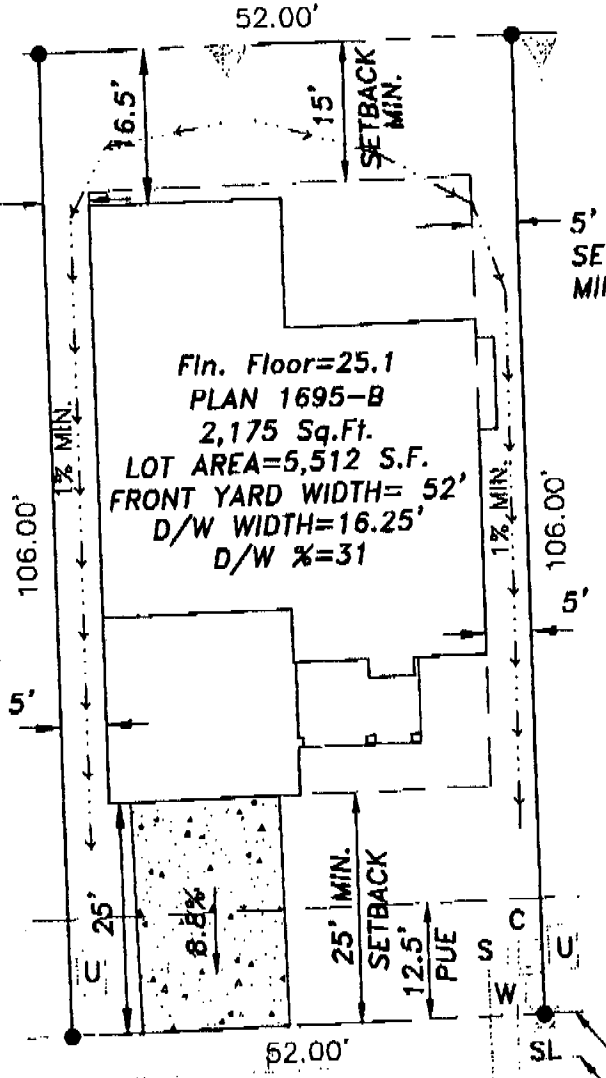

Flr. Floor=25.1
PLAN 1695-B
2,175 Sq.Ft.
LOT AREA=5,512 S.F.
FRONT YARD WIDTH= 52'
D/W WIDTH=16.25'
D/W %=31

WINTER GARDEN AVENUE

BACK OF WALK
BACK OF CURB

NOTICE TO BUYER: THIS PLOT PLAN IS PROVIDED AS A GENERAL LAYOUT OF THE PROPERTY, AND ALL INFORMATION ON THIS PLAN, INCLUDING TREE LOCATIONS AND SIZES, SETBACK DIMENSIONS, DRIVEWAY GRADES, AND WALL HEIGHTS AND LOCATIONS, ARE APPROXIMATE AND MAY VARY OR CHANGE WITHOUT PRIOR NOTICE. THE ENGINEER SHALL NOT be held to permit or approve the violation of any City Ordinance or State Law.

Plot Plan for 381 WINTER GARDEN AVENUE Lot 18

- LEGEND:**
W - WATER
S - SEWER
U - UTILITY SERVICE
C - CABLE PEDESTAL
DI - DRAIN INLET
SL - STREET LIGHT

CLAYBAR ENGINEERING
1104 ELK GROVE FLORIN ROAD
ELK GROVE, CA 95624
Ph: 916-934-7301
Fax: 916-934-3927

I:\PROJ\mapgate\LANROT-107.dwg, 12/11/03 01:22:24 PM

CERTIFICATION OF INSULATION

ADDRESS OR TRACT Tim Lewis Garden Oaks	LOT # 18	SACRAMENTO BUILDING PRODUCTS <input checked="" type="checkbox"/> P.O. BOX 854, WEST SACRAMENTO, CA 95891 LIC. #202026 <input type="checkbox"/> 1309 MELODY ROAD, MARYSVILLE, CA 95901 LIC. #202026 <input type="checkbox"/> P.O. BOX 9651, FRESNO, CA 93793-9651 LIC. #202026 <input type="checkbox"/> P.O. BOX 1631, RENO, NV 89505 LIC. #10675 <input type="checkbox"/> 3326 A PONDEROSA WAY, LAS VEGAS, NV 89116 LIC. #10675 DATE INSULATION COMPLETED
--	----------	---

WALLS			CEILING			FLOORS			
(SQUARE FEET)			(SQUARE FEET)			(SQUARE FEET)			
TYPE OF INSULATION			TYPE OF INSULATION			TYPE OF INSULATION			
MATERIAL FIBERGLASS			MATERIAL FIBERGLASS			MATERIAL FIBERGLASS			
FORM BATTS			FORM BATTS & BLOW			FORM BATTS			
MANUFACTURER'S PRODUCT I.D.			MANUFACTURER'S PRODUCT I.D.			MANUFACTURER'S PRODUCT I.D.			
MANUFACTURER			MANUFACTURER			MANUFACTURER			
CT	OC	JM	CT	OC	JM	CT	OC	JM	
BAGS									
R-VALUE INSTALLED	APPLIED THICKNESS	R-VALUE INSTALLED	APPLIED THICKNESS	MIN. INSTALLED WEIGHT PER SQUARE FOOT	R-VALUE INSTALLED	APPLIED THICKNESS			
13	3 1/2"	30	9"						
KNEE WALLS IF R-VALUE IS OTHER THAN WALLS ABOVE									
MATERIAL FIBERGLASS		FORM	BATTS		R VALUE		MANUFACTURER		
							CT	OC	JM
AIR INFILTRATION SEALANT									
MATERIAL						MANUFACTURER			
						HILTI			
						HANDY FOAM			
THIS IS TO CERTIFY THAT INSULATION AND/OR SEALANT HAS BEEN INSTALLED IN CONFORMANCE WITH APPLICABLE CODES, MATERIAL STANDARDS AND REGULATIONS									
SIGNATURE — INSULATION CONTRACTOR			JC			TITLE MANAGER		DATE 7/12/04	
SIGNATURE — GENERAL CONTRACTOR						TITLE		DATE	
REMARKS									

303 - 303