

CITY OF SACRAMENTO

Permit No: 0114809

1231 I Street, Sacramento, CA 95814

Insp Area: 4

Site Address: 2035 SHERINGTON WY SAC

Thos Bros:

**Parcel No: 225-1130-104
N**

PARKWAY PLAZA UNIT 4 LOT 28

Sub-Type: NSFR

Housing (Y/N):

CONTRACTOR

LENNAR RENAISSANCE INC
2240 DOUGLAS BL
ROSEVILLE, CA 95661

OWNER

ARCHITECT

Nature of Work: MP 1968 /OPT PLAN 133 X 2 STORY 10 ROOM SFR

CONSTRUCTION LENDING AGENCY : I hereby affirm under penalty of perjury that there is a construction lending agency for the performance of the work for which this permit is issued (Sec. 3097, Civ. C).

Lender's Name _____ Lender's Address _____

LICENSED CONTRACTORS DECLARATION: I hereby affirm under penalty of perjury that I am licensed under provisions of Chapter 9 (commencing with section 7000) of Division 3 of the Business and Professions Code and my license is in full force and effect.

License Class B License Number 732348 Date 1/8/02 Contractor Signature J. Price

OWNER-BUILDER DECLARATION: I hereby affirm under penalty of perjury that I am exempt from the contractors License Law for the following reason (Sec. 7031.5, Business and Professions Code; any city or county which requires a permit to construct, alter, improve, demolish, or repair any structure, prior to its issuance, also requires the applicant for such permit to file a signed statement that he or she is licensed pursuant to the provisions of the Contractors License Law (Chapter 9 (commencing with Section 7000) of Division 8 of the Business and Professions Code) or that he or she is exempt therefrom and the basis for the alleged exemption. Any violation of Section 7031.5 by any applicant for a permit subjects the applicant to a civil penalty of not more than five hundred dollars (\$500.00);

I, as a owner of the property, or my employees with wages as their sole compensation, will do the work, and the structure is not intended or offered for sale (Sec. 7044, Business and Professional Code: The Contractors License Law does not apply to an owner of property who builds or improves thereon, and who does such work himself or herself or through his/her own employees, provided that such improvements are not intended or offered for sale. If, however, the building or improvement is sold within one year of completion, the owner-builder will have the burden of proving that he/she did not build or improve for the purpose of sale.)

I, as owner of the property, am exclusively contracting with licensed contractors to construct the project (Sec. 7044, Business and Professions Code: The Contractors License Law does not apply to an owner of property who builds or improves thereon, and who contracts for such projects with a contractor(s) licensed pursuant to the Contractors License Law).

I am exempt under Sec. _____ B & PC for this reason: _____

Date _____ Owner Signature _____

IN ISSUING THIS BUILDING PERMIT, the applicant represents, and the city relies on the representation of the applicant, that the applicant verified all measurements and locations shown on the application or accompanying drawings and that the improvement to be constructed does not violate any law or private agreement relating to permissible or prohibited locations for such improvements. This building permit does not authorize any illegal location of any improvement or the violation of any private agreement relating to location of improvements.

I certify that I have read this application and state that all information is correct. I agree to comply with all city and county ordinances and state laws relating to building construction and hereby authorize representative(s) of this city to enter upon the abovementioned property for inspection purposes.

Date 1/8/02 Applicant/Agent Signature J. Price

WORKER'S COMPENSATION DECLARATION: I hereby affirm under penalty of perjury one of the following declarations:

I have and will maintain a certificate of consent to self-insure for workers' compensation as provided for by Section 3700 of the Labor Code, for the performance of work for which the permit is issued.

I have and will maintain workers' compensation insurance, as required by Section 3700 of the Labor Code, for the performance of the work for which this permit is issued. My workers' compensation insurance carrier and policy number are:

Carrier CNA INSURANCE COMPANY Policy Number WC138201151 PAID 05/01/2002

(This section need not be completed if the permit is for \$100 or less) I certify that in the performance of the work for which this permit is issued, I shall not employ any person in any manner so as to become subject to the workers' compensation laws, and I agree that if I should become subject to the workers' compensation provisions of Section 3700 of the Labor Code, I shall forthwith comply with those provisions.

Date 1/8/02 Applicant Signature J. Price

**PAID
CITY OF SACRAMENTO
JAN 10 2002
NEIGHBORHOODS PLANNING
AND DEVELOPMENT SERVICES**

WARNING: FAILURE TO SECURE WORKER'S COMPENSATION COVERAGE IS UNLAWFUL AND SHALL SUBJECT AN EMPLOYER TO CRIMINAL PENALTIES AND CIVIL FINES UP TO ONE HUNDRED THOUSAND DOLLARS (\$100,000) IN ADDITION TO THE COST OF COMPENSATION, DAMAGES AS PROVIDED FOR IN SECTION 3706 OF THE LABOR CODE, INTEREST AND ATTORNEY'S FEE.

THIS PERMIT SHALL EXPIRE BY LIMITATION IF WORK IS NOT COMMENCED WITHIN 180 DAYS.

#28

OMEGA PRODUCTS INTERNATIONAL, INC.

DIAMOND WALL INSULATING STUCCO SYSTEM

JOB ADDRESS:

ICBO Report #4004

RENAISSANCE SANDALWOOD

Date of Job Completion 9/4/04

PLASTERING CONTRACTOR:

Name: Stucco Works, Inc.

Address: 5920 Warehouse way Sacramento, CA. 95826

Telephone No: (916) 383-6699

Contractor Number of Diamond Wall System 2175

This is to certify that the exterior coating system on the building exterior at the above address has been installed in accordance with the evaluation report specified above and the manufacturer's instructions.

Date 10/4/04

[Signature]
Signature of authorized representative of
Plastering Contractor

This installation card must be presented to the building inspector after

CERTIFICATION OF INSULATION

ADDRESS OR TRACT

RENAISSANCE

LOT # **28**

SANDALWOOD

SACRAMENTO BUILDING PRODUCTS

- P.O. BOX 854, WEST SACRAMENTO, CA 95691 LIC. #202026
- 1309 MELODY ROAD, MARYSVILLE, CA 95901 LIC. #202026
- P.O. BOX 9651, FRESNO, CA 93793-9651 LIC. #202026
- P.O. BOX 1631, RENO, NV 89505 LIC. #10675
- 3326 A PONDEROSA WAY, LAS VEGAS, NV 89118 LIC. #10675

DATE INSULATION COMPLETED **8-20-02**

PART I GENERAL

PART II AREAS INSULATED

PART III CERTIFICATION

WALLS			CEILING			FLOORS		
(SQUARE FEET)			(SQUARE FEET)			(SQUARE FEET)		
TYPE OF INSULATION			TYPE OF INSULATION			TYPE OF INSULATION		
MATERIAL FIBERGLASS			MATERIAL FIBERGLASS			MATERIAL FIBERGLASS		
FORM BATTS			FORM BATTS & BLOW			FORM BATTS		
MANUFACTURER'S PRODUCT I.D.			MANUFACTURER'S PRODUCT I.D.			MANUFACTURER'S PRODUCT I.D.		
MANUFACTURER			MANUFACTURER			MANUFACTURER		
CT	OC	JM	CT	OC	JM	CT	OC	JM
BAGS								
R-VALUE INSTALLED	APPLIED THICKNESS	R-VALUE INSTALLED	APPLIED THICKNESS	MIN. INSTALLED WEIGHT PER SQUARE FOOT	R-VALUE INSTALLED	APPLIED THICKNESS	R-VALUE INSTALLED	APPLIED THICKNESS
13 19	3 1/2" 5 1/2"	30	9"					
KNEE WALLS IF R-VALUE IS OTHER THAN WALLS ABOVE								
MATERIAL FIBERGLASS		FORM BATTS		R VALUE		MANUFACTURER		
						CT	OC	JM
AIR INFILTRATION SEALANT								
MATERIAL FOAM						MANUFACTURER		
						HILTI	HANDY FOAM	

THIS IS TO CERTIFY THAT INSULATION AND/OR SEALANT HAS BEEN INSTALLED IN CONFORMANCE WITH APPLICABLE CODES, MATERIAL STANDARDS AND REGULATIONS.

SIGNATURE — INSULATION CONTRACTOR <i>Jeff Cable</i>	TITLE MANAGER	DATE 8-21-02
SIGNATURE — GENERAL CONTRACTOR	TITLE	DATE

REMARKS



CAPITOL ENGINEERING LABORATORIES, INC.

631 Commerce Drive, Suite #200 • Roseville, California 95678 • (916) 786-2488

JOB REPORT

PAGE: 1

PROJECT NAME: _____

FILE NO. 5317

INSPECTOR: [Signature]

DATE: 7-19-00

PERSONS CONTACTED: _____

PERMIT #: _____

REFERENCE DOCUMENTS: _____

WEATHER: _____

SERVICE PROVIDED: CONCRETE (INSP / SAMPLE ONLY / PU) MASONRY WELDING (SHOP / FIELD) SOILS

OTHER _____

1.5 cu yd of concrete for 2' x 2' x 4' wall
10/5/00 per [Signature]

COMPLIANCE OF WORK: [Signature]

ATTACHMENTS: _____

EQUIPMENT/SUPPLIES USED: [Signature]

NEXT VISIT: _____

REMARKS: _____

REVIEWED BY: [Signature] DATE: 7-19

RESIDENTIAL BUILDING PERMIT APPLICATION

New Construction

Addition

Remodels

Other #28 --

Project Address: 2035 Sherington Way Assessor Parcel # _____

OWNER INFORMATION: Parkway Plaza Village #4

Legal Property Owner: LENNAR RENAISSANCE Phone # (916) 773-7471
 Owner Address: 1240 DOUGLAS BLVD. City ROSEVILLE State CA Zip 95601

CONTRACTOR INFORMATION:

Contractor: LENNAR RENAISSANCE Lic. # 132343 Phone # (916) 773-7471 Fax # (916) 773-4086

PROJECT INFORMATION:

Land Use Zone R/A Occupancy Group R3 Construction Type UN Fed Code 1A

No. of stories: _____ No. of rooms: _____ Street width: 40'

1st Floor Area 1162 2nd Floor Area 975 Basement N/A Roof Material TILE

AREA IN SQUARE FOOT OF:	EXISTING	NEW
Dwelling/Living	_____	<u>2137</u>
Garage/Storage	_____	<u>4167</u>
Decks/Balconies	_____	_____
Carports	_____	_____

SCOPE OF WORK: NEW CONSTRUCTION SFD

FOR OFFICE USE ONLY

- Information above complete
- Violation files checked
- Standard setbacks
- County Sewer
- AD Flood Waiver required
- Flood Elevation Certificate Required
- Water Development Infill Area
- Planning Approval
- Design Review Approval
- Special Fee District Apply _____

NEW STRUCTURES & ADDITIONS

(THE FOLLOWING MUST BE PROVIDED IN ORDER TO SUBMIT FOR PLAN REVIEW)

- 2 COMPLETE PLANS, LEGIBLE & DRAWN TO SCALE
- 3 SETS IF PROJECT IS IN A DESIGN REVIEW AREA
- Title 24 Energy Compliance documentation
- Grading and Erosion Control Questionnaire
- Plans to include site plan, floor plan, elevations, roof/ceiling plan, foundation and structural framing details, and structural calculations for non-conforming structures.
- 1/4" x 1/4" copy of floor plan for County Assessor
- Plan Review Fees

Date: _____

Received by: staff _____

ACTIVITY PERMIT # _____

27
P=14.0

29
P=13.6

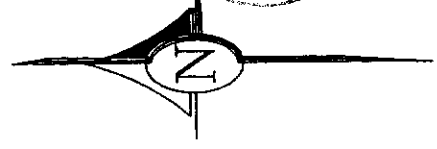
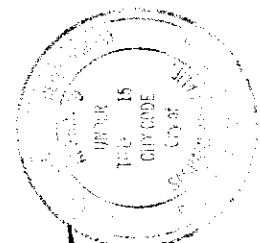
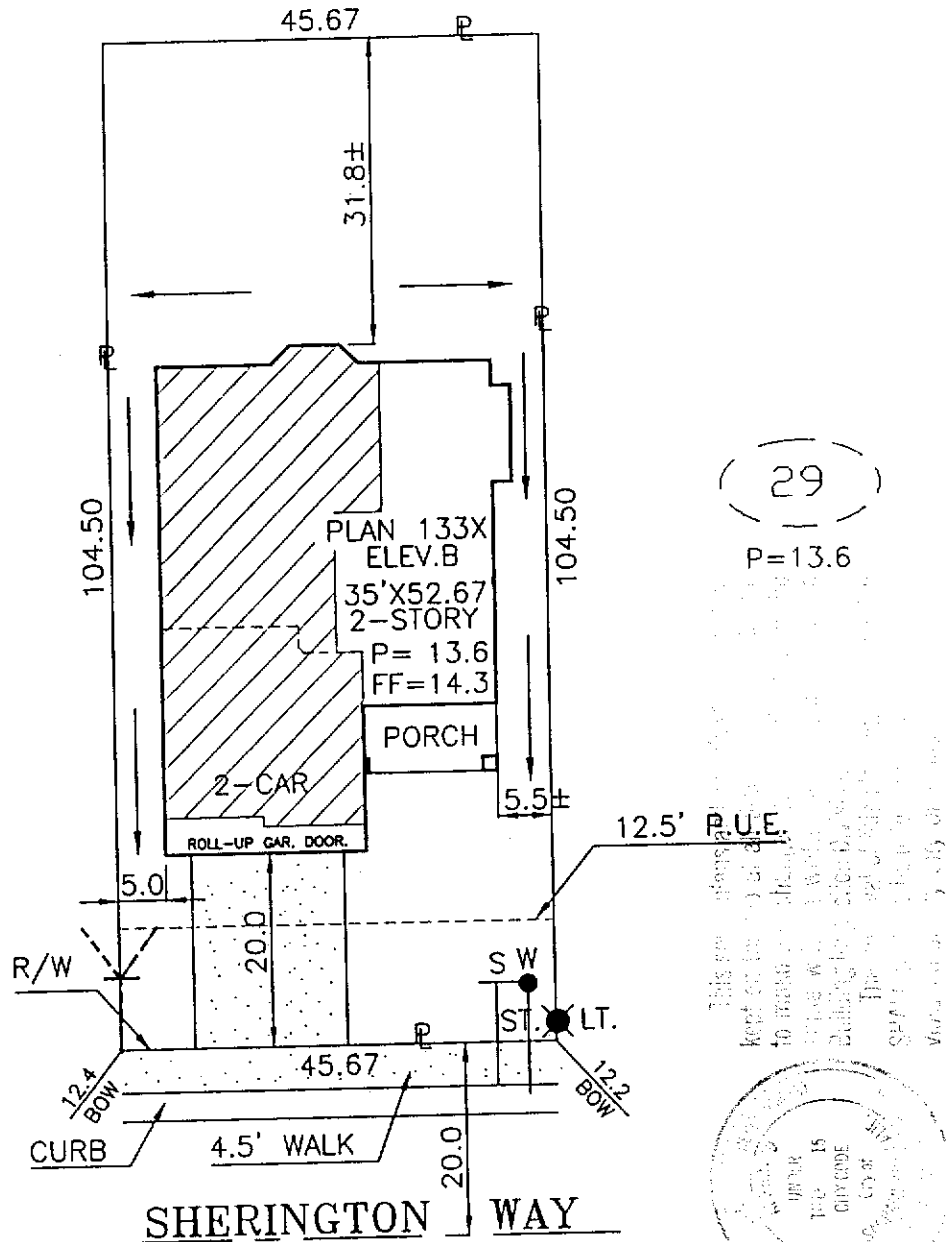

DIMENSIONS SHOWN ARE APPROXIMATE EXCEPT FOR MINIMUMS REQUIRED BY ORDINANCE. THIS PLOT DOES NOT REFLECT AS BUILT CONDITIONS AND MAY VARY FROM THIS PLAN.

<h1>RENAISSANCE HOMES</h1> <p>2240 DOUGLAS BLVD. SUITE 250 ROSEVILLE, CA. 95661 PHONE (916) 773-4083 FAX (916) 773-4086</p>	SANDALWOOD		PLOT PLAN NOTES:
	PARKWAY PLAZA UNIT 4 CITY OF SACRAMENTO SACTO. COUNTY, CALIFORNIA		
ADDRESS: 2035 SHERINGTON WAY	LOT COV: 33 %	APN:	LOT 28
PLAN NO.: 133X-B	LOT SQ. FT.: 4,772.5	REAR YARD COVERAGE: %	
DRAWN BY: R.P.	APPROVED BY: <i>[Signature]</i>	DATE: 8/8/01 SCALE: 1"=20'	