

**CITY OF SACRAMENTO**  
1231 I Street, Sacramento, CA 95814

**Permit No: 0303874**

**Insp Area: 4**

**Thos Bros:**

**Sub-Type: NSFR**

**Housing (Y/N): N**

**Site Address: 610 REGENCY PARK CR SAC**

**Parcel No: 201-0810-020**

**NORTHPT PK 21 LOT 32**

**CONTRACTOR**

FORECAST HOMES  
1796 TRIBUTE RD. STE 100, SAC. CAL.  
95815

**OWNER**

**ARCHITECT**

**Nature of Work: SFR MP 1765 1 STORY 7 ROOMS**

**CONSTRUCTION LENDING AGENCY :** I hereby affirm under penalty of perjury that there is a construction lending agency for the performance of the work for which this permit is issued (Sec. 3097, Civ. C).

Lender's Name \_\_\_\_\_ Lender's Address \_\_\_\_\_

**LICENSED CONTRACTORS DECLARATION:** I hereby affirm under penalty of perjury that I am licensed under provisions of Chapter 9 (commencing with section 7000) of Division 3 of the Business and Professions Code and my license is in full force and effect.

License Class B License Number 685513 Date \_\_\_\_\_ Contractor Signature [Signature]

**OWNER-BUILDER DECLARATION:** I hereby affirm under penalty of perjury that I am exempt from the contractors License Law for the following reason (Sec. 7031.5, Business and Professions Code; any city or county which requires a permit to construct, alter, improve, demolish, or repair any structure, prior to its issuance, also requires the applicant for such permit to file a signed statement that he or she is licensed pursuant to the provisions of the Contractors License Law (Chapter 9 (commencing with Section 7000) of Division 8 of the Business and Professions Code) or that he or she is exempt therefrom and the basis for the alleged exemption. Any violation of Section 7031.5 by any applicant for a permit subjects the applicant to a civil penalty of not more than five hundred dollars (\$500.00);

\_\_\_\_ I, as a owner of the property, or my employees with wages as their sole compensation, will do the work, and the structure is not intended or offered for sale (Sec. 7044, Business and Professional Code: The Contractors License Law does not apply to an owner of property who builds or improves thereon, and who does such work himself or herself or through his/her own employees, provided that such improvements are not intended or offered for sale. If, however, the building or improvement is sold within one year of completion, the owner-builder will have the burden of proving that he/she did not build or improve for the purpose of sale.)

\_\_\_\_ I, as owner of the property, am exclusively contracting with licensed contractors to construct the project (Sec. 7044, Business and Professions Code: The Contractors License Law does not apply to an owner of property who builds or improves thereon, and who contracts for such projects with a contractor(s) licensed pursuant to the Contractors License Law).

\_\_\_\_ I am exempt under Sec. \_\_\_\_\_ B & PC for this reason: \_\_\_\_\_

Date \_\_\_\_\_ Owner Signature \_\_\_\_\_

**PAID**

**IN ISSUING THIS BUILDING PERMIT,** the applicant represents, and the city relies on the representation of the applicant, that the applicant verified all measurements and locations shown on the application or accompanying drawings and that the improvement to be constructed does not violate any law or private agreement relating to permissible or prohibited locations for such improvements. This building permit does not authorize any illegal location of any improvement or the violation of any private agreement relating to location of improvements.

**CITY OF SACRAMENTO**  
NORTH PT PERMIT

I certify that I have read this application and state that all information is correct. I agree to comply with all city and county ordinances and state laws relating to building construction, and hereby authorize representative(s) of this city to enter upon the abovementioned property for inspection purposes.

Date 4-01-03 Applicant/Agent Signature [Signature]

**WORKER'S COMPENSATION DECLARATION:** I hereby affirm under penalty of perjury one of the following declarations:

\_\_\_\_ I have and will maintain a certificate of consent to self-insure for workers' compensation as provided for by Section 3700 of the Labor Code, for the performance of work for which the permit is issued.

I have and will maintain workers' compensation insurance, as required by Section 3700 of the Labor Code, for the performance of the work for which this permit is issued. My workers' compensation insurance carrier and policy number are:

Carrier ZURICH AMERICAN INS CO Policy Number WC343666300 Exp Date 10/31/2002

\_\_\_\_ (This section need not be completed if the permit is for \$100 or less) I certify that in the performance of the work for which this permit is issued, I shall not employ any person in any manner so as to become subject to the workers' compensation laws of California and agree that if I should become subject to the workers' compensation provisions of Section 3700 of the Labor Code, I shall forthwith comply with those provisions.

Date 4-01-03 Applicant Signature [Signature]

**WARNING: FAILURE TO SECURE WORKER'S COMPENSATION COVERAGE IS UNLAWFUL AND SHALL SUBJECT AN EMPLOYER TO CRIMINAL PENALTIES AND CIVIL FINES UP TO ONE HUNDRED THOUSAND DOLLARS (\$100,000) IN ADDITION TO THE COST OF COMPENSATION, DAMAGES AS PROVIDED FOR IN SECTION 3706 OF THE LABOR CODE, INTEREST AND ATTORNEY'S FEE.**

**THIS PERMIT SHALL EXPIRE BY LIMITATION IF WORK IS NOT COMMENCED WITHIN 180 DAYS.**



**INSULATION CONTRACTORS  
ASSOCIATION  
OF AMERICA**

INSULATION  
CERTIFICATE  
**40297**

1321 DUKE STREET, SUITE 303 • ALEXANDRIA, VA 22314 • (703) 739-0356

THIS IS TO CERTIFY THAT INSULATION HAS BEEN INSTALLED IN CONFORMANCE WITH CURRENT ENERGY REGULATIONS, CALIFORNIA ADMINISTRATIVE CODE TITLE 24, STATE OF CALIFORNIA, IN THE BUILDING LOCATED AT:

Forecast H LOT # 2032 TRACT # Canterbury

STREET 610 Regency Park Dr CITY Sac.

**EXTERIOR WALLS:**

MANUFACTURER F/G THICKNESS/TYPE \_\_\_\_\_ R-  
VALUE \_\_\_\_\_

**CELLINGS:**

BATTS: MANUFACTURER F/G THICKNESS/TYPE 1 1/2 R-  
VALUE 30

BLOWN IN: MANUFACTURER F/G MINIMUM THICKNESS 1 1/2 R-  
VALUE 30

MANUFACTURER \_\_\_\_\_ THICKNESS/TYPE \_\_\_\_\_ R-  
VALUE \_\_\_\_\_

SQUARE FOOTAGE COVERED 1677 NUMBER OF BAGS USED 31

FLOORS: MANUFACTURER \_\_\_\_\_ THICKNESS/TYPE \_\_\_\_\_ R-  
VALUE \_\_\_\_\_

SLAB ON GRADE: MANUFACTURER \_\_\_\_\_ THICKNESS/TYPE \_\_\_\_\_ R-  
VALUE \_\_\_\_\_

MANUFACTURER \_\_\_\_\_ THICKNESS/TYPE \_\_\_\_\_ R-  
VALUE \_\_\_\_\_

WIDTH OF INSULATION \_\_\_\_\_ INCHES

FOUNDATION WALLS: MANUFACTURER \_\_\_\_\_ THICKNESS/TYPE \_\_\_\_\_ R-  
VALUE \_\_\_\_\_

MANUFACTURER \_\_\_\_\_ THICKNESS/TYPE \_\_\_\_\_ R-  
VALUE \_\_\_\_\_

GENERAL CONTRACTOR \_\_\_\_\_ DATE \_\_\_\_\_

CALIFORNIA CONTRACTORS LICENSE # \_\_\_\_\_

SIGNATURE \_\_\_\_\_

TITLE \_\_\_\_\_

**INSULATION CONTRACTOR ARCADE INSULATION**

CALIFORNIA CONTRACTORS LICENSE #815286

NEVADA CONTRACTORS LICENSE #55201

DATE \_\_\_\_\_

SIGNATURE \_\_\_\_\_

TITLE \_\_\_\_\_



# CAPITOL ENGINEERING LABORATORIES, INC.

631 Commerce Drive, Suite #200 • Roseville, California 95678 • (916) 786-2488

## JOB REPORT

PAGE: 1

PROJECT NAME: Center Buoy Forecast

FILE NO. 5277

INSPECTOR: MORRIS Felt

DATE: 5-27-03

PERSONS CONTACTED: FDUO CU

PERMIT #:

REFERENCE DOCUMENTS: ICBO #5279

WEATHER:

SERVICE PROVIDED: CONCRETE (INSP/SAMPLE ONLY/PU)  MASONRY  WELDING (SHOP/FIELD)  SOILS

OTHER  Epoxy Anchor

Lot 2033 witness the installation of two 5/8" HTTs into U-SAW Holes using Simpson set 2 1/2 Exp Date of 3/05 Embedment of 7" on South wall

COMPLIANCE OF WORK: Acceptable

ATTACHMENTS:

EQUIPMENT/SUPPLIES USED: Hydraulics

NEXT VISIT:

REMARKS:

REVIEWED BY: [Signature] DATE: 5-27-03



**BASALITE®**  
PACIFIC STUCCO SYSTEMS

4290 Roseville Road  
North Highlands, CA 95660-5710  
(916) 486-4093  
Fax (916) 486-4187

Installation Card  
Fiber Reinforced Stucco

Job Name and Address: CANTERBURY

ICBO# 5269

Lot 2032

6-20-03

610 REGENCY PARK CIR.

Date of job completion

Plastering Contractor

Name: VISION PLASTERING

Address: 8974 GREENBACK LANE ORANGEVALE, CA. 95662

Telephone No. (916) 987-3324

Approved contractor as issued by Basalite/Pacific Stucco

This is to certify the exterior coating system at the above address, has been installed in accordance with the evaluation report specified above and the manufacturers instructions.

*M. S. Smith*  
Signature of authorized representative of  
plastering contractor

7/23/03  
Date

This installation card must be presented to the building inspector after completion of work and before final inspection.

# plot plan

THIS PLOT PLAN IS FOR THE PURPOSE OF SHOWING THE HOUSE TO BE CONSTRUCTED ON THE LOT AND MAY NOT REPRESENT THE FINAL AS-BUILT CONFIGURATION OF THE PROPERTY OR IMPROVEMENTS THEREON. THE ACCURACY OF THIS PLOT PLAN IS NOT GUARANTEED, NOR IS IT A PART OF ANY POLICY, REPORT OR GUARANTEE TO WHICH IT MAY BE ATTACHED. ACTUAL DIMENSIONS, OTHER THAN THE MINIMUM ORDINANCE, MAY VARY OR CHANGE WITHOUT PRIOR NOTICE, DUE TO ACTUAL SITE CONDITIONS.

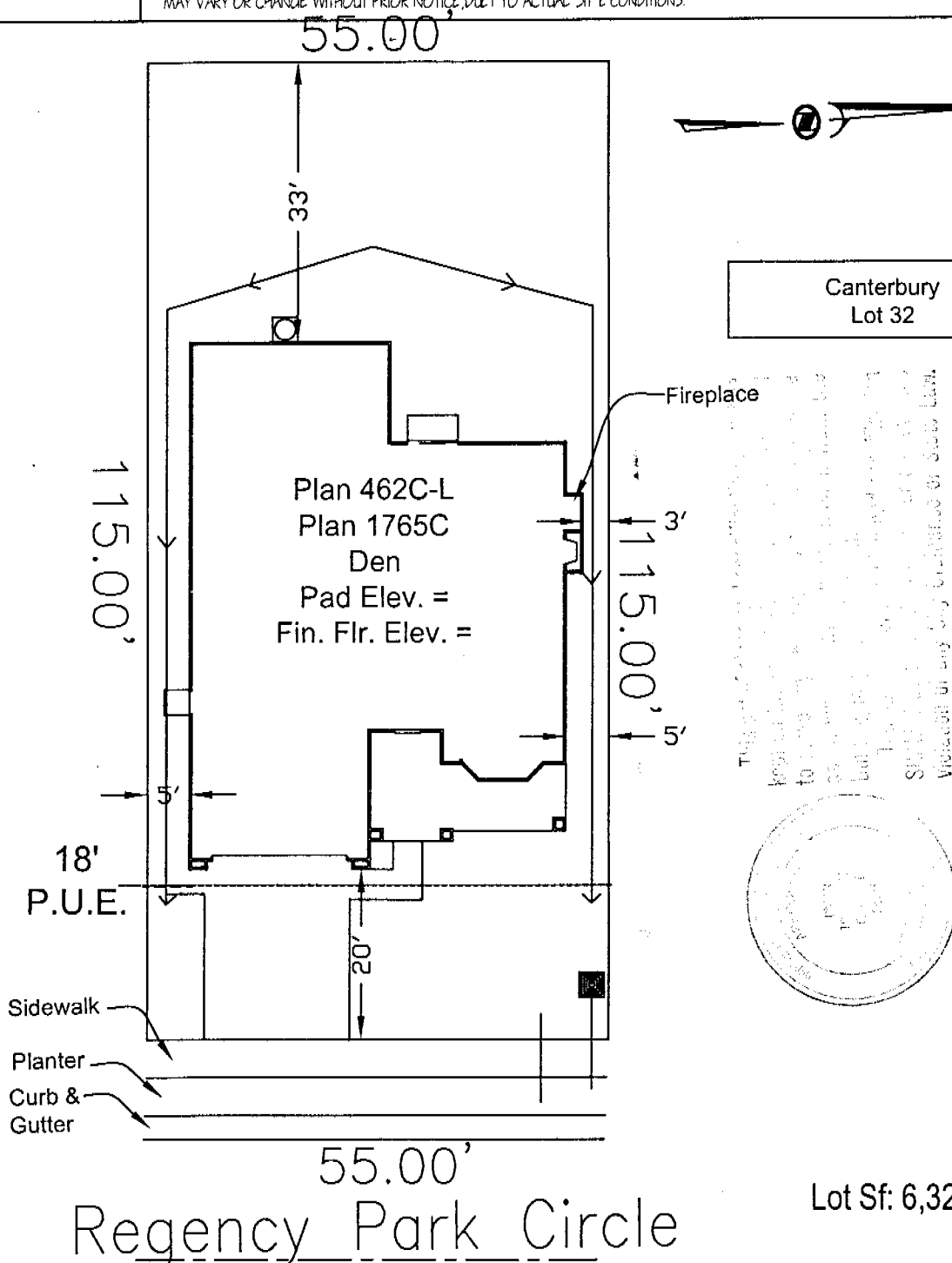

Canterbury  
Lot 32

*Faint, illegible text, possibly a title block or project information.*

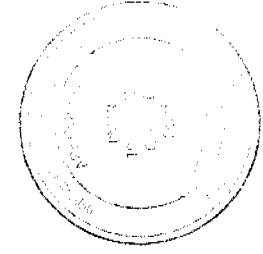

Lot Sf: 6,325

Regency Park Circle

Northpointe Park  
Village 21

The Forecast Group



Lot #32  
610 Regency Park Circle  
City of Sacramento  
A.P.N.:

Apollo  
Real  
Estate  
Group

### Symbols Legend

- |                        |  |                             |          |
|------------------------|--|-----------------------------|----------|
| Street Light:          |  | Water Service:              |          |
| Drop Inlet:            |  | Flow Line:                  |          |
| Electric Service Box:  |  | High Point:                 | FL= 23.4 |
| Fire Hydrant:          |  | Flow Line:                  |          |
| Pad-Mount Transformer: |  | Elevation Back of Sidewalk: | 173.4    |
| Sewer Service:         |  | 2nd Story Element:          |          |

6	MAH	3/17/03	1"=20'
Phase	Drawn By	Date	Scale

1204 El Sur Way  
Sacramento, CA 95864  
(916) 978-9726