

CITY OF SACRAMENTO

1231 I Street, Sacramento, CA 95814

Permit No: 0003767

Insp Area: 4

Site Address: 3 NAUTICA CT SAC

Parcel No: 274-0550-007

LOT 7 SHOREBIRD

Sub-Type: NSFR

Housing (Y/N): N

CONTRACTOR

CITATION NORTHERN
597 CENTER AVE. STE. 150
MARTINEZ CAL. 94553

OWNER

ARCHITECT

Nature of Work: MP 2322 2 STORY 9 ROOM SFR

CONSTRUCTION LENDING AGENCY : I hereby affirm under penalty of perjury that there is a construction lending agency for the performance of the work for which this permit is issued (Sec. 3097, Civ. C).

Lender's Name _____ Lender's Address _____

LICENSED CONTRACTORS DECLARATION: I hereby affirm under penalty of perjury that I am licensed under provisions of Chapter 9 (commencing with section 7000) of Division 3 of the Business and Professions Code and my license is in full force and effect.

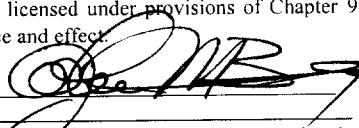
License Class B License Number 547764 Date 4-14-00 Contractor Signature 

OWNER-BUILDER DECLARATION: I hereby affirm under penalty of perjury that I am exempt from the contractors License Law for the following reason (Sec. 7031.5, Business and Professions Code; any city or county which requires a permit to construct, alter, improve, demolish, or repair any structure, prior to its issuance, also requires the applicant for such permit to file a signed statement that he or she is licensed pursuant to the provisions of the Contractors License Law (Chapter 9 (commencing with Section 7000) of Division 8 of the Business and Professions Code) or that he or she is exempt therefrom and the basis for the alleged exemption. Any violation of Section 7031.5 by any applicant for a permit subjects the applicant to a civil penalty of not more than five hundred dollars (\$500.00);

____ I, as a owner of the property, or my employees with wages as their sole compensation, will do the work, and the structure is not intended or offered for sale (Sec. 7044, Business and Professional Code: The Contractors License Law does not apply to an owner of property who builds or improves thereon, and who does such work himself or herself or through his/her own employees, provided that such improvements are not intended or offered for sale. If, however, the building or improvement is sold within one year of completion, the owner-builder will have the burden of proving that he/she did not build or improve for the purpose of sale.)

____ I, as owner of the property, am exclusively contracting with licensed contractors to construct the project (Sec. 7044, Business and Professions Code: The Contractors License Law does not apply to an owner of property who builds or improves thereon, and who contracts for such projects with a contractor(s) licensed pursuant to the Contractors License Law).

____ I am exempt under Sec. _____ B & PC for this reason: _____

Date _____ Owner Signature 

IN ISSUING THIS BUILDING PERMIT, the applicant represents, and the city ~~upon the representation of the applicant,~~ that the applicant verified all measurements and locations shown on the application or accompanying drawings ~~and that the improvement to be constructed~~ does not violate any law or private agreement relating to permissible or prohibited locations for such improvements. This building permit does not authorize any illegal location of any improvement or the violation of any private agreement relating to location of improvements.

I certify that I have read this application and state that all information is correct. I agree to comply with all city and county ordinances and state laws relating to building construction and herby authorize representative(s) of this city to enter upon the above mentioned property for inspection purposes.

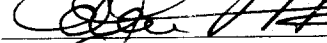
Date 4-14-00 Applicant/Agent Signature 

WORKER'S COMPENSATION DECLARATION: I hereby affirm under penalty of perjury one of the following declarations:

____ I have and will maintain a certificate of consent to self-insure for workers' compensation as provided for by Section 3700 of the Labor Code, for the performance of work for which the permit is issued.

____ I have and will maintain workers' compensation insurance, as required by Section 3700 of the Labor Code, for the performance of the work for which this permit is issued. My workers' compensation insurance carrier and policy number are:

Carrier FREMONT IND. CO. Policy Number WN99-70750-03 Exp Date 6/30/2000

____ (This section need not be completed if the permit is for \$100 or less) I certify that in the performance of the work for which this permit is issued, I shall not employ any person in any manner so as to become subject to the workers' compensation laws of California and agree that if I should become subject to the workers' compensation provisions of Section 3700 of the Labor Code, I shall forthwith comply with those provisions.

Date 4-14-00 Applicant Signature 

WARNING: FAILURE TO SECURE WORKER'S COMPENSATION COVERAGE IS UNLAWFUL AND SHALL SUBJECT AN EMPLOYER TO CRIMINAL PENALTIES AND CIVIL FINES UP TO ONE HUNDRED THOUSAND DOLLARS (\$100,000) IN ADDITION TO THE COST OF COMPENSATION, DAMAGES AS PROVIDED FOR IN SECTION 3706 OF THE LABOR CODE, INTEREST AND ATTORNEY'S FEE.

THIS PERMIT SHALL EXPIRE BY LIMITATION IF WORK IS NOT COMMENCED WITHIN 180 DAYS.

SHOREBIRD
LOT 7

RESIDENTIAL BUILDING PERMIT APPLICATION

- New Construction
- Addition
- Remodels
- Other

Project Address: 3 NAUTICA COURT Assessor Parcel # 274-0550-007

OWNER INFORMATION:

Legal Property Owner: Citation Northern Phone # (925) 372-0300
 Owner Address: 597 Center Avenue, #150 City Martinez State CA Zip 94553

CONTRACTOR INFORMATION:

Contractor: Citation Northern Lic. # 547764 Phone # 925-372-0300, 925-228-1833

PROJECT INFORMATION:

Land Use Zone _____ Occupancy Group _____ Construction Type _____ Fed Code _____
 No. of stories: 2 No. of rooms: 9 Street width: 46' R/W
 1st Floor Area 1,241 2nd Floor Area 1,081 Basement _____ Roof Material TILE

AREA IN SQUARE FOOT OF:	EXISTING	NEW
Dwelling/Living	_____	<u>2,322</u>
Garage/Storage	_____	<u>635</u>
Decks/Balconies	_____	_____
Carpports	_____	_____

SCOPE OF WORK: single family Plan 23 MASTER

FOR OFFICE USE ONLY

- Information above complete
- AR Flood Waiver required
- Planning Approval
- Violation files checked
- Flood Elevation Certificate Required
- Design Review Approval
- Standard setbacks
- Water Development Infill Area
- Special Fee Districts Apply: _____
- County Sewer

NEW STRUCTURES & ADDITIONS

◆ THE FOLLOWING MUST BE PROVIDED IN ORDER TO SUBMIT FOR PLAN REVIEW

- 2 COMPLETE PLANS, LEGIBLE & DRAWN TO SCALE ◆ Plans to include: site plan, floor plan, elevations, roof/ceiling plan, foundation and structural framing details, and structural calculations for non-conforming structures.
- 3 SETS IF PROJECT IS IN A DESIGN REVIEW AREA
- Title 24 Energy Compliance documentation
- 11" x 17" copy of floor plan for County Assessor
- Grading and Erosion Control Questionnaire
- Plan Review Fees

Date: _____ Received by: (staff) _____



MATERIALS TESTING, INC./KC ENGINEERING COMPANY
SPECIAL INSPECTION / CONCRETE TESTING
FIELD REPORT & DATA

Project No. VV 072 Client Name: Citation Northeen Date: 5-22-00

Project Name & Location: Shore Birds S&C

Special Inspection/Tests Performed: Pt. moisture Hardware - STEEL

Foundation Type: Pt's Plans by & Date: _____

The following was noted: INSPECTED Cable moisture (probe) Hardware
(observations, comments & items requiring correction)

+ STEEL REINFORCEMENT FOR CONFORMANCE TO PLANS & SPECIFICATIONS

FOR LOTS - 7-12-13 - ALL ITEMS WERE LOCATED & SET IN ACCORDANCE TO PLAN SPECIFICATIONS

GIVEN CITY APPROVAL THESE LOTS ARE READY FOR CONCRETE PLACEMENT.

Material Description:	Strength Requirement (p.s.i.):
Sample Type:	Supplier:
Samples Cast By:	Date Cast:
Laboratory:	Weather:

Test Samples @: 3 Days _____ 5 Days _____ 7 Days _____ 10 Days _____ 14 Days _____ 28 Days _____ Other _____

No. of Cyl.	Mix No.	Location	Air Content (%)	Slump or Kelly Ball	Unit Weight	Air Temp.	Mix Temp.	Ticket No.

To the best of my knowledge work inspected was in accordance with the Building Department approved design drawings, specifications & applicable workmanship provisions of the UBC except as noted above.

INSPECTOR: Paul Lott DATE: 5-22-00

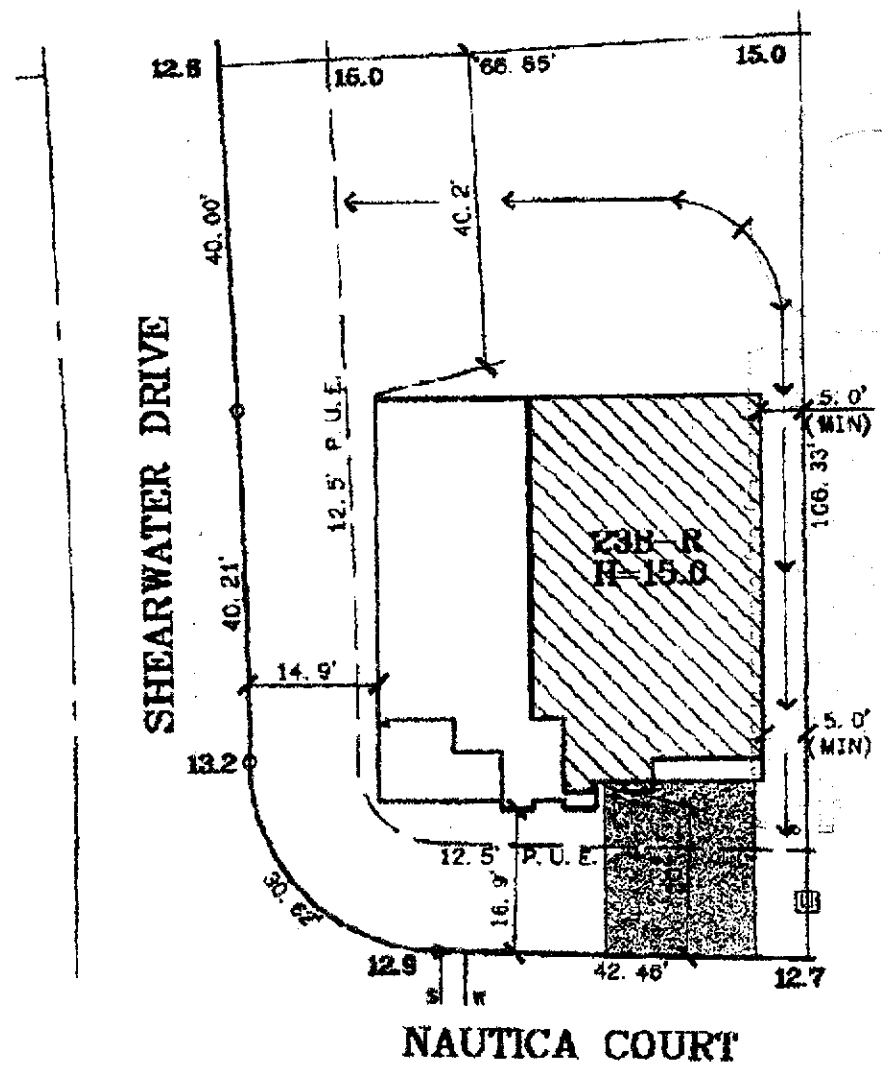

DATE 3-14-00

A.P.N.:

ADDRESS: NAUTICA COURT

LOT AREA: 6,626 SF
LOT COVERAGE: 30%

The Splink Corporation
 2590 VENTURE OAKS WAY
 SACRAMENTO, CA 95833
 PH (916)923-5550 FAX (916)921-9274

**SHOREBIRD
 UNIT NO. 1
 LOT 7
 PLAN 23B**

SHOREBIRD
 CITY OF SACRAMENTO, CA
 CLIENT: CITATION NORTHERN
 JOB NO.: 1579-001