

**CITY OF SACRAMENTO**  
1231 I Street, Sacramento, CA 95814

**Permit No: 0011647**

**Insp Area: 2**

**Site Address: 7836 JACINTO RD SAC**

Parcel No: 117-1360-003

JACINTO VILLAGE LOT 3

Sub-Type: NSFR

Housing (Y/N): N

**CONTRACTOR**

BEAZER HOMES  
3009 DOUGLAS BL #150  
ROSEVILLE CA 95661

**OWNER**

**ARCHITECT**

**Nature of Work: NSFR MP1232 5 RMS**

**CONSTRUCTION LENDING AGENCY :** I hereby affirm under penalty of perjury that there is a construction lending agency for the performance of the work for which this permit is issued (Sec. 3097, Civ. C).

Lender's Name \_\_\_\_\_ Lender's Address \_\_\_\_\_

**LICENSED CONTRACTORS DECLARATION:** I hereby affirm under penalty of perjury that I am licensed under provisions of Chapter 9 (commencing with section 7000) of Division 3 of the Business and Professions Code and my license is in full force and effect.

License Class B License Number 724191 Date 10/4/00 Contractor Signature Sheuyf Van Maeren

**OWNER-BUILDER DECLARATION:** I hereby affirm under penalty of perjury that I am exempt from the contractors License Law for the following reason (Sec. 7031.5, Business and Professions Code; any city or county which requires a permit to construct, alter, improve, demolish, or repair any structure, prior to its issuance, also requires the applicant for such permit to file a signed statement that he or she is licensed pursuant to the provisions of the Contractors License Law (Chapter 9 (commencing with Section 7000) of Division 8 of the Business and Professions Code) or that he or she is exempt therefrom and the basis for the alleged exemption. Any violation of Section 7031.5 by any applicant for a permit subjects the applicant to a civil penalty of not more than five hundred dollars (\$500.00):

\_\_\_\_\_, I, as a owner of the property, or my employees with wages as their sole compensation, will do the work, and the structure is not intended or offered for sale (Sec. 7044, Business and Professional Code: The Contractors License Law does not apply to an owner of property who builds or improves thereon, and who does such work himself or herself or through his/her own employees, provided that such improvements are not intended or offered for sale. If, however, the building or improvement is sold within one year of completion, the owner-builder will have the burden of proving that he/she did not build or improve for the purpose of sale.)

\_\_\_\_\_, I, as owner of the property, am exclusively contracting with licensed contractors to construct the project (Sec. 7044, Business and Professions Code: The Contractors License Law does not apply to an owner of property who builds or improves thereon, and who contracts for such projects with a contractor(s) licensed pursuant to the Contractors License Law).

\_\_\_\_\_, I am exempt under Sec. \_\_\_\_\_ B & PC for this reason: \_\_\_\_\_

Date \_\_\_\_\_ Owner Signature \_\_\_\_\_

**IN ISSUING THIS BUILDING PERMIT,** the applicant represents, and the city relies on the representation of the applicant, that the applicant verified all measurements and locations shown on the application or accompanying drawings and that the improvement to be constructed does not violate any law or private agreement relating to permissible or prohibited locations for such improvements. This building permit does not authorize any illegal location of any improvement or the violation of any private agreement relating to location of improvements.

I certify that I have read this application and state that all information is correct. I agree to comply with all city and county ordinances and state laws relating to building construction and hereby authorize representative(s) of this city to enter upon the abovementioned property for inspection purposes.

Date 10/4/00 Applicant/Agent Signature Sheuyf Van Maeren

**WORKER'S COMPENSATION DECLARATION:** I hereby affirm under penalty of perjury one of the following declarations:

\_\_\_\_\_, I have and will maintain a certificate of consent to self-insure for workers' compensation as provided for by Section 3700 of the Labor Code, for the performance of work for which the permit is issued.

I have and will maintain workers' compensation insurance as required by Section 3700 of the Labor Code, for the performance of the work for which this permit is issued. My workers' compensation insurance carrier and policy number are:

Carrier LIBERTY MUTUAL INS CO.

Policy Number WA2-651-004147-080

Exp Date 4/1/2001

\_\_\_\_\_, (This section need not be completed if the permit is for \$100 or less) I certify that in the performance of the work for which this permit is issued, I shall not employ any person in any manner so as to become subject to the workers' compensation laws of California and agree that \_\_\_\_\_ should become subject to the workers' compensation provisions of Section 3700 of the Labor Code, I shall forthwith comply with all provisions.

Date 10/4/00 Applicant Signature Sheuyf Van Maeren

**WARNING: FAILURE TO SECURE WORKER'S COMPENSATION COVERAGE IS UNLAWFUL AND SHALL SUBJECT AN EMPLOYER TO CRIMINAL PENALTIES AND CIVIL FINES UP TO ONE HUNDRED THOUSAND DOLLARS (\$100,000) IN ADDITION TO THE COST OF COMPENSATION, DAMAGES AS PROVIDED FOR IN SECTION 3706 OF THE LABOR CODE, INTEREST AND ATTORNEY'S FEE.**

**THIS PERMIT SHALL EXPIRE BY LIMITATION IF WORK IS NOT COMMENCED WITHIN 180 DAYS.**

### RESIDENTIAL BUILDING PERMIT APPLICATION

- New Construction    
  Addition    
  Remodels    
  Other

Project Address: 1930 JALISCO ROAD LOT 3     Assessor Parcel # 117-136-003

**OWNER INFORMATION:**

Legal Property Owner: Beazer Homes     Phone # 773-3888  
 Owner Address: 3009 Douglas Blvd. 150     City Roseville     State CA     Zip 95661

**CONTRACTOR INFORMATION:**

Contractor: Beazer Homes     Lic. # B724191     Phone # 773-3888     Fax# 773-0425

**PROJECT INFORMATION:**

Land Use Zone \_\_\_\_\_     Occupancy Group \_\_\_\_\_     Construction Type \_\_\_\_\_     Fed Code \_\_\_\_\_  
 No. of stories: 1     No. of rooms: \_\_\_\_\_     Street width: \_\_\_\_\_  
 1<sup>st</sup> Floor Area 1232     2<sup>nd</sup> Floor Area \_\_\_\_\_     Basement \_\_\_\_\_     Roof Material \_\_\_\_\_

**AREA IN SQUARE FOOT OF:**

**EXISTING**

**NEW**

Dwelling/Living	_____	<u>1232</u>
Garage/Storage	_____	<u>426</u>
Decks/Balconies	_____	_____
Carports	_____	_____

**SCOPE OF WORK:**

**FOR OFFICE USE ONLY**

- |   |   |  |
|---|---|--|
| <input type="checkbox"/> Information above complete | <input type="checkbox"/> AR Flood Waiver required             | <input type="checkbox"/> Planning Approval                   |
| <input type="checkbox"/> Violation files checked    | <input type="checkbox"/> Flood Elevation Certificate Required | <input type="checkbox"/> Design Review Approval              |
| <input type="checkbox"/> Standard setbacks          | <input type="checkbox"/> Water Development Infill Area        | <input type="checkbox"/> Special Fee Districts Apply : _____ |
| <input type="checkbox"/> County Sewer               |   |  |

**NEW STRUCTURES & ADDITIONS**

↻ THE FOLLOWING MUST BE PROVIDED IN ORDER TO SUBMIT FOR PLAN REVIEW

- 2 COMPLETE PLANS, LEGIBLE & DRAWN TO SCALE     ↻ *Plans to include: site plan, floor plan, elevations, roof/ceiling plan, foundation and structural framing details, and structural calculations for non-conforming structures.*
- 3 SETS IF PROJECT IS IN A DESIGN REVIEW AREA
- Title 24 Energy Compliance documentation
- 11" x 17" copy of floor plan for County Assessor
- Grading and Erosion Control Questionnaire
- Plan Review Fees

Date: \_\_\_\_\_

Received by: (staff) \_\_\_\_\_

ACTIVITY/PERMIT # \_\_\_\_\_

**KWIKKOTE**  
STUCCO SYSTEM  
INSTALLATION CARD

# 20992

BEAZER HOMES  
BELLEFLEUR LOT 3  
7836 JACINTO ROAD SACRAMENTO

Stucco System Trade Name: KWIK KOTE  
Name Stucco Manufacturer: KWIK KOTE CORP  
ICBO Evaluation Service, Inc. Report No. 3607  
Date of Job Completion \_\_\_\_\_

Stucco Contractor  
Name  
Address

Kenyon Plastering, Inc.  
John W. Kenyon, III  
P.O. Box 2077  
North Highlands, CA 95660  
(916) 349-8191

Telephone #

Approved Contractor Number as issued by the Stucco Manufacturer: 1

This is to certify that the stucco system on the building exterior at the above address had been installed in accordance with the evaluation report specified above and the manufacturer's instructions.

Signature of authorized representative of stucco contractor:

Date: 3-21-01

Builder Copy

# CERTIFICATION OF INSULATION

PART I GENERAL

ADDRESS OR TRACT

BEAZER

LOT #  
0003

BELLE FLUETZ

SACRAMENTO INSULATION CONTRACTORS

- P.O. BOX 854, WEST SACRAMENTO, CA 95691 LIC. #202026
- 1309 MELODY ROAD, MARYSVILLE, CA 95901 LIC. #202026
- P.O. BOX 9651, FRESNO, CA 93793-9651 LIC. #202026
- P.O. BOX 1631, RENO, NV 89505 LIC. #10675
- 3326 A PONDEROSA WAY, LAS VEGAS, NV 89118 LIC. #10675

DATE INSULATION COMPLETED

PART II AREAS INSULATED

WALLS		CEILINGS			FLOORS	
SQUARE FEET		SQUARE FEET)			( SQUARE FEET)	
TYPE OF INSULATION		TYPE OF INSULATION			TYPE OF INSULATION	
MATERIAL <b>FIBERGLASS</b>		MATERIAL <b>FIBERGLASS</b>			MATERIAL <b>FIBERGLASS</b>	
FORM <b>BATTS</b>		FORM <b>BATTS &amp; BLOW</b>			FORM <b>BATTS</b>	
MANUFACTURER'S PRODUCT I D		MANUFACTURER'S PRODUCT I D			MANUFACTURER'S PRODUCT I D	
MANUFACTURER		MANUFACTURER			MANUFACTURER	
OCF		OCF			OCF	
R - VALUE INSTALLED	APPLIED THICKNESS	R - VALUE INSTALLED	APPLIED THICKNESS	MIN. INSTALLED WEIGHT PER SQUARE FOOT	R - VALUE INSTALLED	APPLIED THICKNESS
13	3 5/8"	38 38	12 1/4" 14 3/4"			
KNEE WALLS IF R-VALUE IS OTHER THAN WALLS ABOVE						
MATERIAL <b>FIBERGLASS</b>		FORM <b>BATTS</b>		R VALUE	MANUFACTURER <b>OCF</b>	
AIR INFILTRATION SEALANT						
MATERIAL <b>FOAM</b>				MANUFACTURER <b>W R GRACE</b>		

**THIS IS TO CERTIFY THAT INSULATION AND/OR SEALANT HAS BEEN INSTALLED IN CONFORMANCE WITH APPLICABLE CODES, MATERIAL STANDARDS AND REGULATIONS.**

SIGNATURE - INSULATION CONTRACTOR <i>Bill Harkins</i>	TITLE MANAGER	DATE 2-19-01
SIGNATURE - GENERAL CONTRACTOR	TITLE	DATE

REMARKS

THIS PLOT PLAN IS NOT FOR SALES PURPOSES. THIS PLOT PLAN IS FOR THE PURPOSES OF INDICATING COMPLIANCE WITH ZONING SET BACKS, GENERAL DRAINAGE DIRECTION, AND APPROXIMATE UTILITY CONNECTION. ALL OTHER DATA SHOWN HEREON IS CONCEPTUAL. THIS PLOT PLAN DOES NOT REFLECT AS-BUILT CONDITION. RETAINING WALLS ARE OPTIONAL AND MAY OR MAY NOT BE CONSTRUCTED.

- W — WATER METER BOX
- E — ELECTRICAL BOX
- U — UTILITY RISERS
- S — SEWER CLEANOUT
- T — TELEPHONE PED.
- — DRAIN INLET

# JACINTO RD.

FRONT YARD  
VARIABLE  
SETBACK  
15'-26'(TYP)

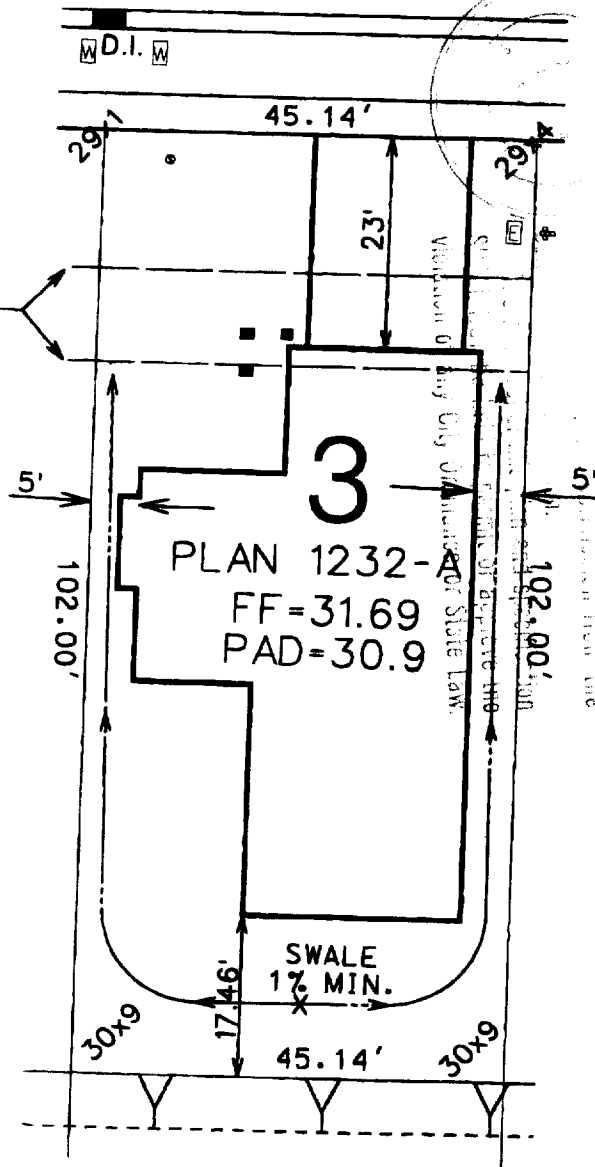

ZONING/A.P.N. APPROVAL	
DATE	INITIALS

SCALE: 1"=20'

4606 SQUARE FEET

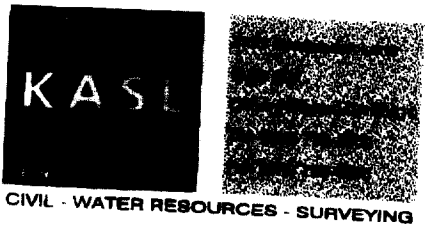

PLOT PLAN FOR  
LOT 3  
JACINTO VILLAGE SOUTH  
A.P.N. 117-1360-003  
ADDRESS:  
COUNTY: SACRAMENTO

SCALE: 1"=20'  
DATE: 09-06-00  
REVISED:  
DRAWN BY: PRA  
CHK'D. BY: LK  
W.O. 0435-01