

CITY OF SACRAMENTO
1231 I Street, Sacramento, CA 95814

Permit No: 0412322
Insp Area: 4
Thos Bros:
Sub-Type: NSFR
Housing (Y/N):

Site Address: 2730 INGLETON LN SAC
Parcel No: 201-0880-023
N

HERITAGE @ NATOMAS PARK 9 LOT 23

CONTRACTOR
US HOME
2366 GOLD MEADOW DR STE 100
GOLD RIVER, CA 95670 77041

OWNER

ARCHITECT

Nature of Work: MP2005 1 STORY 8 ROOM SFR

CONSTRUCTION LENDING AGENCY: I hereby affirm under penalty of perjury that there is a construction lending agency for the performance of the work for which this permit is issued (Sec. 3097, Civ. C).

Lender's Name _____ Lender's Address _____

LICENSED CONTRACTORS DECLARATION: I hereby affirm under penalty of perjury that I am licensed under provisions of Chapter 9 (commencing with section 7000) of Division 3 of the Business and Professions Code and my license is in full force and effect.

License Class B License Number 451839 Date 8/9/4 Contractor Signature Don McCloskey

OWNER-BUILDER DECLARATION: I hereby affirm under penalty of perjury that I am exempt from the contractors License Law for the following reason (Sec. 7031.5, Business and Professions Code; any city or county which requires a permit to construct, alter, improve, demolish, or repair any structure, prior to its issuance, also requires the applicant for such permit to file a signed statement that he or she is licensed pursuant to the provisions of the Contractors License Law (Chapter 9 (commencing with Section 7000) of Division 8 of the Business and Professions Code) or that he or she is exempt therefrom and the basis for the alleged exemption. Any violation of Section 7031.5 by any applicant for a permit subjects the applicant to a civil penalty of not more than five hundred dollars (\$500.00);

I, as a owner of the property, or my employees with wages as their sole compensation, will do the work, and the structure is not intended or offered for sale (Sec. 7044, Business and Professional Code: The Contractors License Law does not apply to an owner of property who builds or improves thereon, and who does such work himself or herself or through his/her own employees, provided that such improvements are not intended or offered for sale. If, however, the building or improvement is sold within one year of completion, the owner-builder will have the burden of proving that he/she did not build or improve for the purpose of sale.)

I, as owner of the property, am exclusively contracting with licensed contractors to construct the project (Sec. 7044, Business and Professions Code: The Contractors License Law does not apply to an owner of property who builds or improves thereon, and who contracts for such projects with a contractor(s) licensed pursuant to the Contractors License Law).

I am exempt under Sec. _____ B & PC for this reason: _____

Date _____ Owner Signature _____

IN ISSUING THIS BUILDING PERMIT, the applicant represents, and the city relies on the representation of the applicant, that the applicant verified all measurements and locations shown on the application or accompanying drawings and that the improvement to be constructed does not violate any law or private agreement relating to permissible or prohibited locations for such improvements. This building permit does not authorize any illegal location of any improvement or the violation of any private agreement relating to location of improvements.

I certify that I have read this application and state that all information is correct. I agree to comply with all city and county ordinances and state laws relating to building construction and hereby authorize representative(s) of this city to enter upon the abovementioned property for inspection purposes.

Date 8/9/4 Applicant/Agent Signature Don McCloskey

WORKER'S COMPENSATION DECLARATION: I hereby affirm under penalty of perjury one of the following declarations:

I have and will maintain a certificate of consent to self-insure for workers' compensation as provided for by Section 3700 of the Labor Code, for the performance of work for which the permit is issued.

I have and will maintain workers' compensation insurance, as required by Section 3700 of the Labor Code, for the performance of the work for which this permit is issued. My workers' compensation insurance carrier and policy number are:

Carrier OLD REPUBLIC INS. CO. Policy Number MWC10815000 Exp Date 11/01/2004

(This section need not be completed if the permit is for \$1000 or less) I certify that in the performance of the work for which this permit is issued, I shall not employ any person in any manner so as to become subject to the workers' compensation laws of California and agree that if I should become subject to the workers' compensation provisions of Section 3700 of the Labor Code, I shall forthwith comply with those provisions.

Date 8/9/4 Applicant Signature Don McCloskey

WARNING: FAILURE TO SECURE WORKER'S COMPENSATION COVERAGE IS UNLAWFUL AND SHALL SUBJECT AN EMPLOYER TO CRIMINAL PENALTIES AND CIVIL FINES UP TO ONE HUNDRED THOUSAND DOLLARS (\$100,000) IN ADDITION TO THE COST OF COMPENSATION, DAMAGES AS PROVIDED FOR IN SECTION 3706 OF THE LABOR CODE, INTEREST AND ATTORNEY'S FEE.

THIS PERMIT SHALL EXPIRE BY LIMITATION IF WORK IS NOT COMMENCED WITHIN 180 DAYS.

THIS PLAN IS PREPARED TO SHOW THE DIMENSIONAL RELATIONSHIP FROM BUILDING FOUNDATION TO PROPERTY LINES, DRAINAGE CONTROL ELEVATIONS AND DIRECTION OF DRAINAGE FLOW. THIS IS DONE TO CONFORM TO LOCAL ORDINANCES FOR THE PURPOSE OF BUILDING PERMIT ISSUANCE. INFORMATION SHOWN ON THIS PLAN IS APPROXIMATE EXCEPT FOR MINIMUM SETBACKS WHICH ARE REQUIRED BY LOCAL ORDINANCE. THIS PLAN DOES NOT REFLECT AS BUILT CONDITIONS WHICH WILL VARY FROM THIS PLAN.

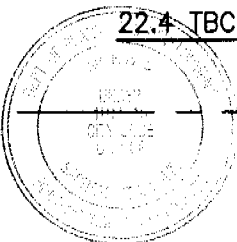
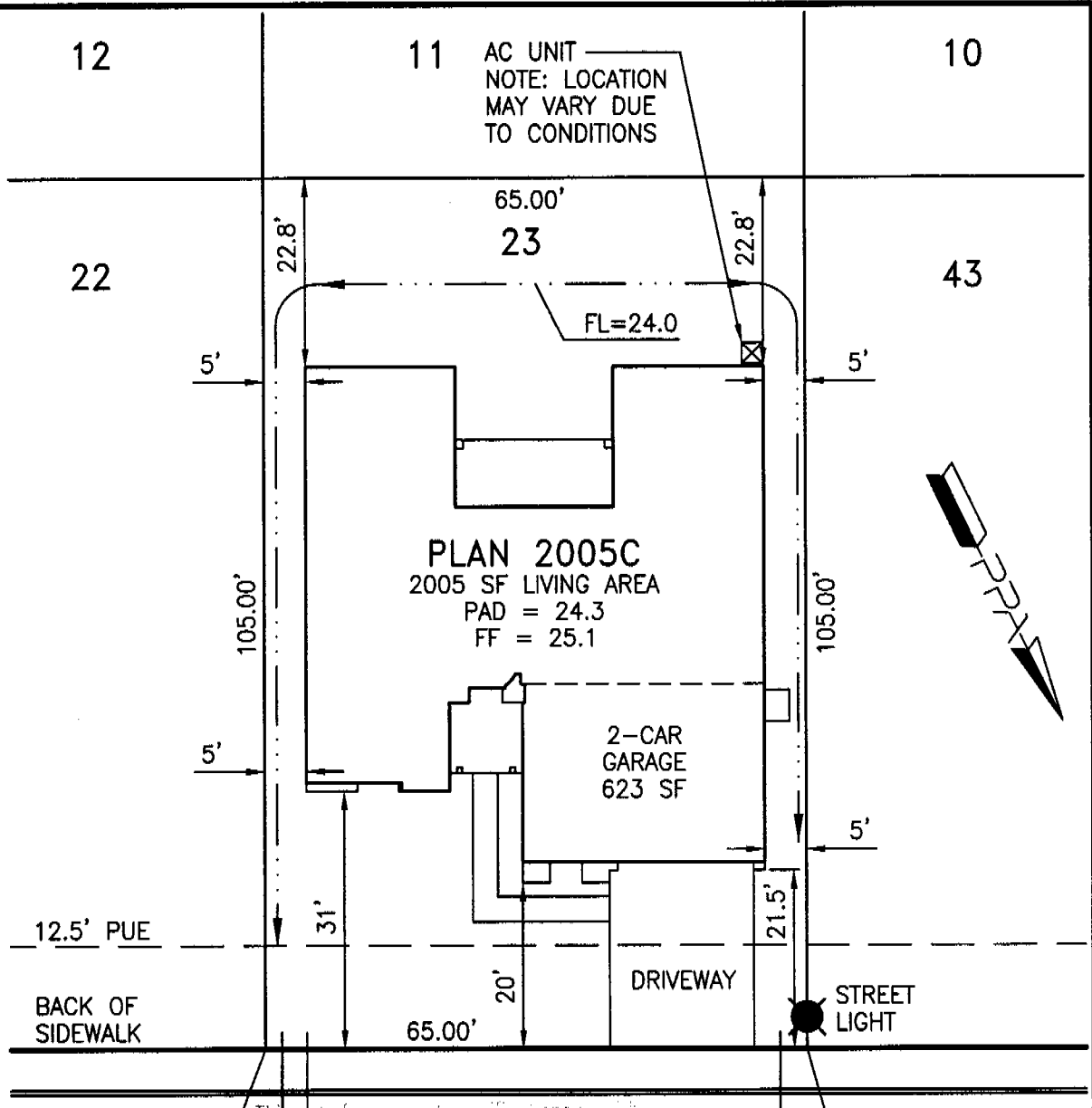

This set of plans and specifications must be kept as is at all times. It is not to be altered to make any changes or additions. If the same with all written permits are from the Building Inspection Department.

INGLETON LANE

The approval of this plan and specification SHALL NOT be held to justify or approve the violation of any City Ordinance or State Law.

Approved By:	US Home Corp. Rep.	Date
Revision	Approved By	Date
▲		
▲		

LOT AREA: 6825 SF
 ALLOWED LOT COVERAGE: 3071 SF = 45.0%
 ACTUAL LOT COVERAGE: 2779 SF = 40.7%
 REAR YARD AREA: 1645 SF
 NUMBER OF BEDROOMS:

It is understood that the drainage areas, slopes and grades shall not be altered, changed, blocked, modified or in any way be reconstructed by Owner contrary to what is depicted on this Plot Plan. THESE CONDITIONS RUN WITH THE LAND AND ARE BINDING ON ALL SUBSEQUENT OWNERS. All setback dimensions and elevations as shown may be adjusted to fit field conditions.

Plot Plan for Heritage at Natomas Park Village 9 PPA Job #005010
Heritage Park - Riviera Lot 23
 2730 Ingleton Lane, Sacramento, CA 95835 APN 201-0880-023

US Home Corporation - Sacramento Division
 2366 Gold Meadow Way, Suite 200, Gold River, CA 95670 Phone (916) 858-3900 Fax (916) 858-3925

Plot Plan Associates www.plotplans.org Date Drawn: 06/21/04 Scale: 1"=20'
 PO Box 435 Citrus Heights CA 95611-0435 (916) 769-9063 Date Revised: - Drawn By: MRM



Planning and Building Department
Building Division

CITY OF SACRAMENTO
CALIFORNIA

November 7, 2003

Downtown Permits Center
1231 I Street, #200
Sacramento, CA 95814-2998

North Permits Center
2101 Arena Blvd., Suite 200
Sacramento, CA 95834

ADDRESS 2730 SUGLETON LN PERMIT NO. 0412322

INSPECTION COMMENTS	PERMIT DOCUMENTS
8-20-04 ESB B10, 14, 210	
B-12 A.P. S.E.B. 8-27-04	
9/16/04 P-424 PL73 APMA	
10/20/04 E67 3361 RB	
5/23/05 B17/26 SIS	OK Cover, Wrap
5/25/05 B/17/26 AP SIS	
6-13-05 B81 CN Mearlark	
06/14/05 AP B81/18	1 Vic BRUBER
6/16/05 B14 AP Bn	
6/22/05 P42 AP SH	

FINAL APPROVALS	
BUILDING	<i>Richard Bell</i> 8/18-05
ELECTRICAL	
PLUMBING	
MECHANICAL	
FIRE	
SITE	

CERTIFICATION OF INSULATION

PART I GENERAL

US Homes LOT # **C23**

HERITAGE PARK RIV

P.O. BOX 854, WEST SACRAMENTO, CA 95691 LIC. #202026
 1309 MELODY ROAD, MARYSVILLE, CA 95901 LIC. #202026
 P.O. BOX 9651, FRESNO, CA 93793-9651 LIC. #202026
 P.O. BOX 1631, RENO, NV 89505 LIC. #10675
 3326 A PONDEROSA WAY, LAS VEGAS, NV 89118 LIC. #10675

DATE INSULATION COMPLETED _____

PART II AREAS INSULATED

WALLS			CEILING			FLOOR		
SQUARE FEET			SQUARE FEET			SQUARE FEET		
MATERIAL			MATERIAL			MATERIAL		
FORM			FORM			FORM		
MANUFACTURER'S PRODUCT I.D.			MANUFACTURER'S PRODUCT I.D.			MANUFACTURER'S PRODUCT I.D.		
MANUFACTURER			MANUFACTURER			MANUFACTURER		
CT	OC	JM	CT	OC	JM	CT	OC	JM
			BAGS					
R-VALUE INSTALLED	R-VALUE INSTALLED		APPLIED THICKNESS	APPLIED THICKNESS		R-VALUE INSTALLED	APPLIED THICKNESS	
13 19	3.5 5.5		38	12-14.75"				
MATERIAL			MATERIAL			MATERIAL		
FIBERGLASS			BAGS			OTHER THAN WALLS ABOVE		
FORM			FORM			FORM		
BATT			BATT			HILTI		
MANUFACTURER			MANUFACTURER			MANUFACTURER		
						HANDY FOAM		

PART III CERTIFICATION

THIS IS TO CERTIFY THAT THE INSULATION HAS BEEN INSTALLED IN CONFORMANCE WITH APPLICABLE CODES, MATERIALS AND MANUFACTURER'S INSTRUCTIONS.

SIGNATURE — INSULATION CONTRACTOR: _____ TITLE: **MANAGER** DATE: **6/21/05**

SIGNATURE — GENERAL CONTRACTOR: **Don Thompson** TITLE: _____ DATE: _____

REMARKS: _____

**Atrium Window Corporation
Installation Certificate**

Customer US HOMES / RIVIERA
 Lot # _____
 Plan 2005 C
 Site Address _____

Brand Name	Product Series	Window Type	Labeled Uvalue	Net Width	Net Height	Quantity	Total Sq Ft.	Comments
Atrium Windows	7000	XO	0.35	59	71	6	174.54	
Atrium Windows	7000	SH	0.35	23	59	1	9.42	
Atrium Windows	7000	PW	0.34	23	23	2	7.35	
Atrium Windows	7000	SH	0.35	35	71	4	69.03	
Atrium Windows	7000	XO	0.35	59	95	2	77.85	
Atrium Windows	7000	PW	0.34	59	71	1	29.09	
Atrium Windows	7000	SH	0.35	23	47	1	7.51	
Atrium Windows	7000	SH	0.35	35	71	1	17.26	
Atrium Windows	7000	SH	0.35	47	71	1	23.17	
Atrium Windows	7000	PW	0.34	-1	-1	0	0.00	
Atrium Windows	7000	XO	0.35	-1	-1	0	0.00	
Atrium Windows	7000	SH	0.35	-1	-1	0	0.00	
Atrium Windows	7000	SH	0.35	-1	-1	0	0.00	
Atrium Windows	7000	SH	0.35	-1	-1	0	0.00	
Atrium Windows	7000	XO	0.35	-1	-1	0	0.00	
Atrium Windows	7000	PW	0.34	-1	-1	0	0.00	
Atrium Windows	7000	PW	0.34	-1	-1	0	0.00	
Atrium Windows	7000	SH	0.35	-1	-1	0	0.00	
Atrium Windows	7000	SH	0.35	-1	-1	0	0.00	
Atrium Windows	7000	SH	0.35	-1	-1	0	0.00	
Atrium Windows	7000	PW	0.34	-1	-1	0	0.00	
Atrium Windows	7000	PW	0.34	-1	-1	0	0.00	
Atrium Windows	7000	PW	0.34	-1	-1	0	0.00	
Atrium Windows	7000	PW	0.34	-1	-1	0	0.00	
Atrium Windows	7000	PW	0.34	-1	-1	0	0.00	
Atrium Windows	7000	PW	0.34	-1	-1	0	0.00	
Atrium Windows	7000	XO	0.35	-1	-1	0	0.00	
Atrium Windows	7000	XO	0.35	-1	-1	0	0.00	
Atrium Windows	7000	XO	0.35	-1	-1	0	0.00	
Atrium Windows	7000	PW	0.34	-1	-1	0	0.00	
Atrium Windows	7000	SH	0.35	-1	-1	0	0.00	
Atrium Windows	7000	SH	0.35	-1	-1	0	0.00	
Weighted Average			0.348			Total Sq. Ft.		415.22

I, the undersigned, verify that the fenestration / glazing listed above my signature is the actual fenestration product installed is the equivalent to or more efficient than that specified in the certificate of compliance (CF-1R) submitted for compliance with the Energy Efficiency Standards for residential buildings, and the product meets or exceeds the appropriate requirements for manufactured devices where applicable.

		
Item #'s	Signature, Date	General Contractor (Co. Name)
Item #'s	Signature, Date	General Contractor (Co. Name)
Item #'s	Signature, Date	General Contractor (Co. Name)

INSTALLATION CERTIFICATE CF-6R
 US Home Corporation - Heritage Park Product Line 3 - Sacramento - Plan 2005

Site Address **Permit Number**

An installation certificate is required to be posted at the building site or made available for all appropriate inspections. (The information provided on this form is required; however, use of this form to provide the information is optional.) After completion of final inspection a copy must be provided to the building department (upon request) and the building owner at occupancy, per Section 10-103(b).

HVAC SYSTEMS:
Heating Equipment

Equip. Type (Heat pump)	CBC Certified Mfr name and Model #	# of Identical Systems	(1) Efficiency (AFUE, etc.) > CF-IR value	Duct Location (attic, etc.)	Duct or Piping R-value	Heating Load (Btu/hr)	Heating Capacity (Btu/hr)
Furnace	York #F4HUB18L084	1	0.80	Attic	6	37,813	80,000

Cooling Equipment

Equip. Type (Heat pump)	CBC Certified Manufacturer Unit Mfr Name and Model #	# of Identical Systems	(1) Efficiency (SEER, etc.) > CF-IR value	Duct Location (attic, etc.)	Duct R-value	Cooling Load (Btu/hr)	Cooling Capacity (Btu/hr)
A/C	York #H1RC036	1	12.0	Attic	6	31,403	34,400

(1) Efficiency greater than or equal to:
 I, the undersigned, verify that equipment listed above is: 1) the actual equipment installed; 2) equivalent to or more efficient than that specified in the certificate of compliance (Form CF-1R) submitted for compliance with the Energy Efficiency Standards for residential buildings; and 3) equipment that meets or exceeds the appropriate requirements for manufactured devices (from the Appliance Efficiency Regulations Part 6), where applicable.

[Signature]
 Signature, Date

Beutler Corporation
 Installing Subcontractor (Co. Name)
 OR General Contractor (Co. Name) OR Owner

WATER HEATING SYSTEMS:

Heater Type	CBC Certified Mfr Name & Model #	Disturbance Type (Std. point of use)	If Recirculation Control Type	# of Identical Systems	(1) Rated Input (kW or Btu/hr)	Tank Volume (gallons)	(2) Efficiency (EF, RE)	(3) Standby Loss (%)	External Insulation R-value
Storage	TRUUD PH2R50-40F	Gas	NA	1	40,000	50	.62		R-20

(2) For small gas storage (rated input of less than or equal to 75,000 Btu/hr), electric resistance and heat pump water heaters, list Energy Factor. For large gas storage water heaters (rated input of greater than 75,000 Btu/hr), list Recovery Efficiency, Standby Loss and Rated Input. For instantaneous gas water heaters, list Recovery efficiency and Rated Input.
 (3) If external insulation is mandatory for storage water heaters with an energy factor of less than 0.58.

Faucets & Shower Heads:

All faucets and showerheads installed are certified to the Commission, pursuant to Title 24, Part 6, Section 111.

I, the undersigned, verify that equipment listed above my signature is: 1) the actual equipment installed; 2) equivalent to or more efficient than that specified in the certificate of compliance (Form CF-1R) submitted for compliance with the Energy Efficiency Standards for residential buildings; and 3) equipment that meets or exceeds the appropriate requirements for manufactured devices (from the Appliance Efficiency Regulations or Part 6), where applicable.

[Signature] 02-18-05
 Signature, Date

Monarch Plumbing Company, Inc.
 Installing Subcontractor (Co. Name)
 OR General Contractor (Co. Name) OR Owner

COPY TO: Building Department
 HECS Provider (if applicable)
 Building Owner at Occupancy

REINFORCED CONCRETE DAILY FIELD REPORT

YOUNGDAHL CONSULTING GROUP, INC.
 GEOTECHNICAL • ENVIRONMENTAL • MATERIALS TESTING
 1234 Glenhaven Court El Dorado Hills, CA 95762
 Ph: 916.933.0633
 502 Giuseppe Court, Suite 2 Roseville, CA 95678
 Ph: 916.773.7633
 Fr: 916.773.7833
 Fr: 916.933.6482

Project Name: *Heritage @ Ashburn Village B* Project No.: *R03230.8*
 Project Location: *SAC* Unit #: *623* Contractor: *RAIN* Date: *5-19-05*
 Client: *J.S. Hovens* Weather: *RAIN* Met With: *Don* Copies To: *Don*
 Requested By: *Don*

SCOPE OF WORK:	SUBJECT AREAS	STATUS OF PROJECT	SAMPLE AND TEST DATA
Concrete Placement Inspection <input type="checkbox"/>	Footings <input type="checkbox"/>	On-Going <input type="checkbox"/>	Concrete Mix #(s):
Concrete Testing Only <input type="checkbox"/>	Slab on Grade <input type="checkbox"/>	Complete <input type="checkbox"/>	Design Strength(s):
Rebar / Tendon Inspection <input type="checkbox"/>	Structural Slab or Deck <input type="checkbox"/>	Completed For This Phase <input type="checkbox"/>	Yards Placed
Tendon Stressing Inspection <input type="checkbox"/>	Slab or Metal Deck <input type="checkbox"/>	On Hold Due To: <input type="checkbox"/>	Cast: Set(s) of: Compression Test Cylinders
Batch Plant Inspection <input type="checkbox"/>	Structural Member: <input type="checkbox"/>	Signed, Stamped, Daily <input type="checkbox"/>	Cylinders Per:
Packometer Detection <input type="checkbox"/>	Cast In Place Walls <input type="checkbox"/>	Letter To Follow <input type="checkbox"/>	Slump:
Sample Reinforcing Steel <input type="checkbox"/>	Tilt Up Panels <input type="checkbox"/>		% Air:
Proof Loading <input type="checkbox"/>	Curb and Gutter <input type="checkbox"/>		Sampled Rebar for Bend & Tensile Tests <input type="checkbox"/>
Pick Up: <input type="checkbox"/>	Sidewalk or Driveway <input type="checkbox"/>		Rebar Grade: , Size(s):
			Other Tests:

NOTES: *As scheduled, to proof load (1) 5/8" A.B. in front Room.*

@ Lot # 623, using WHITE BAR @ 3400 PSI, Held for 7-10 minutes.

Explored A.B. passed pull test.

Work in accordance with SAMPSON/ASTM specifications.

To The Building Official: Regarding Special Inspection
 I hereby certify that the noted portions of the work at the above address which required periodic and/or continuous inspection, and which I was employed to inspect, were inspected and, in my opinion, and to the best of my knowledge, comply with the provisions of the approved plans and specifications, except as noted.
 Note: The verb, "inspect" or "inspection" or "inspector", as used by Youngdahl and Associates, Inc., means observation and monitoring, and does not mean the right to control the contractor's work.

Field Rep (print): *KCHO HALELI* Signed: *[Signature]*
 Reported To: *ICBO# 503 775 6* Page *1* of *1*

NOTE: No guarantee or warranty of the contractor's work is made, expressed or implied.