

CITY OF SACRAMENTO
1231 I Street, Sacramento, CA 95814

Permit No: 0211179

Insp Area: 4

Thos Bros:

Sub-Type: NSFR

Housing (Y/N): N

Site Address: 4716 WYNDVIEW WY SAC

Parcel No: 225-1550-051

WESTBOROUGH 1-1 LOT 20

CONTRACTOR

WOODSIDE HOMES OF N. CALIF.
15 AUTO PLAZA DR #102
FOLSOM CA. 95630

OWNER

ARCHITECT

Nature of Work: MP2653 2 STORY 9 ROOM SFR

CONSTRUCTION LENDING AGENCY : I hereby affirm under penalty of perjury that there is a construction lending agency for the performance of the work for which this permit is issued (Sec. 3097, Civ. C).

Lender's Name _____ Lender's Address _____

LICENSED CONTRACTORS DECLARATION: I hereby affirm under penalty of perjury that I am licensed under provisions of Chapter 9 (commencing with section 7000) of Division 3 of the Business and Professions Code and my license is in full force and effect.

License Class B License Number 744379 Date 8/19/02 Contractor Signature Kerry Melusoto

OWNER-BUILDER DECLARATION: I hereby affirm under penalty of perjury that I am exempt from the contractors License Law for the following reason (Sec. 7031.5, Business and Professions Code; any city or county which requires a permit to construct, alter, improve, demolish, or repair any structure, prior to its issuance, also requires the applicant for such permit to file a signed statement that he or she is licensed pursuant to the provisions of the Contractors License Law (Chapter 9 (commencing with Section 7000) of Division 8 of the Business and Professions Code) or that he or she is exempt therefrom and the basis for the alleged exemption. Any violation of Section 7031.5 by any applicant for a permit subjects the applicant to a civil penalty of not more than five hundred dollars (\$500.00);

I, as a owner of the property, or my employees with wages as their sole compensation, will do the work, and the structure is not intended or offered for sale (Sec. 7044, Business and Professional Code: The Contractors License Law does not apply to an owner of property who builds or improves thereon, and who does such work himself or herself or through his/her own employees, provided that such improvements are not intended or offered for sale. If, however, the building or improvement is sold within one year of completion, the owner-builder will have the burden of proving that he/she did not build or improve for the purpose of sale.)

I, as owner of the property, am exclusively contracting with licensed contractors to construct the project (Sec. 7044, Business and Professions Code: The Contractors License Law does not apply to an owner of property who builds or improves thereon, and who contracts for a contractor(s) licensed pursuant to the Contractors License Law).

PAID
CITY OF SACRAMENTO

I am exempt under Sec. _____ B & PC for this reason: AUG 19 2002

Date _____ Owner Signature NORTH PERMIT CENTER

IN ISSUING THIS BUILDING PERMIT, the applicant represents, and the city relies on the representation of the applicant, that the applicant verified all measurements and locations shown on the application or accompanying drawings and that the improvement to be constructed does not violate any law or private agreement relating to permissible or prohibited locations for such improvements. This building permit does not authorize any illegal location of any improvement or the violation of any private agreement relating to location of improvements.

I certify that I have read this application and state that all information is correct. I agree to comply with all city and county ordinances and state laws relating to building construction and hereby authorize representative(s) of this city to enter upon the above mentioned property for inspection purposes.

Date 8/19/02 Applicant/Agent Signature Kerry Melusoto

WORKER'S COMPENSATION DECLARATION: I hereby affirm under penalty of perjury one of the following declarations:

I have and will maintain a certificate of consent to self-insure for workers' compensation as provided for by Section 3700 of the Labor Code, for the performance of work for which the permit is issued.

I have and will maintain workers' compensation insurance, as required by Section 3700 of the Labor Code, for the performance of the work for which this permit is issued. My workers' compensation insurance carrier and policy number are:

Carrier INSURANCE CO. OF THE WEST Policy Number WSL170169001 Exp Date 12/12/2002

(This section need not be completed if the permit is for \$100 or less) I certify that in the performance of the work for which this permit is issued, I shall not employ any person in any manner so as to become subject to the workers' compensation laws of California and agree that if I should become subject to the workers' compensation provisions of Section 3700 of the Labor Code, I shall forthwith comply with those provisions.

Date 8/19/02 Applicant Signature Kerry Melusoto

WARNING: FAILURE TO SECURE WORKER'S COMPENSATION COVERAGE IS UNLAWFUL AND SHALL SUBJECT AN EMPLOYER TO CRIMINAL PENALTIES AND CIVIL FINES UP TO ONE HUNDRED THOUSAND DOLLARS (\$100,000) IN ADDITION TO THE COST OF COMPENSATION, DAMAGES AS PROVIDED FOR IN SECTION 3706 OF THE LABOR CODE, INTEREST AND ATTORNEY'S FEE.

THIS PERMIT SHALL EXPIRE BY LIMITATION IF WORK IS NOT COMMENCED WITHIN 180 DAYS.

RESIDENTIAL SUBDIVISION BUILDING PERMIT APPLICATION

Project Address: 4716 Wyndview Dr Assessor Parcel # 225-1550-051
 Lot Number: 20 Subdivision Westborough-Village 1 Ph 1

OWNER INFORMATION:

Legal Property Owner: Woodside Westlake, Inc. Phone# (916) 608-9600
 Owner Address: 15 Plaza Drive #102 City Folsom State CA Zip 95630

CONTRACTOR INFORMATION:

Contractor: Woodside Homes of CA, Inc. Lic. # 744379B Phone # 608-9600 Fax 608-9940

PROJECT INFORMATION:

Land Use Zone R1A Occupancy Group R3 Construction Type VN Fed Code 1A
 No. of Stories: 2 No. of Rooms: 9 Street Width: _____
 1st Floor Area 1379 2nd Floor Area 1274 Basement N/A Roof Material Concrete Tile

AREA IN SQUARE FOOT OF:

Dwelling/Living	<u>2653</u>	<u>WD2653V</u>
Garage/Storage	<u>646</u>	<u>\$174,204.44</u>
Decks/Balconies	<u>N/A 50</u>	<u>0211179</u>
Carpports	<u>N/A</u>	

SCOPE OF WORK: New Residential Construction ~~Base House~~

FOR OFFICE USE ONLY

- | | | |
|---|---|---|
| <input type="checkbox"/> Information Above Complete | <input type="checkbox"/> AR Flood Waiver Required | <input type="checkbox"/> Planning Approval |
| <input type="checkbox"/> Violation Files Checked | <input type="checkbox"/> Flood Elevation Certificate Required | <input type="checkbox"/> Design Review Approval |
| <input type="checkbox"/> Standard Setbacks | <input type="checkbox"/> Water Development Infill Area | <input type="checkbox"/> Special Fee Districts Apply: |
| <input type="checkbox"/> County Sewer | | |

THE FOLLOWING MUST BE PROVIDED IN ORDER TO SUBMIT FOR PERMIT

- 2 COMPLETE PLOT PLANS, LEGIBLE & DRAWN TO SCALE
- 11 X 17 COPY OF FLOOR PLAN WITH FOLLOWING INFORMATION

a) Assessor's Parcel Number	c) Owners Name
b) New Floor Area	d) Project Address

Date: _____ Received by: (staff) _____ Permit # _____

COUNTY SANITATION DISTRICT NO. 1
 SACRAMENTO REGIONAL COUNTY SANITATION DISTRICT
SEWER IMPACT FEE *LDC*
 PERMIT AND CALCULATION SHEET *19 AUG 02*

APPLICATION NO: ****CITY**** BLDG PERMIT NO:

GENERAL INFORMATION THIS PERMIT GOOD ONLY WHEN VALIDATED BY THE CASHIER

19 Aug 02
 Paid Thru
 SVD2002-00197

THIS PERMIT TO CONNECT EXPIRES
 ONE YEAR FROM DATE OF ISSUANCE

FEE CALCULATION BUILDING USE

INSPECTION	RESIDENTIAL	SF	MF	UNITS
GSD-1				
SRCSD				
CONSTRUCTION				
IN-LIEU				
TOTAL FEE				4100

APN: 225-1550-051

DESCRIPTION/ SUBDIVISION Westborough Village I, Ph 1 LOT: 20

PROPERTY ADDRESS 4716 Wyndview Drive

OWNER Woodside Nestlake, Inc.

MAILING ADDRESS 15 Plaza Drive #102

CITY-STATE-ZIP Folsom, CA 95630 PHONE 608-9600

ADDITIONAL FEES MAY BE DUE IF CHANGES IN USE INCREASE SEWER IMPACT.

APPLICANT SIGNATURE *Kenneth M. Decker*
 CONSOLIDATED UTILITY BILLING USE ONLY

ACCT _____ INPUT _____ START _____

Natomas Unified School District
 1515 Sports Drive, #1 • Sacramento, CA 95834-1905
 Phone 916/641-3300 • Fax 916/928-1629

CERTIFICATION OF COMPLIANCE

SCHOOL DISTRICT DEVELOPMENT FEES

PART I: TO BE COMPLETED BY APPLICANT			
Property Owner's Name	Woodside Westlake, inc.		
Owner's Address	15 Plaza Drive #102 Folsom, CA 95630		
Project Address	4710 Wyndview Drive Lot 21		
Parcel Number	225-1550-052		
Subdivision Name	Westborough Village 1, Ph 1		
Number of Units	1		
Print Applicant's Name	Woodside Homes of CA, Inc.	Applicant's Signature	<i>[Signature]</i>
Title of Applicant	Construction Admin.		
Date	8/13/02	Telephone Number	608-9600
PART II: TO BE COMPLETED BY BUILDING DEPARTMENT			
Plan Identification Number			
Building Type (Check One)	<input checked="" type="checkbox"/> Residential <input type="checkbox"/> Apartment/Condominium <input type="checkbox"/> Commercial/Industrial		
Square Feet of Chargeable Building Area	2653		
Signature	<i>[Signature]</i>		
Title		Date	8-17-02
PART III: TO BE COMPLETED BY NATOMAS UNIFIED SCHOOL DISTRICT			
District Certification Number	02-214		
Fees Collected:			
Residential:	2653	Sq. Ft. X \$ 3.00	= \$ 7959.00
Apartment/Condominium:		Sq. Ft. X \$	= \$
Commercial/Industrial:		Sq. Ft. X \$	= \$
<p>NOTICE TO APPLICANT: Pursuant to government code section 66020 (d), this will serve to notify you that the 90-day approval period in which you may protest the fees, or other payment identified above, will begin to run on the date in which the building or installation permit for this project is issued, or on which they are paid to the District, or to another public entity authorized to collect them on behalf of the District, whichever is earlier.</p>			
Applicant Signature:	<i>[Signature]</i>		Date: 8/13/02

This certification covers only the amount of square footage indicated above. Any additions or corrections to the square footage for this project will require an amendment to the Certificate of Compliance.

As the authorize Natomas Unified School District official, I hereby certify that the requirements of Government Code Section 95995 have been complied with by the above signed applicant.

SIGNATURE: *Michael Morman* DATE: 8/19/02
 TITLE: Michael Morman
Facilities Planning Director

CERTIFICATION OF INSULATION

ADDRESS OR TRACT WOODSIDE LOT # 20 WESTLAKE	SACRAMENTO BUILDING PRODUCTS <input checked="" type="checkbox"/> P.O. BOX 854, WEST SACRAMENTO, CA 95691 LIC. #202026 <input type="checkbox"/> 1309 MELODY ROAD, MARYSVILLE, CA 95901 LIC. #202026 <input type="checkbox"/> P.O. BOX 9651, FRESNO, CA 93793-9651 LIC. #202026 <input type="checkbox"/> P.O. BOX 1631, RENO, NV 89505 LIC. #10675 <input type="checkbox"/> 3326 A PONDEROSA WAY, LAS VEGAS, NV 89118 LIC. #10675 DATE INSULATION COMPLETED
--	---

WALLS		CEILING			FLOORS	
(SQUARE FEET)		(SQUARE FEET)			(SQUARE FEET)	
TYPE OF INSULATION		TYPE OF INSULATION			TYPE OF INSULATION	
MATERIAL FIBERGLASS		MATERIAL FIBERGLASS			MATERIAL FIBERGLASS	
FORM BATTS		FORM BATTS & BLOW			FORM BATTS	
MANUFACTURER'S PRODUCT I.D.		MANUFACTURER'S PRODUCT I.D.			MANUFACTURER'S PRODUCT I.D.	
MANUFACTURER		MANUFACTURER			MANUFACTURER	
OCF		OCF			OCF	
BAGS						
R-VALUE INSTALLED	APPLIED THICKNESS	R-VALUE INSTALLED	APPLIED THICKNESS	MIN. INSTALLED WEIGHT PER SQ. FT.	R-VALUE INSTALLED	APPLIED THICKNESS
13	3 1/2"	30 30	9" 12"			
KNEE WALLS IF R-VALUE IS OTHER						
MATERIAL FIBERGLASS		FORM BATTS		R-VALUE		MANUFACTURER OCF
AIR INFILTRATION BARRIER						
MATERIAL FOAM				MANUFACTURER W R GRACE		

THIS IS TO CERTIFY THAT INSULATION AND/OR SEAMANT HAS BEEN INSTALLED IN COMPLIANCE WITH APPLICABLE CODES, MATERIAL STANDARDS AND REGULATIONS.

SIGNATURE - INSULATION CONTRACTOR <i>Jeff Cable</i>	TITLE MANAGER	DATE 10/23/02
SIGNATURE - GENERAL CONTRACTOR	TITLE	DATE
REMARKS		

KwikKote

No. 200-912150

Stucco System Installation Card

Job Name: WESTLAKE
Address: 4716 WYNDVIEW DR.

Lot #: 0000020

Stucco System Trade Name: KWIK KOTE
Stucco System Manufacturer: KWIK KOTE CORP.

ICBO Evaluation Service, Inc.
Report No. 3607
Date of Job Completion: November 19, 2002

Home Builder: WOODSIDE HOMES
Address: 15 PLAZA DR. #102
FOLSOM, CA

Stucco Contractor: KENYON PLASTERING, INC.
Address: PO BOX 2077
North Highlands, CA

Telephone Number: 916/349-8191

Approved Contractor Number as
issued by the Stucco Manufacturer: 1001

Card Print Date: 12/02/2002

This is to certify that the stucco system on the building exterior at the above address had been installed in accordance with the evaluation report specified above and the manufacturer's instructions.



Signature of authorized representative of stucco contractor

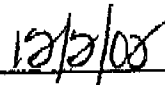

Date

SCALE: 1"=20'

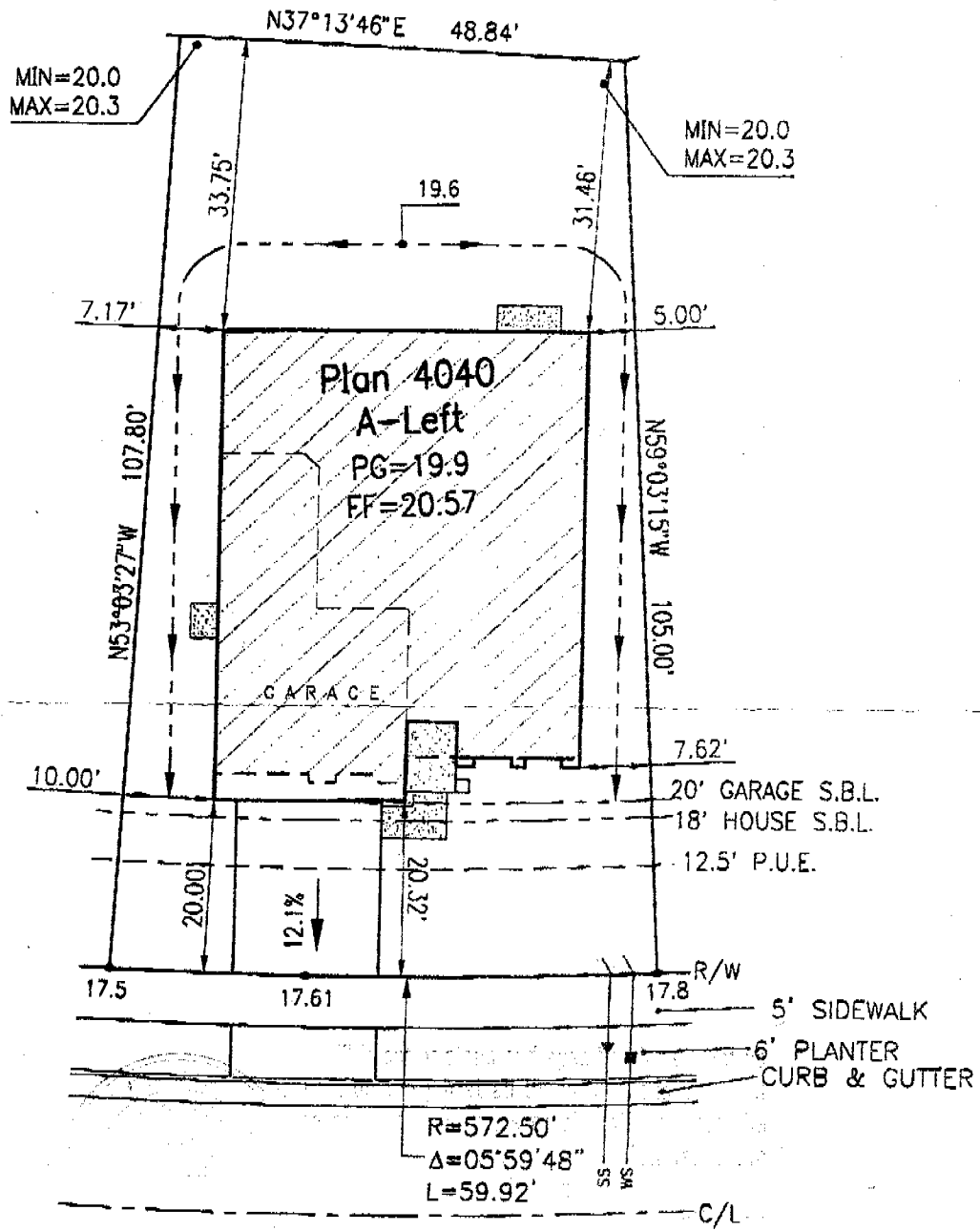

PLAN 4040

2-STORY
 2-CAR GARAGE
 LIVABLE 1st=1379 s.f.
 LIVABLE 2nd=1274 s.f.
 GARAGE AREA= 646 s.f.
 ENTRY "A" AREA=50 s.f.
 FOOTPRINT 2070.5 s.f.

WYNDVIEW DRIVE

Plot Plan for
 Lot 20 of 81



WOODSIDE HOMES OF CA, INC.

Westborough ~ Village 1 , Phase 1

ADDRESS: 4716 WYNDVIEW DRIVE
 CITY OF SACRAMENTO, NATOMAS
 SACRAMENTO COUNTY, CALIFORNIA

A.P.N.: 225-1550-051
 Lot Area: 5803 s.f.
 Lot Coverage: 35.7%

SCALE : 1"=20'

Date: July 31, 2002

Revised:

Drawn By: SAK

Job No: 00-11-132