

CITY OF SACRAMENTO
1231 I Street, Sacramento, CA 95814

Permit No: 0011042
Insp Area: 4

Site Address: 2553 MERRIVALE WY SAC
Parcel No: NORTHBOROUGH VIL. 5-1 LOT 50
N

Sub-Type: NSFR
Housing (Y/N):

CONTRACTOR
CENTEX HOMES
3300 DOUGLAS BLVD
STE. 210 95661

OWNER

ARCHITECT

Nature of Work: NSFR MP1960 9 RMS

CONSTRUCTION LENDING AGENCY : I hereby affirm under penalty of perjury that there is a construction lending agency for the performance of the work for which this permit is issued (Sec. 3097, Civ. C).

Lender's Name N/A Lender's Address _____

LICENSED CONTRACTORS DECLARATION: I hereby affirm under penalty of perjury that I am licensed under provisions of Chapter 9 (commencing with section 7000) of Division 3 of the Business and Professions Code and my license is in full force and effect.

License Class B License Number 734094 Date 10 5 00 Contractor Signature Debbie Stowers

OWNER-BUILDER DECLARATION: I hereby affirm under penalty of perjury that I am exempt from the contractors License Law for the following reason (Sec. 7031.5, Business and Professions Code; any city or county which requires a permit to construct, alter, improve, demolish, or repair any structure, prior to its issuance, also requires the applicant for such permit to file a signed statement that he or she is licensed pursuant to the provisions of the Contractors License Law (Chapter 9 (commencing with Section 7000) of Division 8 of the Business and Professions Code) or that he or she is exempt therefrom and the basis for the alleged exemption. Any violation of Section 7031.5 by any applicant for a permit subjects the applicant to a civil penalty of not more than five hundred dollars (\$500.00);

____ I, as a owner of the property, or my employees with wages as their sole compensation, will do the work, and the structure is not intended or offered for sale (Sec. 7044, Business and Professional Code: The Contractors License Law does not apply to an owner of property who builds or improves thereon, and who does such work himself or herself or through his/her own employees, provided that such improvements are not intended or offered for sale. If, however, the building or improvement is sold within one year of completion, the owner-builder will have the burden of proving that he/she did not build or improve for the purpose of sale.)

____ I, as owner of the property, am exclusively contracting with licensed contractors to construct the project (Sec 7044, Business and Professions Code: The Contractors License Law does not apply to an owner of property who builds or improves thereon, and who contracts for such projects with a contractor(s) licensed pursuant to the Contractors License Law).

____ I am exempt under Sec. _____ B & PC for this reason: _____

Date _____ Owner Signature _____

PAID
CITY OF SACRAMENTO
OCT 05 2000
NEIGHBORHOODS PLANNING
AND DEVELOPMENT SERVICES

IN ISSUING THIS BUILDING PERMIT, the applicant represents, and the city relies on the representation of the applicant, that the applicant verified all measurements and locations shown on the application or accompanying drawings and that the improvement to be constructed does not violate any law or private agreement relating to permissible or prohibited locations for such improvements. This building permit does not authorize any illegal location of any improvement or the violation of any private agreement relating to location of improvements.

I certify that I have read this application and state that all information is correct. I agree to comply with all city and county ordinances and state laws relating to building construction and hereby authorize representative(s) of this city to enter upon the abovementioned property for inspection purposes.

Date 10 5 00 Applicant/Agent Signature Debbie Stowers

WORKER'S COMPENSATION DECLARATION: I hereby affirm under penalty of perjury one of the following declarations:
____ I have and will maintain a certificate of consent to self-insure for workers' compensation as provided for by Section 3700 of the Labor Code, for the performance of work for which the permit is issued.

I have and will maintain workers' compensation insurance, as required by Section 3700 of the Labor Code, for the performance of the work for which this permit is issued. My workers' compensation insurance carrier and policy number are:

Carrier AMER. GUAR. & LIAB. INS. Policy Number WC8322096-02 Exp Date 10/01/2000

____ (This section need not be completed if the permit is for \$100 or less) I certify that in the performance of the work for which this permit is issued, I shall not employ any person in any manner so as to become subject to the workers' compensation laws of California and agree that if I should become subject to the workers' compensation provisions of Section 3700 of the Labor Code, I shall forthwith comply with those provisions.

Date 10 5 00 Applicant Signature Debbie Stowers

WARNING: FAILURE TO SECURE WORKER'S COMPENSATION COVERAGE IS UNLAWFUL AND SHALL SUBJECT AN EMPLOYER TO CRIMINAL PENALTIES AND CIVIL FINES UP TO ONE HUNDRED THOUSAND DOLLARS (\$100,000) IN ADDITION TO THE COST OF COMPENSATION, DAMAGES AS PROVIDED FOR IN SECTION 3706 OF THE LABOR CODE, INTEREST AND ATTORNEY'S FEE.

THIS PERMIT SHALL EXPIRE BY LIMITATION IF WORK IS NOT COMMENCED WITHIN 180 DAYS.

RESIDENTIAL BUILDING PERMIT APPLICATION

New Construction Addition Remodels Other

Project Address: 2553 Merrivale Way Assessor Parcel # 201-0350-050

OWNER INFORMATION: Lot 50

Legal Property Owner: Center Homes Phone # 786-8693
 Owner Address: 3700 Douglas Blvd #150 City Roseville State CA Zip 95661

CONTRACTOR INFORMATION:

Contractor: Center Homes Lic. # 734094 Phone # 786-8693 Fax# 786-6802

PROJECT INFORMATION:

Land Use Zone RIA Occupancy Group R3 Construction Type VN Fed Code 1A
 No. of stories: 1 No. of rooms: _____ Street width: _____
 1st Floor Area 1960 2nd Floor Area _____ Basement _____ Roof Material _____

AREA IN SQUARE FOOT OF:

| | EXISTING | NEW |
|-----------------|---------------------|-------------|
| Dwelling/Living | _____ | <u>1960</u> |
| Garage/Storage | _____ | <u>617</u> |
| Decks/Balconies | _____ | _____ |
| Carports | _____ | _____ |

SCOPE OF WORK: MP 1960 New SFR

FOR OFFICE USE ONLY

- | | | |
|---|---|--|
| <input type="checkbox"/> Information above complete | <input type="checkbox"/> AR Flood Waiver required | <input type="checkbox"/> Planning Approval |
| <input type="checkbox"/> Violation files checked | <input type="checkbox"/> Flood Elevation Certificate Required | <input type="checkbox"/> Design Review Approval |
| <input type="checkbox"/> Standard setbacks | <input type="checkbox"/> Water Development Infill Area | <input type="checkbox"/> Special Fee Districts Apply : _____ |
| <input type="checkbox"/> County Sewer | | |

NEW STRUCTURES & ADDITIONS

❖ THE FOLLOWING MUST BE PROVIDED IN ORDER TO SUBMIT FOR PLAN REVIEW

- | | |
|---|---|
| <input type="checkbox"/> 2 COMPLETE PLANS, LEGIBLE & DRAWN TO SCALE | ❖ Plans to include: site plan, floor plan, elevations, roof/ceiling plan, foundation and structural framing details, and structural calculations for non-conforming structures. |
| <input type="checkbox"/> 3 SETS IF PROJECT IS IN A DESIGN REVIEW AREA | |
| <input type="checkbox"/> Title 24 Energy Compliance documentation | <input type="checkbox"/> 11" x 17" copy of floor plan for County Assessor |
| <input type="checkbox"/> Grading and Erosion Control Questionnaire | <input type="checkbox"/> Plan Review Fees |

Date: _____ Received by: (staff) _____



INSULATION CERTIFICATE

THIS IS TO CERTIFY THAT INSULATION HAS BEEN INSTALLED IN CONFORMANCE WITH THE CURRENT ENERGY REGULATIONS, CALIFORNIA ADMINISTRATION CODE, TITLE 24, STATE OF CALIFORNIA, IN THE BUILDING LOCATED AT:

SITE ADDRESS: LOT 50 NORTH DROUGH SACRAMENTO, CA
STREET CITY STATE

CEILING:

BLOW: MANUFACTURER GREENSTONE THICKNESS 10.3" RVALUE 36
SQUARE FEET 1905 # BAGS/LBS PER BAGS 88

BATTS: MANUFACTURER JOHNS MANVILLE THICKNESS 13" R-VALUE 38
JOHNS MANVILLE

EXTERIOR WALLS:

MANUFACTURER JOHNS MANVILLE THICKNESS 3.5" RVALUE 13
JOHNS MANVILLE

FLOOR INSULATION:

MANUFACTURER JOHNS MANVILLE THICKNESS N/A RVALUE N/A

AIR INFILTRATION: (TITLE 24)
YES XX NO _____

OTHER: _____

GENERAL CONTRACTOR: CENTEX HOMES LICENSE # _____

BY: _____ TITLE _____ DATE _____

INSULATION CONTRACTOR: WESTERN INSULATION, INC. LICENSE # 481278

BY: Jamie Blair TITLE AUTH. AGENT DATE 3/21/01
JAMIE BLAIR

Norman

Scheel

Structural

Engineer

Sacramento
6939 Sunrise Blvd. #123
Citrus Heights, CA 95610
(916) 726-0612
(916) 726-3189 (fax)

NORMAN SCHEEL
Structural Engineer
Email: norm@nsse.com

ROBERT COON
Project Manager
Email: rob@nsse.com

PAULO IBÁÑEZ
P. Manager
Email: paulo@nsse.com

TIM SLOAN
Project Manager
Email: tim@nsse.com

CASANDRA COURTILLET
Design Engineer
Email: cassandra@nsse.com

MARY PHUNG
Design Engineer
Email: mary@nsse.com

NICOLAS HUFF
Design Engineer
Email: nicolas@nsse.com

STEVE COOKSEY
CAD Supervisor
Email: steve@nsse.com

Davis
213 E Street Suite B
Davis, CA 95616
(530)753-5300
(530)753-5380(fax)

TRACY HARRIS P.E.
Project Engineer
E tracy@nsse.com

DARRELL PEREIRA
Design Engineer
Email: darrell@nsse.com

April 10, 2000

Centex Homes
3700 Douglas Blvd., Suite 150
Roseville, CA 95661

Re: Northborough – Plan 1960 Detail Revision (Job #99028)

To whom it may concern:

This letter is to verify that for the above referenced plan, detail 436 is to be removed from the right side of the entry. A letter from our office dated March 9, 2000 incorrectly stated that detail 447 was to be removed from the right side of the plan. Detail 447 is to be installed.

If there are further questions, please contact Tim Sloan at (916) 726-0612.

NORMAN SCHEEL
STRUCTURAL ENGINEER



Norman

Scheel

Structural

Engineer

Sacramento
6939 Sunrise Blvd.
Suite 123
Citrus Heights, CA 95610
(916) 726-0612
(916) 726-3189 (fax)

NORMAN SCHEEL
Structural Engineer
Email: norm@nssc.com

ROBERT COON
Project Manager
Email: rob@nssc.com

PAULO IBÁÑEZ
Project Manager
Email: paulo@nssc.com

TERRI SCHNEIDER P.E.
Project Engineer
Email: terri@nssc.com

TIM SLOAN
Project Manager
Email: tim@nssc.com

CASANDRA COURTILLET
Design Engineer
Email: casandra@nssc.com

Davis
1623 Fifth Street
Suite F
Davis, CA 95616
(530)753-5300
(530)753-5380

TRACY HARRIS P.E.
Project Engineer
Email: tracy@nssc.com

DARRELL PEREIRA
Design Engineer
Email: darrell@nssc.com

February 2, 2000

Centex Homes
3700 Douglas Blvd., Suite 150
Roseville, CA 95661

Re: Northborough – Various Items (Job #99028)

To whom it may concern:

This letter is to verify that this office has addressed the following items:

Plan 1960:

1. The shear on detail 409 may be installed to either face of the truss – provided that the shear is edge nailed to the top chord of the truss a nailed to blocking between the truss verticals.
2. Install (2) H2.5 clips to truss T07 (6900# drag) at the cantilevered end to the top plates below. These clips eliminate the need for the H7 clip at the cantilevered end.

Plan 2406, 2492:

1. A 4x6 is required at HD-10A holdowns (Type 15), not a 6x6 as specified on the foundation sheet.
2. Move the 4' Type 3 at the hallway to the garage wall. This revision is required due to the hallway width increasing.

If there are further questions, please contact Tim Sloan at (916) 726-0612.

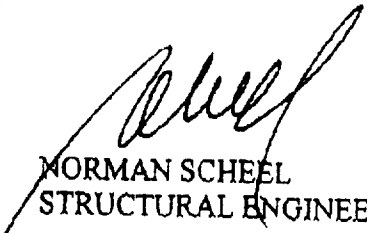

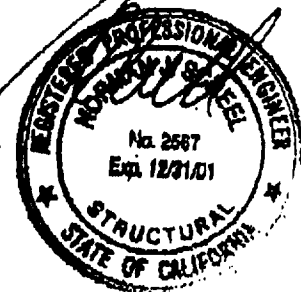
NORMAN SCHEEL
STRUCTURAL ENGINEER

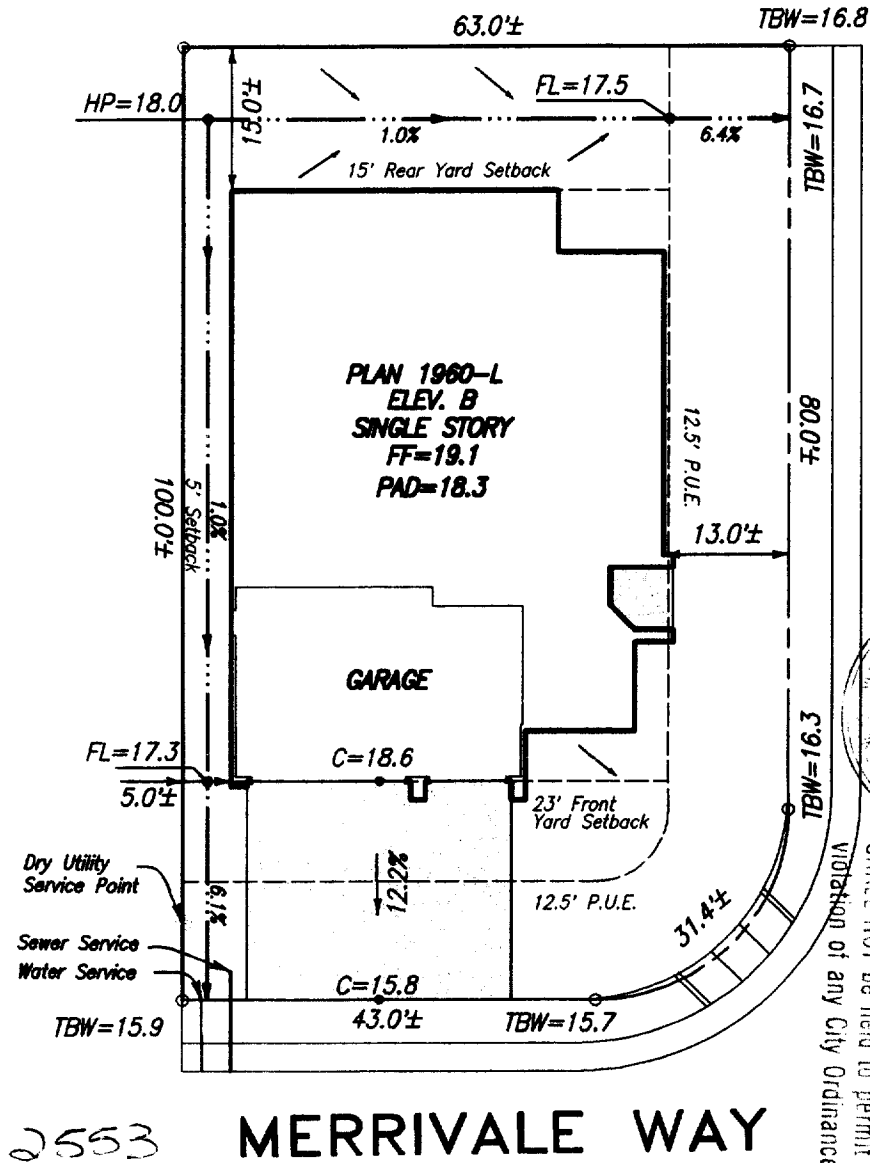
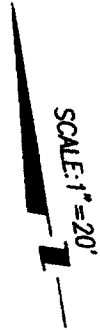

Lot Area = 6,214 sf
 Building Footprint = 2,616 sf
 Gross Coverage = 42.1%
 Porch Allowance = 39 sf
 Net Coverage = 41.5%

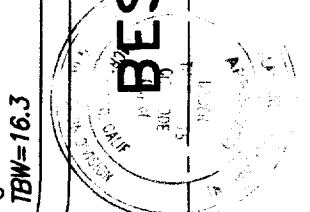

BESSEMER WAY



The approval of this plan and specification SHALL NOT be held to permit or approve the violation of any City Ordinance or State Law.

Plot Plan for Lot 50
 Northborough Village 5-1
 City of Sacramento

Centex Homes
 3700 Douglas Blvd., Suite 150
 Roseville, CA 95661
 Ph.: (916) 786-8693

Plan 1960 Elev. B
 Centex Review & Approval:
 By: [Signature] Date: 9/5

Note:
 This plot plan has been prepared for the purpose of showing the building foundation relationship to the property line, proposed drainage elevations and direction of flow to conform to local ordinances and for the purpose of building permit issuance. Information shown is approximate except for those setbacks which are minimums required by ordinance. This plot does not reflect as-built conditions which will likely vary from this plan.

Murray Smith & Associates Engineering, Inc.
 3110 Gold Canal Drive
 Rancho Cordova, CA 95670
 Ph.: (916) 635-1511

September 1, 2000

PN: 99008