

THIS IS A 2 PART FORM
WRITE ON A FIRM SURFACE

CONSTRUCTION LENDING AGENCY

I hereby affirm under penalty of perjury that there is a construction lending agency for the performance of the work for which this permit is issued (Sec. 3097, Civ. C).

Lenders Name _____
Lenders Address _____

LICENSED CONTRACTORS DECLARATION

I hereby affirm under penalty of perjury that I am licensed under provisions of Chapter 9 (commencing with Section 7000) of Division 3 of the Business and Professions Code and my license is in full force and effect.

License Class C45 Lic. Number 9123-432
Date 7/2/00 Contractor [Signature]
(Signature) [Signature]

OWNER - BUILDER DECLARATION

I hereby affirm under penalty of perjury that I am exempt from the Contractors License Law for the following reason (Sec. 7031.5, Business and Professions Code: Any city or county which requires a permit to construct, alter, improve, demolish, or repair any structure, prior to its issuance, also requires the applicant for such permit to file a signed statement that he or she is licensed pursuant to the provisions of the Contractors License Law (Chapter 9 (commencing with Section 7000) of Division 3 of the Business and Professions Code) or that he or she is exempt therefrom and the basis for the alleged exemption. Any violation of Section 7031.5 by any applicant for a permit subjects the applicant to a civil penalty of not more than five hundred dollars (\$500.00):

I, as owner of the property, or my employees with wages as their sole compensation, will do the work, and the structure is not intended or offered for sale (Sec. 7044, Business and Professions Code: The Contractors License Law does not apply to an owner of property who builds or improves thereon, and who does such work himself or herself or through his or her own employees, provided that such improvements are not intended or offered for sale. If, however, the building or improvement is sold within one year of completion, the owner-builder will have the burden of proving that he or she did not build or improve for the purpose of sale.)

I, as owner of the property, am exclusively contracting with licensed contractors to construct the project (Sec. 7044, Business and Professions Code: The Contractors License Law does not apply to an owner of property who builds or improves thereon, and who contracts for such projects with a contractor(s) licensed pursuant to the Contractors License Law).

I am exempt under Sec. _____ B & P C for this reason _____
Date _____ Owner _____ (Signature)

In issuing this building permit, the applicant represents, and the City relies on the representation of the applicant, that the applicant verified all measurements and locations shown on the application or accompanying drawings and that the improvement to be constructed does not violate any law or private agreement relating to permissible or prohibited locations for such improvements. This building permit does not authorize any illegal location of any improvement or the violation of any private agreement relating to location of improvements.

I certify that I have read this application and state that all information is correct. I agree to comply with all city and county ordinances and state laws relating to building construction and hereby authorize representative of this city to enter upon the abovementioned property for inspection purposes.

Date 7/2/00 Signature of Applicant or Agent [Signature]

USE BLACK INK BALL POINT PEN — PRESS FIRMLY
SIGN PERMIT APPLICATION

SITE ADDRESS

~~4221~~ -4221 Norwood Ave Sac. Ca

SUITE

INSR. AREA

ASSESSOR PARCEL NO. 237-0102-029

PERMIT NO. 0008553

LICENSED CONTRACTOR River City Sign

ADDRESS 2419 Selderwy

ZIP CODE 95291 PHONE NO. 911-371-3300

BUSINESS OWNER [Signature]

SIGN INFORMATION

- ATTACHED INTERIOR/ELECT. SINGLE FACED
- ILLUMINATED NON-ILLUMINATED BILLBOARD/SUBDIVISION
- INDIVIDUAL LETTERS PAINTED ON BUILDING LOGO
- METAL POLE DOUBLE FACED
- PLASTIC MONUMENT VINYL/GATOR FOAM
- WOODEN PROJECTING RE-FACE

SIGN COPY Tarant Sign
Norwood Center

CITY OF SACRAMENTO PERMIT SERVICES
BUILDING INSPECTION DIVISION 264-7619

WORKERS COMPENSATION DECLARATION

I hereby affirm under penalty of perjury one of the following declarations:

I have and will maintain a certificate of consent to self-insure for workers' compensation as provided for by Section 3700 of the Labor Code, for the performance of work for which the permit is issued.

I have and will maintain workers' compensation insurance, as required by Section 3700 of the Labor Code, for the performance of the work for which this permit is issued. My workers' compensation insurance carrier and policy number are:

Carrier State Fund
Policy Number A55554-00

(This section need not be completed if the permit is for one hundred dollars (\$100) or less) I certify that in the performance of the work for which this permit is issued, I shall not employ any person in any manner so as to become subject to the workers' compensation laws of California and agree that if I should become subject to the workers' compensation provisions of Section 3700 of the Labor Code, I shall forthwith comply with those provisions.

Date: 7/2/00 Applicant: [Signature]

WARNING: FAILURE TO SECURE WORKERS COMPENSATION COVERAGE IS UNLAWFUL AND SHALL SUBJECT AN EMPLOYER TO CRIMINAL PENALTIES AND CIVIL FINES UP TO ONE HUNDRED THOUSAND DOLLARS (\$100,000) IN ADDITION TO THE COST OF COMPENSATION, DAMAGES AS PROVIDED FOR IN SECTION 3706 OF THE LABOR CODE, INTEREST AND ATTORNEY'S FEES.

THIS PERMIT SHALL EXPIRE BY LIMITATION IF WORK AUTHORIZED IS NOT COMMENCED WITHIN 180 DAYS.

(A) HEIGHT 6' (B) LENGTH 8'
(A X B) SIGN AREA 48
POLE SIZE _____ FOOTING SIZE _____
STREET FRONTAGE (FT) _____
OCCUPANCY FRONTAGE (FT) _____

OFFICE USE ONLY
ENGINEERING REQUIRED? YES NO
DESIGN REVIEW REQUIRED? YES NO
SPECIAL PERMIT REQUIRED? YES NO
VARIANCE REQUIRED? YES NO
LOCATED IN PUD? YES NO WHICH PUD? _____

SIGN VALUATION
A. TYPE OF SIGN Stake Sign
B. \$ _____ PER SQ. FT. X _____ SQ. FT. = \$ _____
APPROVED BY [Signature] DATE 7/2/00
DENIED BY _____ DATE _____

FINAL INSPECTION
BUILDING INSPECTOR _____ DATE _____
ELECTRICAL INSPECTOR [Signature] DATE _____
SIGN INSPECTOR _____ DATE _____

FEES:
SIGN APPLICATION FEE _____
SIGN PERMIT FEE 111
ELECTRICAL 100
CITY BUSINESS LICENSE _____
OTHER _____

TOTAL \$ _____
RECEIVED AMOUNT _____

**THIS IS A 2 PART FORM
WRITE ON A FIRM SURFACE**

CONSTRUCTION LENDING AGENCY

I hereby affirm under penalty of perjury that there is a construction lending agency for the performance of the work for which this permit is issued (Sec. 3097, Civ.C.).

Lenders Name _____
Lenders Address _____

LICENSED CONTRACTORS DECLARATION

I hereby affirm under penalty of perjury that I am licensed under provisions of Chapter 9 (commencing with Section 7000) of Division 3 of the Business and Professions Code and my license is in full force and effect.

License Class CCS Lic. Number 423-432
Date 7/2/00 Contract 18305
(Signature)

OWNER - BUILDER DECLARATION

I hereby affirm under penalty of perjury that I am exempt from the Contractors License Law for the following reason (Sec. 7031.5, Business and Professions Code: Any city or county which requires a permit to construct, alter, improve, demolish, or repair any structure, prior to its issuance, also requires the applicant for such permit to file a signed statement that he or she is licensed pursuant to the provisions of the Contractors License Law (Chapter 9 (commencing with Section 7000) of Division 8 of the Business and Professions Code) or that he or she is exempt therefrom and the basis for the alleged exemption. Any violation of Section 7031.5 by any applicant for a permit subjects the applicant to a civil penalty of not more than five hundred dollars (\$500.00):

I, as owner of the property, or my employees with wages as their sole compensation, will do the work, and the structure is not intended or offered for sale (Sec. 7044, Business and Professions Code: The Contractors License Law does not apply to an owner of property who builds or improves thereon, and who does such work himself or herself or through his or her own employees, provided that such improvements are not intended or offered for sale. If, however, the building or improvement is sold within one year of completion, the owner-builder will have the burden of proving that he or she did not build or improve for the purpose of sale.)

I, as owner of the property, am exclusively contracting with licensed contractors to construct the project (Sec. 7044, Business and Professions Code: The Contractors License Law does not apply to an owner of property who builds or improves thereon, and who contracts for such projects with a contractor(s) licensed pursuant to the Contractors License Law).

I am exempt under Sec. _____ B & P C for this reason _____

Date _____ Owner _____ (Signature)

In issuing this building permit, the applicant represents, and the City relies on the representation of the applicant, that the applicant verified all measurements and locations shown on the application or accompanying drawings and that the improvement to be constructed does not violate any law or private agreement relating to permissible or prohibited locations for such improvements. This building permit does not authorize any illegal location of any improvement or the violation of any private agreement relating to location of improvements.

I certify that I have read this application and state that all information is correct. I agree to comply with all city and county ordinances and state laws relating to building construction and hereby authorize representative of this city to enter upon the abovementioned property for inspection purposes.

Date 7/2/00 Signature of Applicant or Agent [Signature]

**USE BLACK INK BALL POINT PEN — PRESS FIRMLY
SIGN PERMIT APPLICATION**

SITE ADDRESS

4201-9221 Norwood Ave Sac. Ca 95817 45

SITE

INSP. AREA

ASSESSOR PARCEL NO. 237-0100-029 PERMIT NO. 0008550

NAME OF APPLICANT _____ ADDRESS _____ ZIP CODE _____ PHONE NO. _____

LICENSED CONTRACTOR River City Sign 2419 Sellers Way 95691 916 371-3300

BUSINESS OWNER Passco Prop Mgt Inc. Ca. 800 W. 6th St # 600 95817 916 683-0500

SIGN INFORMATION

- ATTACHED INTERIOR / ELECT. SINGLE FACED
- ILLUMINATED NON-ILLUMINATED BILLBOARD / SUBDIVISION
- INDIVIDUAL LETTERS PAINTED ON BUILDING LOGO
- METAL POLE DOUBLE FACED
- PLASTIC MONUMENT VINYL/GATOR FOAM
- WOODEN PROJECTING RE-FACE

SIGN COPY Add'l signs Free-standing
Tenant Directory sign Center

Sign A S21270

**CITY OF SACRAMENTO PERMIT SERVICES
BUILDING INSPECTION DIVISION 264-7619**

WORKERS COMPENSATION DECLARATION

I hereby affirm under penalty of perjury one of the following declarations:

- I have and will maintain a certificate of consent to self-insure for workers' compensation as provided for by Section 3700 of the Labor Code, for the performance of work for which the permit is issued.
- I have and will maintain workers' compensation insurance, as required by Section 3700 of the Labor Code, for the performance of the work for which this permit is issued. My workers' compensation insurance carrier and policy number are:
Carrier State Fund
Policy Number ASS554-01

(This section need not be completed if the permit is for one hundred dollars (\$100) or less) I certify that in the performance of the work for which this permit is issued, I shall not employ any person in any manner so as to become subject to the workers' compensation laws of California and agree that if I should become subject to the workers' compensation provisions of Section 3700 of the Labor Code, I shall forthwith comply with those provisions.

Date: 7/2/00 Applicant [Signature]

WARNING: FAILURE TO SECURE WORKERS COMPENSATION COVERAGE IS UNLAWFUL AND SHALL SUBJECT AN EMPLOYER TO CRIMINAL PENALTIES AND CIVIL FINES UP TO ONE HUNDRED THOUSAND DOLLARS (\$100,000) IN ADDITION TO THE COST OF COMPENSATION DAMAGES AS PROVIDED FOR IN SECTION 3706 OF THE LABOR CODE, INTEREST AND ATTORNEY'S FEES.

THIS PERMIT SHALL EXPIRE BY LIMITATION IF WORK AUTHORIZED IS NOT COMMENCED WITHIN 180 DAYS.

(A) HEIGHT 6' (B) LENGTH 8'
(A X B) SIGN AREA 6x8 = 48 sq
POLE SIZE _____ FOOTING SIZE _____
STREET FRONTAGE (FT) _____
OCCUPANCY FRONTAGE (FT) _____

OFFICE USE ONLY

ENGINEERING REQUIRED? YES APPROVED BY _____
DESIGN REVIEW REQUIRED? YES APPROVED BY _____
SPECIAL PERMIT REQUIRED? YES # _____
VARIANCE REQUIRED? YES # _____
LOCATED IN PUD? YES NO WHICH PUD? _____

SIGN ALIQUOT Sign
A. TYPE OR SIZE _____ SQ. FT. = \$ _____
B. \$ _____ PER SQ. FT. X _____ SQ. FT. = \$ _____
APPROVED BY [Signature] DATE 7-26-00
DENIED BY _____ DATE _____

FINAL INSPECTIONS
BUILDING INSPECTOR [Signature] DATE _____
ELECTRICAL INSPECTOR _____ DATE _____
SIGN INSPECTOR _____ DATE _____

FEES:	RECEIVED	DATE	AMOUNT
SIGN APPLICATION FEE	<u>PP</u>	<u>6/20/00</u>	<u>00</u>
SIGN PERMIT FEE	<u>PP</u>	<u>6/20/00</u>	<u>00</u>
ELECTRICAL SIGN FEE	<u>PP</u>	<u>6/20/00</u>	<u>00</u>
CITY BUSINESS LICENSE	<u>PP</u>	<u>6/20/00</u>	<u>00</u>
OTHER			
TOTAL \$			

THIS IS A 2 PART FORM
WRITE ON A FIRM SURFACE

CONSTRUCTION LENDING AGENCY

I hereby affirm under penalty of perjury that there is a construction lending agency for the performance of the work for which this permit is issued (Sec. 3097, Civ. C.).

Lenders Name _____
Lenders Address _____

LICENSED CONTRACTORS DECLARATION

I hereby affirm under penalty of perjury that I am licensed under provisions of Chapter 9 (commencing with Section 7000) of Division 3 of the Business and Professions Code and my license is in full force and effect.

License Class 045 Lic. Number 4923432
Date 6-7-00 Contractor John Brown
(Signature)

OWNER - BUILDER DECLARATION

I hereby affirm under penalty of perjury that I am exempt from the Contractors License Law for the following reason (Sec. 7031.5, Business and Professions Code: Any city or county which requires a permit to construct, alter, improve, demolish, or repair any structure, prior to its issuance, also requires the applicant for such permit to file a signed statement that he or she is licensed pursuant to the provisions of the Contractors License Law (Chapter 9 (commencing with Section 7000) of Division 3 of the Business and Professions Code) or that he or she is exempt therefrom and the basis for the alleged exemption. Any violation of Section 7031.5 by any applicant for a permit subjects the applicant to a civil penalty of not more than five hundred dollars (\$500.00):

I, as owner of the property, or my employees with wages as their sole compensation, will do the work, and the structure is not intended or offered for sale (Sec. 7044, Business and Professions Code: The Contractors License Law does not apply to an owner of property who builds or improves thereon, and who does such work himself or herself or through his or her own employees, provided that such improvements are not intended or offered for sale. If, however, the building or improvement is sold within one year of completion, the owner-builder will have the burden of proving that he or she did not build or improve for the purpose of sale.)

I, as owner of the property, am exclusively contracting with licensed contractors to construct the project (Sec. 7044, Business and Professions Code: The Contractors License Law does not apply to an owner of property who builds or improves thereon, and who contracts for such projects with a contractor(s) licensed pursuant to the Contractors License Law).

I am exempt under Sec. _____ B & P C for this reason _____
Date _____ Owner _____ (Signature)

In issuing this building permit, the applicant represents, and the City relies on the representation of the applicant, that the applicant verified all measurements and locations shown on the application or accompanying drawings and that the improvement to be constructed does not violate any law or private agreement relating to permissible or prohibited locations for such improvements. This building permit does not authorize any illegal location of any improvement or the violation of any private agreement relating to location of improvements.

I certify that I have read this application and state that all information is correct. I agree to comply with all city and county ordinances and state laws relating to building construction and hereby authorize representative of this city to enter upon the abovementioned property for inspection purposes.

Date 6-7-00 Signature of Applicant or Agent _____

USE BLACK INK BALL POINT PEN - PRESS FIRMLY
SIGN PERMIT APPLICATION

SITE ADDRESS

4201-4221 NORWOOD AVE. GREAT CA.

SUITE

INSP. AREA

ASSESSOR PARCEL NO. 237-2102-041-030 PERMIT NO. _____

NAME OF APPLICANT _____ ADDRESS _____ ZIP CODE _____ PHONE NO. _____

LICENSED CONTRACTOR ELIOT CITY SIGNS 2419 SOLARIS WY. W. SHARD CA. 95691. 911-371-3300

BUSINESS OWNER PASSCO PROP. MGT. INC. 800 W. GATE ST. SUITE 600. L.A. CA 90017. 215-683-0500.

SIGN INFORMATION
 ATTACHED INTERIOR / ELECT. SINGLE FACED
 ILLUMINATED NON-ILLUMINATED BILLBOARD / SUBDIVISION
 INDIVIDUAL LETTERS PAINTED ON BUILDING LOGO
 METAL POLE DOUBLE FACED
 PLASTIC MOUNTMENT VINYL/GATOR FOAM
 WOODEN PROJECTING RE-FACE

(A) HEIGHT 10' (B) LENGTH 17'
(A X B) SIGN AREA 170 sq ft
POLE SIZE 6x4x2x10 FOLLOW
FOOTING SIZE _____
STREET FRONTAGE (FT) _____
OCCUPANCY FRONTAGE (FT) _____
OFFICE USE ONLY

CITY OF SACRAMENTO PERMIT SERVICES
BUILDING INSPECTION DIVISION 264-7619
WORKERS COMPENSATION DECLARATION
I have and will maintain a certificate of consent to self-insure for workers compensation as provided for by Section 3700 of the Labor Code, for the performance of work for which the permit is issued.
 I have and will maintain workers' compensation insurance, as required by Section 3700 of the Labor Code, for the performance of the work for which this permit is issued. My workers' compensation insurance carrier and policy number are:
STARS FUND
455554-00
Policy Number

FINAL INSPECTIONS
BUILDING INSPECTOR _____ DATE _____
ELECTRICAL INSPECTOR _____ DATE _____
SIGN INSPECTOR _____ DATE _____
FEES: RECEIVED AMOUNT
SIGN APPLICATION FEE 10 DATE 6-7-00 AMOUNT 75.00
SIGN PERMIT FEE _____
ELECTRICAL SIGN FEE _____
CITY BUSINESS LICENSE _____
OTHER _____

WARNING: FAILURE TO SECURE WORKERS' COMPENSATION COVERAGE IS UNLAWFUL AND SHALL SUBJECT AN EMPLOYER TO CRIMINAL PENALTIES AND CIVIL FINES UP TO ONE HUNDRED THOUSAND DOLLARS (\$100,000) IN ADDITION TO THE COST OF COMPENSATION. DAMAGES AS PROVIDED FOR IN SECTION 3706 OF THE LABOR CODE, INTEREST AND ATTORNEY'S FEES.
TOTAL FEES \$ _____

THIS PERMIT SHALL EXPIRE BY LIMITATION IF WORK AUTHORIZED IS NOT COMMENCED WITHIN 180 DAYS.

NORWOOD CENTER

4201-4221 Norwood Ave.
Sacramento, CA

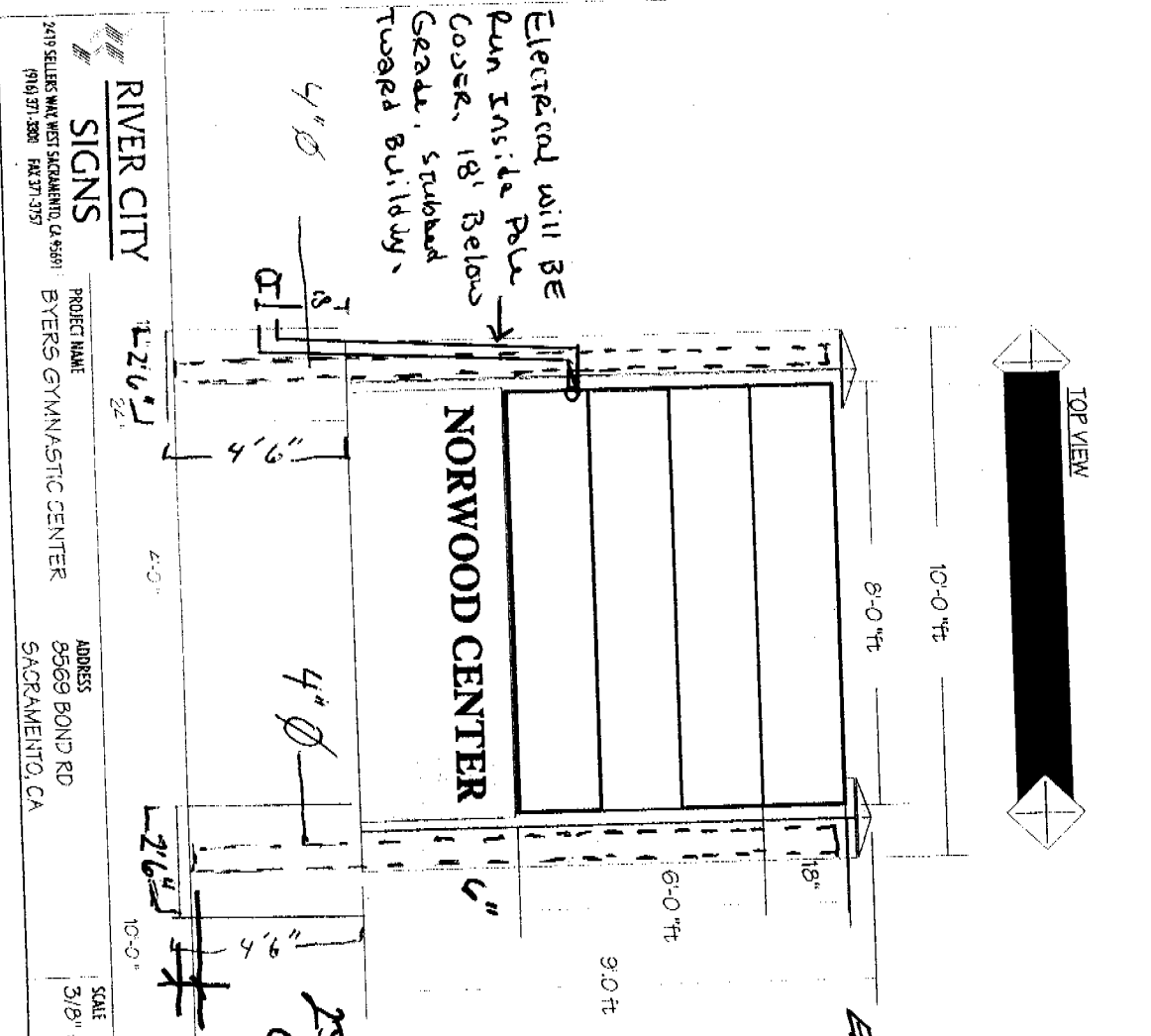

RIVER CITY SIGNS
 2419 SELLERS WAY WEST SACRAMENTO, CA 95691
 (916) 571-5800 FAX 571-5157

PROJECT NAME BYERS GYMNASTIC CENTER
ADDRESS 9569 BOND RD SACRAMENTO, CA

SCALE 3/8" = 1'
DATE 5-15-00
SALESMAN BOB S.
DESIGNER DUSTIN
FILE NAME & LOCATION BYERS GYMNASTIC CENTER CHANNEL LETTERS
ZIP DISK #13

Elec. Permit needed for sign final

2550 PSI Core - (use Min. 5 sacks of cement)

3" clv. (TRP) Sign A + B

DOUBLE FACE POLE SIGN - CONSTRUCTION DETAIL

- METAL CABINET
- EXAM FACES
- DISCONNECT SWITCH
- RETAINER
- STEEL POLE WELDED TO FRAME
- BALLASTS
- ANGLE IRON FRAME
- HIGH OUTPUT FLUORESCENT TUBES

APPROVED
 LINER 3
 CHAPTER 3
 CITY CODE
 CITY OF SACRAMENTO

Scale of City of Sacramento
 Div. 2 of Sacramento City Ordinance 14.71.0100
 Chapter 14, Section 14.0600
 N.E.C. Sec. 14.0600
 All electrical work must comply with existing standards, N.E.C. Sec. 14.0600 and Chapter 14, Div. 2 of Sacramento City Ordinance 14.71.0100.

EQUIPMENT MUST BE USED AS DESIGN INTENDED
ALL SIGN INSTALLATIONS ARE SUBJECT TO FIELD INSPECTIONS

777-0623

The approval of all Electrical Work is subject to field inspections.

FILE COPY

John Tang

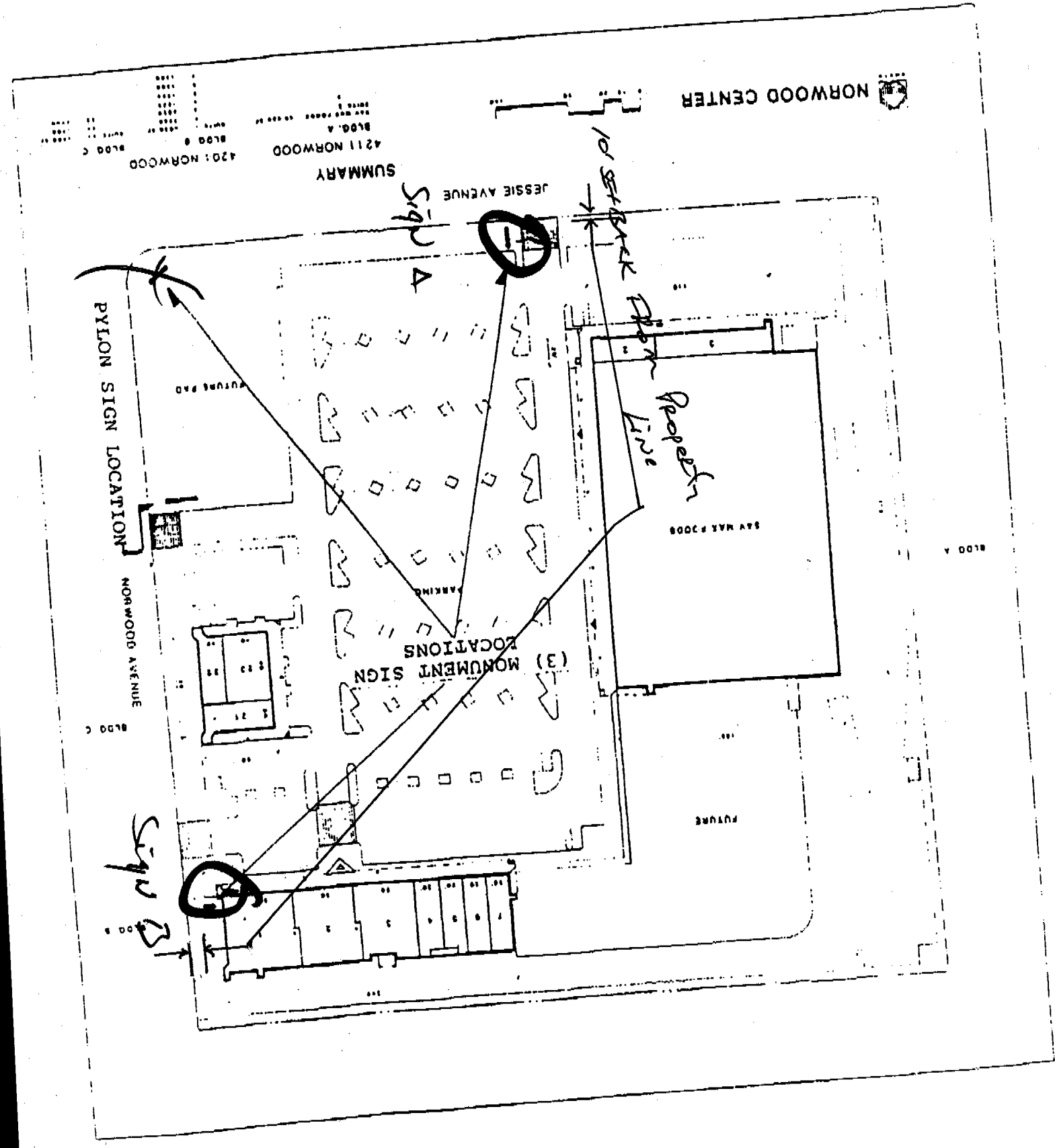

SIGN APPROVED
 CITY PLANNING COMMISSION
 BY: *[Signature]*
 DATE: 9/19/94

NORWOOD CENTER

SUMMARY
 4211 NORWOOD
 BLDG. A
 4201 NORWOOD
 BLDG. B
 4203 NORWOOD
 BLDG. C

JESSIE AVENUE

PYLON SIGN LOCATION

NORWOOD AVENUE

(3) MONUMENT SIGN LOCATIONS

345 MAX FLOOR

FUTURE

BLDG. A

APPROVED 09/19/94 TEST DEPT/ST/90