

CITY OF SACRAMENTO
1231 I Street, Sacramento, CA 95814

Permit No: 0114413
Insp Area: 4
Thos Bros:
Sub-Type: NSFR
Housing (Y/N): N

Site Address: 3328 CALLA LILY WY SAC
Parcel No: 274-0500-063 NATOMAS W 2 LOT 23

CONTRACTOR
KAUFMAN AND BROAD
611 ORANGE DR
VACAVILLE CA. 95687

OWNER

ARCHITECT

Nature of Work: NSFR MP1706 8 RMS 1 STORY

CONSTRUCTION LENDING AGENCY : I hereby affirm under penalty of perjury that there is a construction lending agency for the performance of the work for which this permit is issued (Sec. 3097, Civ. C).

Lender's Name _____ Lender's Address _____

LICENSED CONTRACTORS DECLARATION: I hereby affirm under penalty of perjury that I am licensed under provisions of Chapter 9 (commencing with section 7000) of Division 3 of the Business and Professions Code and my license is in full force and effect.

License Class B License Number 761970 Date 11/16/01 Contractor Signature [Signature]

OWNER-BUILDER DECLARATION: I hereby affirm under penalty of perjury that I am exempt from the contractors License Law for the following reason (Sec. 7031.5, Business and Professions Code; any city or county which requires a permit to construct, alter, improve, demolish, or repair any structure, prior to its issuance, also requires the applicant for such permit to file a signed statement that he or she is licensed pursuant to the provisions of the Contractors License Law (Chapter 9 (commencing with Section 7000) of Division 8 of the Business and Professions Code) or that he or she is exempt therefrom and the basis for the alleged exemption. Any violation of Section 7031.5 by any applicant for a permit subjects the applicant to a civil penalty of not more than five hundred dollars (\$500.00);

I, as a owner of the property, or my employees with wages as their sole compensation, will do the work, and the structure is not intended or offered for sale (Sec. 7044, Business and Professional Code: The Contractors License Law does not apply to an owner of property who builds or improves thereon, and who does such work himself or herself or through his/her own employees, provided that such improvements are not intended or offered for sale. If, however, the building or improvement is sold within one year of completion, the owner-builder will have the burden of proving that he/she did not build or improve for the purpose of sale.)

I, as owner of the property, am exclusively contracting with licensed contractors to construct the project (Sec. 7044, Business and Professions Code: The Contractors License Law does not apply to an owner of property who builds or improves thereon, and who contracts for such projects with a contractor(s) licensed pursuant to the Contractors License Law).

I am exempt under Sec. _____ B & PC for this reason: _____

Date _____ Owner Signature _____

IN ISSUING THIS BUILDING PERMIT, the applicant represents, and the city relies on the representation of the applicant, that the applicant verified all measurements and locations shown on the application or accompanying drawings and that the improvement to be constructed does not violate any law or private agreement relating to permissible or prohibited locations for such improvements. This building permit does not authorize any illegal location of any improvement or the violation of any private agreement relating to location of improvements.

I certify that I have read this application and state that all information is correct. I agree to comply with all city and county ordinances and state laws relating to building construction and hereby authorize representative(s) of this city to enter upon the abovementioned property for inspection purposes.

Date 11/16/01 Applicant/Agent Signature [Signature]

WORKER'S COMPENSATION DECLARATION: I hereby affirm under penalty of perjury one of the following declarations:
I have and will maintain a certificate of consent to self-insure for workers' compensation as provided for by Section 3700 of the Labor Code, for the performance of work for which the permit is issued.

2 I have and will maintain workers' compensation insurance, as required by Section 3700 of the Labor Code, for the performance of the work for which this permit is issued. City workers' compensation insurance carrier and policy number are:

Carrier AMERICAN CASUALTY Policy Number WC247837616 Exp Date 05/01/2002

(This section need not be completed if the permit is for \$100 or less) I certify that in the performance of the work for which this permit is issued, I shall not employ any person who is or may become subject to the workers' compensation laws of California and agree that if I should become subject to the workers' compensation provisions of Section 3700 of the Labor Code, I shall forthwith comply with those provisions.

Date 11/16/01 Applicant Signature [Signature]

WARNING: FAILURE TO SECURE WORKER'S COMPENSATION COVERAGE IS UNLAWFUL AND SHALL SUBJECT AN EMPLOYER TO CRIMINAL PENALTIES AND CIVIL FINES UP TO ONE HUNDRED THOUSAND DOLLARS (\$100,000) IN ADDITION TO THE COST OF COMPENSATION, DAMAGES AS PROVIDED FOR IN SECTION 3706 OF THE LABOR CODE, INTEREST AND ATTORNEY'S FEE.

THIS PERMIT SHALL EXPIRE BY LIMITATION IF WORK IS NOT COMMENCED WITHIN 180 DAYS.

RESIDENTIAL SUBDIVISION BUILDING PERMIT APPLICATION

Project Address: 3328 Calla Lily Way Assessor Parcel # 274-0500-063
Lot Number: 23 Subdivision Natomas West Village

OWNER INFORMATION:

Legal Property Owner: KB Home Phone# 707-469-2464
Owner Address: 611 Orange dr City Vacaville State CA Zip 95687

CONTRACTOR INFORMATION:

Contractor: KB Home Lic. # 761970 Phone # 707-469-2464 Fax 469-2405

PROJECT INFORMATION:

Land Use Zone RIA Occupancy Group R3 Construction Type VN Fed Code 1A
 No. of Stories: 1 No. of Rooms: 8 Street Width: _____
 1st Floor Area 1700 2nd Floor Area _____ Basement _____ Roof Material _____

AREA IN SQUARE FOOT OF:

Dwelling/Living 1700
 Garage/Storage 436
 Decks/Balconies 25 78
 Carports _____

SCOPE OF WORK: New Single Family Dwelling

FOR OFFICE USE ONLY

<input type="checkbox"/> Information Above Complete	<input type="checkbox"/> AR Flood Waiver Required	<input type="checkbox"/> Planning Approval
<input type="checkbox"/> Violation Files Checked	<input type="checkbox"/> Flood Elevation Certificate Required	<input type="checkbox"/> Design Review Approval
<input type="checkbox"/> Standard Setbacks	<input type="checkbox"/> Water Development Infill Area	<input type="checkbox"/> Special Fee Districts Apply:
<input type="checkbox"/> County Sewer		

THE FOLLOWING MUST BE PROVIDED IN ORDER TO SUBMIT FOR PERMIT

2 COMPLETE PLOT PLANS, LEGIBLE & DRAWN TO SCALE
 11 X 17 COPY OF FLOOR PLAN WITH FOLLOWING INFORMATION

a) Assessor's Parcel Number	c) Owners Name
b) New Floor Area	d) Project Address

CERTIFICATION OF INSULATION

ADDRESS OR TRACT <div style="font-size: 2em; font-weight: bold; margin-left: 20px;">KB</div> <div style="margin-left: 150px;">LOT # 24</div> <div style="margin-top: 20px; font-size: 1.5em; font-weight: bold;">CALIF GARDENS</div>	SACRAMENTO BUILDING PRODUCTS <input checked="" type="checkbox"/> P.O. BOX 854, WEST SACRAMENTO, CA 95691 LIC. #202026 <input type="checkbox"/> 1309 MELODY ROAD, MARYSVILLE, CA 95901 LIC. #202026 <input type="checkbox"/> P.O. BOX 9651, FRESNO, CA 93793-9651 LIC. #202026 <input type="checkbox"/> P.O. BOX 1631, RENO, NV 89505 LIC. #10675 <input type="checkbox"/> 3326 A PONDEROSA WAY, LAS VEGAS, NV 89118 LIC. #10675 DATE INSULATION COMPLETED
---	---

WALLS			CEILING			FLOORS			
(SQUARE FEET)			(SQUARE FEET)			(SQUARE FEET)			
TYPE OF INSULATION			TYPE OF INSULATION			TYPE OF INSULATION			
MATERIAL FIBERGLASS			MATERIAL FIBERGLASS			MATERIAL FIBERGLASS			
FORM BATTS			FORM BATTS & BLOW			FORM BATTS			
MANUFACTURER'S PRODUCT I.D.			MANUFACTURER'S PRODUCT I.D.			MANUFACTURER'S PRODUCT I.D.			
MANUFACTURER			MANUFACTURER			MANUFACTURER			
CT	OC	JM	CT	OC	JM	CT	OC	JM	
			BAGS						
R-VALUE INSTALLED	APPLIED THICKNESS	R-VALUE INSTALLED	APPLIED THICKNESS	WEIGHT PER SQUARE FOOT	R-VALUE INSTALLED	APPLIED THICKNESS			
13	3 1/2"	38 38	12" 14 3/4"						
KNEE WALLS IF R-VALUE IS OTHER THAN WALLS ABOVE									
MATERIAL FIBERGLASS		FORM BATTS		R VALUE			MANUFACTURER		
							CT	OC	JM
AIR INFILTRATION SEALANT									
MATERIAL FOAM				MANUFACTURER					
				HILTI		HANDY FOAM			

THIS IS TO CERTIFY THAT INSULATION AND/OR SEALANT HAS BEEN INSTALLED IN CONFORMANCE WITH APPLICABLE CODES, MATERIAL STANDARDS AND REGULATIONS.		
SIGNATURE — INSULATION CONTRACTOR <i>Jeff All</i>	TITLE MANAGER	DATE 8-29-02
SIGNATURE — GENERAL CONTRACTOR	TITLE	DATE
REMARKS		

PART I GENERAL
PART II AREAS INSULATED
PART III CERTIFICATION

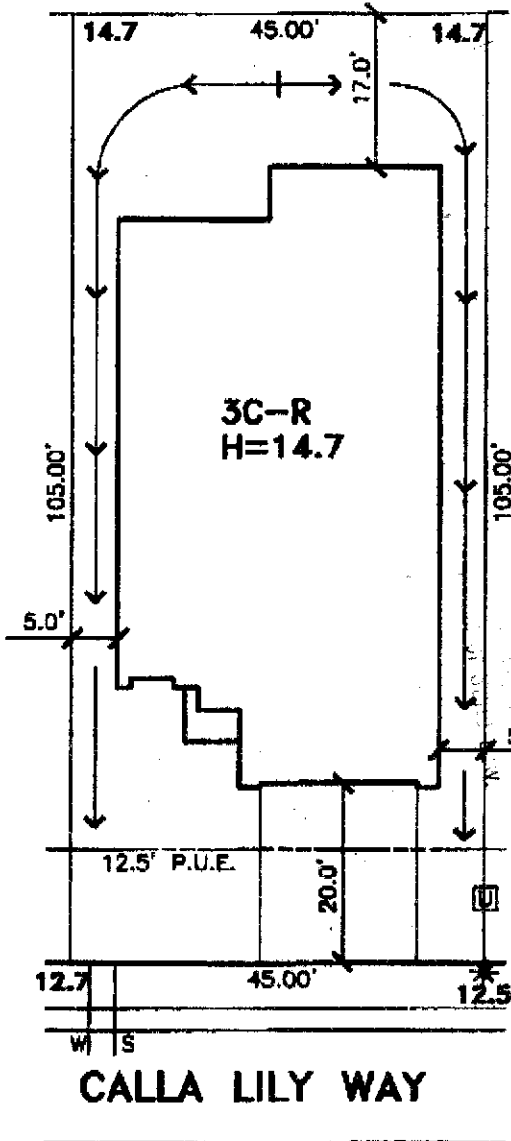

The set of plans and specifications shall be
 subject to the terms and conditions of the
 contract documents and shall be subject to
 the terms and conditions of the contract documents
 and shall be subject to the terms and conditions
 of the contract documents.



DATE: 7-27-01
A.P.N.: 274-0500-063
ADDRESS: 3328 CALLA LILY WAY

LOT AREA: 4,725 SF
LOT COVERAGE: 46%

Stantec

Stantec Consulting Inc.
 2590 Venture Oaks Way
 Sacramento, CA 95833-3288
 Tel. 916.925.5550
 Fax. 916.921.9274
 www.stantec.com

**NATOMAS WEST
 VILLAGE 2**

**LOT 23
 PLAN 3C**

CALIFORNIA GARDENS

**CITY OF SACRAMENTO, CA
 CLIENT: KAUFMAN & BROAD**